

F.A.I. RTE.	SECTION	COUNTY	TOTAL SHEETS	SHEET NO.
290	2006-0301	COOK	78	62
STA.	TO STA.			
FED. ROAD DIST. NO.	ILLINOIS	FED. AID PROJECT		

CONTRACT NO. 60B79

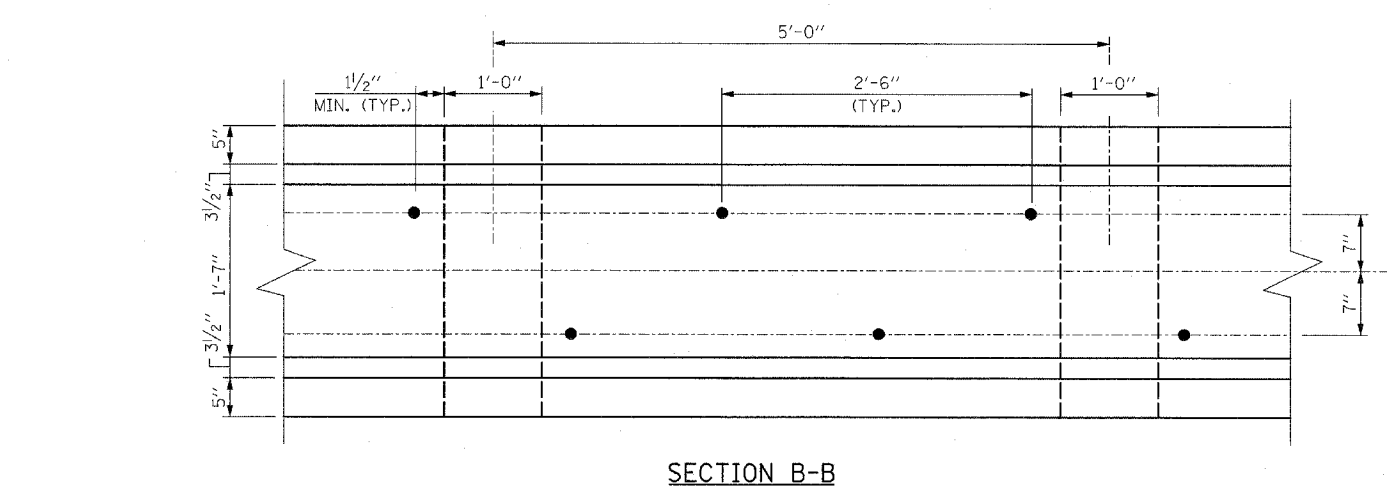
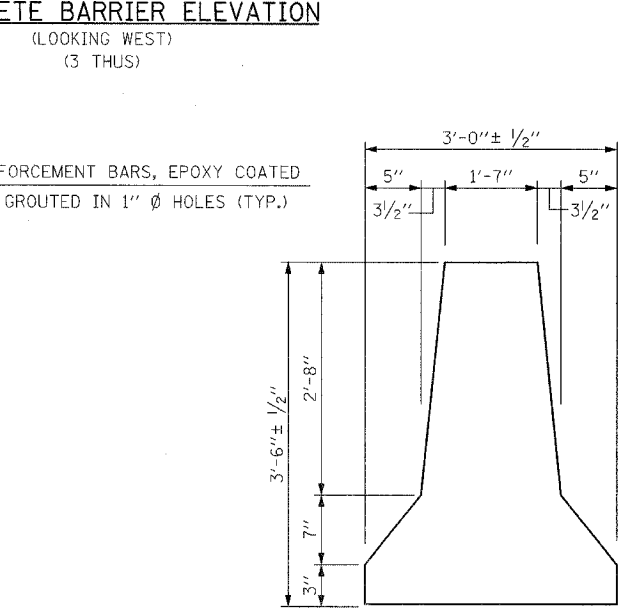
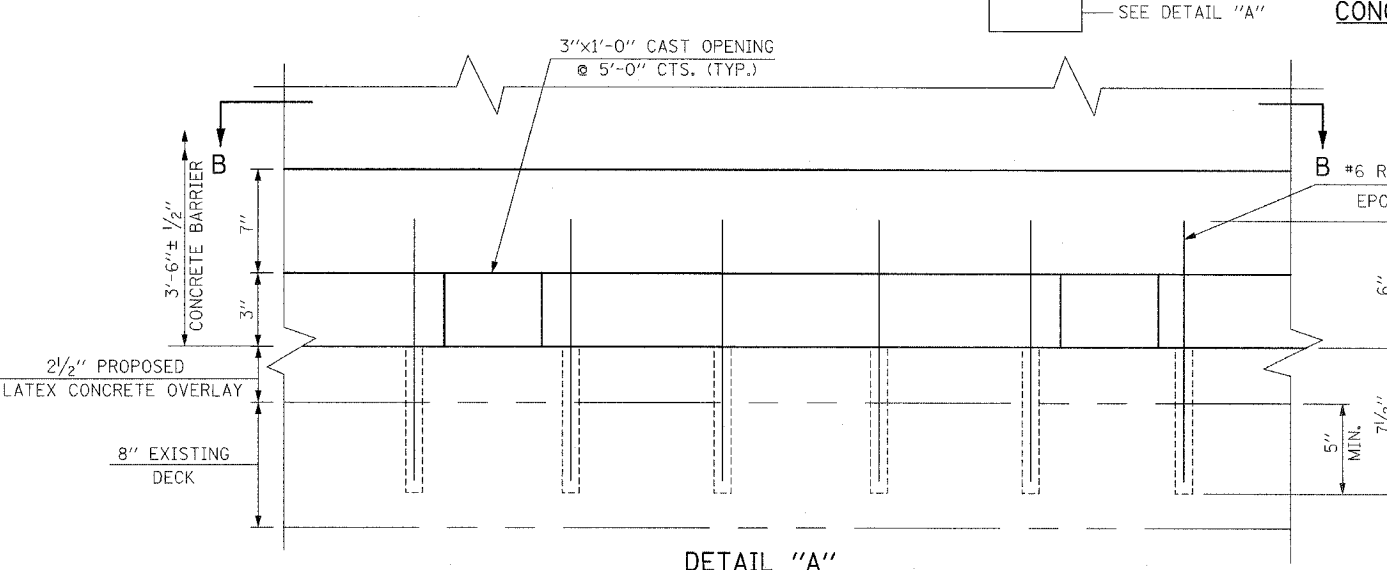
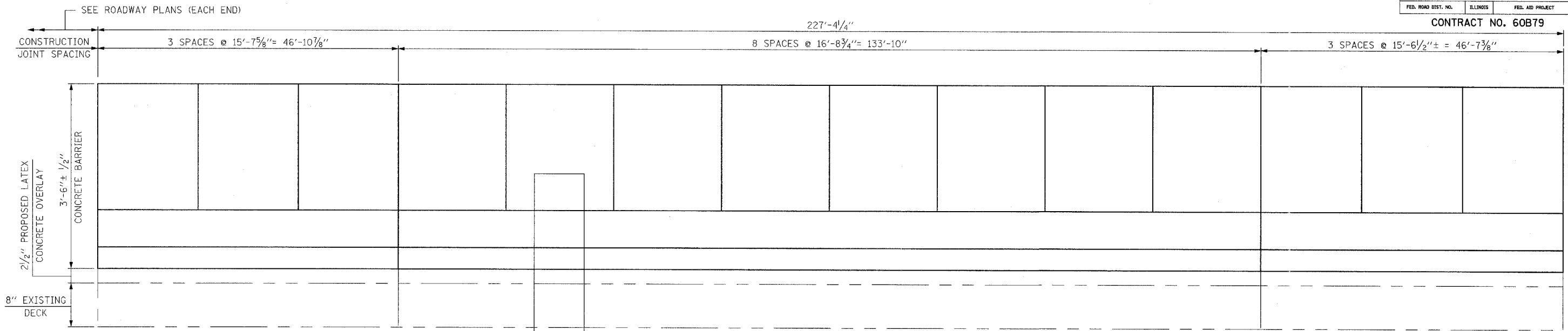

NOTE:
VERTICAL DIMENSIONS ARE EXAGGERATED FOR CLARITY

NOTES:
CONCRETE BARRIERS SHALL CONFORM TO STANDARD 637006, EXCEPT AS NOTED.
FOR BARRIER LOCATIONS, SEE SHEETS S3 & S4.
REINFORCEMENT BARS, EPOXY COATED, CAST OPENINGS AND EPOXY GROUTING SHALL BE INCLUDED WITH "CONCRETE BARRIER, DOUBLE FACE, 42 IN"

BILL OF MATERIAL		
DESCRIPTION	UNIT	QUANTITY
CONCRETE BARRIER, DOUBLE FACE, 42 IN.	FT.	683

REVISIONS	
NAME	DATE

ILLINOIS DEPARTMENT OF TRANSPORTATION
CONCRETE BARRIER
 F.A.I. RTE. 290 (I-290) OVER GOLF ROAD
 F.A.I. RTE. 290 SECTION: 2006-0301
 COOK COUNTY STATION 612+95.92
 STRUCTURE NO. 016-0980

SCALE: DATE: MAY 10, 2007
 DRAWN BY: D.L./F.M.
 CHECKED BY: B.N.S./J.C.N.
CHRISTIAN-ROGE & ASSOC., INC.
 CHICAGO ILLINOIS