

F.A.P. RTE.	SECTION	COUNTY	TOTAL SHEETS	SHEET NO.
303	131B (1&2) BR	McHENRY	107	18
STA.		TO STA.		
FED. ROAD DIST. NO.		ILLINOIS FED. AID PROJECT		
CONTRACT NO. 60B83				

### TRAFFIC CONTROL GENERAL NOTES

1. THE CONTRACTOR SHALL NOT MOUNT SIGNS ON EXISTING SIGNS.
2. THE CONTRACTOR WILL PROVIDE AND INSTALL TWO (2) WEIGHTED SAND BAGS ON EACH BARRICADE USED. (TYPE I OR TYPE II (ONE (1) WEIGHTED SAND BAG ACROSS EACH BOTTOM RAIL).
3. FLUORESCENT VESTS: ALL CONSTRUCTION PERSONNEL WILL BE REQUIRED TO WEAR FLUORESCENT VESTS AT ALL TIMES WHILE ON THE CONSTRUCTION SITE. COMPLIANCE WITH THIS REQUIREMENT SHALL BE CONSIDERED INCIDENTAL TO THE CONTRACT.
4. THE CONTRACTOR IS ADVISED THAT IN THE EVENT OF SNOW, HE WILL BE RESPONSIBLE FOR THE IMMEDIATE REMOVAL OF ANY MAINTENANCE OF TRAFFIC PROTECTIVE DEVICES REQUIRED FOR HIS OPERATIONS THAT WOULD INTERFERE WITH SNOW REMOVAL OPERATIONS PERFORMED BY THE STATE.
5. TYPE III BARRICADES SHALL BE PLACED AT BOTH ENDS OF THE CLOSED PORTION OF BECK ROAD. THE CONTRACTOR SHALL PROVIDE ENOUGH TYPE III BARRICADES TO CROSS THE ENTIRE ROADWAY AS DEPICTED ON THE PLANS
6. TEMPORARY AGGREGATE ACCESS SHALL BE PROVIDED AT ALL DRIVEWAYS AS DIRECTED BY THE ENGINEER.
7. CONTRACTOR SHALL MAINTAIN SATISFACTORY INGRESS AND EGRESS TO ADJACENT PROPERTIES THROUGHOUT THE CONSTRUCTION.
8. CONTRACTOR SHALL USE PAVEMENT MARKING TAPE, TYPE III FOR ALL TEMPORARY LANE MARKINGS ON ALL PERMANENT PAVEMENT. PAVEMENT MARKING TAPE SHALL BE USED ON WET PAVEMENT AS DIRECTED BY THE ENGINEER. TEMPORARY PAVEMENT MARKINGS SHALL BE USED ON SURFACES TO BE REMOVED OR OVERLAID.
9. TEMPORARY INFORMATION SIGNING:
10. EXISTING TRAFFIC CONTROL SIGNS AND MESSAGES THAT ARE IN CONFLICT WITH THE PROPOSED MAINTENANCE OF TRAFFIC SHALL BE TEMPORARILY COVERED OR MODIFIED WITH TEMPORARY OVERLAY AS SHOWN IN PLANS AND AS DIRECTED BY THE ENGINEER.
11. INSTALL ADDITIONAL TEMPORARY SIGN PANEL ASSEMBLY AS SHOWN IN PLANS AND AS DIRECTED BY THE ENGINEER. TO BE PAID FOR BY ITEM "TEMPORARY INFORMATION SIGNING"
12. WHERE REQUIRED BY THE ENGINEER, TEMPORARY PAVEMENT CAN BE ADDED TO THE PROJECT.

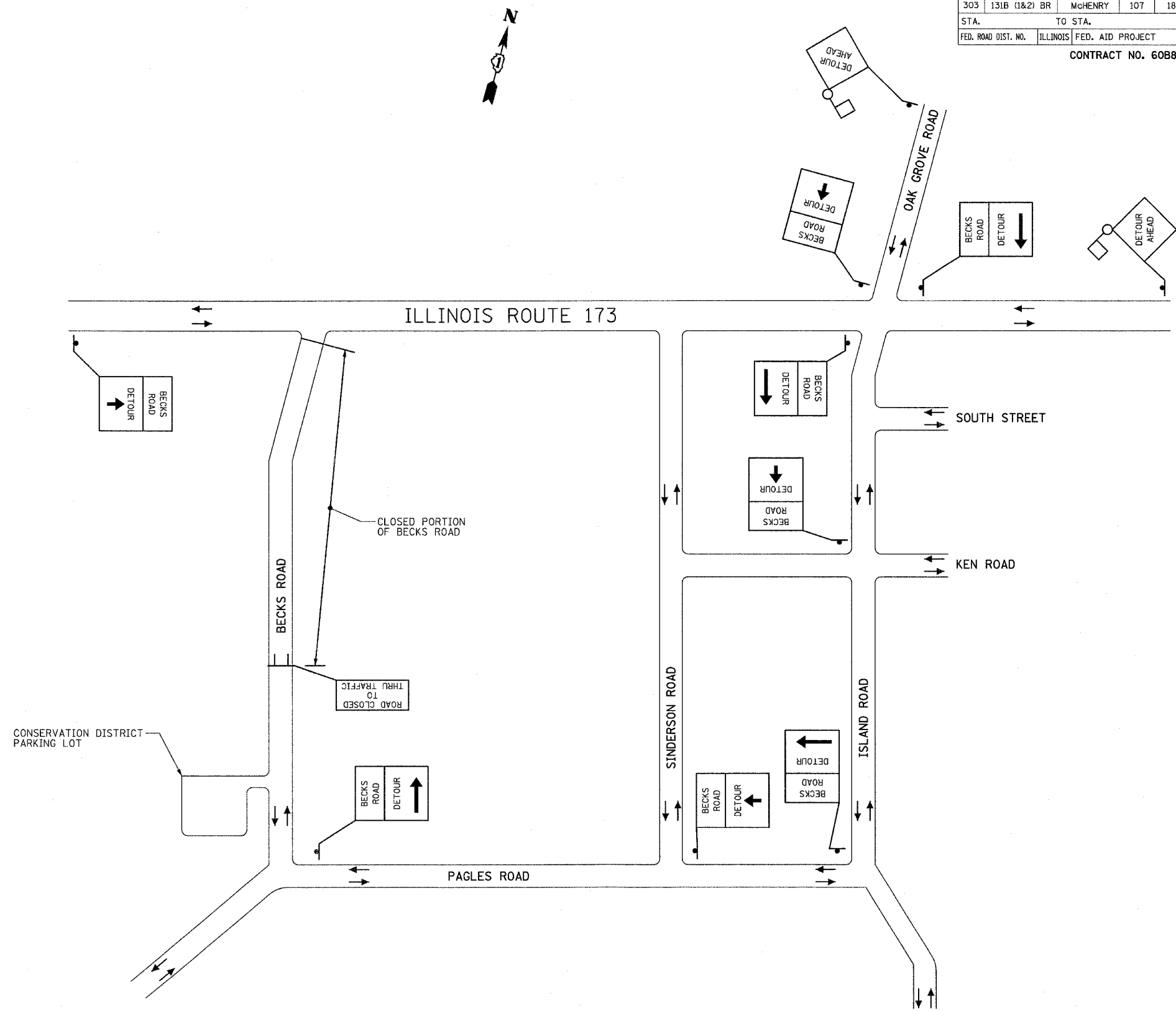

W20-2  
(48" x 48")

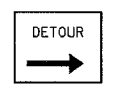

M4-9  
(30" x 24")

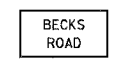

(24" x 24")

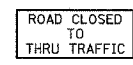

R11-4

REVISIONS	
NAME	DATE

ILLINOIS DEPARTMENT OF TRANSPORTATION  
**SUGGESTED STAGING AND TRAFFIC CONTROL  
GENERAL NOTES AND  
DETOUR PLAN  
IL. RTE. 173 & BECKS RD.**

SCALE: NONE  
DATE: APRIL 16, 2007  
DRAWN BY: A.C.S.  
CHECKED BY: S.J.P.

**CR & A**  
**CHRISTIAN-ROGE & ASSOCIATES, INC.**  
ENGINEERS-PLANNERS-SURVEYORS  
211 WEST WACKER DRIVE  
CHICAGO, ILLINOIS 60606  
1-312-372-2023 FAX: 1-312-372-5274