

F.A.P. RTE.	SECTION	COUNTY	TOTAL SHEETS	SHEET NO.
303	131B (1&2) BR	McHENRY	107	36
STA.	TO STA.			
FED. ROAD DIST. NO.	ILLINOIS	FED. AID PROJECT		

CONTRACT NO. 60B83



LANDSCAPING LEGEND

- SODDING, SALT TOLERANT
- SEEDING, CLASS 3 WITH HEAVY DUTY EROSION CONTROL BLANKET
- CLEARING LIMIT

PAVEMENT MARKING LEGEND

- EXISTING PAVEMENT MARKINGS
- PROPOSED PAVEMENT MARKINGS
- PROPOSED MONODIRECTIONAL RAISED RELECTIVE PAVEMENT MARKER (AMBER)
- PROPOSED BIDIRECTIONAL RAISED RELECTIVE PAVEMENT MARKER (AMBER)
- CRYSTAL TYPE C, BARRIER MARKERS
- CRYSTAL TYPE A, ON SPBGR
- AMBER TYPE A, ON SPBGR

NOTE:

1. EROSION CONTROL BLANKET SHALL HAVE A BIO-DEGRADABLE NETTING OTHER THAN PLASTIC.
2. ALL PAVEMENT MARKINGS SHALL BE THERMOPLASTIC, UNLESS OTHERWISE NOTED.
3. ALL RIPRAP SHALL HAVE FILTER FABRIC.

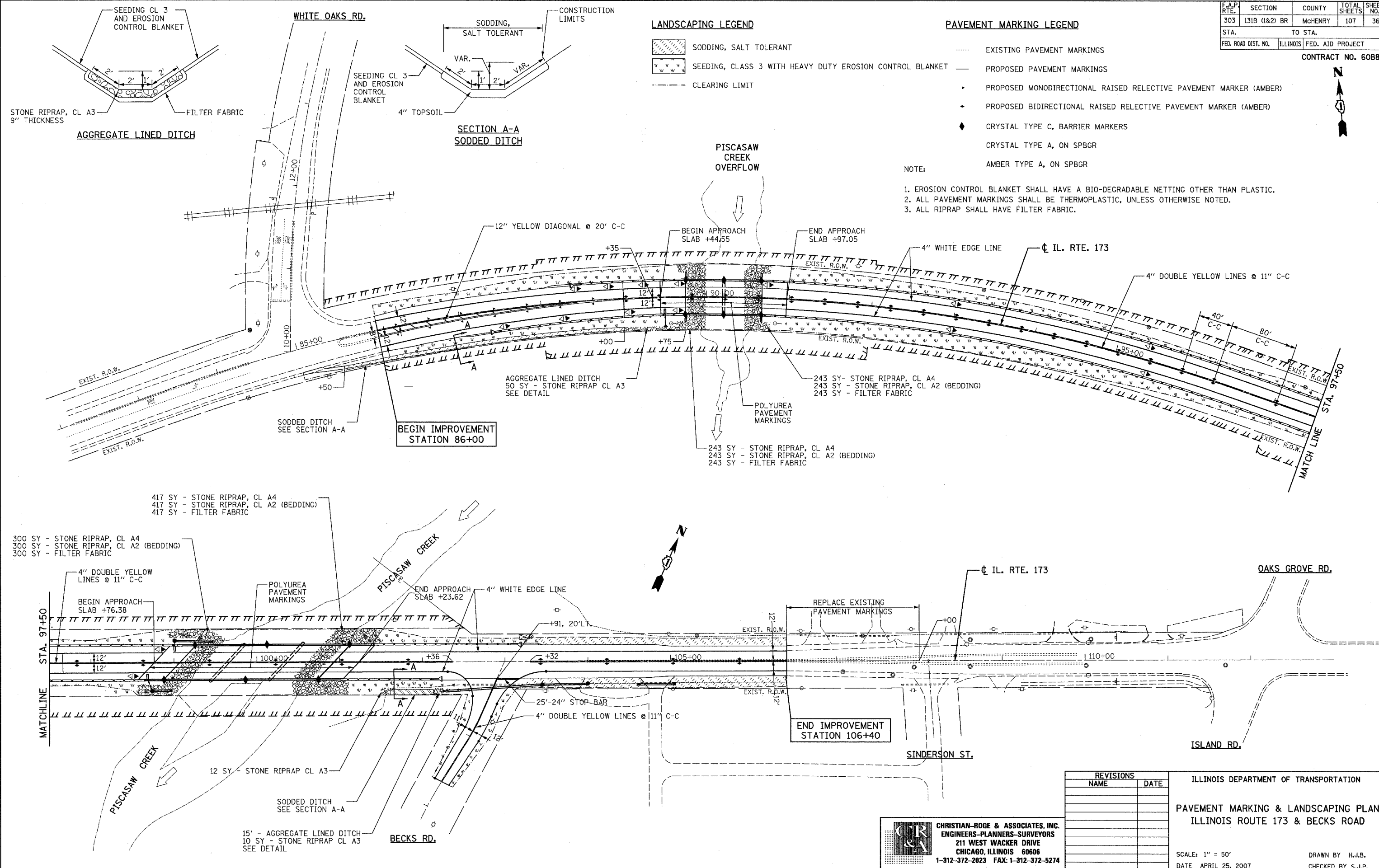

REVISIONS	
NAME	DATE

ILLINOIS DEPARTMENT OF TRANSPORTATION
 PAVEMENT MARKING & LANDSCAPING PLAN
 ILLINOIS ROUTE 173 & BECKS ROAD

SCALE: 1" = 50'
 DATE: APRIL 25, 2007
 DRAWN BY: H.J.B.
 CHECKED BY: S.J.P.

CR & A
 CHRISTIAN-ROGE & ASSOCIATES, INC.
 ENGINEERS-PLANNERS-SURVEYORS
 211 WEST WACKER DRIVE
 CHICAGO, ILLINOIS 60606
 1-312-372-2023 FAX: 1-312-372-5274