

F.A.U. RTE.	SECTION	COUNTY	TOTAL SHEETS	SHEET NO.
1374	0406 WRS	COOK	43	1

+1
44

D-91-106-07



LOCATION OF SECTION INDICATED THUS: - [Symbol] -

STATE OF ILLINOIS
DEPARTMENT OF TRANSPORTATION
DIVISION OF HIGHWAYS

**PROPOSED
HIGHWAY PLANS**
**F.A.U. 1374: BELMONT AVENUE
AT PLAINFIELD AVENUE**
SECTION: 0406 WRS
**WIDENING, RESURFACING &
TRAFFIC SIGNAL INSTALLATION**
COOK COUNTY
C-91-106-07

FOR INDEX OF SHEETS, SEE SHEET NO. 2

IMPROVEMENT IS LOCATED IN THE CITY OF CHICAGO AND THE VILLAGE OF RIVER GROVE

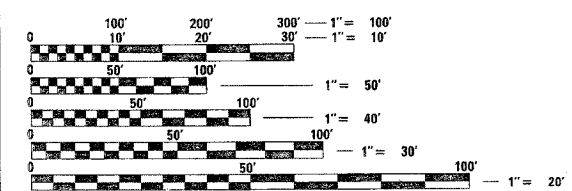

FULL SIZE PLANS HAVE BEEN PREPARED USING STANDARD ENGINEERING SCALES. REDUCED SIZED PLANS WILL NOT CONFORM TO STANDARD SCALES. IN MAKING MEASUREMENTS ON REDUCED PLANS, THE ABOVE SCALES MAY BE USED.

J.U.L.I.E.
JOINT UTILITY LOCATION INFORMATION FOR EXCAVATION
1-800-892-0123

IMPROVEMENT BEGINS
STA. 94+70

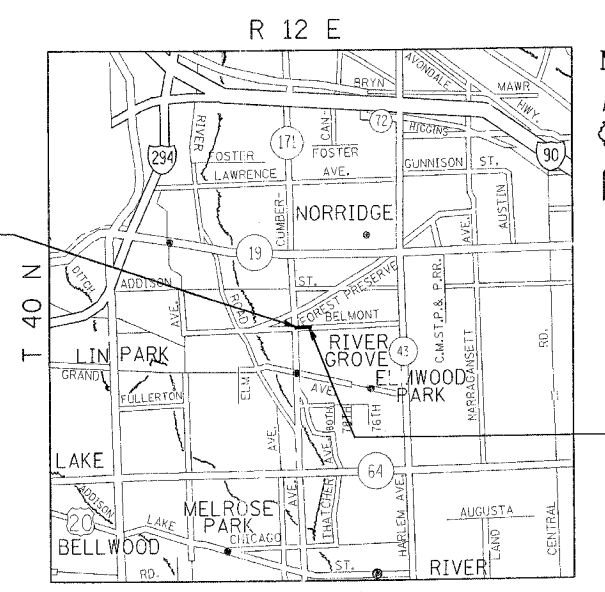

TRAFFIC DATA
SPEED LIMIT: 35 MPH
2002 ADT: 21,100

IMPROVEMENT ENDS
STA. 104+75

LEYDEN TOWNSHIP

GROSS & NET LENGTH OF IMPROVEMENT = 1,005 FEET (0.2 MILE)

STATE OF ILLINOIS
DEPARTMENT OF TRANSPORTATION
DIVISION OF HIGHWAYS

SUBMITTED April 10 20 07

Diane O'Keefe
DEPUTY DIRECTOR OF HIGHWAYS, REGION ENGINEER

May 11, 20 07
Eric E. Haranto
INTERIM ENGINEER OF DESIGN AND ENVIRONMENT

May 11, 20 07
Milton R. Sewell
DIRECTOR OF HIGHWAY, CHIEF ENGINEER

**PRINTED BY THE AUTHORITY
OF THE STATE OF ILLINOIS**

DISTRICT ONE-PLAN PREPARATION ENGINEER K. ENG / LONG TRAN (847) 705-4240