

F.A.P. RTE.	SECTION	COUNTY	TOTAL SHEETS	SHEET NO.
531	40X-RS-4	WILL	18	1

STATE OF ILLINOIS  
DEPARTMENT OF TRANSPORTATION  
DIVISION OF HIGHWAYS

**PROPOSED HIGHWAY PLANS**

F.A.P. ROUTE 531: MANHATTAN-MONEE ROAD

SCHEER ROAD TO CENTER ROAD

SECTION: 40X-RS-8

RESURFACING (3P)

WILL COUNTY

C-91-300-07

FOR INDEX OF SHEETS, SEE SHEET NO. 2

IMPROVEMENT IS LOCATED IN UNINCORPORATED WILL COUNTY

D-91-300-07

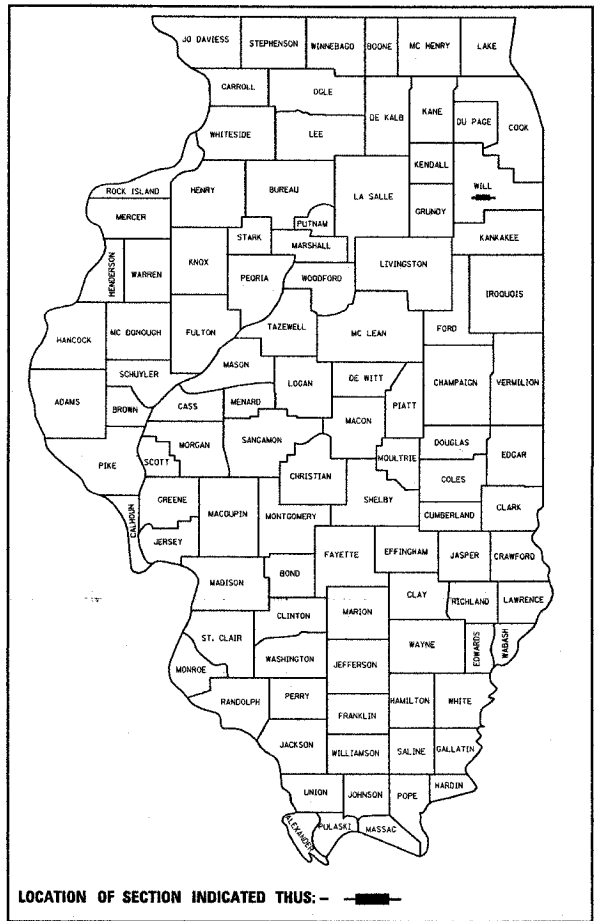

LOCATION OF SECTION INDICATED THUS: —

IMPROVEMENT BEGINS: STATION 55+16

BRIDGE OMISSION: STA. 83+27 TO STA. 84+44

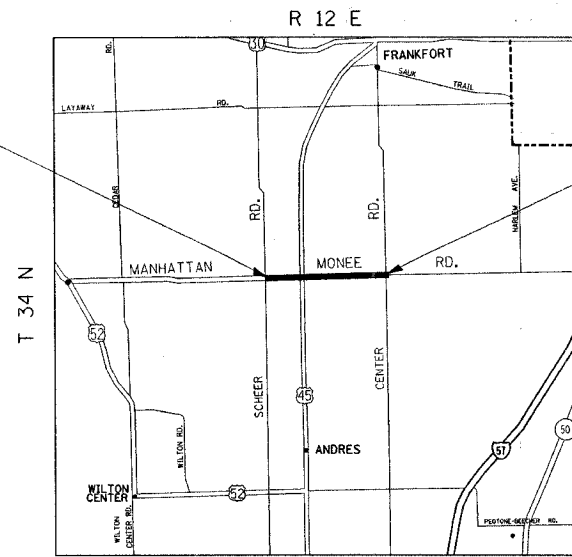

IMPROVEMENT ENDS: STATION 214+16

TRAFFIC DATA

2004 ADT = 3,900

SPEED LIMIT = 45 MPH

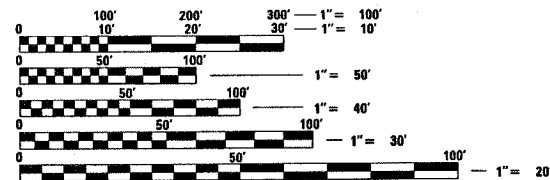

FULL SIZE PLANS HAVE BEEN PREPARED USING STANDARD ENGINEERING SCALES. REDUCED SIZED PLANS WILL NOT CONFORM TO STANDARD SCALES. IN MAKING MEASUREMENTS ON REDUCED PLANS, THE ABOVE SCALES MAY BE USED.

J.U.L.I.E.  
JOINT UTILITY LOCATION INFORMATION FOR EXCAVATION  
1-800-892-0123

GROSS LENGTH OF IMPROVEMENT = 15,900 FT. (3.01 MI.)

NET LENGTH OF IMPROVEMENT = 15,783 FT. (2.99 MI.)

CONTRACT NO. 60C62

STATE OF ILLINOIS  
DEPARTMENT OF TRANSPORTATION  
DIVISION OF HIGHWAYS

SUBMITTED April 12, 2007

[Signature]  
DEPUTY DIRECTOR OF HIGHWAYS, REGION ENGINEER

May 11, 2007  
[Signature]  
INTERIM ENGINEER OF DESIGN AND ENVIRONMENT

May 11, 2007  
[Signature]  
DIRECTOR OF HIGHWAYS, CHIEF ENGINEER

PRINTED BY THE AUTHORITY  
OF THE STATE OF ILLINOIS

DISTRICT ONE - PLAN PREPARATION ENGINEER: KEN ENG/JENPAI CHANG (847) 705-4432