

F.A.P. RTE.	SECTION	COUNTY	TOTAL SHEETS	SHEET NO.
303	136 RS-4	LAKE	25	9
STA. 75+00		TO STA. 98+20		
FED. ROAD DIST. NO. 1 ILLINOIS FED. AID PROJECT				

CONTRACT NO. 60D10

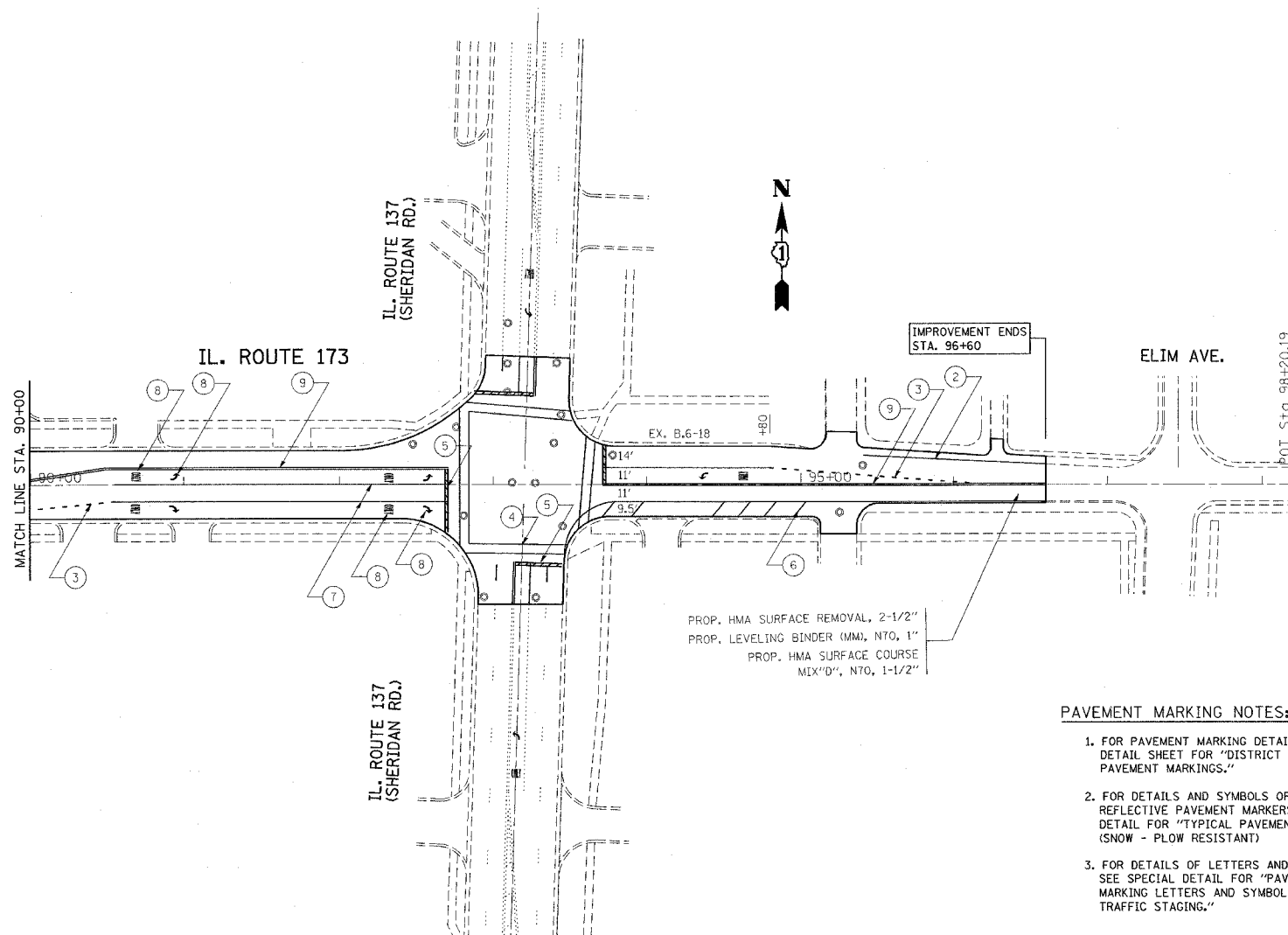
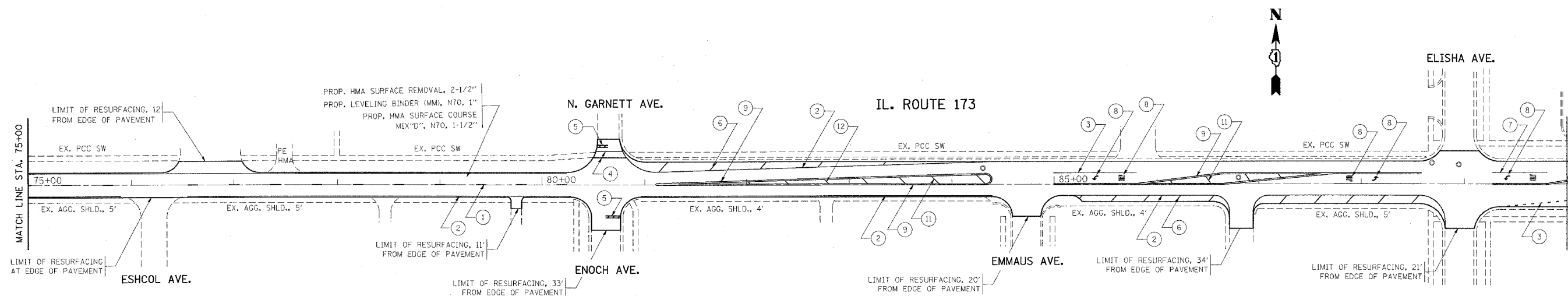

PAVEMENT MARKING LEGEND

- | | |
|--|---|
| <ul style="list-style-type: none"> ① THERMOPLASTIC PAVEMENT MARKING SKIP-DASH LINE, 4" YELLOW ② THERMOPLASTIC PAVEMENT MARKING EDGE LINE, 4" SOLID WHITE ③ THERMOPLASTIC PAVEMENT MARKING DOTTED LANE LINE, 6" WHITE ④ THERMOPLASTIC PAVEMENT MARKING CROSS-WALK LINE, 6" SOLID WHITE, 2@6' C-C AND 4' IN ADVANCE OF STOP BAR ⑤ THERMOPLASTIC PAVEMENT MARKING 24" SOLID WHITE STOP BAR ⑥ THERMOPLASTIC PAVEMENT MARKING SHOULDER DIAGONAL, 12" @ 45° SPACING 20' C-C SOLID YELLOW ⑦ THERMOPLASTIC PAVEMENT MARKING LANE LINE, 6" SOLID WHITE | <ul style="list-style-type: none"> ⑧ THERMOPLASTIC PAVEMENT MARKING LEFT AND RIGHT TURN ONLY LETTERS AND SYMBOLS, 8" WHITE ⑨ THERMOPLASTIC PAVEMENT MARKING MEDIAN EDGE LINE, 4" SOLID YELLOW (DOUBLE) ⑩ THERMOPLASTIC PAVEMENT MARKING SCHOOL CROSSING, 12" @ 90° SOLID WHITE AND 2' APART ⑪ THERMOPLASTIC PAVEMENT MARKING NO PASSING ZONE LINES, 5-1/2" C-C FROM SKIP-DASH CENTERLINE 11" C-C YELLOW ⑫ THERMOPLASTIC PAVEMENT MARKING MEDIAN DIAGONAL, 12" @ 45° (MINIMUM OF 5 EQUALLY SPACED DIAGONAL LINES) |
|--|---|

PAVEMENT MARKING NOTES:

1. FOR PAVEMENT MARKING DETAILS SEE SPECIAL DETAIL SHEET FOR "DISTRICT ONE TYPICAL PAVEMENT MARKINGS."
2. FOR DETAILS AND SYMBOLS OF RAISED REFLECTIVE PAVEMENT MARKERS SEE SPECIAL DETAIL FOR "TYPICAL PAVEMENT MARKERS" (SNOW - PLOW RESISTANT)
3. FOR DETAILS OF LETTERS AND SYMBOLS SEE SPECIAL DETAIL FOR "PAVEMENT MARKING LETTERS AND SYMBOLS FOR TRAFFIC STAGING."

REVISIONS	
NAME	DATE

ILLINOIS DEPARTMENT OF TRANSPORTATION
ILL 173
LEWIS AVE. TO IL. 137 (SHERIDAN AVE.)
EXISTING AND PROPOSED
ROADWAY AND PAVEMENT MARKING PLANS
 SCALE: VERT. 1"=50'
 HORIZ. 1"=50'
 DATE 4/25/2007
 DRAWN BY
 CHECKED BY

PLOT DATE = 4/25/2007
 FILE NAME = c:\projects\ill137\ill137.dwg
 PLOT SCALE = 1/8"=1'-0"
 USER NAME = gurekshya