

F.A.P. RTE.	SECTION	COUNTY	TOTAL SHEETS	SHEET NO.
344	3034N-1	COOK	71	3
FED. ROAD DIST. NO. 1		ILLINOIS	HIGHWAY PROJECT	

SUMMARY OF QUANTITIES			HSIP				F			
CODE NO	ITEM	UNIT	URBAN TOTAL QUANTITIES	CONSTRUCTION TYPE CODE						
				1000-2A 90% FED. 10% STATE	Y031-IF TRAFFIC 90% FED. 5% STATE 5% CITY	Y031-IF TRAFFIC 100% CITY	Y030-IE LIGHTING 80% FED. (STP-U) 20% CITY			
20100110	TREE REMOVAL (6 TO 15 UNITS DIAMETER)	UNIT	70	70						
20100210	TREE REMOVAL (OVER 15 UNITS DIAMETER)	UNIT	307	307						
20101000	TEMPORARY FENCE	FOOT	744	744						
20101300	TREE PRUNING (1 TO 10 INCH DIAMETER)	EACH	5	5						
20101350	TREE PRUNING (OVER 10 INCH DIAMETER)	EACH	5	5						
* 20101700	SUPPLEMENTAL WATERING	UNIT	17	17						
20200500	EARTH EXCAVATION (WIDENING)	CU YD	1504	1504						
20201200	REMOVAL AND DISPOSAL OF UNSUITABLE MATERIAL	CU YD	275	275						
20800150	TRENCH BACKFILL	CU YD	845	845						
* 21101615	TOPSOIL FURNISH AND PLACE, 4"	SQ YD	1865	1865						
21300010	EXPLORATION TRENCH, SPECIAL	FOOT	200				200			
* 25000400	NITROGEN FERTILIZER NUTRIENT	POUND	24	24						
* 25000500	PHOSPHORUS FERTILIZER NUTRIENT	POUND	24	24						
* 25000600	POTASSIUM FERTILIZER NUTRIENT	POUND	24	24						
25000750	MOWING	ACRE	0.5	0.5						
* 25200110	SODDING, SALT TOLERANT	SQ YD	1865	1865						
28000510	INLET FILTERS	EACH	42	42						
31101200	SUB-BASE GRANULAR MATERIAL, TYPE B 4"	SQ YD	2023	2023						
35400400	PORTLAND CEMENT CONCRETE BASE COURSE WIDENING 9"	SQ YD	1650	1650						
35501308	HOT-MIX ASPHALT BASE COURSE, 6"	SQ YD	137	137						
40600200	BITUMINOUS MATERIALS (PRIME COAT)	TON	8	8						
40600300	AGGREGATE (PRIME COAT)	TON	40	40						
40600400	MIXTURE FOR CRACKS, JOINTS, AND FLANGEWAYS	TON	3	3						
40600895	CONSTRUCTING TEST STRIP	EACH	1	1						
40600982	HOT-MIX ASPHALT SURFACE REMOVAL - BUTT JOINT	SQ YD	88	88						
40601005	HOT-MIX ASPHALT REPLACEMENT OVER PATCHES	TON	99	99						
40603310	HOT-MIX ASPHALT SURFACE COURSE, MIX "C", N50	TON	16	16						

SUMMARY OF QUANTITIES			HSIP				F			
CODE NO	ITEM	UNIT	URBAN TOTAL QUANTITIES	CONSTRUCTION TYPE CODE						
				1000-2A 90% FED. 10% STATE	Y031-IF TRAFFIC 90% FED. 5% STATE 5% CITY	Y031-IF TRAFFIC 100% CITY	Y030-IE LIGHTING 80% FED. (STP-U) 20% CITY			
40603340	HOT-MIX ASPHALT SURFACE COURSE, MIX "D", N70	TON	824	824						
42300200	PORTLAND CEMENT CONCRETE DRIVEWAY PAVEMENT, 6 INCH	SQ YD	180	180						
42400200	PORTLAND CEMENT CONCRETE SIDEWALK 5 INCH	SQ FT	15337	15337						
42400800	DETECTABLE WARNINGS	SQ FT	60	60						
44000159	HOT-MIX ASPHALT SURFACE REMOVAL, 2 1/2"	SQ YD	8156	8156						
44000200	DRIVEWAY PAVEMENT REMOVAL	SQ YD	390	390						
44000500	COMBINATION CURB AND GUTTER REMOVAL	FOOT	3481	3481						
44000600	SIDEWALK REMOVAL	SQ FT	10955	10955						
44003510	MEDIAN REMOVAL PARTIAL DEPTH	SQ FT	3938	3938						
44201753	CLASS D PATCHES, TYPE II, 9 INCH	SQ YD	756	756						
44201757	CLASS D PATCHES, TYPE III, 9 INCH	SQ YD	19	19						
44201759	CLASS D PATCHES, TYPE IV, 9 INCH	SQ YD	367	367						
50300300	PROTECTIVE COAT	SQ YD	2479	2479						
550A0050	STORM SEWERS, CLASS A, TYPE 1 12"	FOOT	340	340						
550A0360	STORM SEWERS, CLASS A, TYPE 2 15"	FOOT	367	367						
550A0380	STORM SEWERS, CLASS A, TYPE 2 18"	FOOT	190	190						
60107600	PIPE UNDERDRAINS 4"	FOOT	200	200						
60201330	CATCH BASINS, TYPE A, 4'-DIAMETER, TYPE 23 FRAME AND GRATE	EACH	22	22						
60218300	MANHOLES, TYPE A, 4'-DIAMETER, TYPE 1 FRAME, OPEN LID	EACH	5	5						
60218400	MANHOLES, TYPE A, 4'-DIAMETER, TYPE 1 FRAME, CLOSED LID	EACH	6	6						
60240327	INLETS, TYPE B, TYPE 23 FRAME AND GRATE	EACH	6	6						
60250200	CATCH BASINS TO BE ADJUSTED	EACH	10	10						
60300310	FRAMES AND LIDS TO BE ADJUSTED (SPECIAL)	EACH	16	16						
60500040	REMOVING MANHOLES	EACH	2	2						
60500050	REMOVING CATCH BASINS	EACH	12	12						
60500060	REMOVING INLETS	EACH	2	2						
60603800	COMBINATION CONCRETE CURB AND GUTTER, TYPE B-6.12	FOOT	3481	3481						
67000400	ENGINEER'S FIELD OFFICE, TYPE A	CAL MO	9	9						
67100100	MOBILIZATION	L SUM	1	1						

1/10/2007

©NON-PARTICIPATING
*SPECIALTY ITEMS

Rev. 6-1-07

REVISIONS	
NAME	DATE

ILLINOIS DEPARTMENT OF TRANSPORTATION
SUMMARY OF QUANTITIES
127TH ST. AT MAPLE AVE.

PLOT DATE: 1/10/2007

F.A.P. RTE.	SECTION	COUNTY	TOTAL SHEETS	SHEET NO.
344	3034 N-1	COOK	71	6
FED. ROAD DIST. NO. 1		ILLINOIS	HIGHWAY PROJECT	

SUMMARY OF QUANTITIES			CONSTRUCTION TYPE CODE					SUMMARY OF QUANTITIES			CONSTRUCTION TYPE CODE				
CODE NO	ITEM	UNIT	URBAN TOTAL QUANTITIES	I000-2A 90% FED. 10% STATE	Y031-IF TRAFFIC 90% FED. 5% STATE 5% CITY		Y030-IE LIGHTING 80% FED. (STP-U) 20% CITY								
* 88030100	SIGNAL HEAD ,LED, 1-FACE, 5-SECTION, BRACKET MOUNTED	EACH	4		4										
* 88030110	SIGNAL HEAD ,LED, 1-FACE, 5-SECTION, MAST-ARM MOUNTED	EACH	4		4										
* 88102740	PEDESTRIAN SIGNAL HEAD, LED, 2-FACE, BRACKET MOUNTED	EACH	4		4										
* XX001363	PERENNIAL PLANT, NARCISSUS	UNIT	1	1											
* XX001399	UNIT DUCT, BORED AND PULLED	FOOT	3145				3145								
* XX002852	RE-OPTIMIZE TRAFFIC SIGNAL SYSTEM	EACH	1		1										
Z0001050	AGGREGATE SUBGRADE 12"	SQ YD	2424	2424											
Z0013798	CONSTRUCTION LAYOUT	L SUM	1	1											
⊙ Z0018500	DRAINAGE STRUCTURES TO BE CLEANED	EACH	35	35											
B2005214	TREE, MALUS SUTYZAN (SUGAR TYME CRABAPPLE), 2" CALIPER, TREE FORM, BALLED AND BURLAPPED	EACH	5	5											
B2005716	TREE, PYRUS CALLERYANA CHANTICLEER (CHANTICLEER CALLERY PEAR), 2" CALIPER, TREEFORM, BALLED & BURLAPPED	EACH	2	2											
B2010070	TREE, CLADRASTIS KENTUCKEA (AMERICAN YELLOWWOOD), 2" CALIPER, BALLED AND BURLAPPED	EACH	5	5											
* A2005700	TREE, PARROTIA PERSICA (PERSIAN PARROTIA) 2 1/2" CALIPER, TREE FORM, BALLED AND BURLAPPED	EACH	4	4											
A2007250	TREE, ROBINIA PSEUDOACACIA PURPLE ROBE (PURPLE ROBE BLACK LOCUST), 2" CALIPER, BALLED AND BURLAPPED	EACH	4	4											
XX005056	INLET FILTER CLEANING	EACH	96	96											
● Z0076600	TRAINEES	HOUR	1000	1000											
X6020090	MANHOLES WITH RESTRICTOR PLATE	EACH	2	2											
* X0322033	STORM SEWER (WATER MAIN REQUIREMENTS) 12 INCH	FOOT	162	162											

⊙ NON-PARTICIPATING
 * SPECIALTY ITEMS
 ● Y080

REVISIONS	
NAME	DATE

ILLINOIS DEPARTMENT OF TRANSPORTATION
 SUMMARY OF QUANTITIES
 127TH ST. AT MAPLE AVE.

△ Rev. 6-1-07

PLOT DATE: 1/9/2007

*REF-drain05
*REF-drain06

CONTRACT NO. 62719

F.A.P. R.T.E.	SECTION	COUNTY	TOTAL SHEETS	SHEET NO.
344	3034N-1	COOK	71	15
STA.	TO STA.			
FED. ROAD DIST. NO.	ILLINOIS FED. AID PROJECT			

- EXISTING**
- R** STRUCTURE TO BE REMOVED
 - AB** STORM SEWER TO BE PLUGGED AND ABANDONED
 - ADJ** STRUCTURE TO BE ADJUSTED
 - REL** RELOCATE STORM SEWER

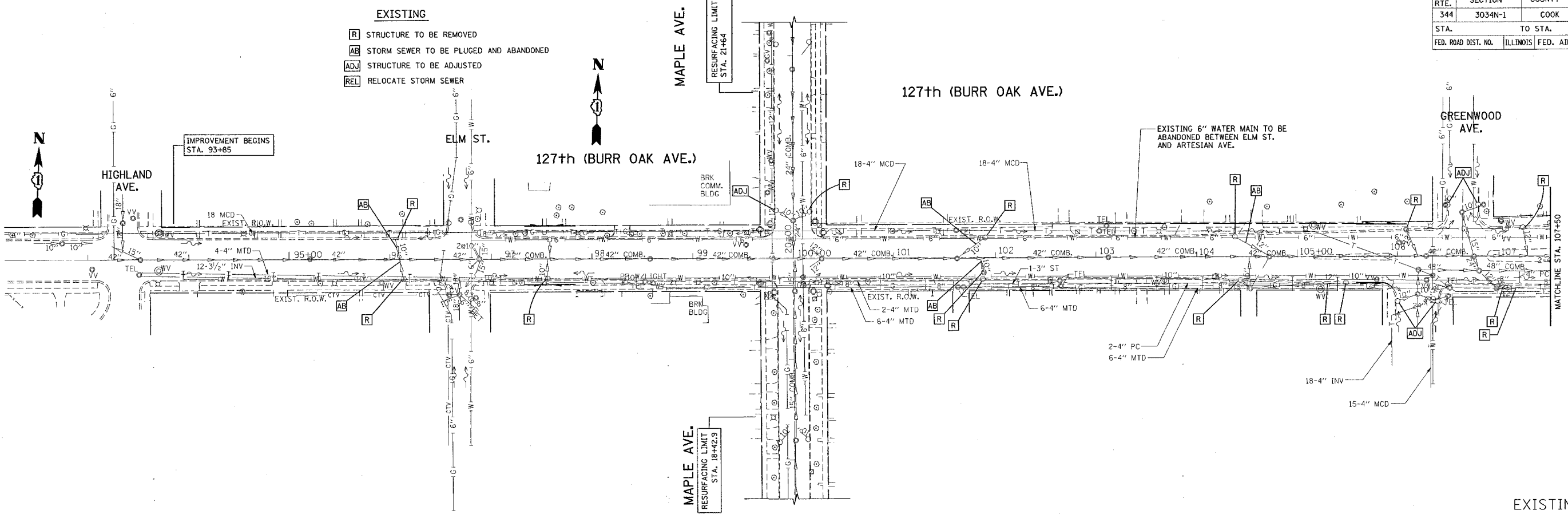

EXISTING

PROPOSED

- CATCH BASIN
- MANHOLE
- STORM SEWER

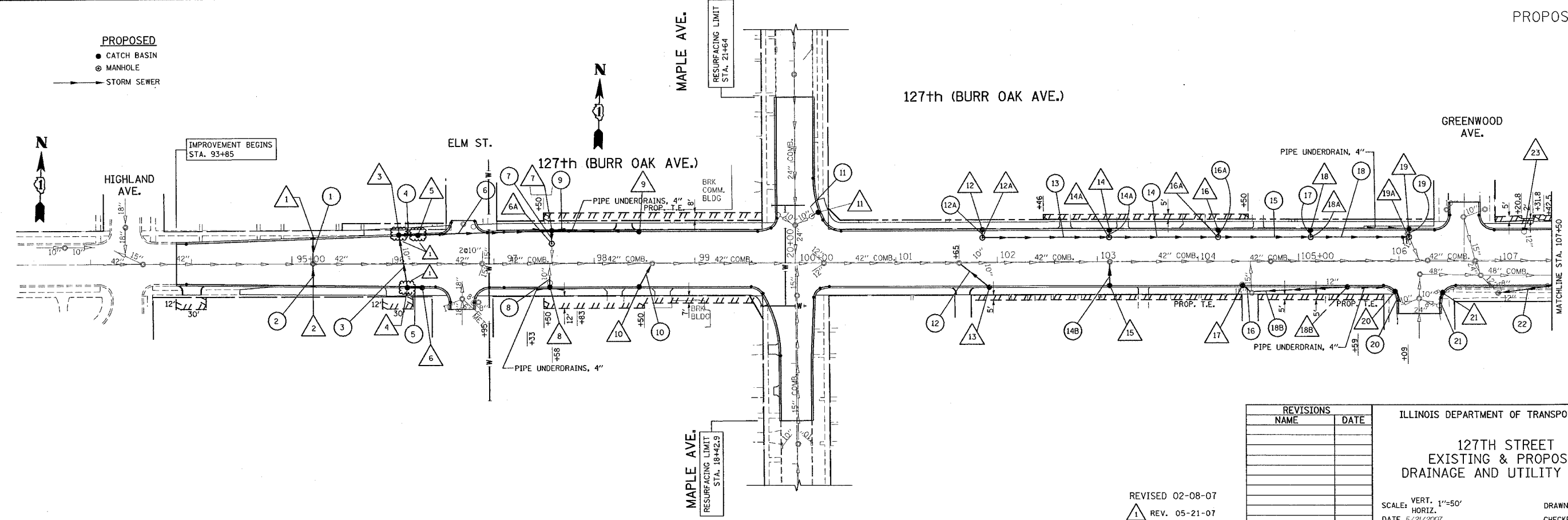

PROPOSED

REVISIONS	
NAME	DATE

ILLINOIS DEPARTMENT OF TRANSPORTATION

127TH STREET
EXISTING & PROPOSED
DRAINAGE AND UTILITY PLANS

SCALE: VERT. 1"=50'
HORIZ. DATE 5/21/2007

DRAWN BY
CHECKED BY

REVISED 02-08-07
△ REV. 05-21-07

PLOT DATE = 5/21/2007
FILE NAME = K:\100405\127th.drain.dgn
PLOT SCALE = 50.0000 / IN.
USER NAME = jays

F.A.P. RTE.	SECTION	COUNTY	TOTAL SHEETS	SHEET NO.
344	3034N-1	COOK	71	18
STA.		TO STA.		
FED. ROAD DIST. NO. 1		ILLINOIS FED. AID PROJECT		

127th ST. AT MAPLE AVENUE
LIST OF DRAINAGE STRUCTURES

127th ST. AT MAPLE AVENUE
LIST OF STORM SEWER PIPES

1 INLET TYPE B, TYPE 23, FRAME AND GRATE STA. 95+21, 24' LT. T.G. (TOP OF GRATE) = 636.57 INV. EL. (INVERT) = 632.57

11 CATCH BASIN, TYPE A, 4' DIA. TYPE 23, FRAME AND GRATE STA. 100+23, 50' LT. T.G. = 635.64 INV. =

18A MANHOLE, TYPE A, 4' DIA. TYPE 1, FRAME CLOSED LID STA. 101+85, 24' LT. T.G. = 631.90 INV. = 626.08

2 INLET TYPE B, TYPE 23, FRAME AND GRATE STA. 95+21, 22' RT. T.G. = 636.60 INV. = 632.60

12 CATCH BASIN, TYPE A, 4' DIA. TYPE 23, FRAME AND GRATE STA. 101+85, 31' LT. T.G. = 634.55 INV. = 627.26

18B CATCH BASIN, TYPE A, 4' DIA. TYPE 23, FRAME AND GRATE STA. 105+48, 24' RT. T.G. = 631.64 INV. = 628.83

3 CATCH BASIN, TYPE A, 4' DIA. TYPE 23, FRAME AND GRATE STA. 96+06, 28' LT. T.G. = 635.77 INV. = 630.32

12A MANHOLE, TYPE A, 4' DIA. TYPE 1, FRAME CLOSED LID STA. 101+85, 31' LT. T.G. = 634.67 INV. = 627.22

19 CATCH BASIN, TYPE A, 4' DIA. TYPE 23, FRAME AND GRATE STA. 106+10, 31' LT. T.G. = 631.32 INV. = ----- (W) ----- (S)

4 CATCH BASIN, TYPE A, 4' DIA. TYPE 23, FRAME AND GRATE STA. 96+14, 24' RT. T.G. = 635.83 INV. = 630.83

13 CATCH BASIN, TYPE A, 4' DIA. TYPE 23, FRAME AND GRATE STA. 101+92, 25' RT. T.G. = 634.58 INV. = 627.49

19A MANHOLE, TYPE A, 4' DIA. TYPE 1, FRAME CLOSED LID WITH RESTRICTOR AS PER RESTRICTOR DETAIL STA. 106+10, 24' LT. T.G. = 631.44 INV. = 625.70

5 CATCH BASIN, TYPE A, 4' DIA. TYPE 23, FRAME AND GRATE STA. 96+25, 28' LT. T.G. = 635.72 INV. = 630.22

14 CATCH BASIN, TYPE A, 4' DIA. TYPE 23, FRAME AND GRATE STA. 103+12, 31' LT. T.G. = 633.48 INV. = 626.81

20 CATCH BASIN, TYPE A, 4' DIA. TYPE 23, FRAME AND GRATE STA. 105+96, 30' RT. T.G. = 631.39 INV. = 626.65

6 CATCH BASIN, TYPE A, 4' DIA. TYPE 23, FRAME AND GRATE STA. 96+29, 24' RT. T.G. = 635.70 INV. = 630.98

14A MANHOLE, TYPE A, 4' DIA. TYPE 1, FRAME CLOSED LID STA. 101+85, 24' LT. T.G. = 633.60 INV. = 626.78

21 CATCH BASIN, TYPE A, 4' DIA. TYPE 23, FRAME AND GRATE STA. 106+43, 31' RT. T.G. = 631.22 INV. = 626.22

6A MANHOLE, TYPE A, 4' DIA. TYPE 1, FRAME AND GRATE CLOSED LID WITH RESTRICTOR AS PER RESTRICTOR DETAIL "A" STA. 96+29, 24' RT. T.G. = 635.70 INV. = 629.5

15 CATCH BASIN, TYPE A, 4' DIA. TYPE 23, FRAME AND GRATE STA. 103+12, 24' RT. T.G. = 633.59 INV. = 626.81

22 CATCH BASIN, TYPE A, 4' DIA. TYPE 23, FRAME AND GRATE STA. 107+53, 24' RT. T.G. = 630.79 INV. = 626.29

7 CATCH BASIN, TYPE A, 4' DIA. TYPE 23, FRAME AND GRATE STA. 97+58, 31' LT. T.G. = 635.52 INV. = 629.55 (S,E,W)

16 CATCH BASIN, TYPE A, 4' DIA. TYPE 23, FRAME AND GRATE STA. 104+20, 31' LT. T.G. = 632.53 INV. = 626.44

23 INLET, TYPE B, TYPE 23 FRAME AND GRATE STA. 108+00, 24' RT. T.G. = 631.10 INV. = 625.98

8 CATCH BASIN, TYPE A, 4' DIA. TYPE 23, FRAME AND GRATE STA. 97+56, 24' RT. T.G. = 635.48 INV. = 629.05

16A MANHOLE, TYPE A, 4' DIA. TYPE 1, FRAME CLOSED LID STA. 101+85, 24' LT. T.G. = 633.60 INV. = 626.40

24 CATCH BASIN, TYPE A, 4' DIA. TYPE 23, FRAME AND GRATE STA. 108+24, 24' RT. T.G. = 630.99 INV. = 625.90

9 CATCH BASIN, TYPE A, 4' DIA. TYPE 23, FRAME AND GRATE STA. 98+45, 31' LT. T.G. = 635.68 INV. = 629.78

17 CATCH BASIN, TYPE A, 4' DIA. TYPE 23, FRAME AND GRATE STA. 104+44, 24' RT. T.G. = 632.43 INV. = 627.29

25 INLET, TYPE B, TYPE 23 FRAME AND GRATE STA. 109+30, 24' RT. T.G. = 631.39 INV. = 626.89

10 CATCH BASIN, TYPE A, 4' DIA. TYPE 23, FRAME AND GRATE STA. 98+45, 24' RT. T.G. = 635.79 INV. = 629.50

18 CATCH BASIN, TYPE A, 4' DIA. WITH FRAME AND GRATE, TYPE 23 STA. 105+12, 31' LT. T.G. = 631.78 INV. = 626.11

1 STORM SEWER, CL-A, TY.-1, 12" STA. 95+21 (LATERAL) 24', 12" DIA. @ 0.5% T.B. = 22 CU. YD.

12 STORM SEWER, WATER MAIN REQUIREMENTS, 12" STA. 101+92 TO STA. 101+86 (LATERAL) 55', 12" DIA. @ 0.5% T.B. = 56 CU. YD.

18 STORM SEWER, CL-A, TY.-2, 18" STA. 105+12 TO STA. 106+10 98', 18" DIA. @ 0.35% T.B. = 83 CU. YD.

2 STORM SEWER, WATER MAIN REQUIREMENTS, 12" STA. 95+21 (LATERAL) 28', 12" DIA. @ 1.5% T.B. = 10 CU. YD.

12A STORM SEWER, CL-A, TY.-2, 12" STA. 101+86 TO STA. 103+12 (LATERAL) 5', 12" DIA. @ 0.5% T.B. = 5 CU. YD.

18B STORM SEWER, CL-A, TY.-2, 12" STA. 104+53 TO STA. 105+48 95', 12" DIA. @ 0.35%

3 STORM SEWER, WATER MAIN REQUIREMENTS, 12" STA. 96+14 TO STA. 96+06 (LATERAL) 52', 12" DIA. @ 1.5% T.B. = 38 CU. YD.

13 STORM SEWER, CL-A, TY.-2, 15" STA. 101+86 TO STA. 103+12 126', 15" DIA. @ 0.35% T.B. = 126 CU. YD.

19 STORM SEWER, CL-A, TY.-1, 12" STA. 106+10 (LATERAL) 7', 12" DIA. @ 0.35% T.B. = 60 CU. YD.

4 STORM SEWER, CL-A, TY.-2, 15" STA. 96+06 TO 96+25 19', 15" DIA. @ 0.5% T.B. = 15 CU. YD.

14 STORM SEWER, CL-A, TY.-2, 15" STA. 103+12 TO STA. 104+20 108', 15" DIA. @ 0.35% T.B. = 92 CU. YD.

20 STORM SEWER, CL-A, TY.-1, 12" STA. 105+96 (30' RT.) (LATERAL) 14', 12" DIA. @ 0.5%

5 STORM SEWER, CL-A, TY.-2, 15" STA. 96+14 TO 96+29 15', 15" DIA. @ 0.5% T.B. = 12 CU. YD.

14A STORM SEWER, CL-A, TY.-2, 15" STA. 103+12 (LATERAL) NORTH 5', 12" DIA. @ 0.5% T.B. = 4 CU. YD.

21 STORM SEWER, CL-A, TY.-1, 12" STA. 106+43 (31' RT.) 12', 12" DIA. @ 0.5%

6 STORM SEWER, CL-A, TY.-2, 15" STA. 96+25 TO 97+58 133', 15" DIA. @ 0.5% T.B. = 106 CU. YD.

14B STORM SEWER, WATER MAIN REQUIREMENTS, 12" STA. 103+12 (LATERAL) SOUTH 24', 12" DIA. @ 0.5% T.B. = 20 CU. YD.

22 STORM SEWER, CL-A, TY.-1, 12" STA. 107+53 TO STA. 106+97 66', 12" DIA. @ 0.5%

7 STORM SEWER, CL-A, TY.-2, 15" STA. 97+58 (LATERAL) (N) 12', 12" DIA. @ 1.5% T.B. = 10 CU. YD.

15 STORM SEWER, CL-A, TY.-2, 18" STA. 104+20 TO STA. 105+12 92', 18" DIA. @ 0.35% T.B. = 78 CU. YD.

23 STORM SEWER, CL-A, TY.-1, 12" STA. 108+00 TO STA. 108+24 24', 12" DIA. @ 0.5% T.B. = 7 CU. YD.

8 STORM SEWER, CL-A, TY.-2, 10" STA. 97+58 (LATERAL) (S) 6', 12" DIA. @ 1.5% T.B. = 5 CU. YD.

16 STORM SEWER, CL-A, TY.-1, 12" STA. 104+45 TO STA. 104+54 10', 12" DIA. @ 0.5%

9 STORM SEWER, CL-A, TY.-2, 15" STA. 98+45 TO STA. 97+58 (N) 87', 15" DIA. @ 1.5% T.B. = 68 CU. YD.

16A STORM SEWER, CL-A, TY.-2, 12" STA. 104+45 (LATERAL) NORTH 5', 12" DIA. @ 0.5% T.B. = 5 CU. YD.

10 STORM SEWER, WATER MAIN REQUIREMENTS, 12" STA. 98+45 TO STA. 98+58 (LATERAL) 24', 15" DIA. @ 1.5% T.B. = 19 CU. YD.

17 STORM SEWER, CL-A, TY.-1, 12" STA. 105+12 5', 12" DIA. @ 0.5% T.B. = 4 CU. YD.

11 STORM SEWER, CL-A, TY.-2, 12" STA. 100+23 (LATERAL) (N) 8', 12" DIA. @ 0.5% T.B. = 8 CU. YD.

REVISIONS	
NAME	DATE

ILLINOIS DEPARTMENT OF TRANSPORTATION
127TH STREET @ MAPLE AVENUE
DRAINAGE PIPE AND STRUCTURE
TABLE

SCALE: VERT. N/A
HORIZ. DATE 5/22/2007
DRAWN BY
CHECKED BY

PLOT DATE = 5/22/2007
FILE NAME = c:\projects\100483\ah_drain.dgn
USER NAME = drakeoan

REV. 05-21-07