

F.A.U. RTE.	SECTION	COUNTY	TOTAL SHEETS	SHEET NO
344	3034N-1	COOK	71	31
STA.		TO STA.		
FED. ROAD DIST. NO.		ILLINOIS	FED. AID PROJECT.	

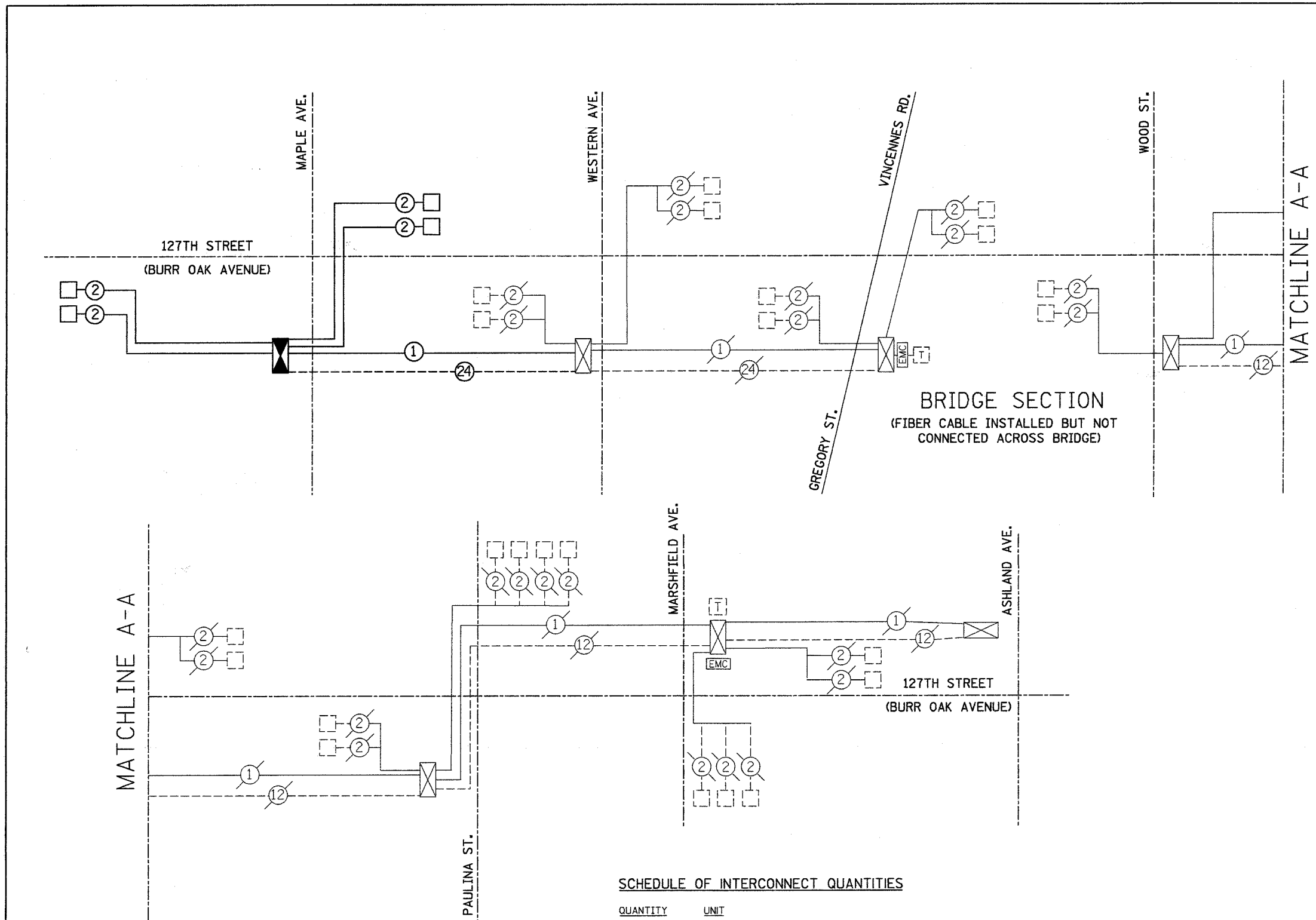

- INTERCONNECT SCHEMATIC LEGEND**
- EXISTING INTERSECTION CONTROLLER
 - PROPOSED INTERSECTION CONTROLLER
 - EXISTING MASTER CONTROLLER
 - PROPOSED MASTER CONTROLLER
 - MASTER MASTER CONTROLLER
 - EXISTING INTERSECTION & SAMPLING (SYSTEM) DETECTORS
 - PROPOSED INTERSECTION & SAMPLING (SYSTEM) DETECTORS
 - EXISTING INTERSECTION LOOP DETECTORS AND PROPOSED SAMPLING (SYSTEM) DETECTORS
 - EXISTING SAMPLING (SYSTEM) DETECTORS
 - PROPOSED SAMPLING (SYSTEM) DETECTORS
 - EXISTING SAMPLING (SYSTEM) DETECTORS, PROPOSED INTERSECTION & SAMPLING (SYSTEM) DETECTORS.
 - EXISTING SAMPLING (SYSTEM) DETECTORS, PROPOSED SAMPLING (SYSTEM) DETECTORS.
 - EXISTING PREFORMED INTERSECTION & SAMPLING (SYSTEM) DETECTORS
 - PROPOSED PREFORMED INTERSECTION & SAMPLING (SYSTEM) DETECTORS
 - EXISTING SAMPLING (SYSTEM) PREFORMED DETECTORS.
 - PROPOSED SAMPLING (SYSTEM) PREFORMED DETECTORS.
 - EXISTING FIBER OPTIC CABLE IN CONDUIT NO. 62.5/125 MM12F & SM12F
 - PROPOSED FIBER OPTIC CABLE IN CONDUIT NO. 62.5/125 MM12F & SM12F
 - EXISTING INTERCONNECT CABLE - NO. 62.5/125 12F. FIBER OPTIC CABLE
 - PROPOSED INTERCONNECT CABLE - NO. 62.5/125 12F FIBER OPTIC CABLE
 - EXISTING INTERCONNECT CABLE - NO. 18 3 PAIR TWISTED, SHIELDED
 - PROPOSED INTERCONNECT CABLE - NO. 18 3 PAIR TWISTED, SHIELDED
 - EXISTING LOOP DETECTOR CABLE - 2/C TWISTED, SHIELDED
 - PROPOSED LOOP DETECTOR CABLE - 2/C TWISTED, SHIELDED
 - EXISTING ELECTRIC CABLE 1/C (AS SPECIFIED)
 - PROPOSED ELECTRIC CABLE, 1/C (AS SPECIFIED)
 - EXISTING TELEPHONE CONNECTION
 - PROPOSED TELEPHONE CONNECTION

SCHEDULE OF INTERCONNECT QUANTITIES

QUANTITY	UNIT	
913	FOOT	CONDUIT IN TRENCH, 2" DIA., GALVANIZED STEEL
126	FOOT	CONDUIT PUSHED, 2" DIA., GALVANIZED STEEL
1	EACH	HANDHOLE
913	FOOT	TRENCH AND BACKFILL FOR ELECTRICAL WORK
1	EACH	MAINTENANCE OF EXISTING TRAFFIC SIGNAL INSTALLATION
1	EACH	DRILL EXISTING HANDHOLE
1447	FOOT	ELECTRIC CABLE IN CONDUIT, TRACER NO. 14 1C
1473	FOOT	FIBER OPTIC CABLE IN CONDUIT, NO. 62.5/125, MM12F SM12F
1	L SUM	RE-OPTIMIZE TRAFFIC SIGNAL SYSTEM

THE TRAFFIC SIGNAL CONTROL EQUIPMENT FOR THIS PROJECT SHALL BE "ECONOLITE" TO MATCH THE EXISTING ADJACENT SYSTEM.

ILLINOIS DEPARTMENT OF TRANSPORTATION
INTERCONNECT SCHEMATIC AND SCHEDULE OF QUANTITIES
 127th STREET (BURR OAK AVE.) AT MAPLE AVE.

REVISIONS	
NAME	DATE

GO GANDHI AND ASSOCIATES, INC.
 ENGINEERS AND PLANNERS
 6035 N. NORTHWEST HIGHWAY
 SUITE 306
 CHICAGO, ILLINOIS 60631 TEL: (773) 774-9900

SCALE: NONE
 DATE: 7/17/06
 DRAWN BY: DSS/RDP
 DESIGNED BY: PKG
 CHECKED BY: PKG/KGP