

CONTRACT #62873

F.A.P. RTE.	SECTION	COUNTY	TOTAL SHEETS	SHEET NO.
533	2004 - 117 RS	MCHENRY	26	21
STA.		TO STA.		
FED. ROAD DIST. NO. 1		ILLINOIS HIGHWAY PROJECT		

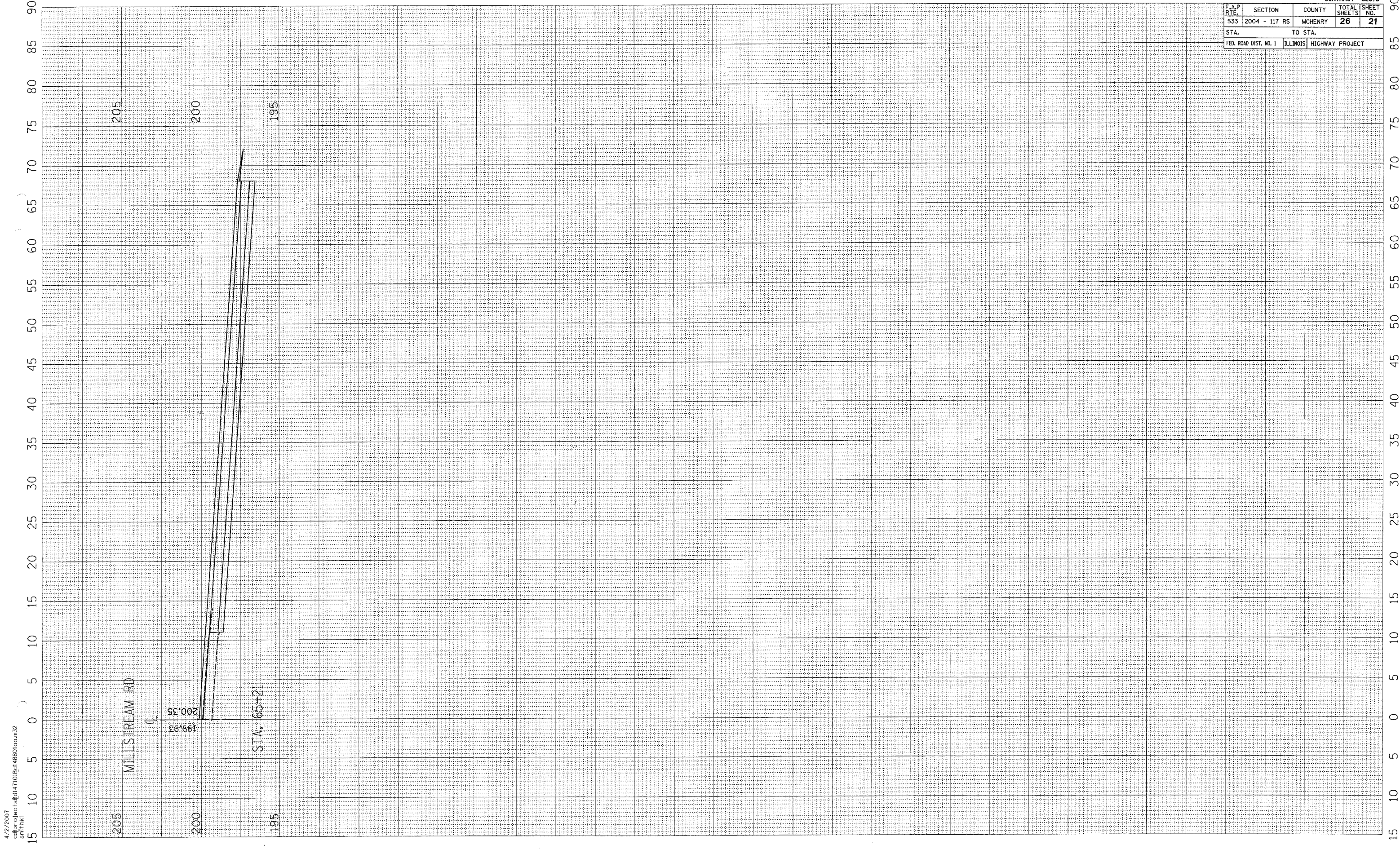

4/2/2007
c:\proj\proj\147101\pl\68801\oa.m32
smh\kl

MILLSTREAM RD

205

199.93

200

STA. 65.12

195

195

90
85
80
75
70
65
60
55
50
45
40
35
30
25
20
15
0
5
10
15