

F.A.I. RTE.	SECTION	COUNTY	TOTAL SHEETS	SHEET NO.
55	99 (1&2) WRS	WILL	334	58
STA.	TO STA.			
FED. ROAD DIST. NO.	ILLINOIS	FED. AID PROJECT		

REMOVAL LEGEND:

- HOT-MIX ASPHALT SURFACE REMOVAL, 3 1/2"
- BITUMINOUS CONCRETE SHOULDER REMOVAL
- HOT-MIX ASPHALT SURFACE REMOVAL, VARIABLE DEPTH

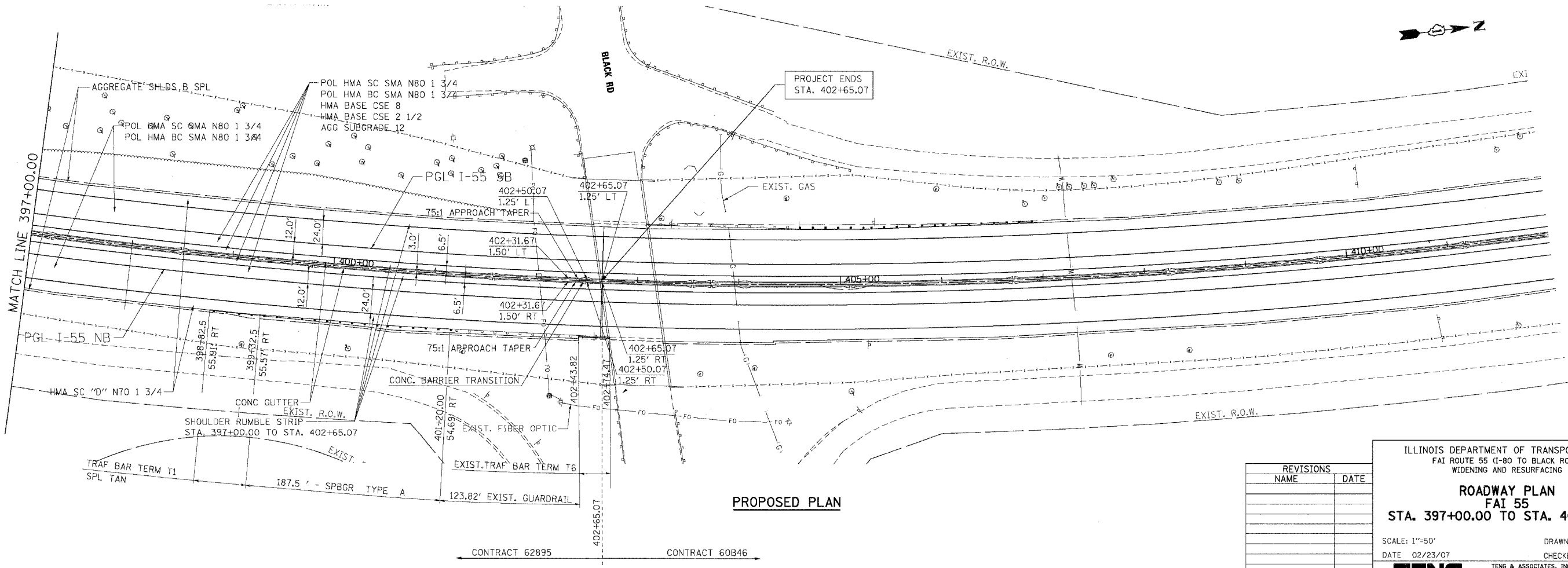
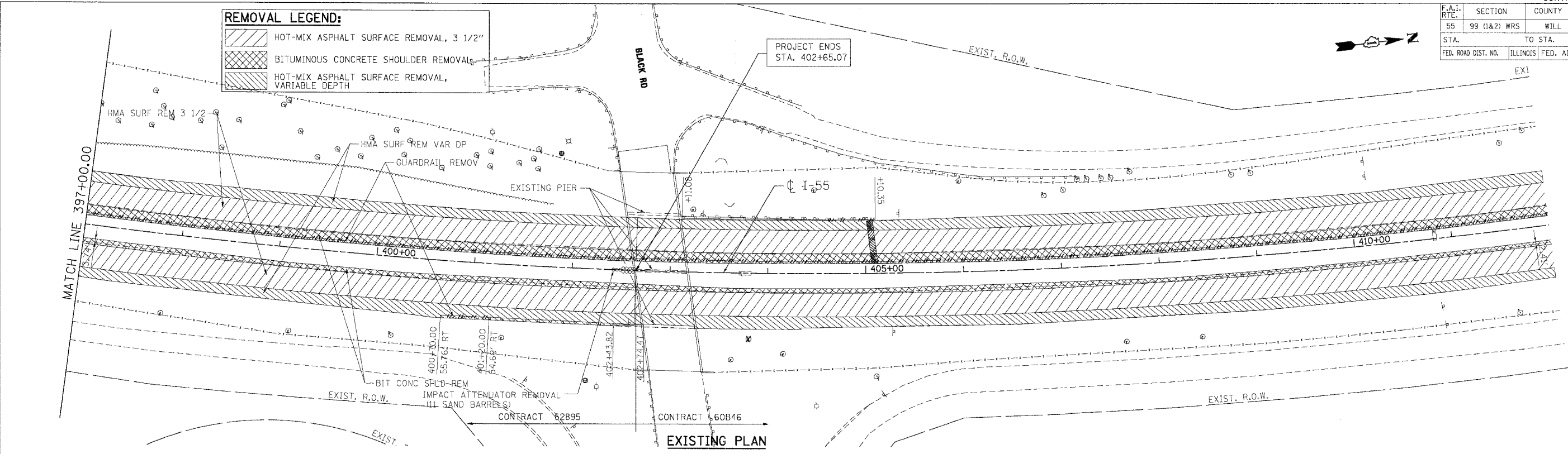

REVISIONS	
NAME	DATE

ILLINOIS DEPARTMENT OF TRANSPORTATION
 FAI ROUTE 55 (I-80 TO BLACK ROAD)
 WIDENING AND RESURFACING

ROADWAY PLAN
 FAI 55
 STA. 397+00.00 TO STA. 402+65.07

SCALE: 1"=50'
 DATE 02/23/07
 DRAWN BY AG
 CHECKED BY DDH

TENG TENG & ASSOCIATES, INC.
 ENGINEERS/ARCHITECTS/PLANNERS
 CHICAGO, ILLINOIS

PLOT DATE = 02/23/07
 FILE NAME = FAI55.PLOT
 PLOT SCALE = 1"=50'
 USER NAME = DDH