

F.A.I. RTE.	SECTION	COUNTY	TOTAL SHEETS	SHEET NO.
55	99 (1&2) WRS	WILL	334	73
STA.		TO STA.		
FED. ROAD DIST. NO.		ILLINOIS FED. AID PROJECT		

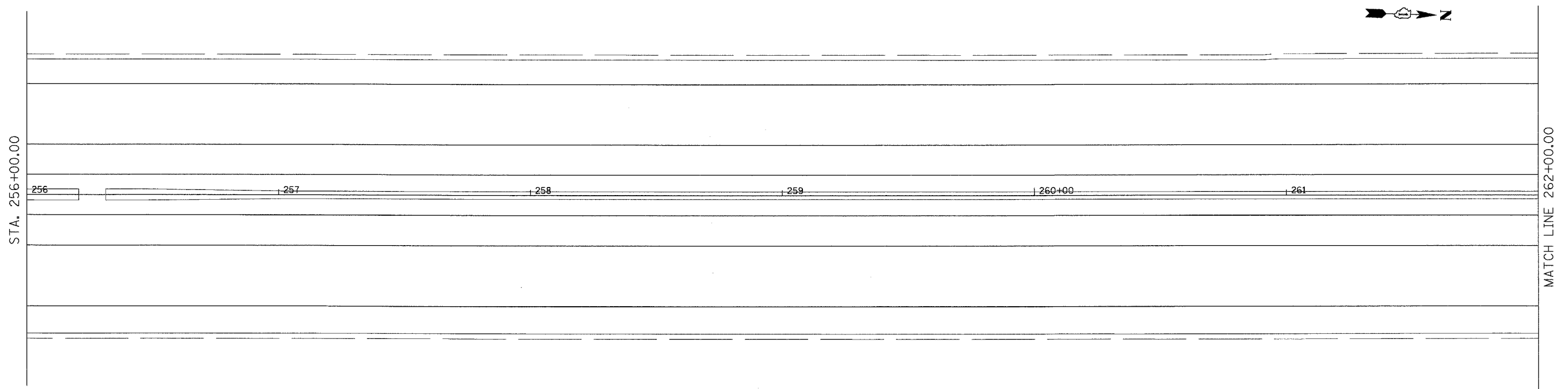
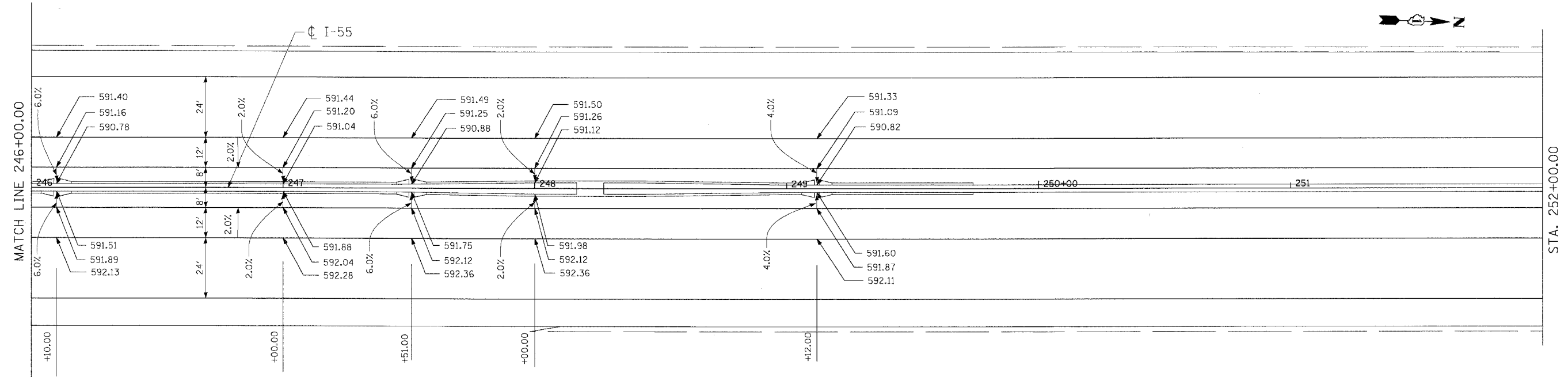

PLOT DATE = 02/23/07
 FILE NAME = 02FILE08
 PLOT SCALE = 1/8"=1'-0"
 USER NAME = 02USER08

REVISIONS	
NAME	DATE

ILLINOIS DEPARTMENT OF TRANSPORTATION
 FAI ROUTE 55 (I-80 TO BLACK ROAD)
 WIDENING AND RESURFACING

PAVEMENT ELEVATION DETAILS
FAI 55
STA. 246+00.00 TO STA. 262+00.00

SCALE: 1"=20'
 DATE 02/23/07

DRAWN BY MRK
 CHECKED BY DDH

TENG ENGINEERS/ARCHITECTS/PLANNERS
 CHICAGO, ILLINOIS