

F.A.I. RTE.	SECTION	COUNTY	TOTAL SHEETS	SHEET NO.
55	99 (1&2) WRS	WILL	334	162
STA.		TO STA.		
FED. ROAD DIST. NO.		ILLINOIS FED. AID PROJECT		

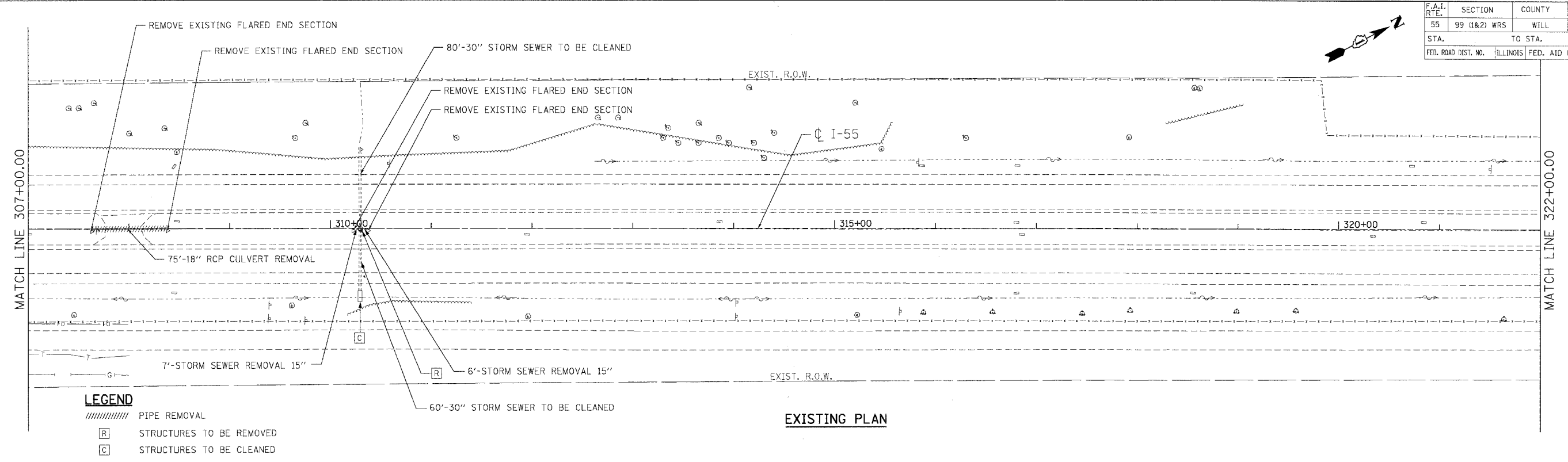

LEGEND
 // // // // PIPE REMOVAL
 [R] STRUCTURES TO BE REMOVED
 [C] STRUCTURES TO BE CLEANED

EXISTING PLAN

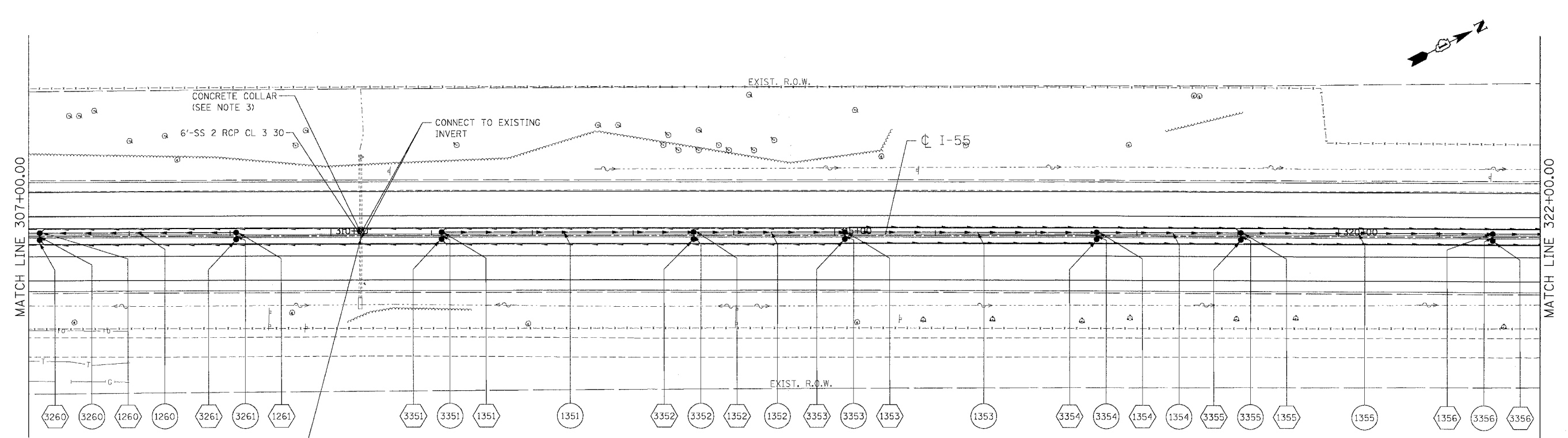

LEGEND
 1001 STRUCTURE NUMBER
 1001 GR
 1001 GRATING FOR STRUCTURE
 1001 PIPE NUMBER
 - - - - - STORM SEWER
 ● CATCH BASIN
 ○ MANHOLE
 ▲ FLARED END SECTION
) HEADWALL
 - - - - - PIPE UNDERDRAINS

NOTES
 1. FOR STRUCTURE AND PIPE INFORMATION SEE DRAINAGE SCHEDULES, SHEETS 169, 170, 171, 172, 173, 174 AND 175.
 2. PROPOSED SEWER AND CULVERT CROSSING BENEATH THE EXISTING PAVEMENT SHALL BE CONSTRUCTED DURING PRE-STAGE PER THE STAGING AND TRAFFIC CONTROL PLANS. SEE ROADWAY PLANS FOR PATCHING DETAILS.

3. SEE DISTRICT 1 DETAIL BD-7 FOR CONCRETE COLLAR DETAILS.

PROPOSED PLAN

REVISIONS	
NAME	DATE

ILLINOIS DEPARTMENT OF TRANSPORTATION
 FAI ROUTE 55 (I-80 TO BLACK ROAD)
 WIDENING AND RESURFACING

**DRAINAGE AND UTILITY PLAN
 FAI 55
 STA. 307+00.00 TO STA. 322+00.00**

SCALE: 1"=50'
 DATE 03/15/07

DRAWN BY MRK
 CHECKED BY TKL

TENG
 TENG & ASSOCIATES, INC.
 ENGINEERS/ARCHITECTS/PLANNERS
 CHICAGO, ILLINOIS

PLOT DATE: 3/15/2007 10:30:57
 PLOT SCALE: 1"=50'
 PLOT SHEET: 334 OF 334
 USER NAME: KLSURF