

F.A.I. R.F.S.	SECTION	COUNTY	TOTAL SHEETS	SHEET NO.
55	99 (I&2) WRS	WILL	334	214
STA. TO STA.		ILLINOIS FED. AID PROJECT		

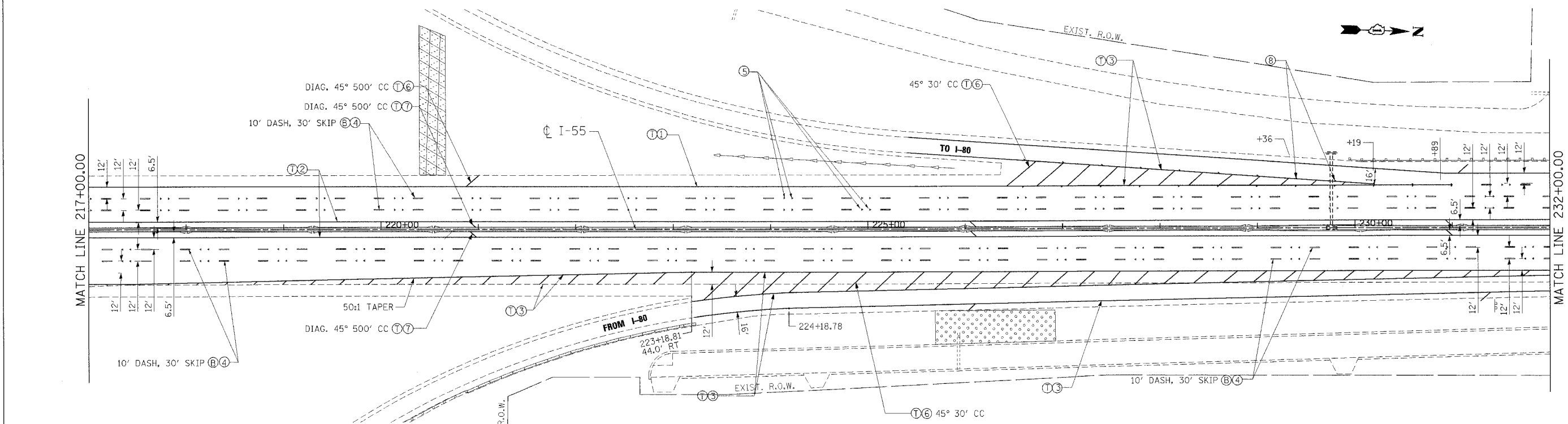
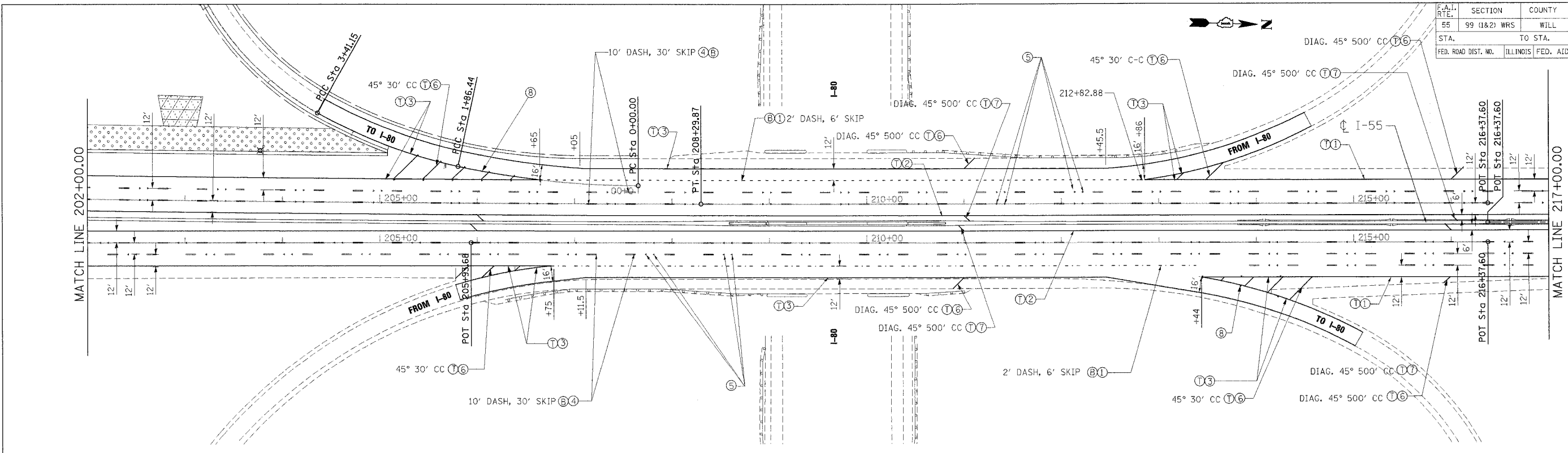

PAVEMENT MARKING LEGEND

- ① PAVEMENT MARKING LINE 4" (WHITE)
- ② PAVEMENT MARKING LINE 4" (YELLOW)
- ③ PAVEMENT MARKING LINE 8" (WHITE)
- ④ PAVEMENT MARKING LINE 5" (WHITE)
- ⑤ RAISED REFLECTIVE PAVEMENT MARKER (DOUBLE, ONE-WAY, CRYSTAL MARKERS @ 80' C-C)
- ⑥ PAVEMENT MARKING LINE 12" (WHITE)
- ⑦ PAVEMENT MARKING LINE 12" (YELLOW)
- ⑧ RAISED REFLECTIVE PAVEMENT MARKER (SINGLE, ONE-WAY, CRYSTAL MARKERS @ 40' C-C)
- ⑨ RAISED REFLECTIVE PAVEMENT MARKER (SINGLE, ONE-WAY, CRYSTAL MARKERS @ 45' C-C)

LANDSCAPING LEGEND

- ① THERMOPLASTIC (EXTRUDED)
- ② POLYUREA
- ③ PREFORMED PLASTIC, TYPE B
- SEEDING CLASS 2A WITH TOPSOIL FURNISH AND PLACE, 6" AND EROSION CONTROL BLANKET
- SEEDING CLASS 4 WITH COMPOST FURNISH AND PLACE, 4" AND EROSION CONTROL BLANKET
- SEEDING, CLASS 4B (MODIFIED) WITH COMPOST FURNISH AND PLACE, 4" AND MULCH METHOD 2

REVISIONS	
NAME	DATE

ILLINOIS DEPARTMENT OF TRANSPORTATION
 FAI ROUTE 55 (I-80 TO BLACK ROAD)
 WIDENING AND RESURFACING
PAVEMENT MARKING AND LANDSCAPING
 FAI 55
 STA. 202+00.00 TO STA. 232+00.00

SCALE: 1"=50'
 DATE: 04/20/07
 DRAWN BY: MW
 CHECKED BY: DDH

TENG
 TENG & ASSOCIATES, INC.
 ENGINEERS/ARCHITECTS/PLANNERS
 CHICAGO, ILLINOIS

MORCOM, N.V., INC.
 CONSULTING ENGINEERS
 CHICAGO, ILLINOIS

PLOT DATE = 04/20/07
 PLOT SCALE = AS SHOWN
 USER NAME = USER