

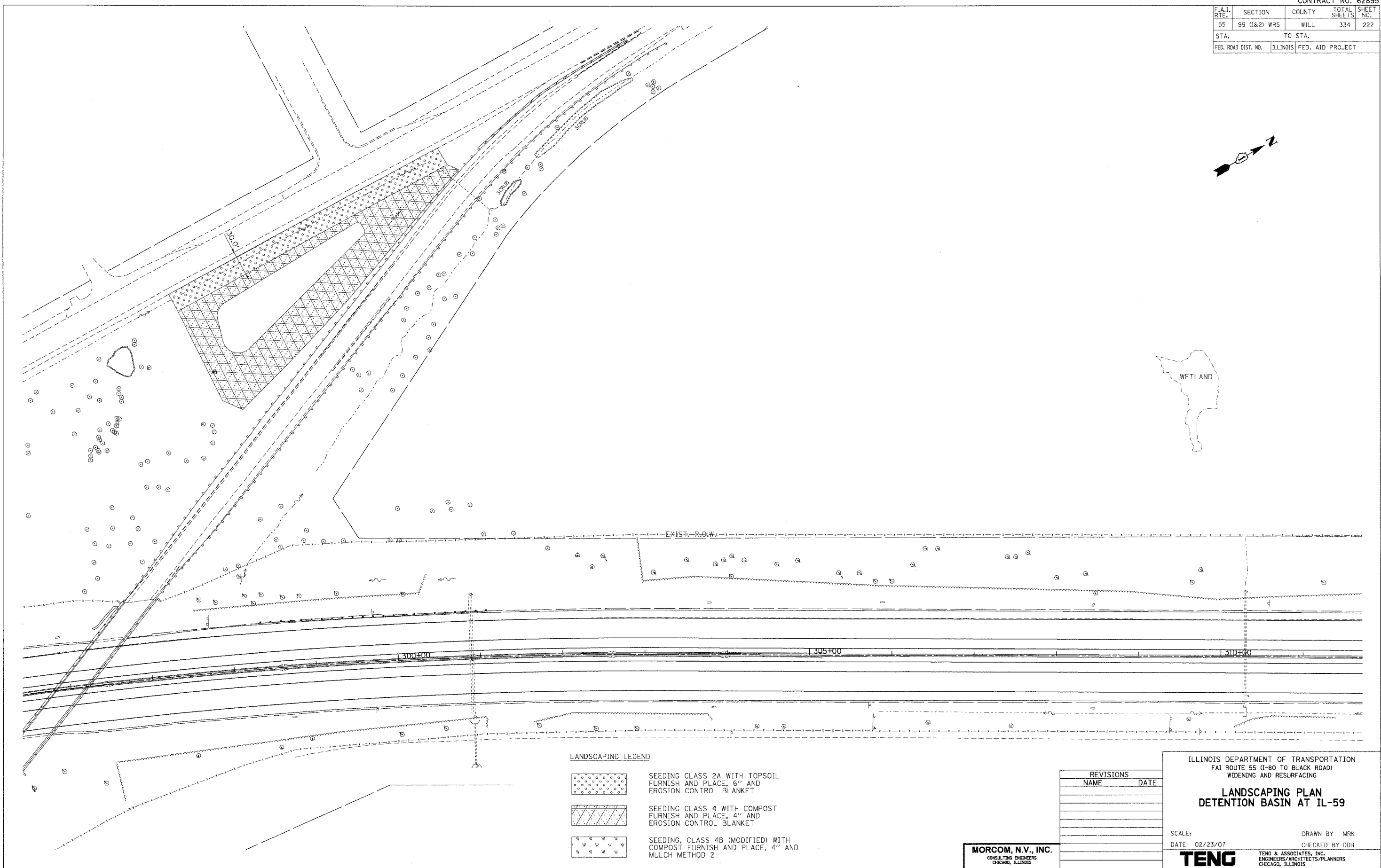

F.A.I. RTE.	SECTION	COUNTY	TOTAL SHEETS	SHEET NO.
55	99 (I&2) WRS	WILL	334	222
STA.		TO STA.		
FED. ROAD DIST. NO.	ILLINOIS	FED. AID PROJECT		

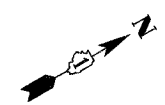

LANDSCAPING LEGEND

-  SEEDING CLASS 2A WITH TOPSOIL FURNISH AND PLACE, 6" AND EROSION CONTROL BLANKET
-  SEEDING CLASS 4 WITH COMPOST FURNISH AND PLACE, 4" AND EROSION CONTROL BLANKET
-  SEEDING, CLASS 4B (MODIFIED) WITH COMPOST FURNISH AND PLACE, 4" AND MULCH METHOD 2

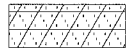
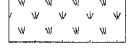
REVISIONS	
NAME	DATE

ILLINOIS DEPARTMENT OF TRANSPORTATION
 I-55 (I-80 TO BLACK ROAD)
 WIDENING AND RESURFACING

**LANDSCAPING PLAN
 DETENTION BASIN AT IL-59**

SCALE: _____
 DATE 02/23/07

DRAWN BY MRK
 CHECKED BY DDH

TENG
 TENG & ASSOCIATES, INC.
 ENGINEERS/ARCHITECTS/PLANNERS
 CHICAGO, ILLINOIS

MORCOM, N.V., INC.
 CONSULTING ENGINEERS
 CHICAGO, ILLINOIS

PLOT DATE: 02/23/07
 FILE NAME: 022307.DWG
 PLOT SCALE: 1"=40'
 USER NAME: JUS188
 \\P061A001\LDN\...N\061A001.DWG
 \\P061A001\LDN\...X\061A001.DWG
 \\P061A001\LDN\...M\061A001.DWG
 \\P061A001\LDN\...L\061A001.DWG
 2-22-2007 11:26:23
 GARCIAZ