

F.A. RTE.	SECTION	COUNTY	TOTAL SHEETS	SHEET NO.
55	99 (1+2) WRS	WILL.	334	276
STA. TO STA.		FED. ROAD DIST. NO. ILLINOIS FED. AID PROJECT		

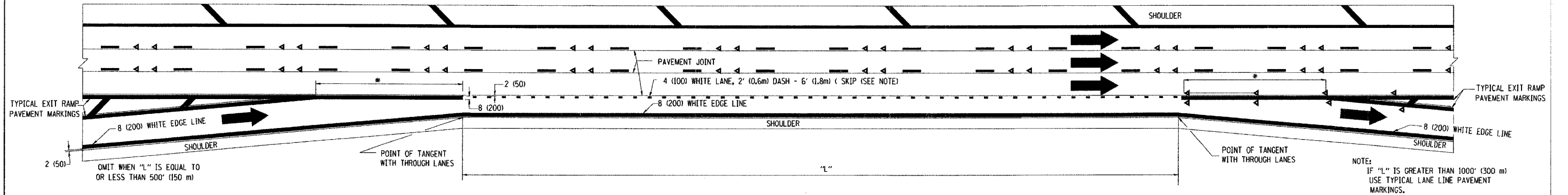

TYPICAL ENTRANCE/EXIT RAMP COMBINATION PAVEMENT MARKINGS

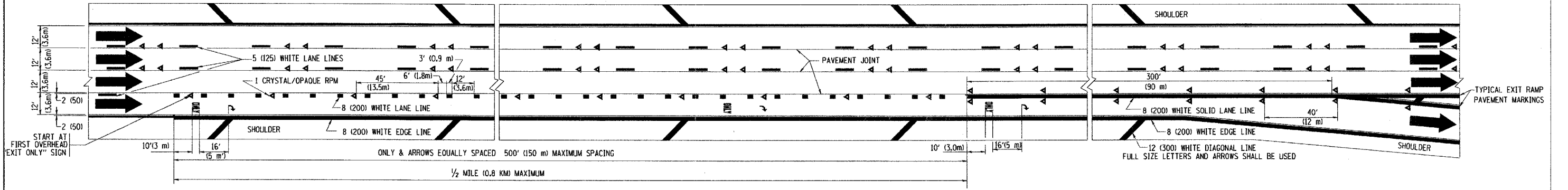

TYPICAL EXIT ONLY LANE PAVEMENT MARKINGS

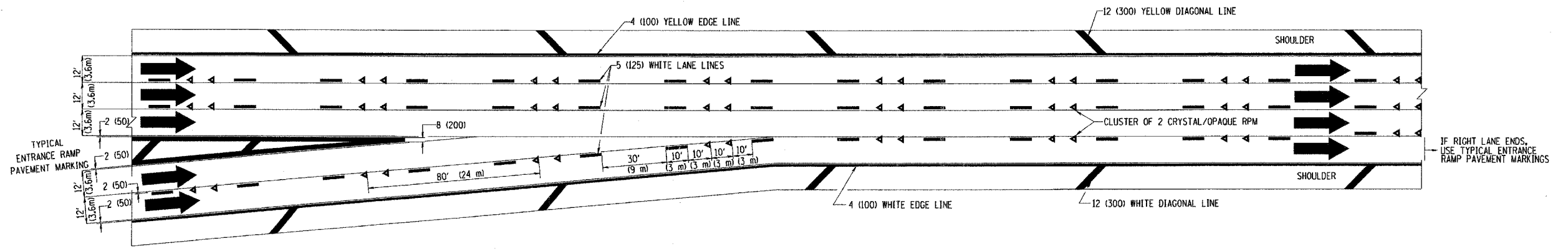

TYPICAL TWO LANE ENTRANCE RAMP PAVEMENT MARKINGS

PLOT DATE = 1/16/2007
 FILE NAME = K:\projects\1212.dgn
 PLOT SCALE = 5/8" = 1'-0"
 USER NAME = leggs

REVISIONS	
NAME	DATE
DWS	1/90
DWS	5/91
SPB	1/07

ILLINOIS DEPARTMENT OF TRANSPORTATION

MULTI-LANE FREEWAY PAVEMENT MARKING DETAILS

SCALE: NONE
DATE: 1/16/2007

DRAWN BY C.A.D.D.

CHECKED BY

TC12 SHEET 2 OF 2

REVISION DATE: 01/01/07