

SECTION	COUNTY	TOTAL SHEETS	SHEET NO.
99 (1&2) WRS-1	WILL	227	53
STA. 727+00 TO STA. 757+00			
FED. ROAD DIST. NO. ILLINOIS FED. AID PROJECT			
PRO-06 OF 07			

PLAN	DATE
NO.	
BY	
CHECKED	
DATE	

PROFILE	DATE
NO.	
BY	
CHECKED	
DATE	

PLOT DATE = 2/28/20
 PLOT SCALE = 1"=40'
 USER NAME = MUSER

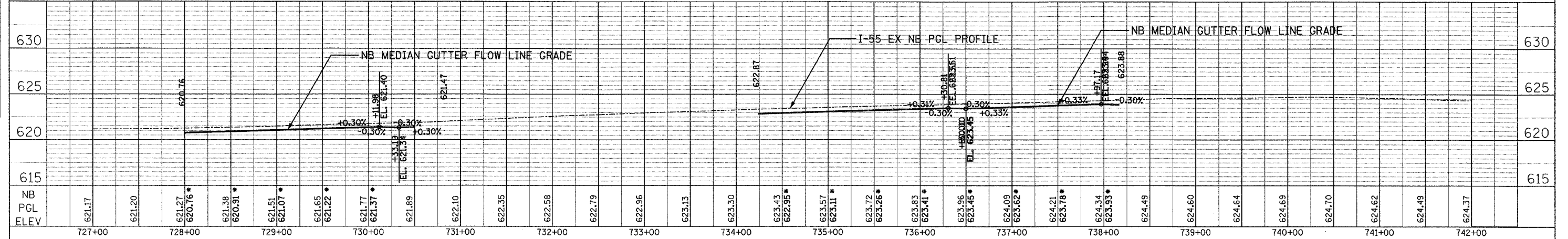
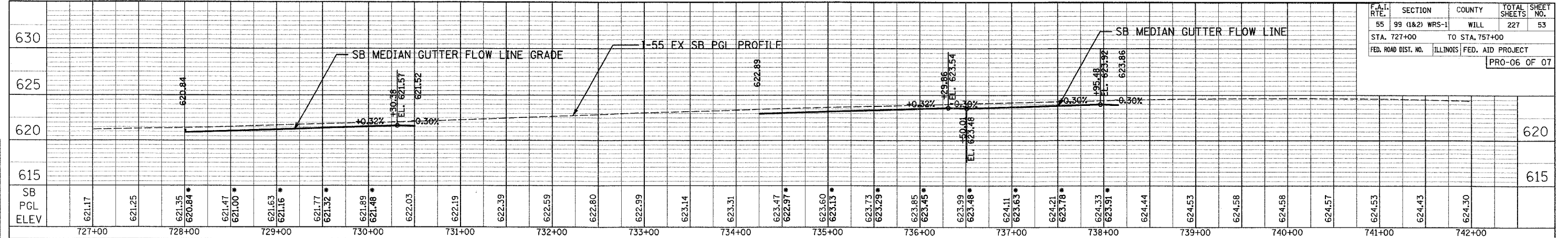

• PROPOSED GUTTER FLOW LINE GRADE ELEVATION

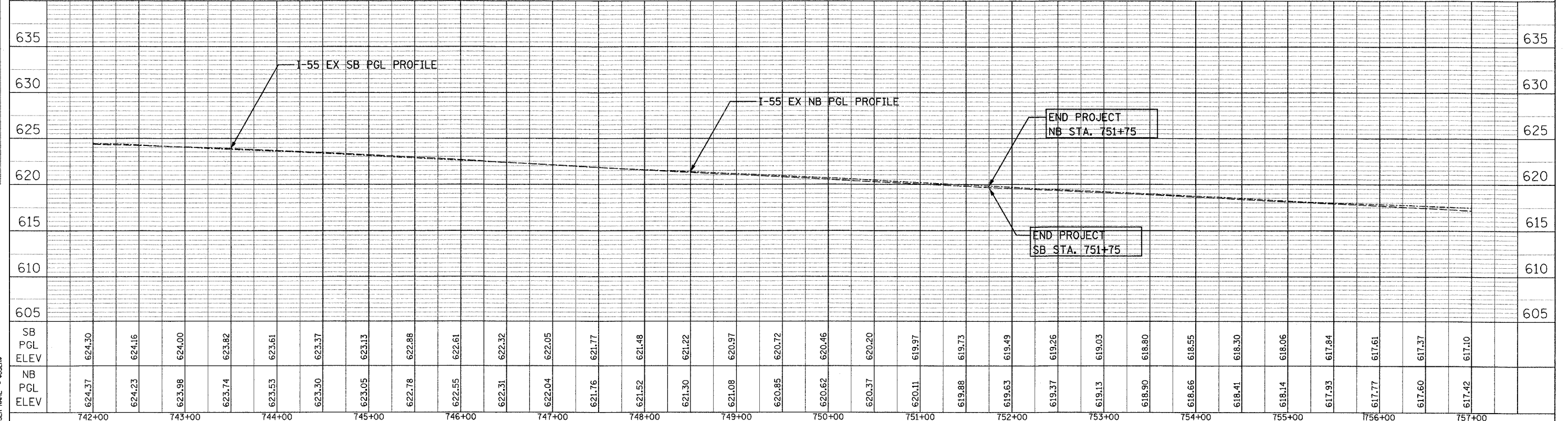

END PROJECT NB STA. 751+75

END PROJECT SB STA. 751+75