

CONTRACT NO. 62896				
F.A. RTE.	SECTION	COUNTY	TOTAL SHEETS	SHEET NO.
55	99 (1&2) WRS-1	WILL.	227	94
STA. 727+00 TO STA. 742+00		ILLINOIS FED. AID PROJECT		

DRU-09 OF 10

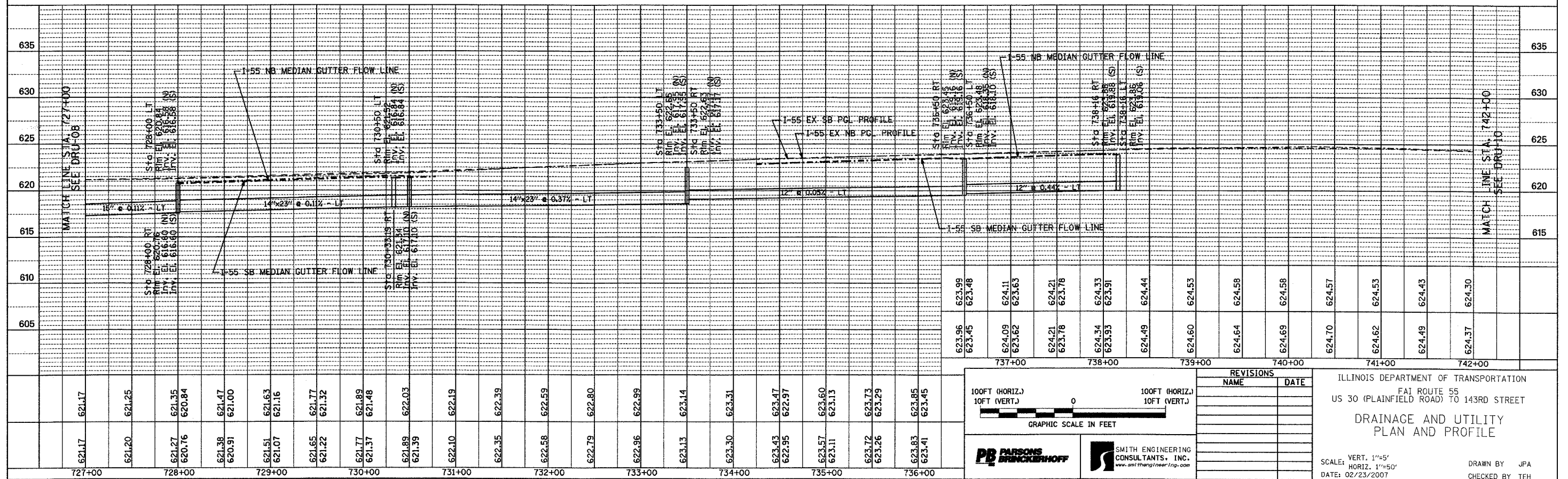
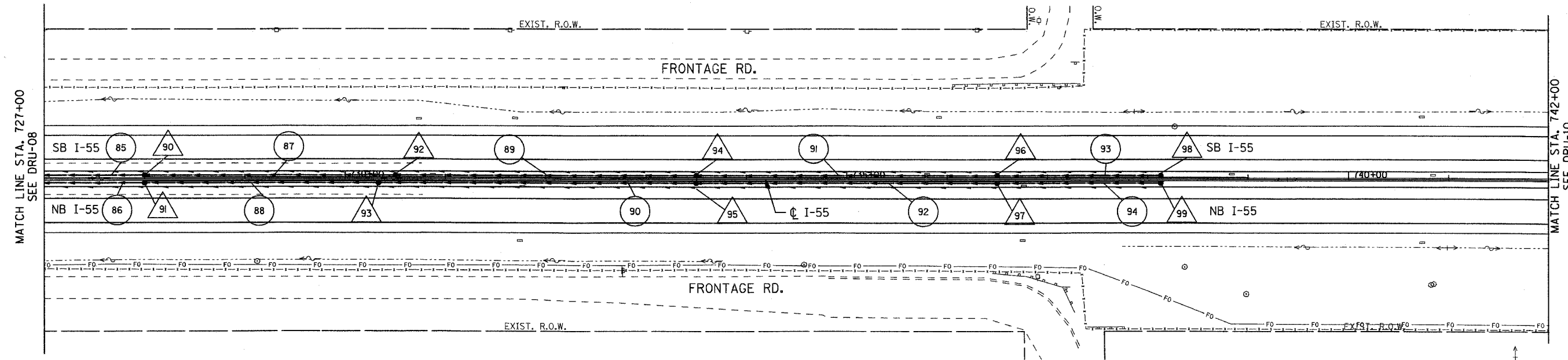
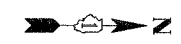

100FT (HORIZ.)  
10FT (VERT.)

GRAPHIC SCALE IN FEET

**PARSONS BRINCKERHOFF**

**SMITH ENGINEERING CONSULTANTS, INC.**  
www.smitheng.com

REVISIONS	
NAME	DATE

ILLINOIS DEPARTMENT OF TRANSPORTATION  
FAI ROUTE 55  
US 30 (PLAINFIELD ROAD) TO 143RD STREET

**DRAINAGE AND UTILITY  
PLAN AND PROFILE**

SCALE: VERT. 1"=5'  
HORIZ. 1"=50'  
DATE: 02/23/2007

DRAWN BY JFA  
CHECKED BY TEH

FINAL