

STATE OF ILLINOIS
DEPARTMENT OF TRANSPORTATION

ROUTE NO.	SECTION	COUNTY	TOTAL SHEETS	SHEET NO.
FAI 55	**	WILL	227	145
FED. ROAD DIST. NO. 7	ILLINOIS	FED. AID PROJECT		

SHEET NO. 1

5 SHEETS

** SECTION 99 (1&2) WRS-1
CONTRACT NO. 62896

B.M. 3216 -
Square cut near NE corner of middle pier between NB & SB lanes of I-55 under Airport Rd.
(Also Lockport-Plainfield Rd.)
El. 617.57.

Existing Structure -
Structure No. 099-0176 was rehabilitated as Plainfield/Lockport Road Section 99-1HB-2-BR
in 2002. The existing structure is 188'-0" Bk. to Bk. of Abutments and is a four-span structure
consisting of a 32'-0" wide reinforced concrete deck supported on a continuous steel wide flange
beam superstructure. The existing substructure was rehabilitated and incorporated into the 2002
improvements and consists of stub type abutments and concrete piers supported on a pile foundation.

Salvage -
None

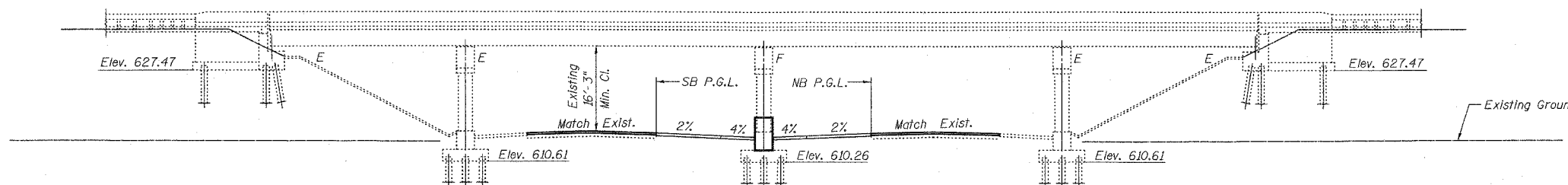

ELEVATION

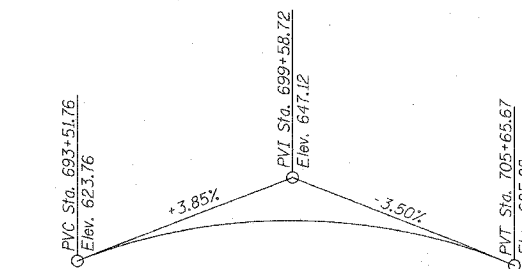

EXISTING PLAINFIELD/LOCKPORT ROAD
PROFILE GRADE

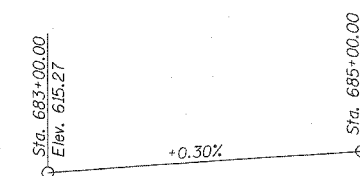

SB I-55 PROFILE GRADE

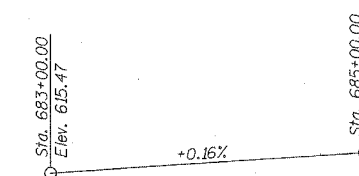

NB I-55 PROFILE GRADE

SCOPE OF WORK

1. Repair substructure defects at Pier 1, Pier 2, & Pier 3 with Structural Repair of Concrete and/or Epoxy Crack Sealing.
2. The Pier 2 Crashwall will be extended to a height equal to 42" from edge of pavement to match the proposed I-55 mainline median barrier configuration.

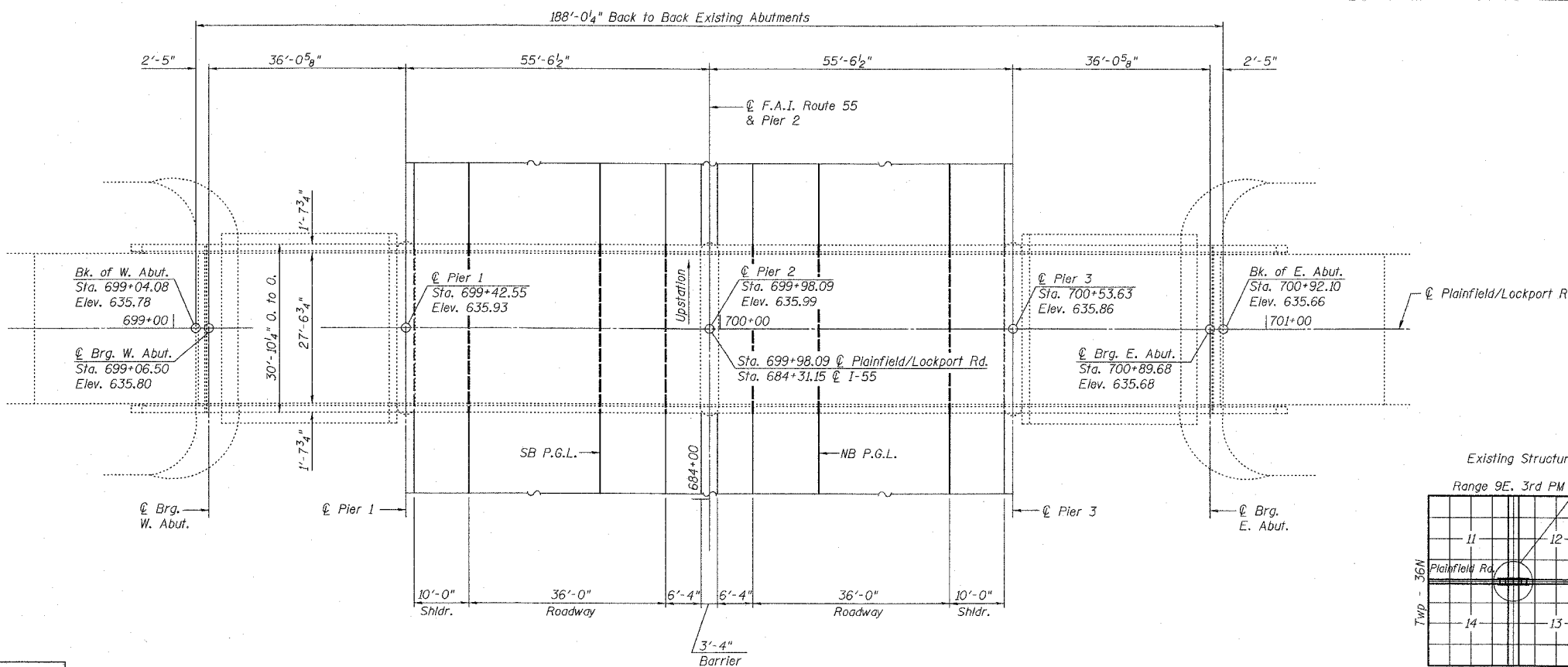

PLAN

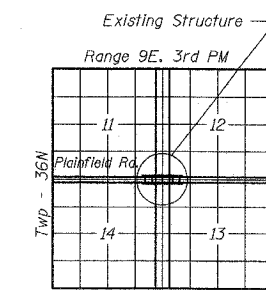

LOCATION SKETCH

DESIGN SPECIFICATIONS

AASHTO 2002

LOADING HS20-44

Allow 50#/Sq. Ft. for future wearing surface.

DESIGN STRESSES

FIELD UNITS

f_c = 3,500 psi
f_y = 60,000 psi (reinforcement)



Signed Jamal Grainawi
Jamal I. Grainawi, S.E., IL. Lic. No. 081-005161
Expires 11-30-2008
Date 2/23/2007

GENERAL PLAN AND ELEVATION
PLAINFIELD ROAD OVER I-55
SECTION 99 (1&2) WRS-1
WILL COUNTY
STA. 699+98.09
STRUCTURE NO. 099-0176



DESIGNED	S.CHELBIAN
CHECKED	J.GRAINAWI
DRAWN	D.C.PATEL
CHECKED	J.GRAINAWI

Date: 2/23/2007