

CONTRACT NO. 62911				
F.A.P. RTE.	SECTION	COUNTY	TOTAL SHEETS	SHEET NO.
311	9 Y-N-2	COOK & DUPAGE	39	30
STA.		TO STA.		
FED. ROAD DIST. NO.		ILLINOIS FED. AID PROJECT		

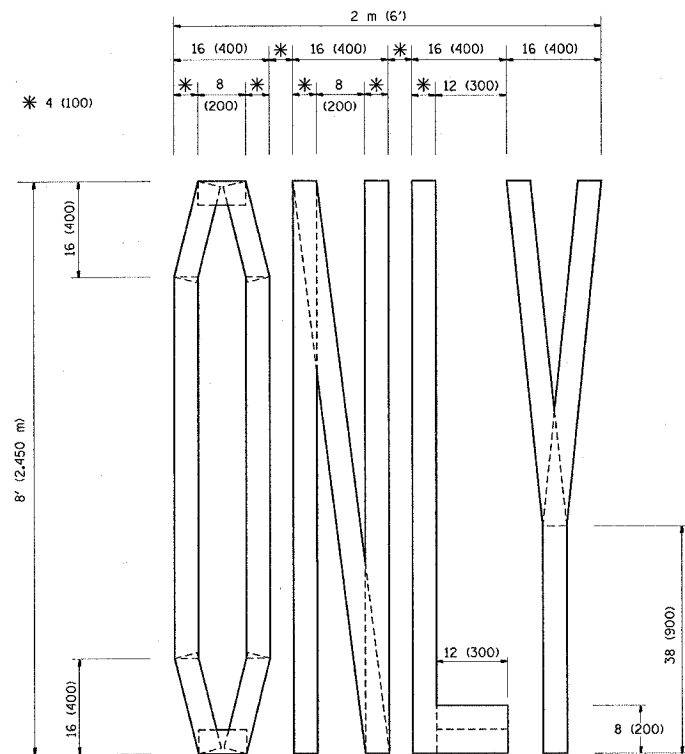

QUANTITY  
4 (100) LINE = 64.1 ft. (19.7 m)  
21.1 sq. ft. (1.97 sq. m)

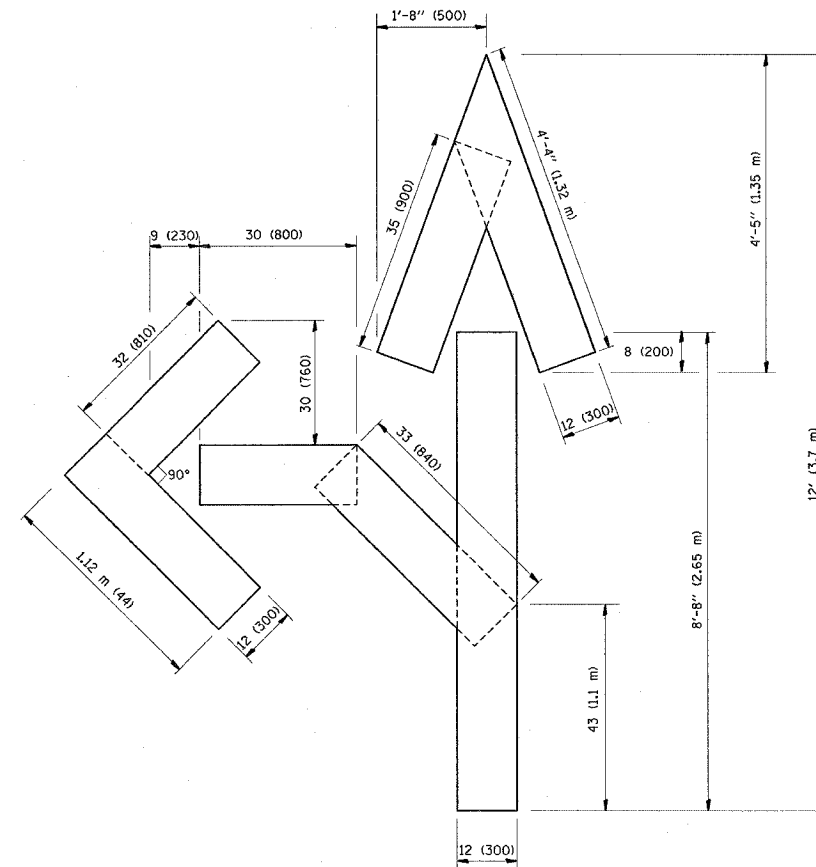

QUANTITY  
4 (100) LINE = 82.5 ft. (25.3 m)  
27.5 sq. ft. (2.53 sq. m)

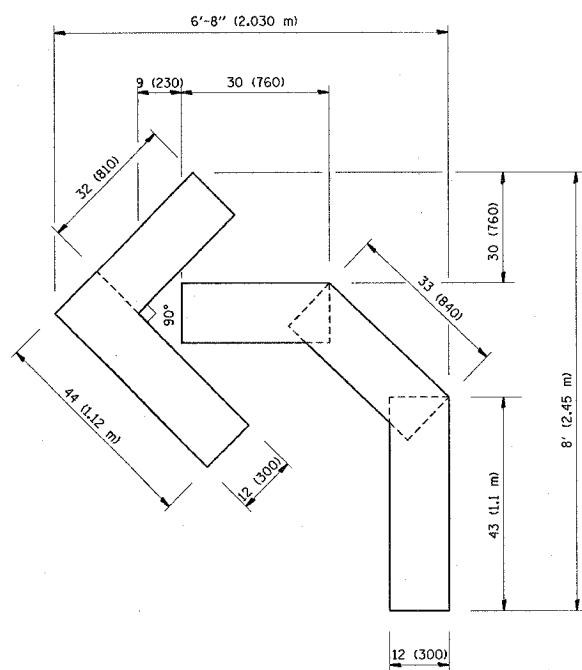

QUANTITY  
4 (100) LINE = 45.5 ft. (13.9 m)  
15.2 sq. ft. (1.39 sq. m)

All dimensions are in millimeters (inches) unless otherwise shown.

REVISIONS	
NAME	DATE
T. RAMMACHER	09/18/94
J. OBERLE	06/01/96
T. RAMMACHER	06/05/96
T. RAMMACHER	11/04/97
T. RAMMACHER	03/02/98
E. GOMEZ	08/28/00

ILLINOIS DEPARTMENT OF TRANSPORTATION

PAVEMENT MARKING  
LETTERS AND SYMBOLS  
FOR TRAFFIC STAGING

SCALE: NONE  
DATE: 2/16/2007

DRAWN BY CADD  
CHECKED BY  
TC-16

REVISION DATE: 08/28/00