

F.A.P. RTE.	SECTION	COUNTY	TOTAL SHEETS	SHEET NO.
734	(4MFT)R	WINNEBAGO	353	280
STA.		TO STA.		
FED. ROAD DIST. NO.		ILLINOIS	FED. AID PROJECT	

TWO CENTER CURVE DATA

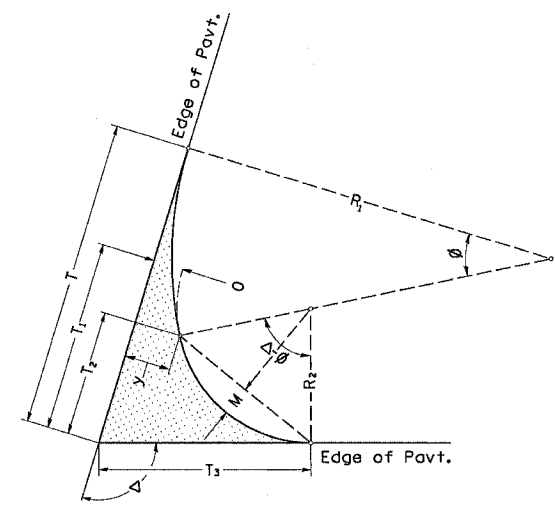

TWO CENTER CURVES

ALL DIMENSIONS ARE IN MILLIMETERS (INCHES) UNLESS OTHERWISE NOTED.

CURVE NO.	1	2	3	4	5	6	7	8	9	10
R1	450.0	360.0	300	200	200	300	140	150	250	200
R2	90.0	80.0	50.0	50.0	50.0	50.0	30.0	25.0	35.0	40.0
O	10.0	12.0	12.0	6.5	10.0	14.0	6.0	10.0	7.0	6.0
DELTA	87.90	91.00	79.70	100.30	105.00	75.00	89.30	90.70	88.60	91.00
T	170.66	162.71	116.08	104.8	121.7	117.1	65.4	74.419	88.4	84.21
T1	86.39	81.62	39.55	61.09	67.84	34.62	29.56	25.43	33.98	40.81
T2	65.33	58.45	24.25	46.53	49.89	18.12	19.79	15.63	25.13	29.96
T3	96.77	93.41	53.93	66.51	75.51	52.86	35.64	35.31	41.16	46.71
y	12.50	15.43	14.40	8.67	13.33	16.80	7.64	12.00	8.14	7.50
4y/9	5.56	6.86	6.40	3.85	5.93	7.47	3.39	5.33	3.62	3.33
y/9	1.39	1.71	1.60	0.96	1.48	1.87	0.85	1.33	0.90	0.83
M	18.30	16.18	7.11	12.66	12.83	5.80	5.47	4.23	7.04	8.32
15M/16	17.15	15.17	6.67	11.87	12.03	5.44	5.13	3.96	6.60	7.80
3M/4	13.72	12.13	5.34	9.49	9.62	4.35	4.10	3.17	5.28	6.24
7M/16	8.00	7.08	3.11	5.54	5.61	2.54	2.39	1.85	3.08	3.64
C	108.78	96.47	51.41	66.50	66.89	46.74	34.54	27.82	42.10	48.84

CURVE NO.	11	12	13	14	15	16	17	18	19	20
R1	300	100	280	160	250	150	300	250	280	250
R2	60.0	50.0	35.0	30.0	35.0	30.0	40.0	35.0	35.0	35.0
O	10.0	4.0	7.0	8.0	7.0	10.0	8.0	5.0	7.0	7.0
DELTA	90.90	89.10	87.50	91.00	89.90	91.20	90.80	89.40	88.50	90.50
T	129.7	68.75	91.35	75.57	89.34	78.8	104.7	80.68	92.06	89.78
T1	61.11	49.16	33.20	30.67	34.93	30.84	40.67	34.58	33.91	35.37
T2	43.97	29.56	24.89	20.31	26.07	18.85	30.83	27.08	25.61	26.51
T3	70.95	53.22	40.51	38.53	41.94	40.64	48.56	39.64	41.10	42.31
y	12.50	8.00	8.00	9.85	8.14	12.50	9.23	5.81	8.00	8.14
4y/9	5.56	3.56	3.56	4.38	3.62	5.56	4.10	2.58	3.56	3.62
y/9	1.39	0.89	0.89	1.09	0.90	1.39	1.03	0.65	0.89	0.90
M	12.18	8.07	7.01	5.55	7.28	5.08	8.60	7.61	7.19	7.39
15M/16	11.42	7.57	6.57	5.20	6.82	4.76	8.06	7.14	6.74	6.93
3M/4	9.13	6.05	5.25	4.16	5.46	3.81	6.45	5.71	5.39	5.54
7M/16	5.33	3.53	3.06	2.43	3.18	2.22	3.76	3.33	3.15	3.23
C	72.47	54.48	42.02	34.75	42.73	33.40	49.55	43.59	42.50	43.02

TRAFFIC CONTROL AND PROTECTION AT TURN BAYS (TO REMAIN OPEN TO TRAFFIC)

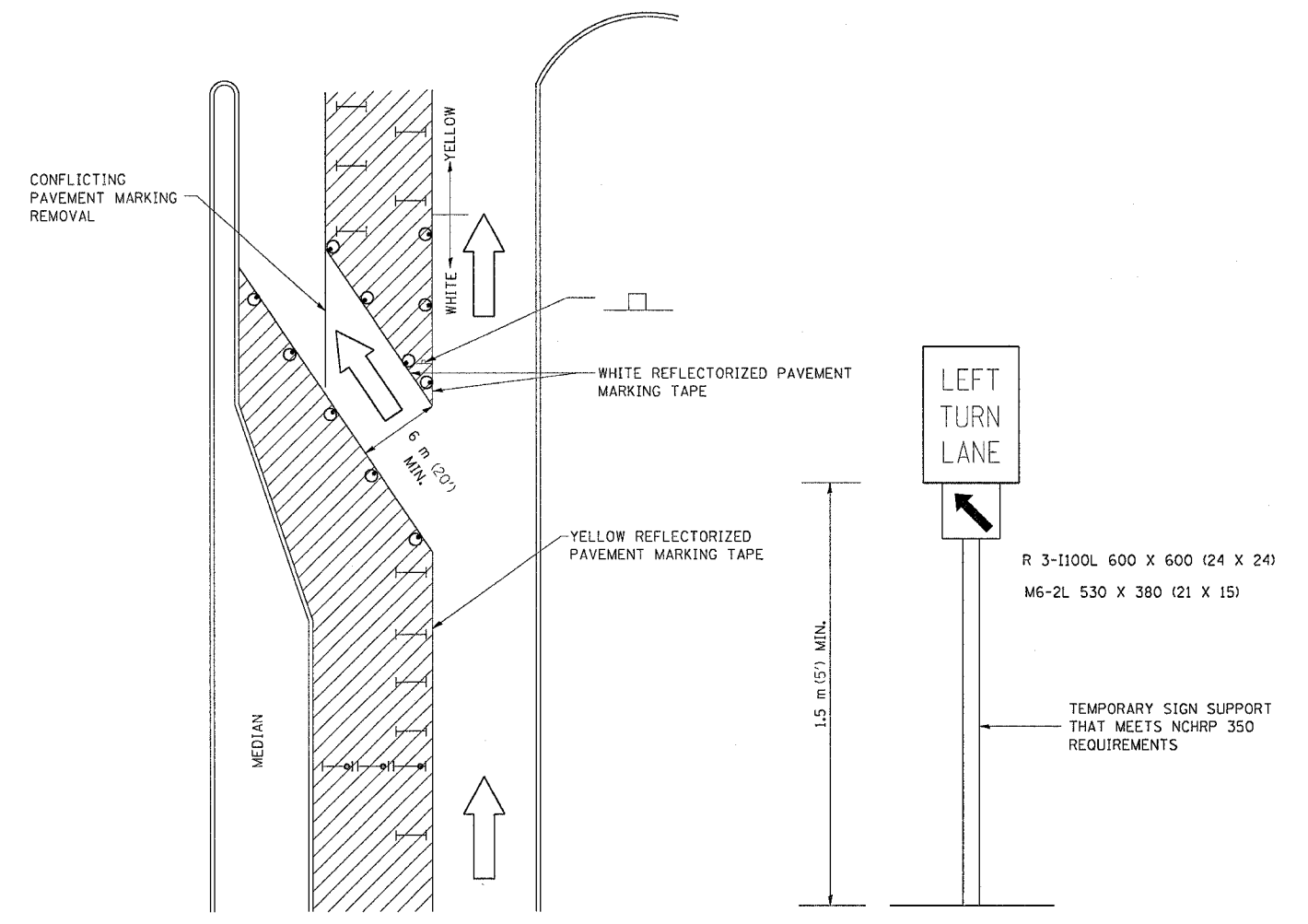

LEGEND

- WORK AREA
- LANE OPEN TO TRAFFIC
- TYPE I OR II BARRICADE OR DRUM WITH FLASHING BURNING LIGHT
- DRUM OR BARRICADE WITH STEADY BURN LIGHT
- SIGN (SEE DETAIL)
- TYPE I OR II CHECK BARRICADE WITH STEADY LIGHT BURN

GENERAL NOTES

CONES MAY BE SUBSTITUTED FOR BARRICADES OR DRUMS AT HALF THE SPACING DURING DAY OPERATIONS. CONES SHALL BE A MINIMUM OF 710 (28) IN HEIGHT.

STEADY BURNING LIGHTS WILL NOT BE REQUIRED ON BARRICADES OR DRUMS FOR DAY OPERATIONS. ALL LIGHTS WILL BE MONODIRECTIONAL.

REFLECTORIZED TEMPORARY PAVEMENT MARKING TAPE SHALL BE PLACED THROUGHOUT THE BARRICADED AREA OF EACH BAY WHERE THE CLOSURE TIME IS GREATER THAN FOURTEEN DAYS.

THIS APPLICATION ALSO APPLIES WHEN WORK IS BEING PERFORMED IN THE RIGHT LANE(S) AND THE RIGHT TURN BAY IS TO REMAIN OPEN. UNDER THIS CONDITION, "RIGHT TURN LANE" R3-100 600 X 600 (24 X 24) AND M6-2R 530 X 380 (21 X 15) SHALL BE USED.

THESE CONTROLS SHALL SUPPLEMENT MAINLINE TRAFFIC CONTROL FOR LANE CLOSURES.

LONGITUDINAL DIMENSIONS MAY BE ADJUSTED TO FIT FIELD CONDITIONS.

TRAFFIC CONTROL AND PROTECTION AT TURN BAYS (TO REMAIN OPEN TO TRAFFIC) SHALL BE INCLUDED IN THE COST SPECIFIED TRAFFIC CONTROL STANDARDS OR ITEMS.

ALL DIMENSIONS ARE IN MILLIMETERS (INCHES) UNLESS OTHERWISE NOTED.

PLOT DATE = Mon Apr 30 14:31:24 2007
 PLOT SCALE = 20.0000 / IN.
 REFERENCE = REF'S