

F.A.P. RTE.	SECTION	COUNTY	TOTAL SHEETS	SHEET NO.
505	110RS-1, 111RS-3	STEPHENSON	174	18
STA.		TO STA.		
FED. ROAD DIST. NO.		ILLINOIS	FED. AID PROJECT	
CONTRACT NO. 64C32				

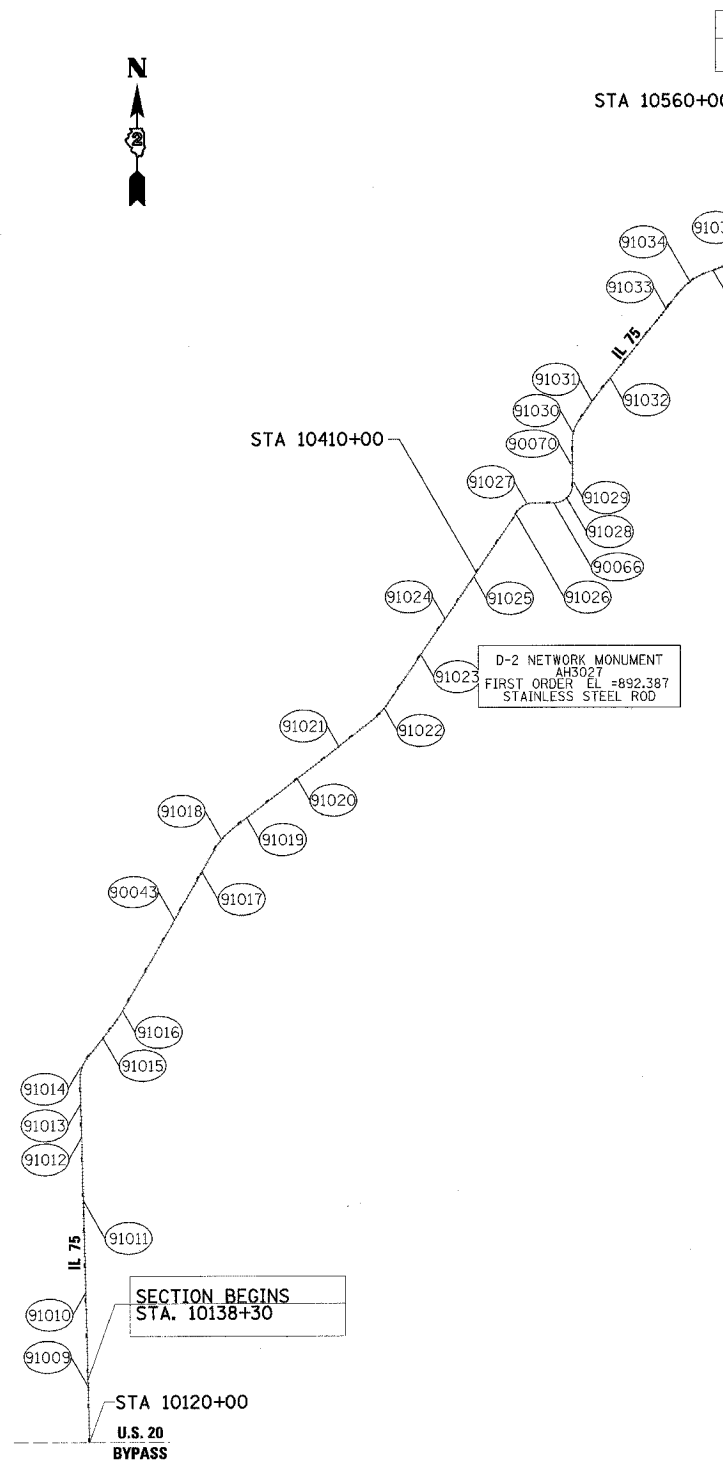

NOTE:
Work around permanent horizontal and vertical monuments will be done in conjunction with the Special Provision for Earth Excavation (Special).

The contractor shall be aware that the cost to replace a GPS monument will be in the millions of dollars. These monuments shall be protected at all costs.

At the end of the project, a State of Illinois survey crew will be dispatched to check if any disturbance has occurred. If a disturbance/damage is detected, the Contractor will coordinate with the State of Illinois Survey Department for proper recourse. If the Contractor disturbs/damages a GPS monument, the Contractor shall be required to replace the monument at his/her expense.

Chain IL75 contains:
CUR 240 CUR 250 CUR 260 CUR 270 CUR 280 CUR 290
CUR 300 CUR 310 CUR 320 CUR 1230 CUR 1250 CUR 330 CUR 340

Beginning chain IL75 description

Curve Data
-----*

Curve 240
P.I. Station 10095+19.74 N 2,054,361.0530 E 2,457,253.8840
Delta = 89° 49' 22.0341" (LT)
Degree = 10° 53' 29.0773"
Tangent = 524.4393'
Length = 824.7122'
Radius = 526.0639'
External = 216.7549'
Long Chord = 742.8153'
Mid. Ord. = 153.5057'
P.C. Station 10089+95.30 N 2,054,346.7981 E 2,456,729.6384
P.T. Station 10098+20.01 N 2,054,885.3401 E 2,457,241.2506
C.C. N 2,054,872.6676 E 2,456,715.3393
Course from PT 240 to PC 250 358° 37' 10.7300" Dist 12,534.1586'

Curve 250
P.I. Station 10227+18.89 N 2,067,780.4776 E 2,456,930.5247
Delta = 40° 12' 15.27" (RT)
Degree = 5° 44' 58.19"
Tangent = 364.72'
Length = 699.27'
Radius = 996.54'
External = 64.65'
Long Chord = 685.01'
Mid. Ord. = 60.71'
P.C. Station 10223+54.17 N 2,067,415.8614 E 2,456,939.3106
P.T. Station 10230+53.43 N 2,068,064.6240 E 2,457,159.1794
C.C. N 2,067,439.8673 E 2,457,935.5568
Course from PT 250 to PC 260 38° 49' 26.0010" Dist 879.4443'

Curve 260
P.I. Station 10244+04.59 N 2,069,117.2791 E 2,458,006.2587
Delta = 9° 05' 14.94" (LT)
Degree = 0° 57' 54.96"
Tangent = 471.71'
Length = 941.45'
Radius = 5,935.74'
External = 18.71'
Long Chord = 940.46'
Mid. Ord. = 18.66'
P.C. Station 10239+32.88 N 2,068,749.7785 E 2,457,710.5282
P.T. Station 10248+74.32 N 2,069,526.8753 E 2,458,240.2333
C.C. N 2,072,471.0669 E 2,453,086.1285
Course from PT 260 to PC 270 29° 44' 11.0654" Dist 5,126.5285'

Curve 270
P.I. Station 10303+77.92 N 2,074,305.7418 E 2,460,970.0766
Delta = 22° 34' 48.10" (RT)
Degree = 3° 02' 00.59"
Tangent = 377.07'
Length = 744.36'
Radius = 1,888.77'
External = 37.27'
Long Chord = 739.55'
Mid. Ord. = 36.55'
P.C. Station 10300+00.85 N 2,073,978.3246 E 2,460,783.0453
P.T. Station 10307+45.21 N 2,074,536.2455 E 2,461,268.4904
C.C. N 2,073,041.4747 E 2,462,423.0958

Course from PT 270 to PC 280 52° 18' 59.1689" Dist 5,033.8339'

Curve 280
P.I. Station 10361+57.00 N 2,077,844.4757 E 2,465,551.3787
Delta = 18° 05' 43.22" (LT)
Degree = 2° 24' 50.08"
Tangent = 377.96'
Length = 749.63'
Radius = 2,373.57'
External = 29.90'
Long Chord = 746.52'
Mid. Ord. = 29.53'
P.C. Station 10357+79.04 N 2,077,613.4284 E 2,465,252.2611
P.T. Station 10365+28.67 N 2,078,157.0012 E 2,465,763.9391
C.C. N 2,079,491.8658 E 2,463,801.3003

Course from PT 280 to PC 290 34° 13' 15.9440" Dist 6,577.2181'

Curve 290
P.I. Station 10433+92.33 N 2,083,832.3805 E 2,469,623.9783
Delta = 55° 49' 22.42" (RT)
Degree = 10° 35' 45.34"
Tangent = 286.44'
Length = 526.83'
Radius = 540.73'
External = 71.18'
Long Chord = 506.24'
Mid. Ord. = 62.90'
P.C. Station 10431+05.89 N 2,083,595.5290 E 2,469,462.8867
P.T. Station 10436+32.72 N 2,083,832.1606 E 2,469,910.4205
C.C. N 2,083,291.4268 E 2,469,910.0053

Course from PT 290 to PC 300 90° 02' 38.3680" Dist 590.7315'

Curve 300
P.I. Station 10447+55.71 N 2,083,831.2984 E 2,471,033.4077
Delta = 90° 20' 30.01" (LT)
Degree = 10° 49' 44.71"
Tangent = 532.26'
Length = 834.25'
Radius = 529.09'
External = 221.40'
Long Chord = 750.48'
Mid. Ord. = 156.08'
P.C. Station 10442+23.45 N 2,083,831.7070 E 2,470,501.1517
P.T. Station 10450+57.70 N 2,084,363.5473 E 2,471,030.6424
C.C. N 2,084,360.7984 E 2,470,501.5580

Course from PT 300 to PC 310 359° 42' 08.3619" Dist 1,212.3708'

Curve 310
P.I. Station 10465+82.91 N 2,085,888.7306 E 2,471,022.7183
Delta = 34° 33' 29.19" (RT)
Degree = 5° 41' 49.85"
Tangent = 312.83'
Length = 606.58'
Radius = 1,005.69'
External = 47.53'
Long Chord = 597.43'
Mid. Ord. = 45.39'
P.C. Station 10462+70.07 N 2,085,575.9017 E 2,471,024.3436
P.T. Station 10468+76.66 N 2,086,147.2832 E 2,471,198.8294
C.C. N 2,085,581.1266 E 2,472,030.0164

Course from PT 310 to PC 320 34° 15' 37.5535" Dist 556.1078'

Curve 320
P.I. Station 10476+79.71 N 2,086,810.9993 E 2,471,650.9145
Delta = 4° 59' 37.53" (RT)
Degree = 1° 00' 42.24"
Tangent = 246.95'
Length = 493.58'
Radius = 5,663.13'
External = 5.3817'
Long Chord = 493.43'
Mid. Ord. = 5.38'
P.C. Station 10474+32.76 N 2,086,606.8993 E 2,471,511.8933
P.T. Station 10479+26.35 N 2,087,002.2232 E 2,471,807.1742
C.C. N 2,083,418.8074 E 2,476,192.4014

Course from PT 320 to PC 1230 39° 15' 15.0876" Dist 1,499.0010'
Point 1230 N 2,088,162.9692 E 2,472,755.6851 Sta 10494+25.35
Course from 1230 to PC 1250 39° 11' 50.1386" Dist 1,207.6734'

Curve 1250
P.I. Station 10507+93.11 N 2,089,222.9463 E 2,473,620.0970
Delta = 1° 01' 07.67" (LT)
Degree = 0° 19' 05.58"
Tangent = 160.08'
Length = 320.16'
Radius = 18,005.33'
External = 0.71'
Long Chord = 320.15'
Mid. Ord. = 0.71'
P.C. Station 10506+33.02 N 2,089,098.8855 E 2,473,518.9253
P.T. Station 10509+53.18 N 2,089,348.7864 E 2,473,719.0468
C.C. N 2,100,478.1164 E 2,459,565.2476

Course from PT 1250 to PC 330 38° 10' 42.4726" Dist 563.5046'

Curve 330
P.I. Station 10520+82.40 N 2,090,236.4506 E 2,474,417.0295
Delta = 33° 06' 14.38" (RT)
Degree = 3° 00' 36.29"
Tangent = 565.71'
Length = 1,099.77'
Radius = 1,903.46'
External = 82.29'
Long Chord = 1,084.54'
Mid. Ord. = 78.88'
P.C. Station 10515+16.69 N 2,089,791.7514 E 2,474,067.3563
P.T. Station 10526+16.46 N 2,090,417.9889 E 2,474,952.8211
C.C. N 2,088,615.1964 E 2,475,563.6479

Course from PT 330 to PC 340 71° 16' 56.8546" Dist 7,540.8058'

Curve 340
P.I. Station 10606+01.00 N 2,092,980.2512 E 2,482,515.0751
Delta = 14° 38' 44.93" (RT)
Degree = 1° 39' 33.62"
Tangent = 443.73'
Length = 882.63'
Radius = 3,452.93'
External = 28.40'
Long Chord = 880.23'
Mid. Ord. = 28.16'
P.C. Station 10601+57.26 N 2,092,837.8557 E 2,482,094.8093
P.T. Station 10610+39.89 N 2,093,011.7586 E 2,482,957.6889
C.C. N 2,089,567.5432 E 2,483,202.8651

REVISIONS	
NAME	DATE

ILLINOIS DEPARTMENT OF TRANSPORTATION
F.A.P. ROUTE 505 (IL 75)

**ILLINOIS ROUTE 75
HORIZONTAL AND
VERTICAL CONTROL SHEETS**

SCALE: VERT. _____
HORIZ. _____
DATE: 12/6/06

DRAWN BY JMC
CHECKED BY DWB

2/6/2006 4:46:57 PM k:\1195600\1175_3p\road\design\horiz & vert\ControlLdgn