

| | | | | |
|---------------------|------------------|------------------|--------------|-----------|
| F.A.P. RTE. | SECTION | COUNTY | TOTAL SHEETS | SHEET NO. |
| 505 | 110RS-1, 111RS-3 | STEPHENSON | 174 | 24 |
| STA. 10160+00 | TO STA. 10190+00 | | | |
| FED. ROAD DIST. NO. | ILLINOIS | FED. AID PROJECT | | |
| CONTRACT NO. 64C32 | | | | |



ELWOOD I. & JUDITH A. STRONG

CLIFFORD W. JR & JEAN A. STOUT

DANIEL A. & PEGGY S. KOCHSMIER
 THOMAS & MILDRED JONES
 BRENDA L. BOYNTON

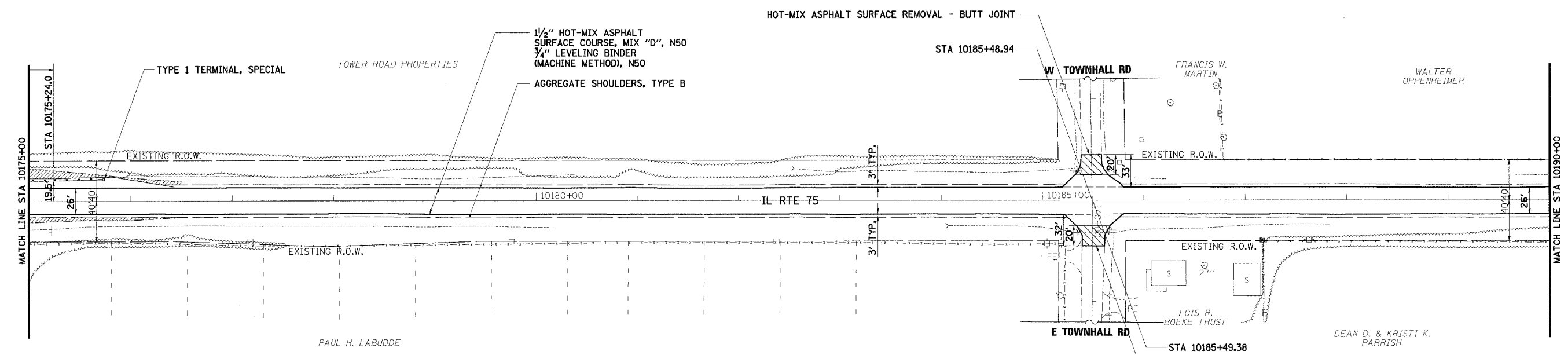
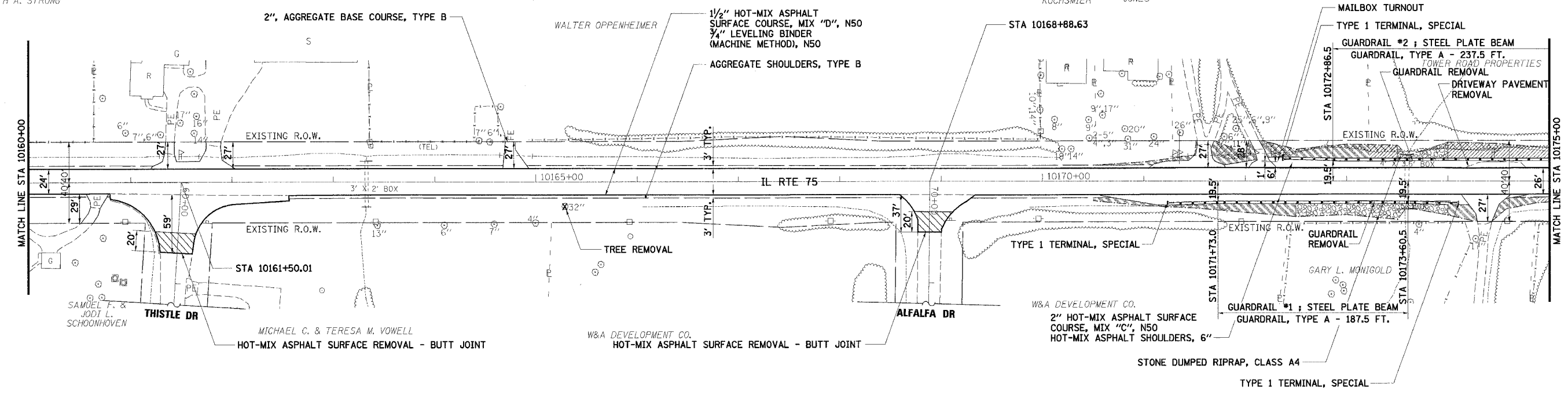

- LEGEND**
- SEEDING, CLASS 1
 - SEEDING, CLASS 2A
 - SEEDING, CLASS 4
 - AGGREGATE DITCH, 12" OR STONE DUMPED RIPRAP, CLASS A4 OR STONE RIPRAP, CLASS A3

- REMOVAL LEGEND**
- TREE REMOVAL, UNIT
 - TREE REMOVAL, ACRE

- NOTES:**
- FOR TURF SHOULDER LIMITS, SEE "SCHEDULE OF TURF SHOULDER" SHEET NO. 12.
 - OVERLAY DRIVEWAYS TO R.O.W. OR AS DESIGNATED IN THE PLANS.
 - RESTRIPE ILLINOIS ROUTE 75 TO MATCH EXISTING CONDITIONS.
 - REMOVE ALL EXISTING RAISED REFLECTIVE PAVEMENT MARKINGS.

| REVISIONS | |
|-----------|------|
| NAME | DATE |
| | |
| | |
| | |
| | |
| | |
| | |
| | |
| | |
| | |
| | |

ILLINOIS DEPARTMENT OF TRANSPORTATION
 F.A.P. ROUTE 505 (IL 75)
ILLINOIS ROUTE 75
PLAN
STA 10160+00 TO STA 10190+00

SCALE: VERT. 1" = 50'
 HORIZ. 1" = 50'
 DATE: 12/6/06

DRAWN BY JMC
 CHECKED BY DWB

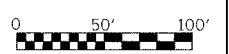

12/17/2006 8:50:22 AM K:\1109500\1175_3p\cadd\design\PLN02.dgn