

F.A.P. RTE.	SECTION	COUNTY	TOTAL SHEETS	SHEET NO.
505	110RS-1, 111RS-3	STEPHENSON	174	34
STA. 10325+00	TO STA. 10340+00			
FED. ROAD DIST. NO.	ILLINOIS	FED. AID PROJECT		
CONTRACT NO. 64C32				

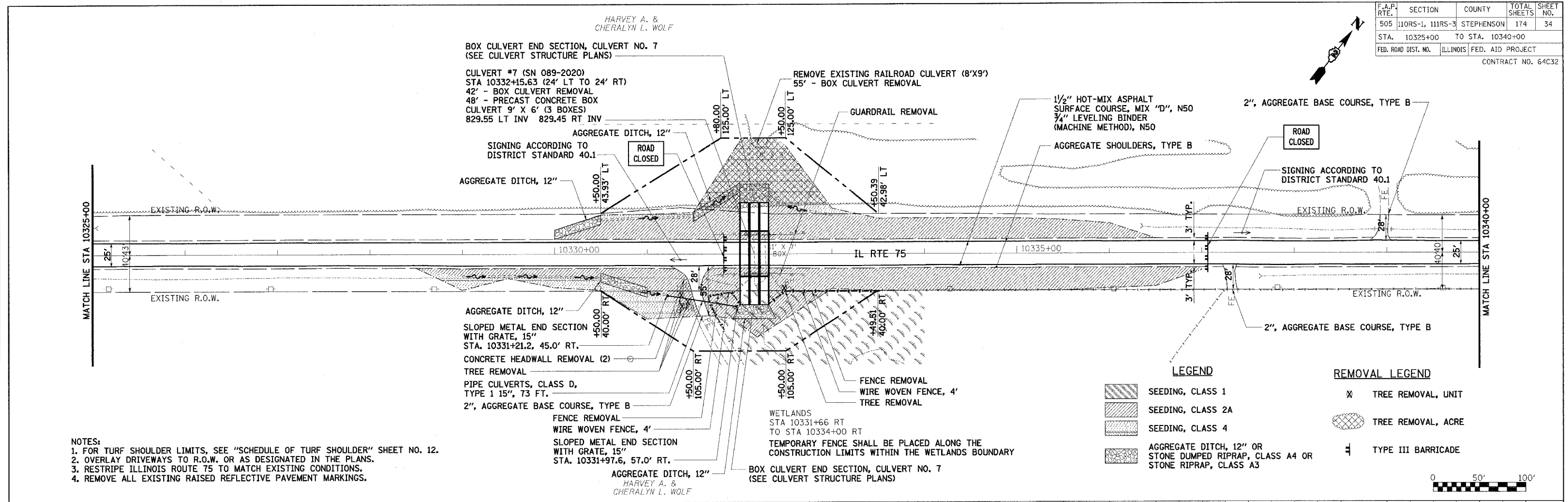

DATE	BY
DATE	BY
DATE	BY

DATE	BY
DATE	BY
DATE	BY



- NOTES:
1. FOR TURF SHOULDER LIMITS, SEE "SCHEDULE OF TURF SHOULDER" SHEET NO. 12.
 2. OVERLAY DRIVEWAYS TO R.O.W. OR AS DESIGNATED IN THE PLANS.
 3. RESTRIPE ILLINOIS ROUTE 75 TO MATCH EXISTING CONDITIONS.
 4. REMOVE ALL EXISTING RAISED REFLECTIVE PAVEMENT MARKINGS.

LEGEND		REMOVAL LEGEND	
	SEEDING, CLASS 1		TREE REMOVAL, UNIT
	SEEDING, CLASS 2A		TREE REMOVAL, ACRE
	SEEDING, CLASS 4		TYPE III BARRICADE
	AGGREGATE DITCH, 12" OR STONE DUMPED RIPRAP, CLASS A4 OR STONE RIPRAP, CLASS A3		

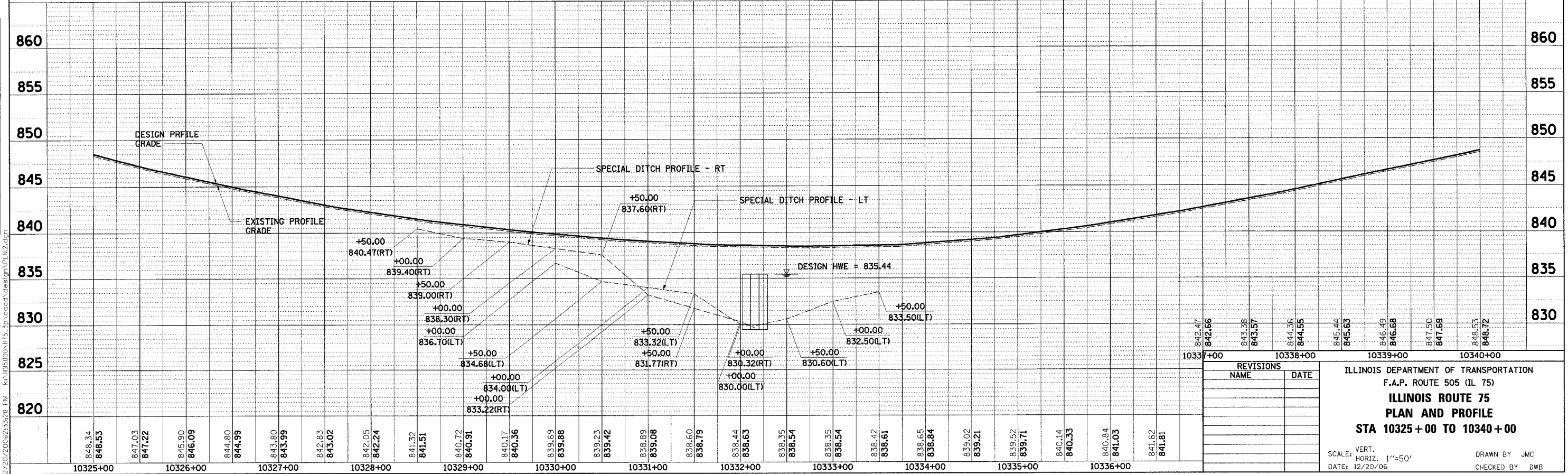
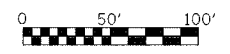

REVISIONS	NAME	DATE

ILLINOIS DEPARTMENT OF TRANSPORTATION
 F.A.P. ROUTE 505 (IL 75)
ILLINOIS ROUTE 75
PLAN AND PROFILE
STA 10325 + 00 TO 10340 + 00

SCALE: VERT. 1"=20'
 HORIZ. 1"=50'
 DATE: 12/20/06

DRAWN BY JMC
 CHECKED BY DWB

12/20/2006 2:33:28 PM K:\V\8800\1175_3p.ccd\design\pl\N2.dgn