

| | | | | |
|---------------------|------------------|------------------|--------------|-----------|
| F.A.P. RTE. | SECTION | COUNTY | TOTAL SHEETS | SHEET NO. |
| 505 | 110RS-1, 111RS-3 | STEPHENSON | 174 | 42 |
| STA. | TO STA. | | | |
| FED. ROAD DIST. NO. | ILLINOIS | FED. AID PROJECT | | |
| CONTRACT NO. 64C32 | | | | |

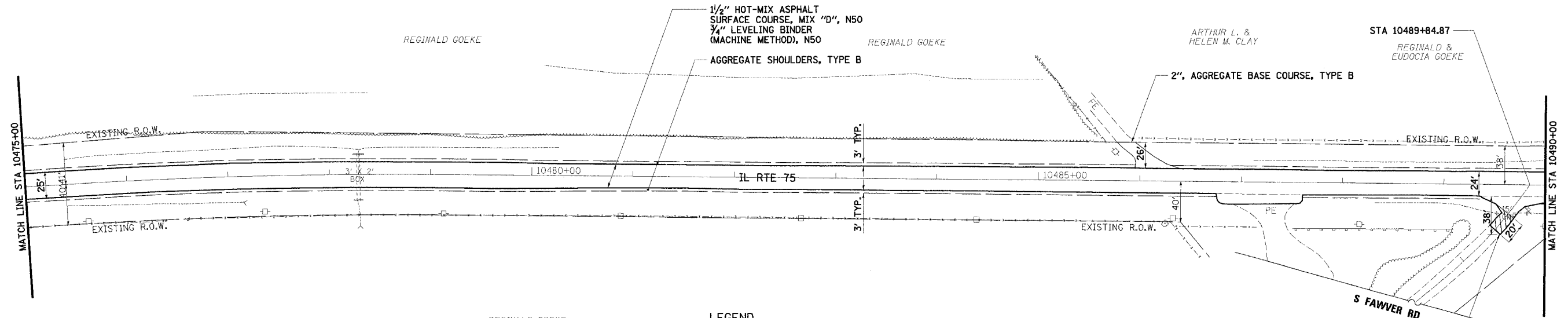
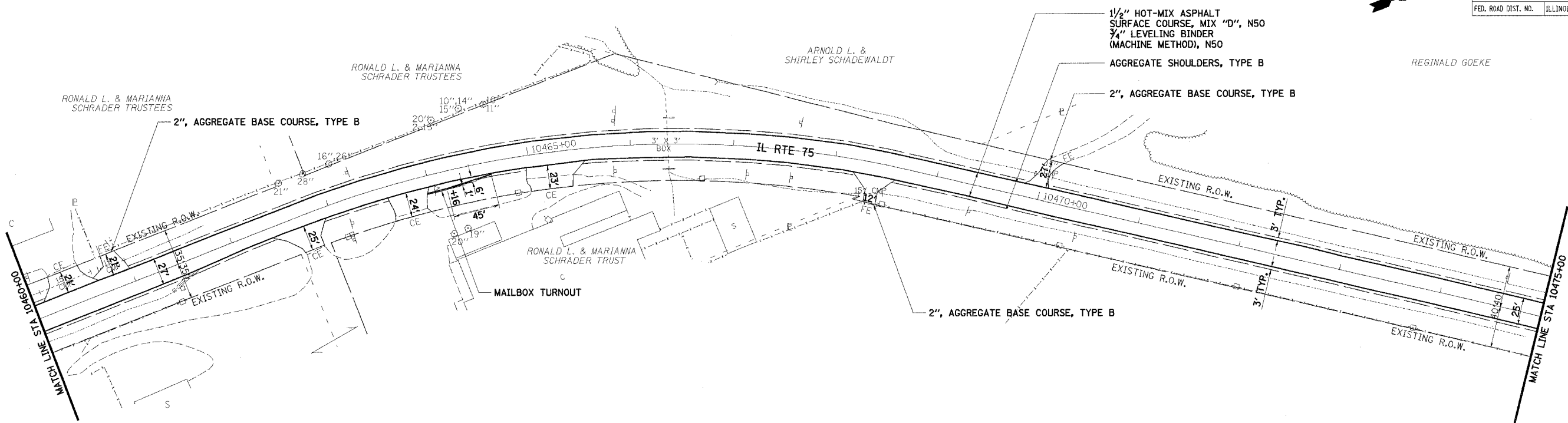
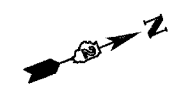

LEGEND

| | | | |
|--|---|--|--------------------|
| | SEEDING, CLASS 1 | | TREE REMOVAL, UNIT |
| | SEEDING, CLASS 2A | | TREE REMOVAL, ACRE |
| | SEEDING, CLASS 4 | | |
| | AGGREGATE DITCH, 12" OR STONE DUMPED RIPRAP, CLASS A4 OR STONE RIPRAP, CLASS A3 | | |

HOT-MIX ASPHALT SURFACE REMOVAL - BUTT JOINT

- NOTES:**
1. FOR TURF SHOULDER LIMITS, SEE "SCHEDULE OF TURF SHOULDER" SHEET NO. 12.
 2. OVERLAY DRIVEWAYS TO R.O.W. OR AS DESIGNATED IN THE PLANS.
 3. RESTRIPE ILLINOIS ROUTE 75 TO MATCH EXISTING CONDITIONS.
 4. REMOVE ALL EXISTING RAISED REFLECTIVE PAVEMENT MARKINGS.

| REVISIONS | |
|-----------|------|
| NAME | DATE |
| | |
| | |
| | |
| | |
| | |
| | |
| | |
| | |
| | |
| | |

ILLINOIS DEPARTMENT OF TRANSPORTATION
 F.A.P. ROUTE 505 (IL 75)
ILLINOIS ROUTE 75
PLAN
STA 10460+00 TO 10490+00

SCALE: VERT. 1" = 50'
 HORIZ. 1" = 50'
 DATE: 12/6/06

DRAWN BY JMC
 CHECKED BY DWB

12/7/2006 8:50:40 AM K:\1195800\1175_3p\ceadd\design\PLAN20.dgn