

CONTRACT NO. 66400

F.A.S. RTE.	SECTION	COUNTY	TOTAL SHEETS	SHEET NO.
1279	*	LASALLE	43	13
STA.	TO STA.			
FED. ROAD DIST. NO. 4   ILLINOIS   FED. AID PROJECT				
* I-RS, (106,107)RS-2, 108RS-1 & I				

Roger & Sandra Harbeck  
 Tax ID # 22-04-100-001, 22-04-100-002  
 Proposed Right of Way = 0.13 acres

PLAN	DATE
SURVEYED	
PLotted	
CHECKED	
BY ROADWAY	
NO. OF WAY CHECKED	
NO. OF FILE NAME	

PROFILE	DATE
SURVEYED	
PLotted	
CHECKED	
BY ROADWAY	
NO. OF WAY CHECKED	
NO. OF FILE NAME	

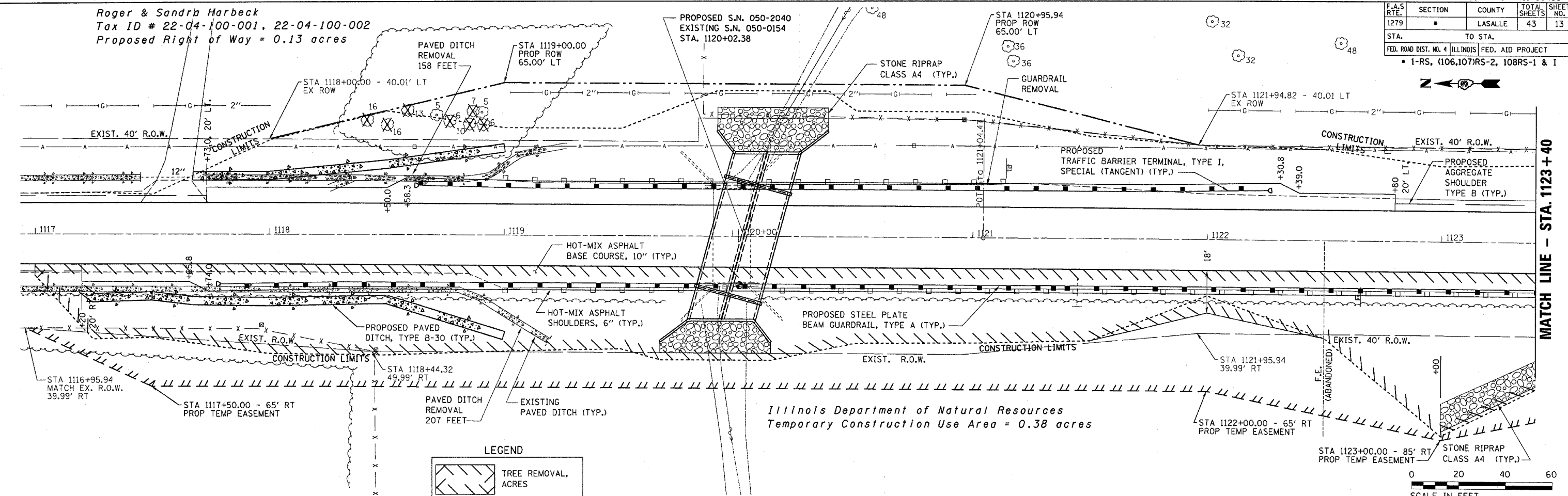

Illinois Department of Natural Resources  
 Temporary Construction Use Area = 0.38 acres

**LEGEND**

TREE REMOVAL, ACRES

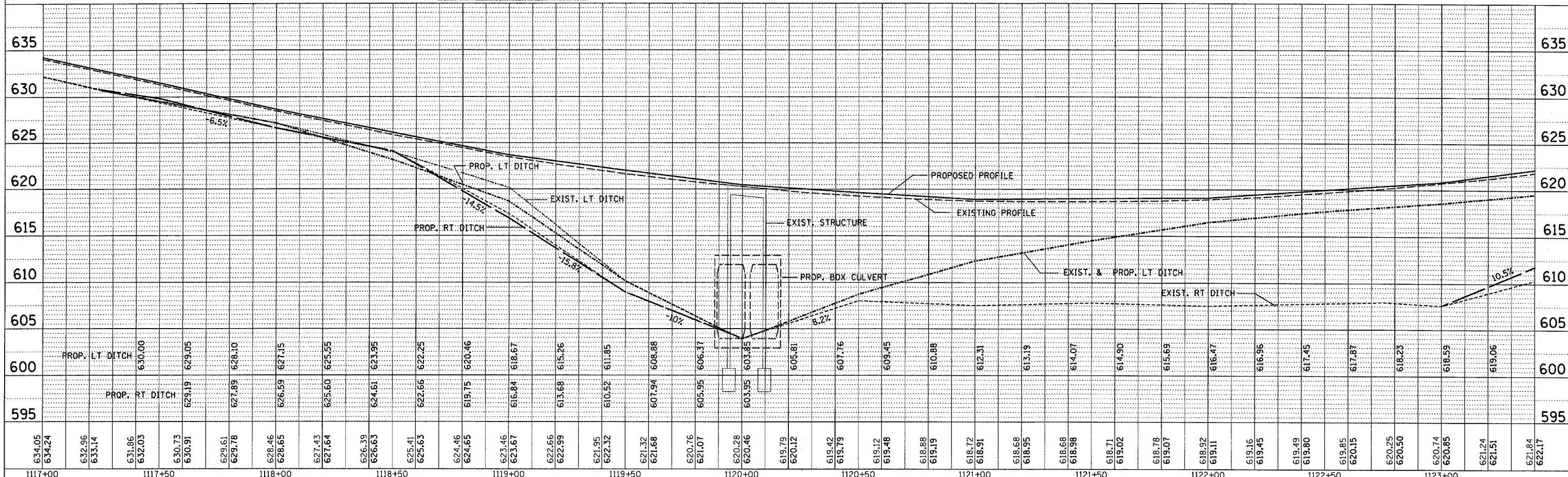

4/11/2007 4:28:15 PM  
 c:\proj\sects\ep22001\consu\1\lpr\shp\ep2.dgn

PLAN AND PROFILE AT S.N. 050-2040