

F.A.P. RTE.	SECTION	COUNTY	TOTAL SHEETS	SHEET NO.
786	(109,110,111)RS-3	LASALLE	20	14
STA.		TO STA.		
FED. ROAD DIST. NO.	ILLINOIS	FED. AID PROJECT		

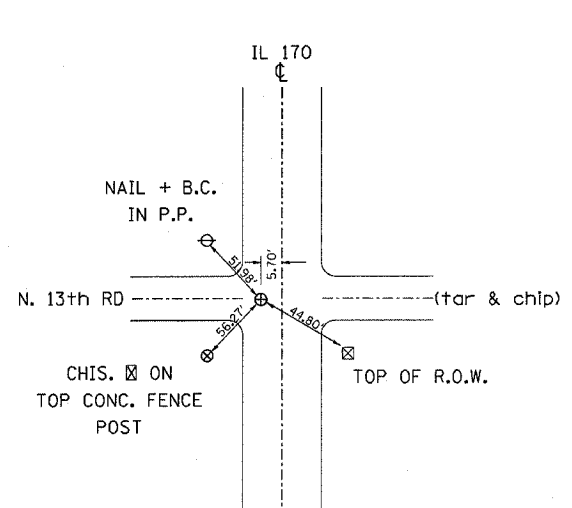

Brass Disk 5.70' W. of \pm IL 170
 S.W. CORNER SECTION 27
 T. 31 N., R. 5 E.
 3rd P.M., LASALLE COUNTY

REPLACE WITH SURVEY SPIKE

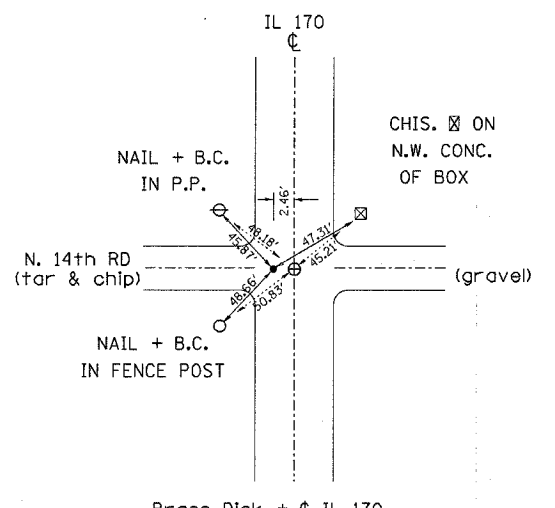

Brass Disk \pm \pm IL 170
 (Control Pt. Possibly P.O.T.)
 P.K. Nail \pm 2.46' W. of \pm IL 170
 S.W. CORNER SECTION 22
 T. 31 N., R. 5 E.
 3rd P.M., LASALLE COUNTY

REPLACE WITH SURVEY SPIKE

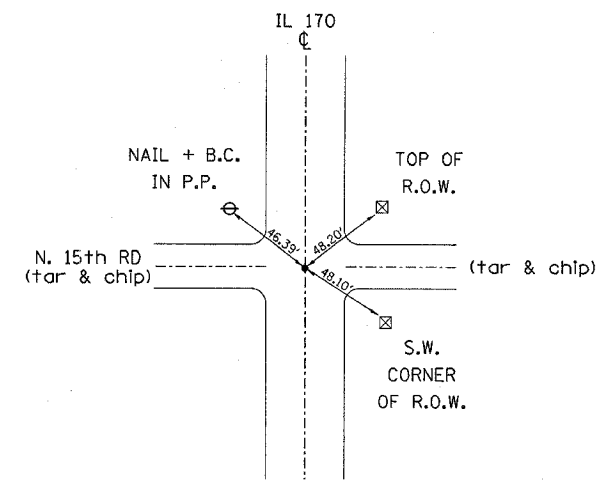

P.K. Nail \pm \pm IL 170
 N.W. CORNER SECTION 22
 T. 31 N., R. 5 E.
 3rd P.M., LASALLE COUNTY

REPLACE WITH PK NAIL

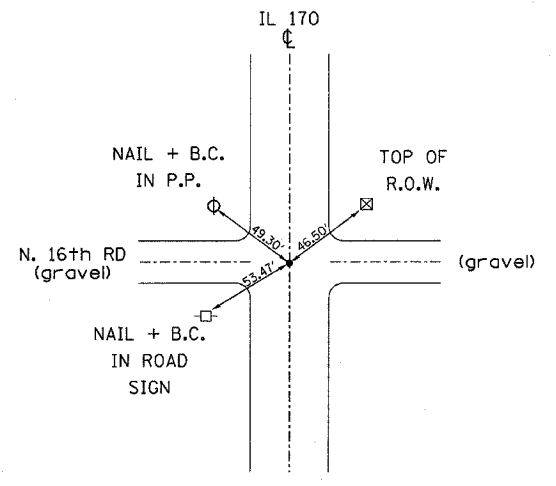

Survey Nail +/- of \pm IL 170
 S.W. CORNER SECTION 10
 T. 31 N., R. 5 E.
 3rd P.M., LASALLE COUNTY

REPLACE WITH SURVEY SPIKE

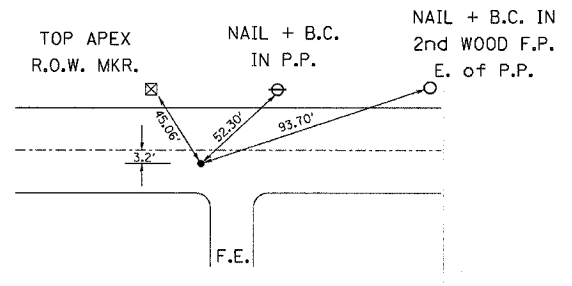

Brass Disk 3.0' S of \pm IL 170
 S.1/4 CORNER SECTION 3
 T. 31 N., R. 5 E.
 3rd P.M., LASALLE COUNTY

PERMANENT SURVEY MARKER TYPE 1 - 1 EACH

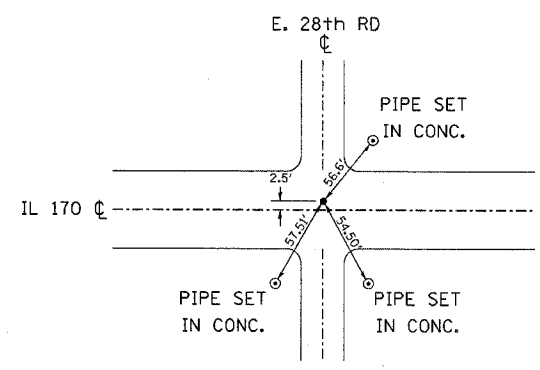

P.K. Nail \pm 2.5' N. of \pm IL 170
 S.W. CORNER SECTION 2
 T. 31 N., R. 5 E.
 3rd P.M., LASALLE COUNTY

REPLACE WITH PK NAIL



4/12/2007 11:18:43 AM
 c:\p07\ec\3904\03904\detail11s.dgn
 ED03904\DETAILS.DGN

ALLEN TOWNSHIP

ILLINOIS DEPARTMENT OF TRANSPORTATION

TIE POINTS

SCALE: VERT. _____
 HORIZ. _____
 DATE _____ DRAWN BY _____
 CHECKED BY _____