

F.A. RTE.	SECTION	COUNTY	TOTAL SHEETS	SHEET NO.
5952	Q-BR	GRUNDY	86	1

D-93-056-05
P-93-023-96

STATE OF ILLINOIS
DEPARTMENT OF TRANSPORTATION
DIVISION OF HIGHWAYS

**PROPOSED
HIGHWAY PLANS**

FAU ROUTE 5952 /SBI 7 (U.S. RTE. 6)
SECTION Q-BR
PROJECT M-5952 (003)
GRUNDY COUNTY

C - 93 - 099 - 05

PROJECT DESCRIPTION

BRIDGE AND APPROACH ROADWAY RECONSTRUCTION
WITH PROVISIONS FOR FUTURE RECONSTRUCTION
OF ADJACENT ROADWAY

EXIST. S.N. 032-0076

PROP. S.N. 032-0107

STRUCTURE LENGTH: 147'
EXISTING SUPERSTRUCTURE
AND SUBSTRUCTURE
REPLACEMENT

END IMPROVEMENT

STA 460+85.00

BEGIN IMPROVEMENT

STA 440+11.00

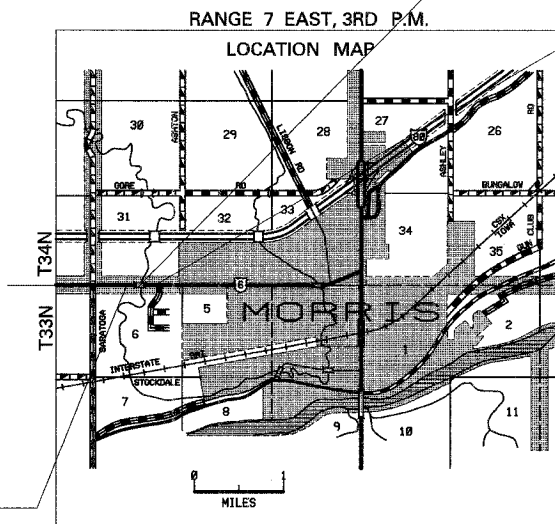

GROSS LENGTH = 2074 FT. = 0.39 MI.
NET LENGTH = 1927 FT. = 0.36 MI.

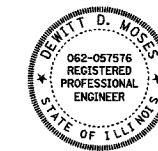

DATE: March 19, 2007
LICENSE EXPIRES November 30, 2007

BOWMAN, BARRETT & ASSOCIATES INC.
CONSULTING ENGINEERS
130 E. RANDOLPH STREET
CHICAGO, ILLINOIS 60601
JOB NO. 541

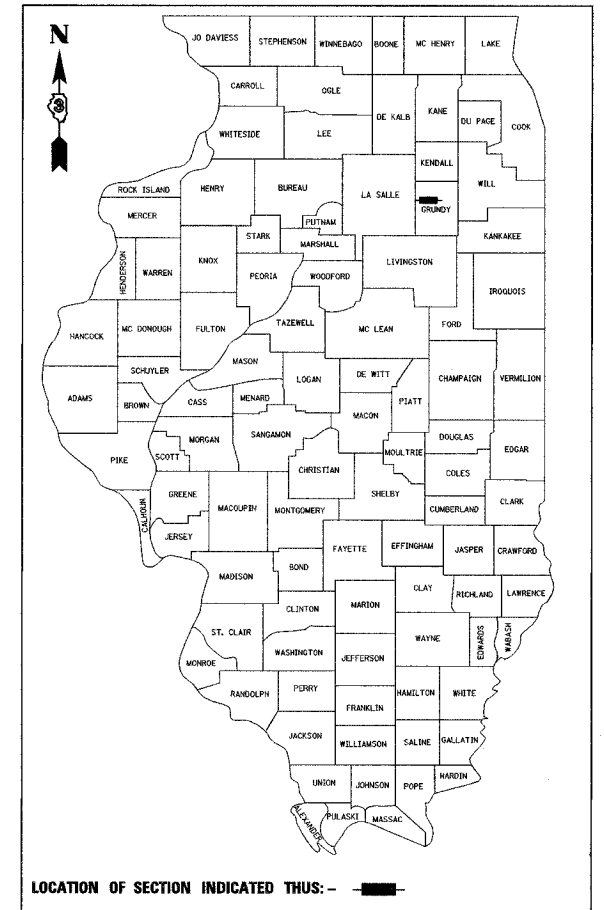

LOCATION OF SECTION INDICATED THUS: [shaded box]

MINOR ARTERIAL
2005 ADT 6,300
93% P.C. 4% S.U. 3% M.U.

STATE OF ILLINOIS
DEPARTMENT OF TRANSPORTATION
DIVISION OF HIGHWAYS

SUBMITTED March 23 20 07
George R. Brown
DEPUTY DIRECTOR OF HIGHWAYS, REGION ENGINEER
May 11, 2007
Eric E. Haralick
ENGINEER OF DESIGN AND ENVIRONMENT
May 11, 2007
Milton R. Sepp, P.E.
DIRECTOR OF HIGHWAYS, CHIEF ENGINEER

**PRINTED BY THE AUTHORITY
OF THE STATE OF ILLINOIS**

FOR INDEX OF SHEETS, SEE SHEET NO. 2

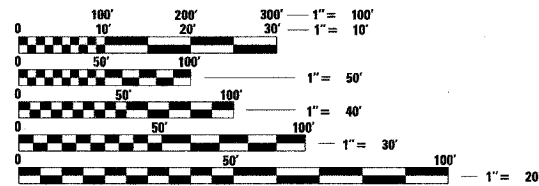

FULL SIZE PLANS HAVE BEEN PREPARED USING STANDARD
ENGINEERING SCALES. REDUCED SIZED PLANS WILL NOT
CONFORM TO STANDARD SCALES. IN MAKING MEASUREMENTS
ON REDUCED PLANS, THE ABOVE SCALES MAY BE USED.

MICROFILMED _____
REEL NUMBER _____
AWARDED _____
RESIDENT ENGINEER _____
AS BUILT CHANGES WERE MADE
ON THE FOLLOWING SHEETS _____

J.U.L.I.E.
JOINT UTILITY LOCATION INFORMATION FOR EXCAVATION
1-800-892-0123

DISTRICT 3 NO. (815) 434-6131

PROJECT ENGINEER: D. BROVIAK
UNIT CHIEF: B. DUNCAN
TOWNSHIP: MORRIS /SARATOGA
CONTRACT NO. 66594

3/19/2007 2:45:28 PM
M:\SAR\cadd\ctv\66594_North\66594-HEC501.nc.dgn