

STATE OF ILLINOIS
DEPARTMENT OF TRANSPORTATION

ROUTE NO.	SECTION	COUNTY	DISTRICT	SHEET NO.	SHEET NO. 51
S.B.L.	①	GRUNDY	86	74	OF 57 SHEETS
F.A.U. NO.					
FED. ROAD DIST. NO. 7	ILLINOIS	FED. AID PROJECT			

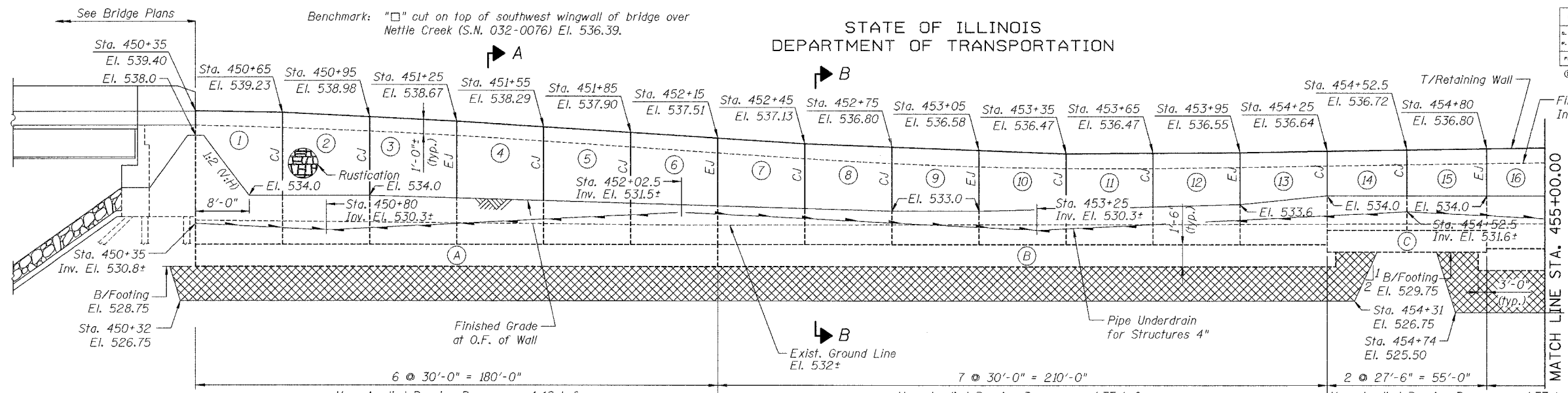

APPROVED
FOR STRUCTURAL ADEQUACY ONLY
Relativ E. Anderson, J. 1910
ENGINEER OF BRIDGES AND STRUCTURES



Brian L. Umbright
Date: March 19, 2007
License Expires: November 30, 2008

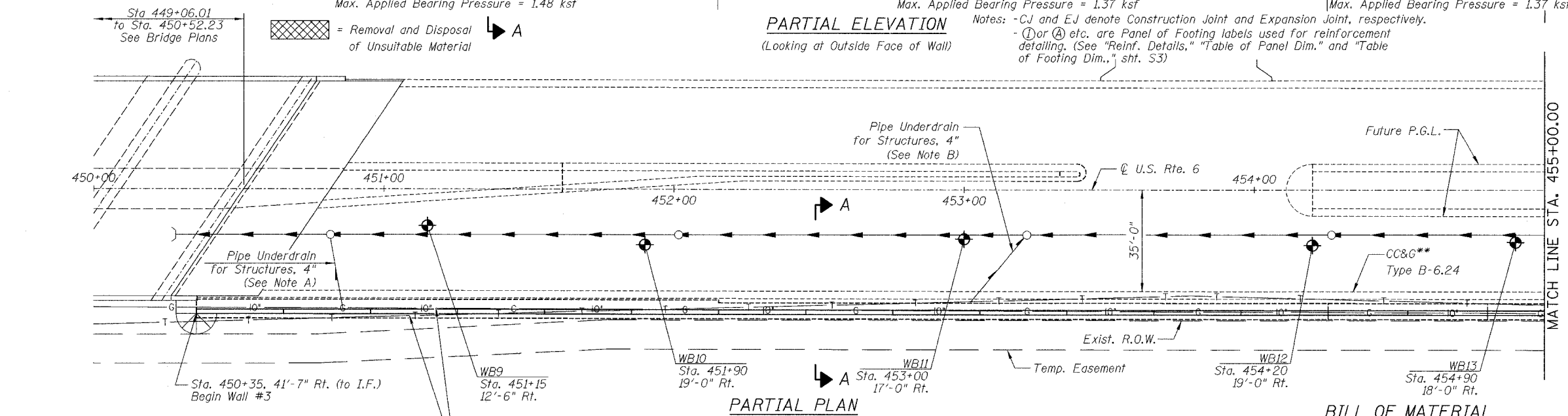

Allowable Soil Bearing Pressure = 2.0 ksf
Note A: Connect to manhole #202 at Inv. El. 530.0+. Pipe Underdrains to have 1% minimum slope.
Note B: Connect to manhole #202 at Inv. El. 530.0+. Pipe Underdrains to have 1% minimum slope.

BILL OF MATERIAL

ITEM	UNIT	TOTAL
Structure Excavation	Cu. Yd.	1,010
Porous Granular Embankment, Special	Cu. Yd.	1,521
Concrete Structures	Cu. Yd.	614.2
Reinforcement Bars, Epoxy Coated	Pound	64,490
Rustication Finish	Sq. Ft.	4,791
Geocomposite Wall Drain	Sq. Yd.	626
Pipe Underdrains for Structures 4"	Foot	1,052
Removal and Disposal of Unsuitable Material	Cu. Yd.	827
Protective Coat	Sq. Yd.	210

** Plan view shows final future condition, see Roadway Plans and Cross Sections for limits of improvements for this contract.

LEGEND

- T — Existing Telephone Line
- G — Existing Gas Line
- S — Existing Storm Sewer
- P — Proposed Storm Sewer
- U — Proposed Underdrain

GENERAL NOTES

Protective Coat shall be applied to the top and exposed inside face of wall.
See sheet S3 for Section A-A and Wall Details.
The limits and quantities of removal and replacement shown are based on the boring data and may be modified by the Engineer for variable subsurface conditions encountered in the field.
The gradations of the soil used to replace the unsuitable material shall be CA-5 or CA-7. See Special Provisions for Porous Granular Embankment (Special).
Lateral limits for Removal and Replacement of Unsuitable Material are 2'-0" beyond the footing edge on each side.
Rustication Finish shall extend a minimum of 1'-0" below finished grade and to 3" from top of wall.
All cast-in-place stem concrete shall be integrally colored, see Special Provision "Colored Concrete, Cast-In-Place".
Contractor shall coordinate retaining wall construction with bridge wing wall construction and sequencing as required.

⊕ Denotes Soil Boring location

DESIGN SPECIFICATIONS

1996 AASHTO with 1997 thru 2002 Interims

DESIGN STRESSES

FIELD UNITS

$f'_c = 3,500$ psi
 $f_y = 60,000$ psi (reinforcement)

BOWMAN, BARRETT & ASSOCIATES INC.
CONSULTING ENGINEERS
130 E. RANDOLPH STREET
CHICAGO, ILLINOIS 60601
JOB NO. 541



GENERAL PLAN & ELEVATION 1

RETAINING WALL #3
STA. 450+35 TO STA. 459+80
U.S. ROUTE 6
FAU 5952-SEC. Q-BR
GRUNDY COUNTY
S.N. 032-8803

PROFILE GRADE LINE
9' RT. & LT. OF C U.S. ROUTE 6
Future P.G.L. see Roadway Plans for limits of work this contract

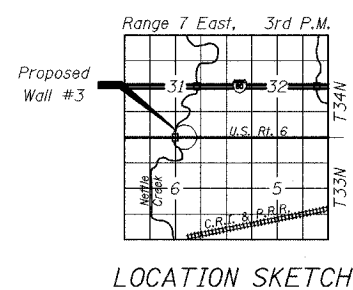

DESIGNED	BLU
CHECKED	MRM
DRAWN	MRM
CHECKED	BLU

DATE: 3/19/07