

FAU	SECTION	COUNTY	TOTAL SHEETS	SHEET NO.
5645	(116,117)RS-3	BUREAU	10	1

D-93-056-06

**INDEX OF SHEETS**

- 1 COVERSHEET
- 2 GENERAL NOTES
- 3 SUMMARY OF QUANTITIES
- 4-5 TYPICAL SECTION
- 6-7 SCHEDULES
- 8-10 DETAILS

**HIGHWAY STANDARDS**

- 000001-04 STANDARD SYMBOLS, ABBREVIATIONS AND PATTERNS
- 001006 DECIMAL OF AN INCH AND OF A FOOT
- 406201 MAILBOX TURNOUT
- 701001-01 OFF-ROAD OPERATIONS 2L, 2W, MORE THAN 4.5 m (15') AWAY
- 701006-02 OFF-ROAD OPERATIONS 2L, 2W, 4.5 m (15') TO 600 mm (24") FROM
- 701011-01 OFF-ROAD MOVING OPERATIONS 2L, 2W, DAY ONLY FOR SPEEDS > 45 MPH
- 701301-02 LANE CLOSURE, 2L, 2W, SHORT TIME OPERATIONS
- 701306-01 LANE CLOSURE, 2L, 2W, SLOW MOVING OPERATIONS DAY ONLY, FOR SPEEDS > 45 MPH
- 701311-02 LANE CLOSURE, 2-L, 2-W, MOVING DAY ONLY OPERATIONS
- 701501-03 URBAN LANE CLOSURE, 2L, 2W, UNDIVIDED
- 702001-06 TRAFFIC CONTROL DEVICES
- 780001-01 TYPICAL PAVEMENT MARKINGS
- 781001-02 TYPICAL APPLICATIONS, RAISED REFLECTIVE PAVEMENT MARKERS

FULL SIZE PLANS HAVE BEEN PREPARED USING STANDARD ENGINEERING SCALES, REDUCED SIZED PLANS WILL NOT CONFORM TO STANDARD SCALES, IN MAKING MEASUREMENTS ON REDUCED PLANS, THE ABOVE SCALES MAY BE USED.

MICROFILMED \_\_\_\_\_  
 REEL NUMBER \_\_\_\_\_  
 AWARDED \_\_\_\_\_  
 RESIDENT ENGINEER \_\_\_\_\_  
 AS BUILT CHANGES WERE MADE ON THE FOLLOWING SHEETS \_\_\_\_\_

JULIE 1-800-892-0123

DISTRICT 3 NO. (815) 434-6131

PROJECT ENGINEER: JOE KANNEL  
 UNIT CHIEF: PAT BRABOY  
 TOWNSHIP: PRINCETON

CONTRACT NO. 66683

STATE OF ILLINOIS  
 DEPARTMENT OF TRANSPORTATION  
 DIVISION OF HIGHWAYS

**PROPOSED  
 HIGHWAY PLANS**

**FAU 5645 SOUTH MAIN ST  
 SECTION: (116,117)RS-3  
 PROJECT M-5645(001)  
 BUREAU COUNTY**

C - 93 - 112 - 06

**PROJECT DESCRIPTION**

**PARK AVE TO THE END OF FAU 5645 (S OF S CITY LIMITS IN PRINCETON)**

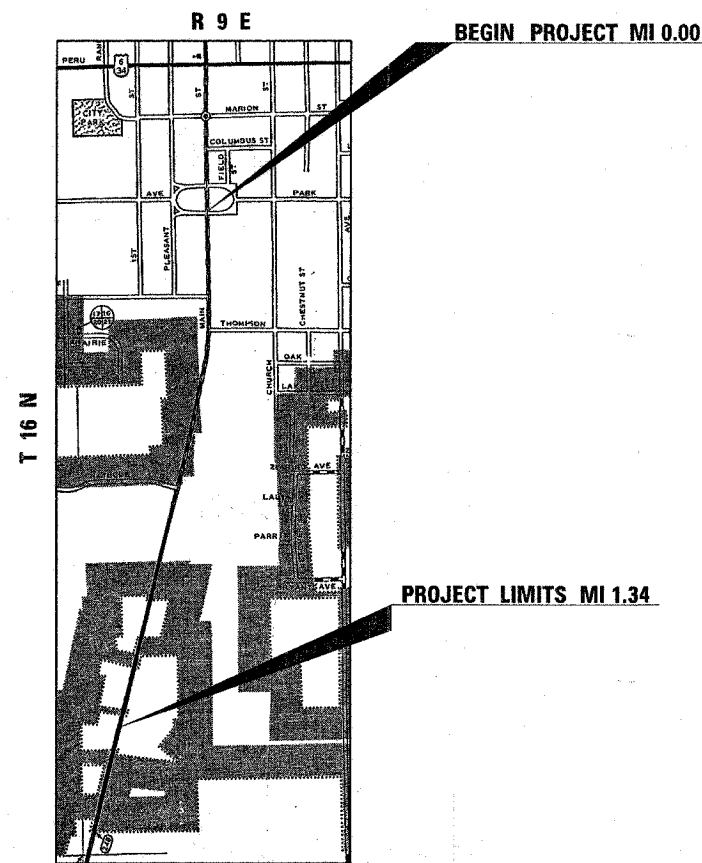

LOCATION MAP  
 NOT TO SCALE

GROSS LENGTH = 7075.2 FT = 1.34 MI  
 NET LENGTH = 7075.2 FT = 1.34 MI

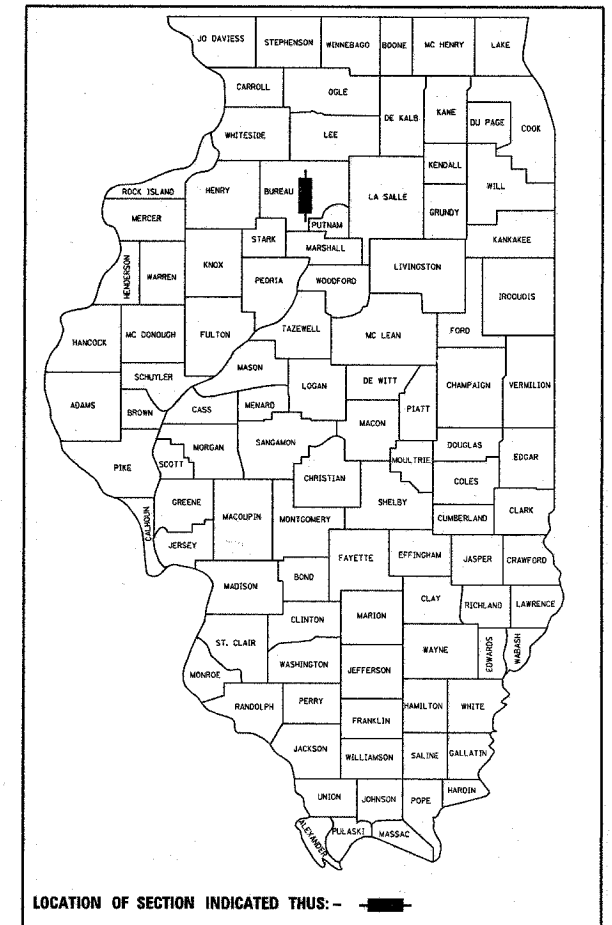

LOCATION OF SECTION INDICATED THUS: - ■ -

MINOR ARTERIAL (URBAN)

2007 ADT = 5100

P.V. = 97.0 % S.U. = 2.0 % M.U. = 1.0 %

STATE OF ILLINOIS  
 DEPARTMENT OF TRANSPORTATION  
 DIVISION OF HIGHWAYS

SUBMITTED March 23, 20 07  
George Dargatzis  
 DEPUTY DIRECTOR OF HIGHWAYS, REGION ENGINEER  
May 11, 20 07  
Eric E. Shuman  
 INTERIM ENGINEER OF DESIGN AND ENVIRONMENT  
May 11, 20 07  
Milton R. Swo, P.E.  
 DIRECTOR OF HIGHWAYS, CHIEF ENGINEER

PRINTED BY THE AUTHORITY  
 OF THE STATE OF ILLINOIS

FAU RTE	SECTION	COUNTY	TOTAL SHEETS	SHEET NO.
5645	(116,117)RS-3	BUREAU	10	2
STA.		TO STA.		
FED. ROAD DIST. NO.		BLDGNS	FED. AID PROJECT	

**GENERAL NOTES**

(Revised October 5, 2006)

THE THICKNESS OF HMA SHOWN ON THE PLANS IS THE NOMINAL THICKNESS. DEVIATIONS FROM THE NOMINAL THICKNESS WILL BE PERMITTED WHEN SUCH DEVIATIONS OCCUR DUE TO IRREGULARITIES IN THE EXISTING SURFACE OR BASE ON WHICH THE HMA IS PLACED.

THE HMA SURFACE OF ALL MAILBOX TURNOUTS, PRIVATE ENTRANCES, COMMERCIAL ENTRANCES, AND SIDE ROADS SHALL BE MADE NEATLY, IN A WORKMANLIKE MANNER, AND SHALL ACCURATELY CONFORM TO THE SHAPES AND DIMENSIONS SHOWN ON THE PLAN DETAILS. IF REQUIRED BY THE ENGINEER, THE CONTRACTOR SHALL BE REQUIRED TO SAW CUT THE HMA SURFACE TO CONFORM TO THE SHAPES AND DIMENSIONS SHOWN ON THE PLAN DETAILS. THIS WORK SHALL BE INCLUDED IN THE COST OF THE HMA SURFACE

EXCEPT AS NOTED ON THE PLANS, PAVEMENT GRADES SHOWN ARE AT THE TOP OF PAVEMENT SURFACES.

THE ENGINEER WILL BE THE SOLE JUDGE CONCERNING CURING TIME FOR THE VARIOUS HMA LIFTS.

SEEDING SHALL NOT BE PERMITTED AT ANY TIME WHEN THE GROUND IS FROZEN, WET, OR IN AN UNTILLABLE CONDITION. LOCATIONS TO BE SEEDED WILL BE DETERMINED BY THE ENGINEER.

IN AREAS OF FURNISHED EXCAVATION, SEEDING, FERTILIZER, AND MULCH SHALL BE CONSTRUCTED TO SECTION 250 OF THE STANDARD SPECIFICATION. THIS WORK WILL NOT BE PAID FOR SEPERATLY, BUT INCLUDED IN THE COST OF FURNISHED EXCAVATION.

ADDITIONAL LEVELING BINDER HAS BEEN ADDED TO THE PLANS IN CASE MORE OF THE EXISTING BITUMINOUS MATERIAL COMES OFF THE BRICK PAVEMENT DURING THE MILLING OPERATION

ANY REFERENCE TO A STANDARD IN THESE PLANS SHALL BE INTERPRETED TO MEAN THE EDITION AS INDICATED BY THE SUBNUMBER SHOWN IN THE LIST OF STANDARDS INCLUDED IN THESE PLANS.

THE FOLLOWING RATES OF APPLICATION HAVE BEEN USED IN CALCULATING PLAN QUANTITIES:

GRANULAR MATERIALS	2.05	TONS / CU YD
BITUMINOUS MAT PRIME COAT	0.08	GAL / SQ YD OR
	0.375	GAL / SQ YD
AGGREGATE PRIME COAT	0.002	TONS / SQ YD
HMA RESURFACING	112	LBS / SQ YD / IN
SHORT TERM PAVEMENT MARKING	10	FT /100 FT OF APPLICATION
MIX FOR CRACKS, JTS & FLGWYS	0.0003	TONS / SQ YD
LEVEL BINDER (HAND METHOD)	0.0005	TONS / SQ YD

ALL DAMAGE TO DEPARTMENT OWNED UNDERGROUND FACILITIES, CAUSED BY THE CONTRACTOR SHALL BE REPAIRED TO THE SATISFACTION OF THE DEPARTMENT AT THE CONTRACTOR'S EXPENSE. THIS SHALL INCLUDE ALL TEMPORARY REPAIRS REQUIRED TO KEEP THE FACILITY OPERATIONAL WHILE MATERIAL IS BEING OBTAINED TO MAKE PERMANENT REPAIRS. SPLICING OF ELECTRIC CABLE SHALL NOT BE ALLOWED. ELECTRIC CABLE SHALL BE REPLACED FROM POLE TO POLE OR CONTROLLER.

STATE OF ILLINOIS  
DEPARTMENT OF TRANSPORTATION  
DISTRICT THREE

PREPARED BY: Paul Powell  
DISTRICT STUDIES & PLANS ENGINEER

DATE: March 23, 2007

EXAMINED BY: Herbert K. ...  
DISTRICT CONSTRUCTION ENGINEER

Matt ...  
DISTRICT MATERIALS ENGINEER

... ..  
DISTRICT OPERATIONS ENGINEER

FAU RTE	SECTION	COUNTY	TOTAL SHEETS	SHEET NO.
5645	(116,117)RS-3	BUREAU	10	3
FED. ROAD DIST. NO.		ILLINOIS	FED. AID PROJECT	

SUMMARY OF QUANTITIES				80% FEDERAL 20% STATE	
CODE NO.	ITEM	UNIT	URBAN TOTAL QUANTITY	CONSTRUCTION TYPE CODE	
				ROADWAY I000	
20400800	FURNISHED EXCAVATION	CU YD	2	2	
40600100	BITUMINOUS MATERIALS (PRIME COAT)	GALLON	2222	2222	
40600300	AGGREGATE (PRIME COAT)	TON	56	56	
40600400	MIXTURE FOR CRACKS, JOINTS, AND FLANGEWAYS	TON	8	8	
40600535	LEVELING BINDER (HAND METHOD), N70	TON	30	30	
40600635	LEVELING BINDER (MACHINE METHOD), N70	TON	1250	1250	
40600895	CONSTRUCTING TEST STRIP	EACH	1	1	
40600990	TEMPORARY RAMP	SQ YD	40	40	
40603340	HOT-MIX ASPHALT SURFACE COURSE, MIX "D", N70	TON	2208	2208	
40800050	INCIDENTAL HOT-MIX ASPHALT SURFACING	TON	187	187	
44000152	HOT-MIX ASPHALT SURFACE REMOVAL, 3/4"	SQ YD	10647	10647	
44000158	HOT-MIX ASPHALT SURFACE REMOVAL, 2 1/4"	SQ YD	14406	14406	
44000198	HOT-MIX ASPHALT SURFACE REMOVAL, VARIABLE DEPTH	SQ YD	1490	1490	
44001700	COMBINATION CONCRETE CURB AND GUTTER REMOVAL AND REPLACEMENT	FOOT	110	110	
48101200	AGGREGATE SHOULDERS, TYPE B	TON	224	224	
56109210	WATER VALVES TO BE ADJUSTED	EACH	1	1	
60255500	MANHOLES TO BE ADJUSTED	EACH	8	8	
60260100	INLETS TO BE ADJUSTED	EACH	10	10	
67000400	ENGINEER'S FIELD OFFICE, TYPE A	CAL MO	2	2	
67100100	MOBILIZATION	L SUM	1	1	
70100460	TRAFFIC CONTROL AND PROTECTION, STANDARD 701306	L SUM	1	1	
70102620	TRAFFIC CONTROL AND PROTECTION, STANDARD 701501	L SUM	1	1	
70300100	SHORT-TERM PAVEMENT MARKING	FOOT	2302	2302	
70300220	TEMPORARY PAVEMENT MARKING - LINE 4"	FOOT	8593	8593	
70300240	TEMPORARY PAVEMENT MARKING - LINE 6"	FOOT	2121	2121	
70300760	TEMPORARY PAINT PAVEMENT MARKING 24" WHITE	FOOT	88	88	
70301000	WORK ZONE PAVEMENT MARKING REMOVAL	SQ FT	767	767	
* 78000200	THERMOPLASTIC PAVEMENT MARKING - LINE 4"	FOOT	8593	8593	
* 78000400	THERMOPLASTIC PAVEMENT MARKING - LINE 6"	FOOT	2121	2121	
* 78000650	THERMOPLASTIC PAVEMENT MARKING - LINE 24"	FOOT	88	88	
78100100	RAISED REFLECTIVE PAVEMENT MARKER	EACH	88	88	

\* SPECIALTY ITEMS

3/23/2007 1:31:09 PM  
c:\projects\ed05606\details.dgn

FAU RTE	SECTION	COUNTY	TOTAL SHEETS	SHEET NO.
5645	(116,117)RS-3	BUREAU	10	4
FED. ROAD DIST. NO.		ILLINOIS	FED. AID PROJECT	

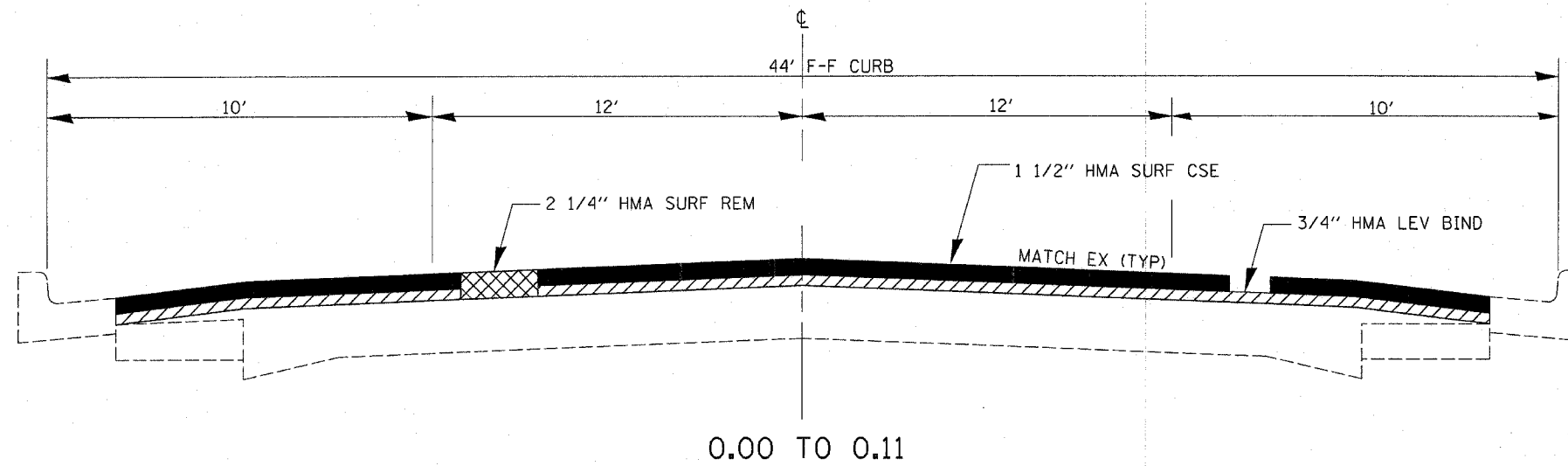

0.00 TO 0.11

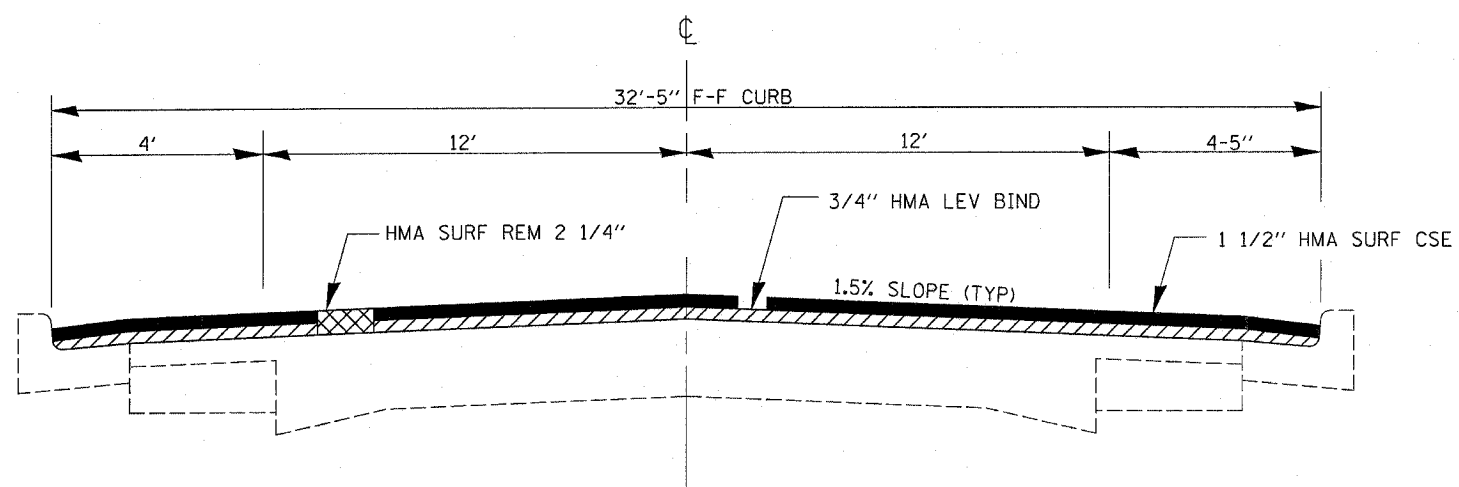

0.11 TO 0.55

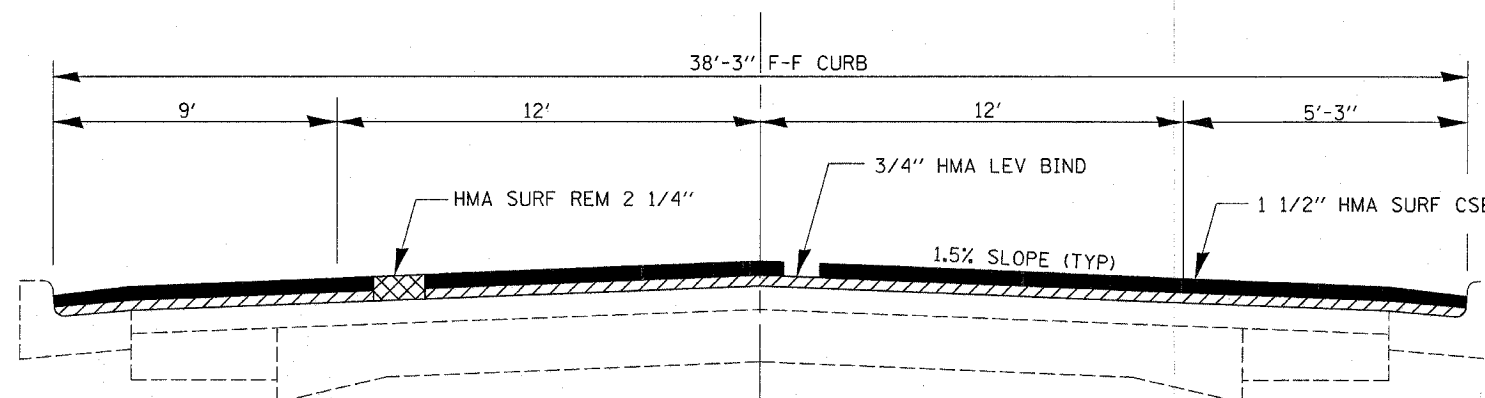

0.55 TO 0.61

	HMA SURFACE	HMA LEVELING BINDER
PG GRADE	PG 64-22	PG 64-22
MAX % RAP ALLOWABLE**	10%***	15%***
DESIGN AIR VOIDS	4% @ N70	4% @ N70
MIXTURE COMPOSITION	IL 12.5 OR IL 9.5	IL 9.5
FRICTION AGGREGATE	MIXTURE D	-
DENSITY CONTROL LIMITS	CORRELATION	SATISFACTION OF ENGINEER

\*\* IF RAP OPTION IS SELECTED, THE ASPHALT CEMENT GRADE MAY NEED TO BE ADJUSTED. THIS WILL BE DETERMINED BY THE ENGINEER.

\*\*\*IF 3/8\"/>

FAU RTE 5645	SECTION (116,117)RS-3	COUNTY BUREAU	TOTAL SHEETS 10	SHEET NO. 5
FED. ROAD DIST. NO. ILLINOIS FED. AID PROJECT				

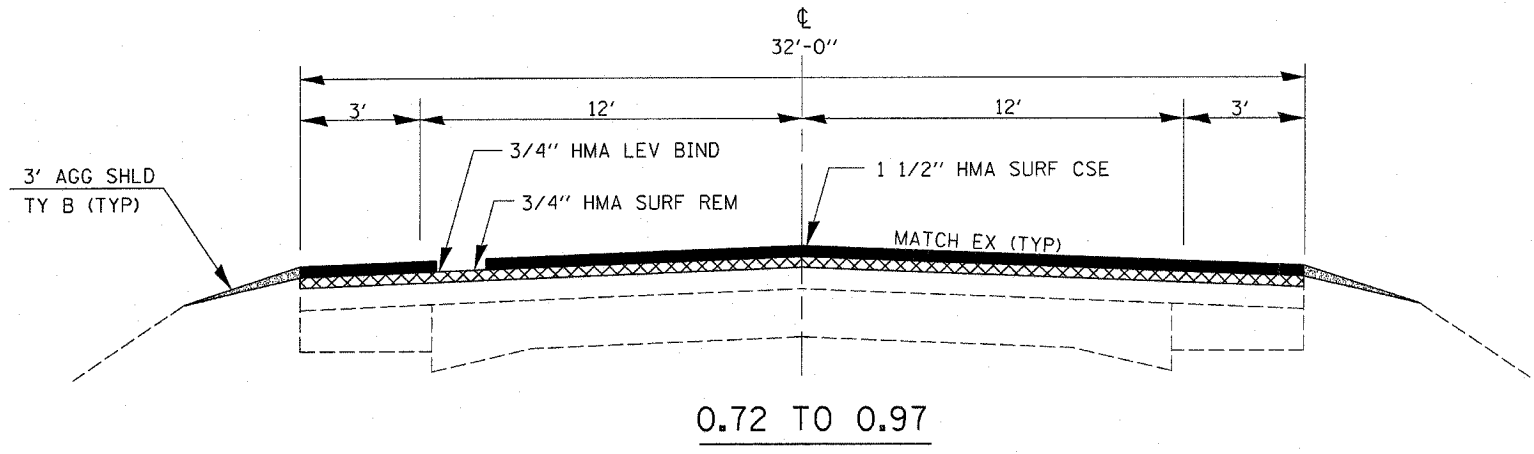
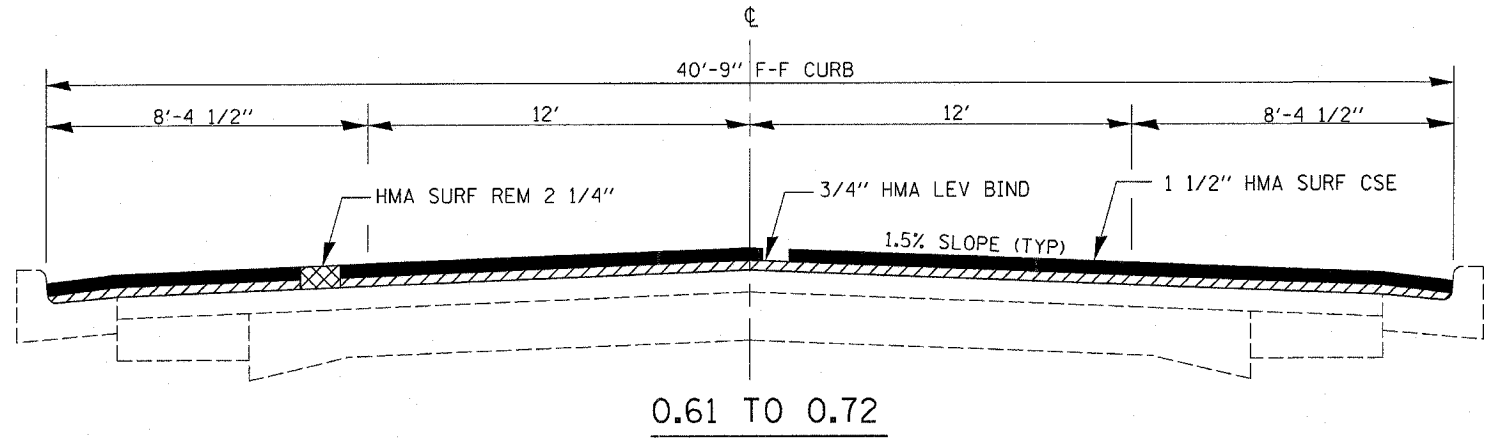

	HMA SURFACE	HMA LEVELING BINDER
PG GRADE	PG 64-22	PG 64-22
MAX % RAP ALLOWABLE**	10%***	15%***
DESIGN AIR VOIDS	4% @ N70	4% @ N70
MIXTURE COMPOSITION	IL 12.5 OR IL 9.5	IL 9.5
FRICTION AGGREGATE	MIXTURE D	-
DENSITY CONTROL LIMITS	CORRELATION	SATISFACTION OF ENGINEER

\*\* IF RAP OPTION IS SELECTED, THE ASPHALT CEMENT GRADE MAY NEED TO BE ADJUSTED. THIS WILL BE DETERMINED BY THE ENGINEER.

\*\*\*IF 3/8" RAP IS UTILIZED, MAXIMUM PERCENT MAY BE INCREASED TO 25% FOR BINDER AND 15% FOR SURFACE. SEE RAP SPECIAL PROVISIONS

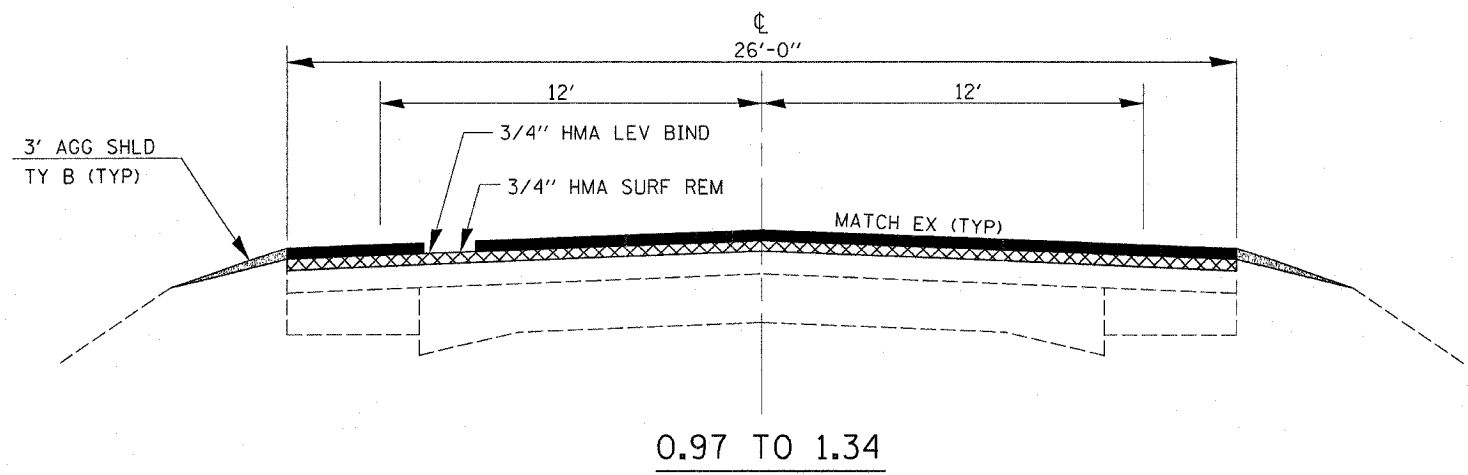

3/23/2007 11:47:03 AM c:\projects\ed05606\detail.is.dgn

FAU RTE	SECTION	COUNTY	TOTAL SHEETS	SHEET NO.
5645	116,117RS-3	BUREAU	10	6
FED. ROAD DIST. NO. _		ILLINOIS	FED. AID PROJECT	

MAINLINE											
LOCATION	WIDTH	LENGTH	AREA	HMA LEVEL BIND (HM)	LEVEL BINDER (MM) N70	HMA SC MIX "D" N70	MIX CR JTS FLANGEWYS	BIT MATLS PR CT	AGG PR CT	TEMP RAMP	AGG SHLD TY B
STATION	FT	FT	SQ YD	TON	TON	TON	TON	GAL	TON	SQ YD	TON
0.00 TO 0.11	44	580.8	2839.5	1.4	119.3	238.5	0.9	227.2	5.7	24.4	
0.11 TO 0.55	32.41	2323.2	8366.1	20.6	493.0	702.8	2.5	669.3	16.7		
0.55 TO 0.61	38.25	316.8	1346.4	0.7	56.5	113.1	0.4	107.7	2.7		
0.61 TO 0.72	40.75	580.8	2629.7	1.3	110.4	220.9	0.8	210.4	5.3		
0.72 TO 0.97 - NO C & G	32	1320.0	4693.3	2.3	197.1	394.2	1.4	375.5	9.4		87.7
0.97 TO 1.34 - NO C & G	26.0	1953.6	5643.7	2.8	237.0	474.1	1.7	451.5	11.3	14.4	129.8
<b>TOTALS</b>		<b>7075.2</b>	<b>25518.8</b>	<b>30.1</b>	<b>1249.8</b>	<b>2207.9</b>	<b>7.9</b>	<b>2102.7</b>	<b>52.6</b>	<b>40.1</b>	<b>224.0</b>

REMOVAL ITEMS				
LOCATION	LENGTH	PVT WIDTH	HMA SURF	HMA SURF
		F-F C & G	REM 2 1/4"	REM 3/4"
	FT	FT	SQ YD	SQ YD
0.00 TO 0.11	580.8	44	2839.5	
0.11 TO 0.55	2323.2	32.41	8366.1	
0.55 TO 0.61	316.8	38.25	1346.4	
0.61 TO 0.72	316.8	40.75	1434.4	
0.72 TO 0.97 No C & G	1320	32		4693.3
0.97 TO 1.34 No C & G	1953.6	26		5643.7
<b>TOTALS</b>			<b>14406.0</b>	<b>10647.2</b>

PAVEMENT MARKING															
LOCATION	TYPE	THPL	THPL	THPL	THPL	THPL	TEMP	TEMP	TEMP	TEMP	TEMP	RAISED	SHORT	WORK	
		PVT	PVT	PVT	PVT	PVT	PVT	PVT	PVT	PVT	PVT	PVT	REF	TERM	ZONE
		MK LN	MK LN	MK LN	MK LN	MK LN	MK LN	MK LN	MK LN	MK LN	MK LN	MK LN	PVT	PVT	PVT
		4"	4"	6"	6"	24"	4"	4"	6"	6"	24"		MKR	MKR	MKR
	YEL	WHITE	YEL	WHITE	WHITE	YEL	WHITE	YEL	WHITE	WHITE				REM	
	FT	FT	FT	FT	FT	FT	FT	FT	FT	FT		EACH	FT	SQ FT	
0.00 TO 0.72				950.4					950.4				1140.48	380.16	
0.72 TO 1.0			2956.8	369.6				2956.8	369.6				443.52	147.84	
1.0 TO 1.20	NO PS SB/PS NB	1056.0	2112.0	264.0			1056.0	2112.0	264.0				316.8	105.6	
1.20 TO 1.34	PS SB/NO PS NB	739.2	1478.4	184.8			739.2	1478.4	184.8				221.76	73.92	
0.14 - W BOYD AVE	X-WALK				60					60			18	6	
0.20 - E THOMPSON ST	X-WALK				60					60			18	6	
0.53 BRYANT WOOD CIRCLE	X-WALK & STOP BAR				170	85				170	88		76.5	25.5	
0.85 BRYANT WOOD ST															
0.00 TO 1.34	<b>TOTALS</b>	<b>1849.1</b>	<b>6743.6</b>	<b>1821.9</b>	<b>299</b>	<b>88</b>	<b>1849.1</b>	<b>6743.6</b>	<b>1821.9</b>	<b>299</b>	<b>88</b>	<b>88</b>	<b>2302.1</b>	<b>767.4</b>	

• NOTE: X-WALKS WILL NOT HAVE LADDERS

3/23/2007 11:47:50 AM c:\projects\ed05606\detail.s.dgn

FAU RTE	SECTION	COUNTY	TOTAL SHEETS	SHEET NO.
5645	(116,117)RS-3	BUREAU	10	7

FED. ROAD DIST. NO. ILLINOIS FED. AID PROJECT

SIDE ROAD & ENTRANCES							
LOCATION	MILE	RT/LT	INCIDENTAL	HMA	BIT	AGG	FUR EX CU YD
			HMA	SURF	MATLS	PR CT	
			SURF	REM	PR CT		
			TON	SQ YD	GAL	TON	
	0.04	RT	2.02	16	1.28	0.03	
	0.06	RT	3.15	25	2.00	0.05	
	0.09	RT	1.40	11	0.92	0.02	
	0.11	LT	3.15	25	2.00	0.05	
BOYD ST	0.14	RT	16.25	129	10.32	0.26	
	0.14	LT	4.54	37.08	2.97	0.07	
	0.16	LT	1.40	11	0.89	0.02	
E THOMPSON ST	0.20	LT	NO WORK				
	0.24	LT	4.54	36	2.88	0.07	
	0.25	LT	2.02	16	1.28	0.03	
	0.32	LT	5.60	44	3.56	0.09	
	0.34	RT	1.40	11	0.89	0.02	
	0.36	LT	3.15	25	2.00	0.05	
	0.41	RT	5.60	44	3.56	0.09	
	0.48	LT	11.20	89	7.11	0.18	
	0.50	RT	2.02	16	1.28	0.03	
BRYANT WOOD DR	0.53	RT	NO WORK				
	0.54	LT	3.15	25	2.00	0.05	
	0.57	RT	2.02	16	1.28	0.03	
	0.58	LT	1.40	11	0.89	0.02	
	0.61	LT	3.15	25	2.00	0.05	
	0.62	LT	3.15	25	2.00	0.05	
	0.68	LT	2.02	16	1.28	0.03	
	0.71	LT	2.02	16	1.28	0.03	
	0.72	RT	2.02	16	1.28	0.03	
	0.74	LT	2.02	16	1.28	0.03	
	0.78	RT	2.52	20	1.60	0.04	
	0.81	LT	2.02	16	1.28	0.03	
BRYANT BLVD	0.85	LT	16.25	129	10.32	0.26	2
	0.86	RT	11.20	89	7.11	0.18	
	0.87	LT	3.15	25	2.00	0.05	
	0.89	RT	2.02	16	1.28	0.03	
	0.94	LT	3.15	25	2.00	0.05	
	0.96	RT	3.15	25	2.00	0.05	
	0.97	LT	2.02	16	1.28	0.03	
	1.01	RT	3.15	25	2.00	0.05	
	1.03	RT	3.15	25	2.00	0.05	
	1.04	RT	2.52	20	1.60	0.04	
	1.07	RT	2.52	20	1.60	0.04	
	1.08	RT	3.15	25	2.00	0.05	
PENTECOASTAL CHURCH	1.10	LT	NO WORK				
	1.11	RT	3.15	25	2.00	0.05	
	1.16	RT	3.15	25	2.00	0.05	
	1.17	RT	2.52	20	1.60	0.04	
	1.17	RT	3.15	25	2.00	0.05	
	1.18	LT	6.78	54	4.30	0.11	
	1.21	RT	2.52	20	1.60	0.04	
	1.23	RT	3.15	25	2.00	0.05	
	1.24	LT	3.15	25	2.00	0.05	
	1.25	RT	2.52	20	1.60	0.04	
	1.26	LT	3.15	25	2.00	0.05	
<b>TOTALS</b>			<b>187.00</b>	<b>1485.57</b>	<b>118.85</b>	<b>2.97</b>	<b>2.00</b>

ADJUSTMENT ITEMS					
LOCATION	RT/LT	MH	INLET	WATER	COMB
		ADJ	ADJ	MAIN	C & G
				ADJ	REM & REP
		EACH	EACH	EACH	FOOT
	0.00				
BOYD ST	0.14				
	0.14	RT	1	1	10
E THOMPSON ST	0.20				
	0.20	RT/LT	1	1	10
	0.25	LT	1		
	0.31	LT	1		
	0.32	LT	1	1	10
	0.36	RT		1	10
	0.37	LT	1		
	0.41	RT	1		
	0.49	LT	1		
	0.50	LT		1	10
BRYANT WOOD DRIVE	0.53				
	0.56	RT/LT		2	20
	0.63	RT/LT		2	20
	0.65	RT/LT		2	20
<b>TOTALS</b>			<b>8</b>	<b>10</b>	<b>1</b>

3/23/2007 11:47:40 AM  
c:\projects\ed05606\defal1s.dgn

FAU RTE	SECTION	COUNTY	TOTAL SHEETS	SHEET NO.
5645	116,117RS-3	BUREAU	10	8
FED. ROAD DIST. NO. 6		ILLINOIS FED. AID PROJECT		

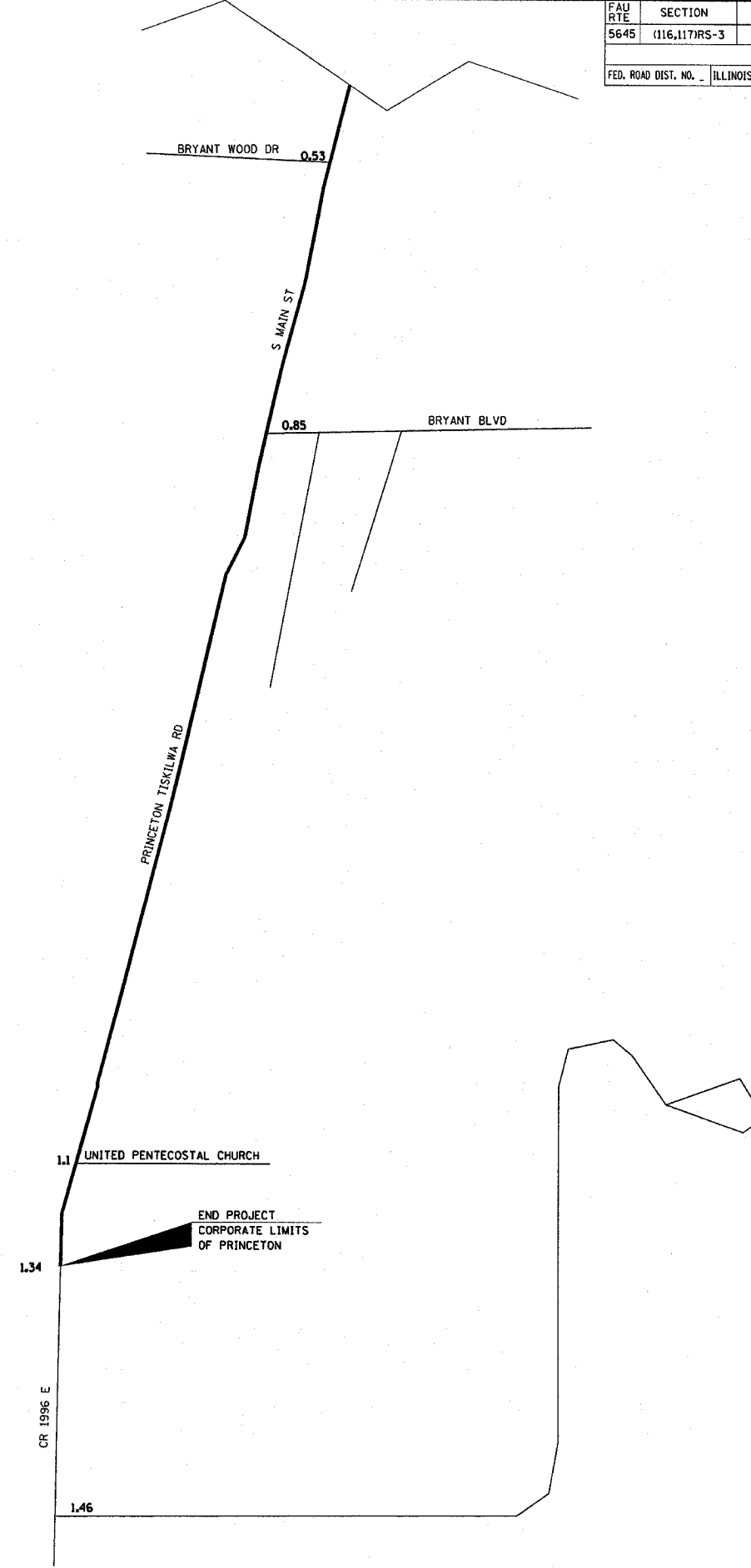
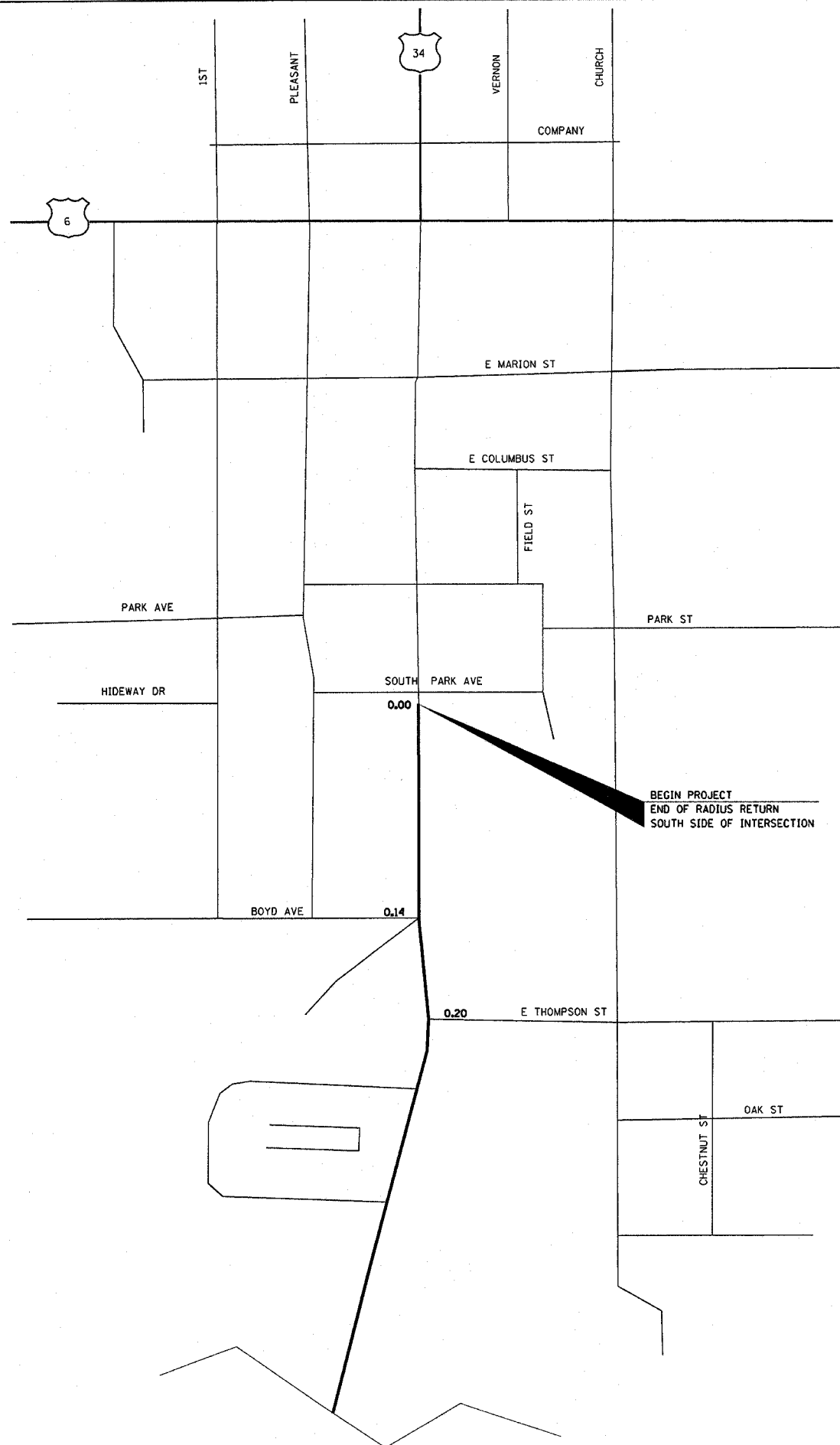



FAU RTE	SECTION	COUNTY	TOTAL SHEETS	SHEET NO.
5645	(116,117)RS-3	BUREAU	10	9
FED. ROAD DIST. NO. ILLINOIS FED. AID PROJECT				

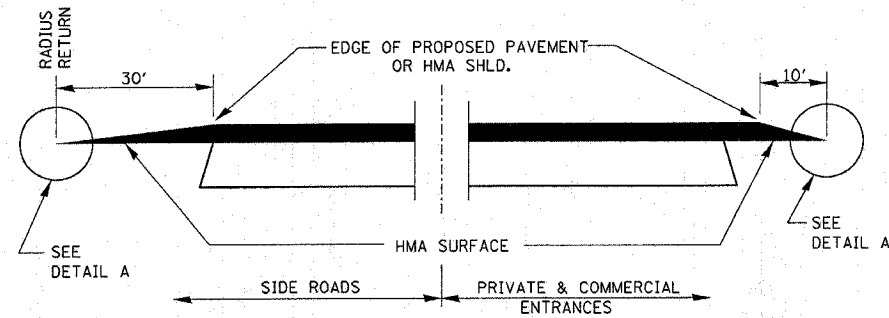

SECTION A-A

DETAILS AT ENTRANCES & SIDE ROADS

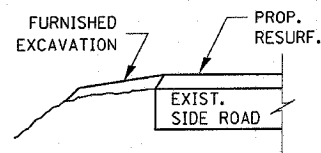

SECTION B-B

THE COST OF REMOVAL AT EXISTING HMA OR P.C.C. LOCATIONS SHALL BE PAID FOR PER SQ. YD. BY THE APPROPRIATE PAY ITEM. REMOVAL AT THE EXISTING AGG. LOCATIONS SHALL BE INCIDENTAL TO THE HMA. A-3 LOCATIONS SHALL BE FEATHER TAPERED.

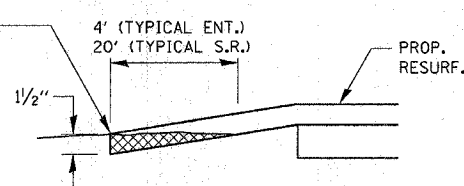

DETAIL A

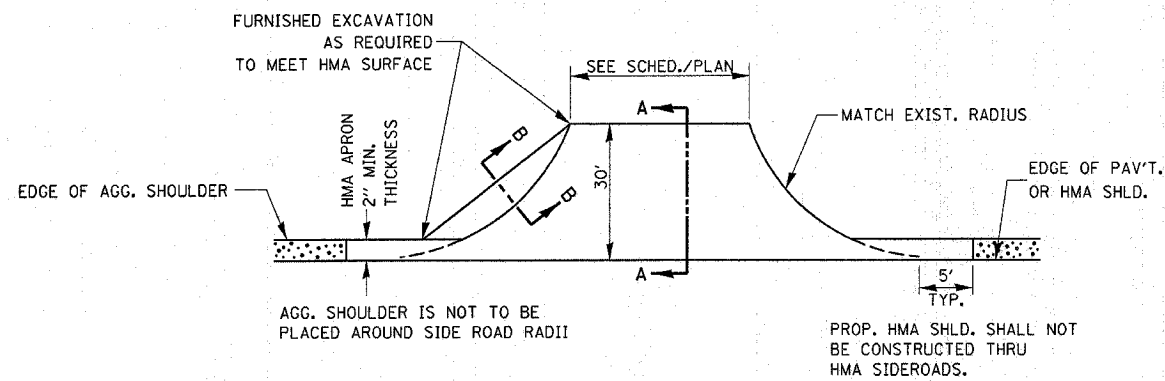

PLAN AT SIDE ROADS

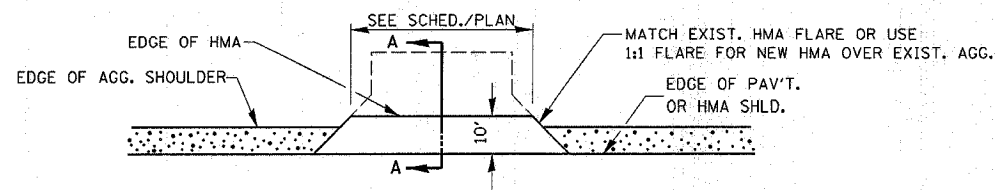

PLAN AT PRIVATE & COMMERCIAL ENTRANCES

(DO NOT RESURFACE FIELD ENTRANCES)

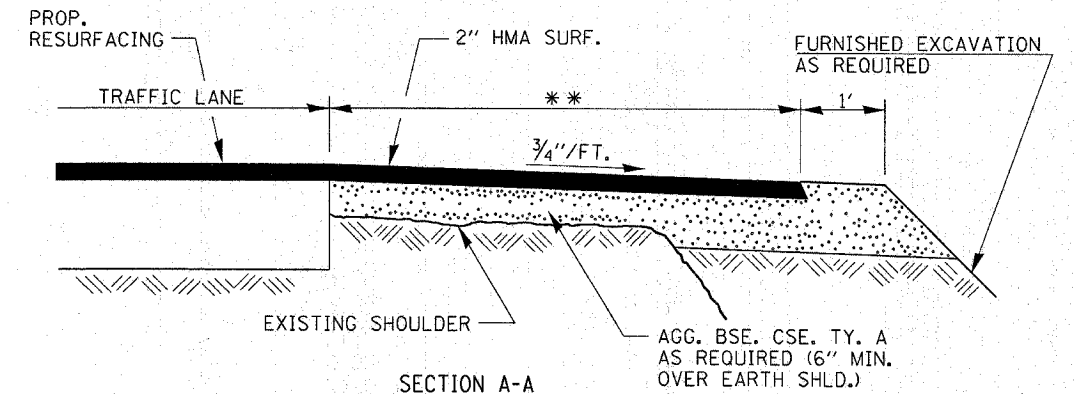
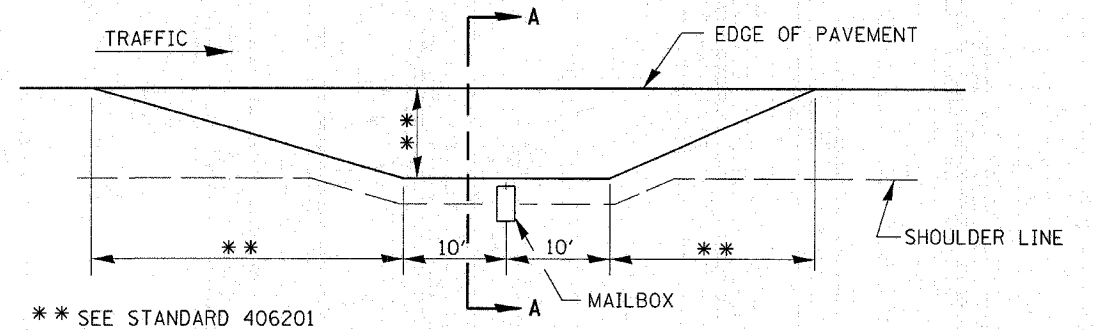

MAILBOX TURNOUT DETAILS

FAU RTE	SECTION	COUNTY	TOTAL SHEETS	SHEET NO.
5645	016,117RS-3	BUREAU	10	10
FED. ROAD DIST. NO. ILLINOIS FED. AID PROJECT				

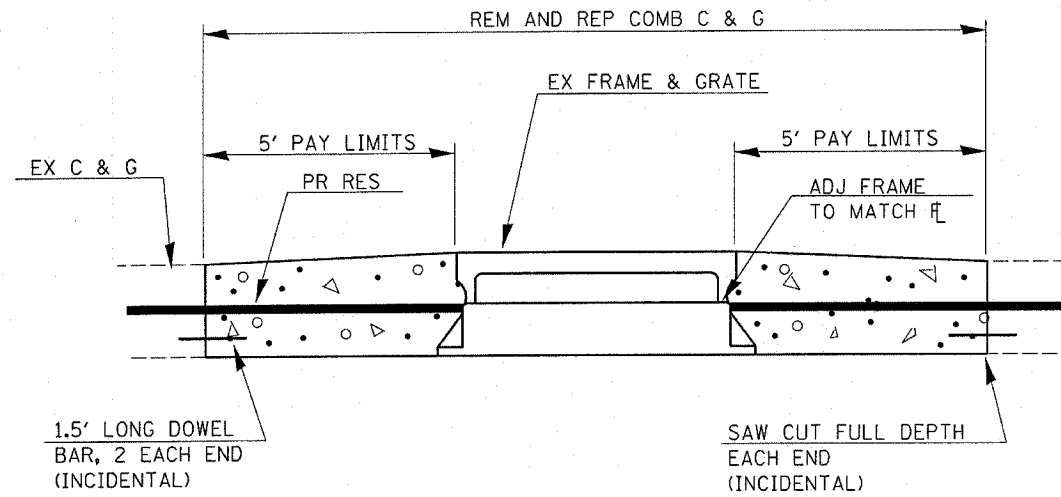

**INLET ADJUST**

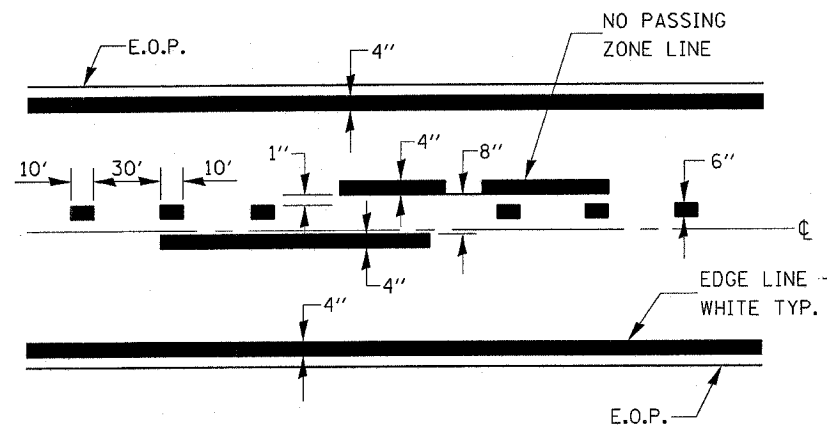

**PAVEMENT MARKING**

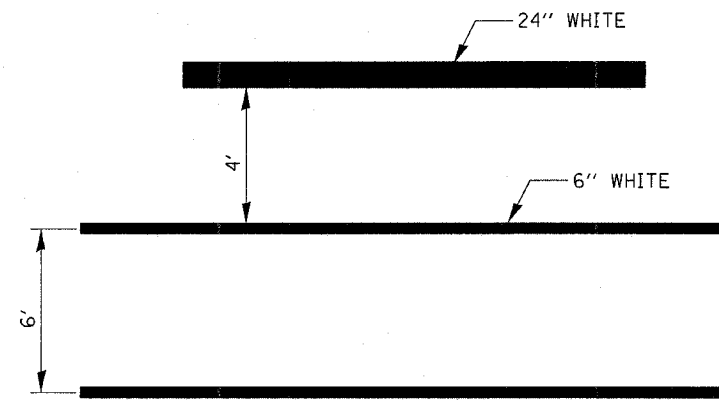

**TYPICAL SPACING DETAIL FOR CROSSWALKS AND STOP BARS**

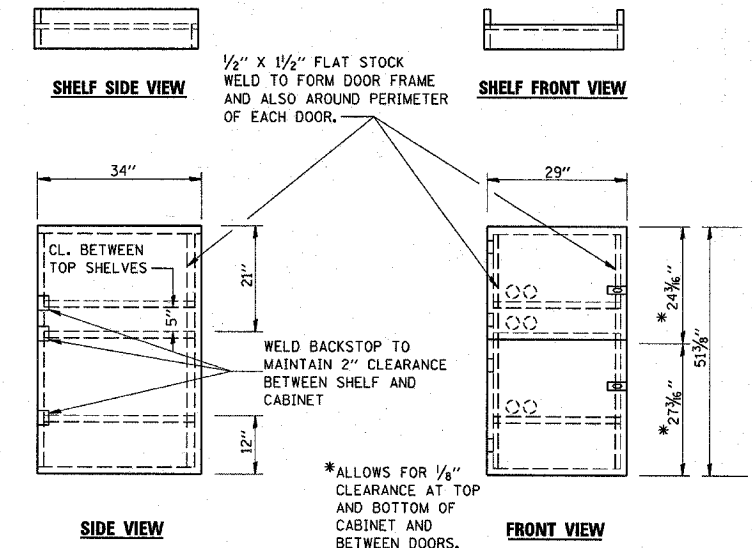
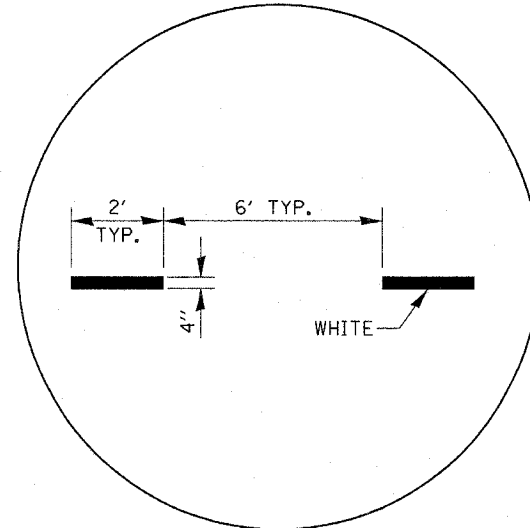
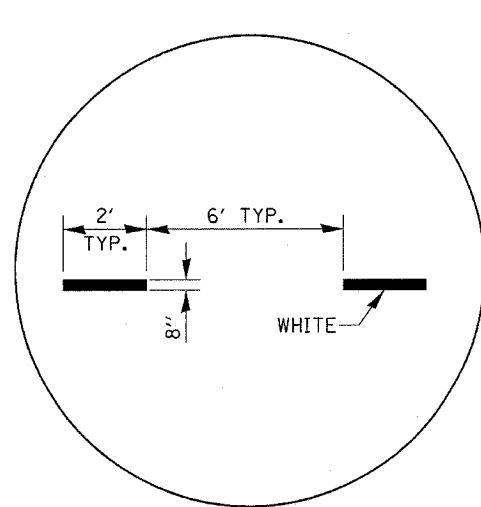

- NOTES:
1. USE 16 GAUGE STEEL FOR CABINET.
  2. THE TOP SHELF SHALL SLIDE IN OR OUT WITH THE TOP DOOR OPEN.
  3. ALL HINGES AND HASPS WILL BE WELDED TO THE CABINET.
  4. ALL EDGES SHALL BE GROUND SMOOTH.
  5. TWO (2" DIA.) ACCESS HOLES WILL BE REQUIRED FOR EACH SHELF.
  6. CABINET SHALL BE PAINTED WITH TWO COATS OF FLAT PAINT.
  7. 2 EACH MATCHING KEY PADLOCKS, WITH 3 KEYS PROVIDED, MASTER MODEL 3 T OR EQUIVALENT.
  8. 4 EACH PLAIN STEEL, NON-REMOVABLE PIN, NO HOLE 4"x4" SQUARE CORNER HINGES TO BE WELDED ON.
  9. 2 EACH EXTRA HEAVY, PLAIN STEEL, FIXED STAPLE, NO HOLE, 7 1/4" HASPS TO BE WELDED ON.

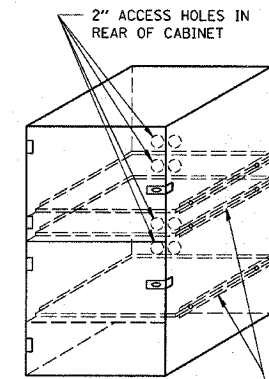

FLAT STOCK DIMENSIONS VARY DEPENDING ON TYPE OF ROLLER ASSEMBLY.

**LOCKABLE COMPUTER CABINET**

3/23/2007 11:46:22 AM  
c:\projects\ed05606\detail1.s.dgn