

FAI RY.	SECTION	COUNTY	TOTAL SHEETS	SHEET NO.
80	(32-1)PATCHING	GRUNDY	10	8

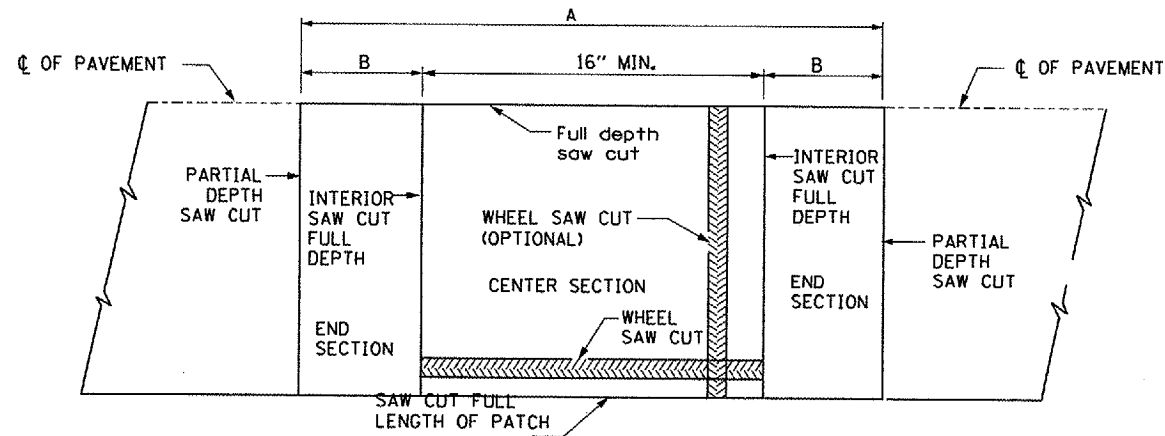

**ALTERNATE SAWING DETAIL**  
(PCC SHOULDER)

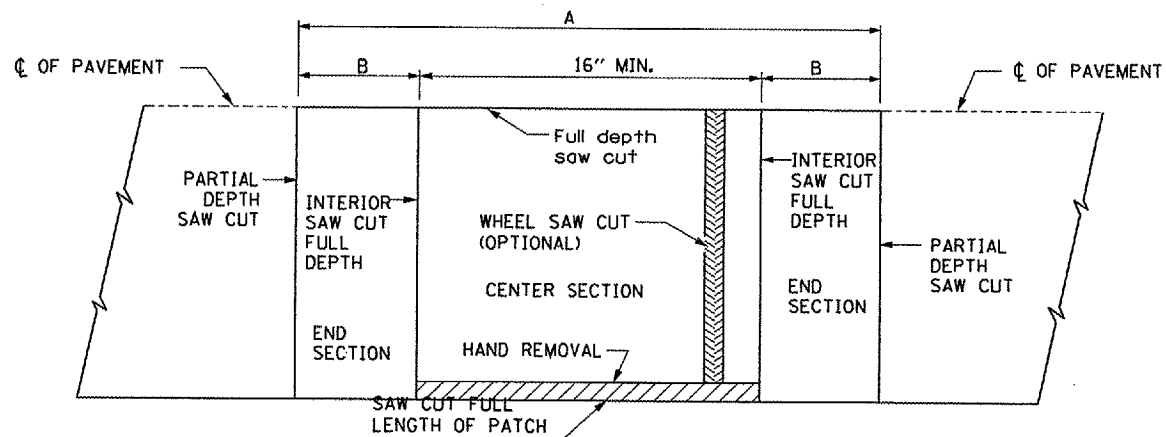

**PAVEMENT SAWING DETAIL**  
(PCC SHOULDER)

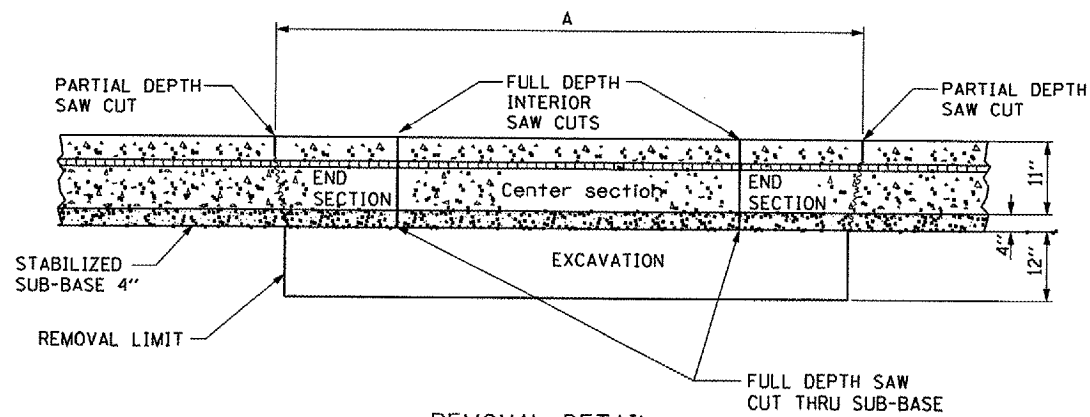

**REMOVAL DETAIL**

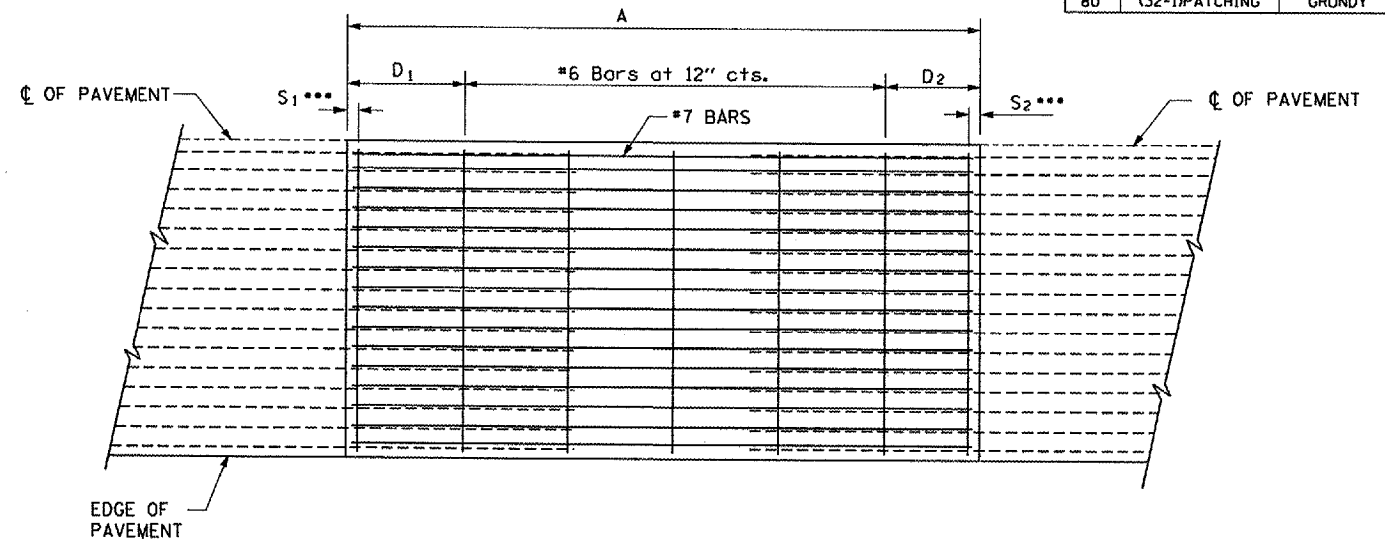

**PROPOSED PAVEMENT DETAIL**  
(AGAINST CONCRETE SHOULDER)

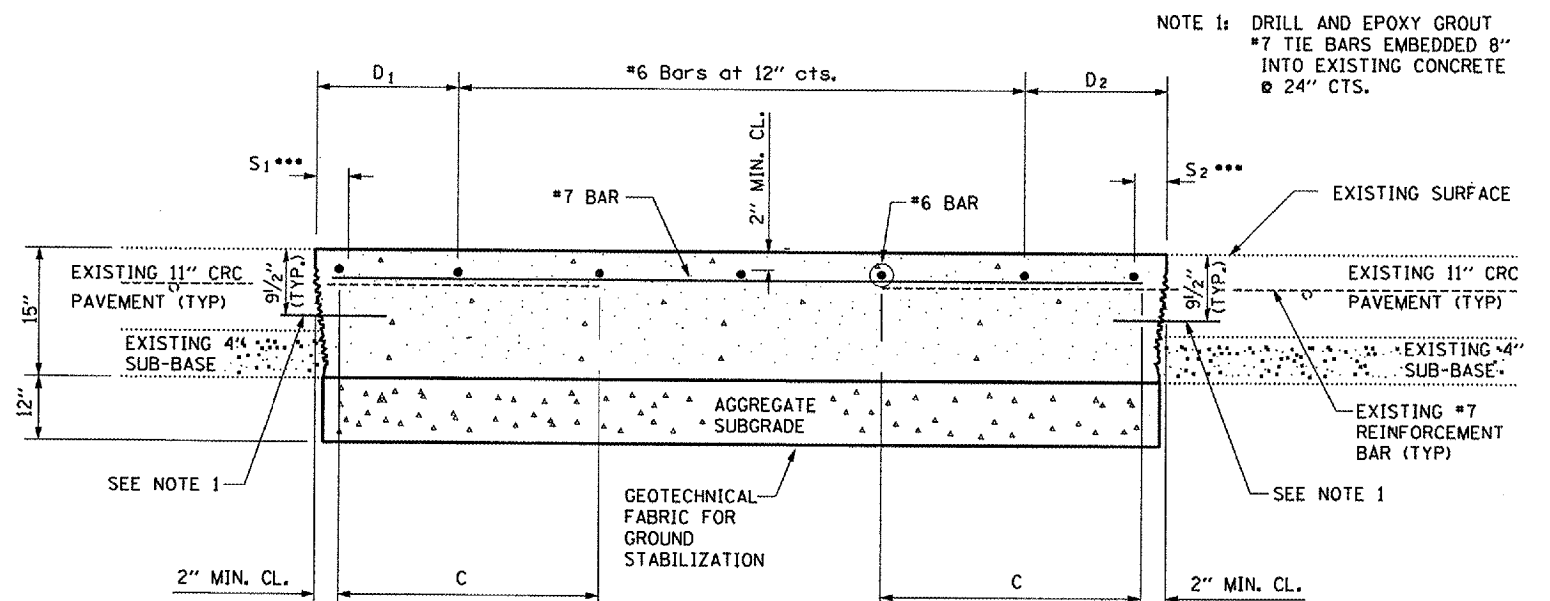

NOTE 1: DRILL AND EPOXY GROUT #7 TIE BARS EMBEDDED 8" INTO EXISTING CONCRETE @ 24" CTS.

**PROPOSED CLASS A PATCHING DETAIL**

EXISTING LONGITUDINAL REINFORCEMENT BARS	A (min.)	B (min.)	C (min.)
No. 7	6'-0"	24"	22"

**NOTES:**

- EVERY 3<sup>rd</sup> INTERSECTION MUST BE TIED
- LAP NEW REINFORCEMENT WITH EXISTING LONGITUDINAL REINFORCEMENT
- VARIABLES: WHERE S<sub>1</sub> AND S<sub>2</sub> ARE 2 1/2" MIN. AND 12" MAX. D<sub>1</sub> = 2(S<sub>1</sub>) AND D<sub>2</sub> = 2(S<sub>2</sub>)

REVISIONS	
NAME	DATE

ILLINOIS DEPARTMENT OF TRANSPORTATION  
**CLASS A PATCHING DETAILS**

**FAI ROUTE 80 (I-80)**  
**SECTION (32-1)PATCHING**  
**GRUNDY COUNTY**

Date: February 23, 2007  
c:/projects/cmain08/cm303/detail.dgn