

F.A.I. RTE.	SECTION	COUNTY	TOTAL SHEETS	SHEET NO.
80	(32-1,2)PATCHING	LASALLE	10	1

STATE OF ILLINOIS
DEPARTMENT OF TRANSPORTATION
DIVISION OF HIGHWAYS

**PROPOSED
HIGHWAY PLANS**

FAI ROUTE 80 (I-80)
SECTION (32-1) PATCHING

GRUNDY COUNTY
C-93-044-07
PAVEMENT PATCHING

INDEX OF SHEETS

1. COVER SHEET
2. GENERAL NOTES
3. SUMMARY OF QUANTITIES
4. TYPICAL SECTIONS
5. SCHEDULES - PATCHING
- 6 - 7. SCHEDULES
8. CLASS A PATCHING DETAILS
9. CLASS B PATCHING DETAILS
10. PAVEMENT MARKING DETAILS

STANDARDS

- 000001-04 STANDARD SYMBOLS, ABBREVIATIONS AND PATTERNS
- 001001-01 AREAS OF REINFORCEMENT BARS
- 001006 DECIMAL OF AN INCH AND OF A FOOT
- 420001-06 PAVEMENT JOINTS
- 420701-01 PAVEMENT FABRIC
- 421001-01 BAR REINFORCEMENT FOR CRC PAVEMENT
- 442001-03 CLASS A PATCHES
- 442101-06 CLASS B PATCHES
- 701101-01 OFF-ROAD OPERATIONS MULTILANE, 4.5 m (15') TO 600 mm (24") FROM PAVEMENT EDGE
- 701106-01 OFF-ROAD OPERATIONS, MULTILANE, MORE THAN 4.5 m (15') AWAY
- 701400-02 APPROACH TO LANE CLOSURE, FREEWAY/EXPRESSWAY
- 701401-03 LANE CLOSURE, FREEWAY/EXPRESSWAY
- 701411-03 LANE CLOSURE, MULTILANE, AT ENTRANCE OR EXIT RAMP FOR SPEEDS \geq 45 MPH
- 701426-02 LANE CLOSURE, MULTILANE INTERMITTENT OR MOVING OPERATION, FOR SPEEDS \geq 45 MPH
- 702001-06 TRAFFIC CONTROL DEVICES

D-93-002-07

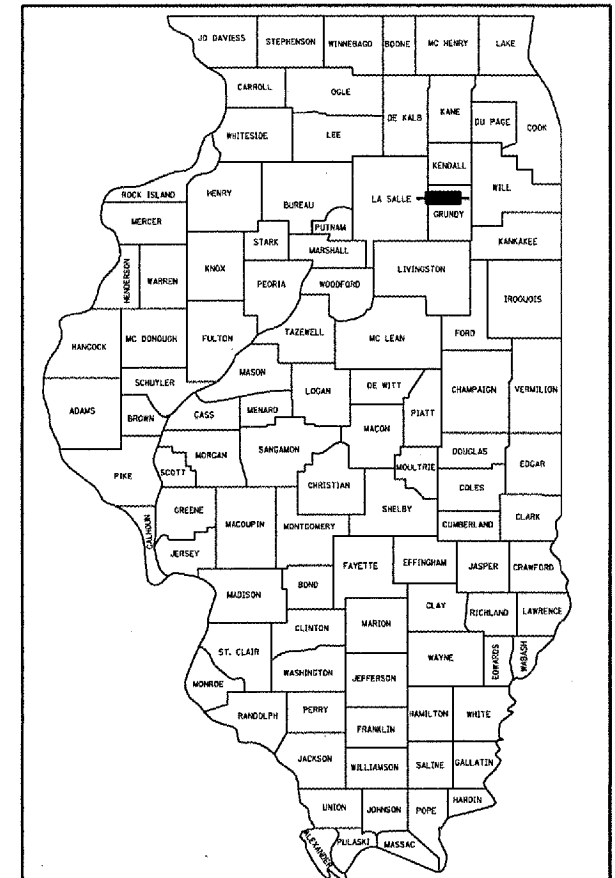

FUNCTIONAL CLASSIFICATION
URBAN - OTHER PRINCIPAL ARTERIAL
F.A.I. ROUTE 80 (I-80)
2005 ADT = 28500
P.V. = 59.6% M.U. = 34.4% S.U. = 6.0%

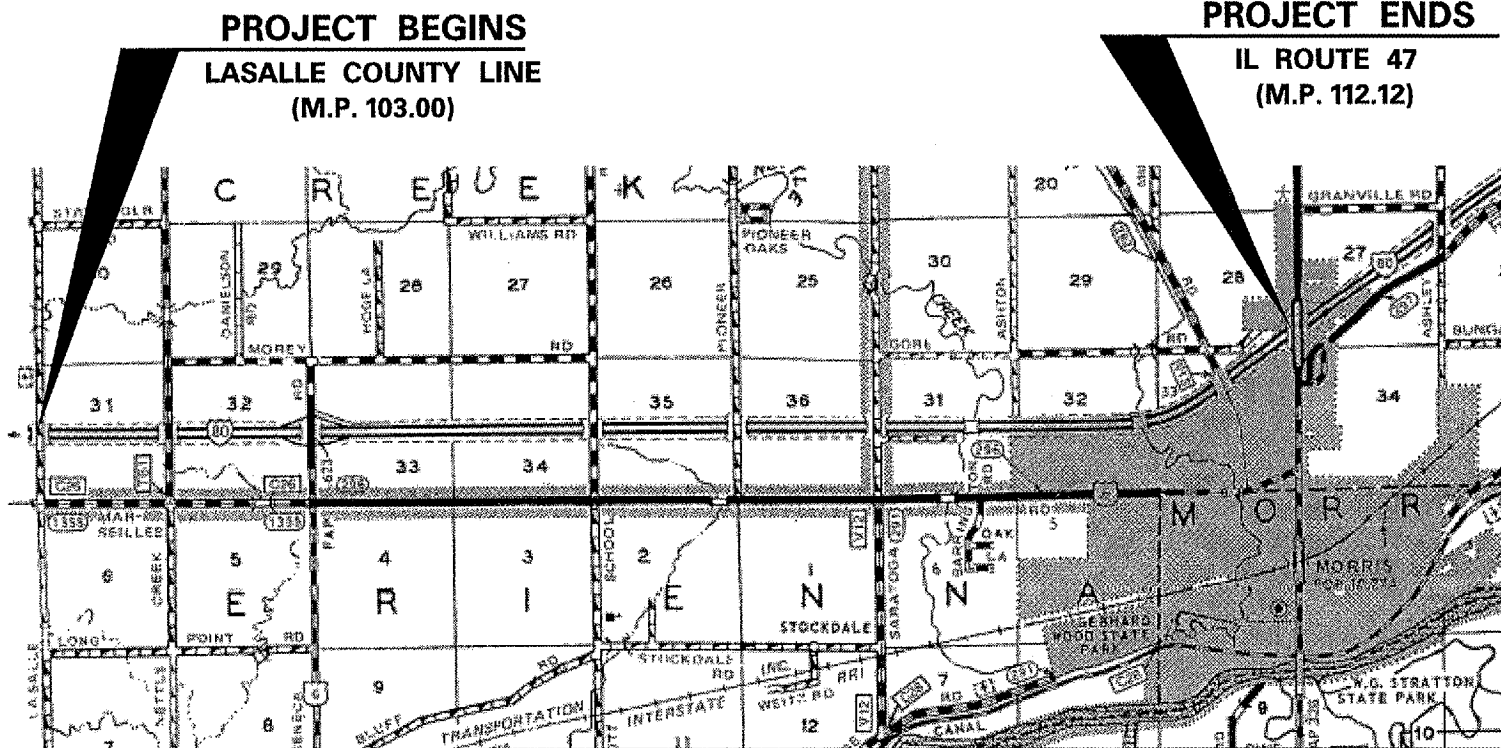

LOCATION MAP

NOT TO SCALE
GROSS LENGTH = 48,154 FT. = 9.12 MI.
NET LENGTH = 167 FT. = 0.03 MI

MICROFILMED _____
REEL NUMBER _____
AWARDED _____
RESIDENT ENGINEER _____
AS BUILT CHANGES WERE MADE
ON THE FOLLOWING SHEETS _____

J.U.L.I.E.
JOINT UTILITY LOCATION INFORMATION FOR EXCAVATION
1-800-892-0123

DISTRICT 3 NO. (815) 434-6131

PROJECT ENGINEER: JOE KANNEL
UNIT CHIEF: RON WOODSHANK
TOWNSHIP: VARIOUS

CONTRACT NO. 66706

STATE OF ILLINOIS
DEPARTMENT OF TRANSPORTATION
DIVISION OF HIGHWAYS

SUBMITTED *April 2 2007*
George Ryan
DEPUTY DIRECTOR OF HIGHWAYS, REGION ENGINEER

May 11 2007
Eric E. Harn
ENGINEER OF DESIGN AND ENVIRONMENT

May 11 2007
Melvin R. Seos
DIRECTOR OF HIGHWAYS, CHIEF ENGINEER

PRINTED BY THE AUTHORITY
OF THE STATE OF ILLINOIS

F.A.I. RTE.	SECTION	COUNTY	TOTAL SHEETS	SHEET NO.
80	(32-1,2)PATCHING	GRUNDY	10	2

GENERAL NOTES

PLAN DIMENSIONS AND DETAILS RELATIVE TO EXISTING ROADWAY OR STRUCTURE HAVE BEEN TAKEN FROM EXISTING PLANS AND ARE SUBJECT TO NOMINAL CONSTRUCTION VARIATIONS. IT SHALL BE THE CONTRACTOR'S RESPONSIBILITY TO VERIFY SUCH DIMENSIONS AND DETAILS IN THE FIELD AND TO MAKE NECESSARY APPROVED ADJUSTMENTS PRIOR TO CONSTRUCTION OR ORDERING OF MATERIALS. SUCH VARIATIONS SHALL NOT BE CAUSE FOR ADDITIONAL COMPENSATION FOR A CHANGE IN THE SCOPE OF THE WORK, HOWEVER, THE CONTRACTOR WILL BE PAID FOR THE QUANTITY ACTUALLY FURNISHED AT THE UNIT BID FOR THE WORK.

FOR STABILIZATION, ALL TYPE III BARRICADES SHALL REQUIRE A MINIMUM OF FOUR SAND BAGS PER BARRICADE.

THE CONTRACTOR SHALL BE RESPONSIBLE FOR PROTECTING UTILITY PROPERTY FROM CONSTRUCTION OPERATIONS AS OUTLINED IN ARTICLE 107.31 OF THE STANDARD SPECIFICATIONS. THE "JULIE" NUMBER IS 1-800-892-0123. A MINIMUM OF FORTY-EIGHT (48) HOURS ADVANCE NOTICE IS REQUIRED.

WHERE SECTION OR SUBSECTION MONUMENTS ARE ENCOUNTERED, THE ENGINEER SHALL BE NOTIFIED BEFORE SUCH MONUMENTS ARE REMOVED. THE CONTRACTOR SHALL PROTECT AND CAREFULLY PRESERVE ALL MONUMENTS UNTIL AN AUTHORIZED SURVEYOR OR AGENT HAS WITNESSED OR OTHERWISE REFERENCED THEIR LOCATION. THE CONTRACTOR SHALL BE RESPONSIBLE FOR HAVING AN AUTHORIZED SURVEYOR REESTABLISH ANY SECTION OR SUBSECTION MONUMENTS DESTROYED BY HIS OPERATIONS.

ABANDONED UNDERGROUND UTILITIES THAT CONFLICT WITH CONSTRUCTION SHALL BE DISPOSED OF OUTSIDE THE LIMITS OF THE RIGHT OF WAY ACCORDING TO ARTICLE 202.03 OF THE STANDARD SPECIFICATIONS AND AS DIRECTED BY THE ENGINEER. THIS WORK WILL NOT BE PAID FOR SEPARATELY BUT SHALL BE INCLUDED IN THE COST OF CLASS A PATCHING.

THE THICKNESS OF BITUMINOUS MIXTURES SHOWN ON THE PLANS IS THE NOMINAL THICKNESS. DEVIATIONS FROM THE NOMINAL THICKNESS WILL BE PERMITTED WHEN SUCH DEVIATIONS OCCUR DUE TO IRREGULARITIES IN THE EXISTING SURFACE OR BASE ON WHICH THE BITUMINOUS MIXTURE IS PLACED.

ANY REFERENCE TO A STANDARD IN THESE PLANS SHALL BE INTERPRETED TO MEAN THE EDITION AS INDICATED BY THE SUBNUMBER LISTED ON THE INDEX OF SHEETS OR THE COPY OF THE STANDARD INCLUDED IN THESE PLANS.

THE EXISTING SHOULDERS ARE LOW. IN THE EVENT THAT CONSTRUCTION OPERATIONS RESULT IN A DROP OFF GREATER THAN 3" BETWEEN THE EDGE OF PAVEMENT OR EDGE OF SHOULDER WITHIN 3' OF THE EDGE OF PAVEMENT AND THE EARTH OR AGGREGATE SHOULDERS, THEN THE DROP OFF SHALL BE PROTECTED ACCORDING TO ARTICLE 701.04(B)(1) OF THE STANDARD SPECIFICATIONS. THIS WORK WILL BE CONSIDERED AS INCLUDED IN THE CONTRACT UNIT PRICES FOR TRAFFIC CONTROL.

ALL NEW REINFORCEMENT BARS SHALL BE "EPOXY COATED" EXCEPT AS SHOWN.

EXISTING REINFORCEMENT BARS EXTENDING INTO REMOVAL AREA SHALL BE CLEANED, STRAIGHTENED AND INCORPORATED INTO THE NEW CONSTRUCTION. ANY REINFORCEMENT BARS THAT ARE DAMAGED DURING CONCRETE REMOVAL SHALL BE REPLACED WITH AN APPROVED BAR SPLICER OR ANCHORAGE SYSTEM. COST INCLUDED WITH CONCRETE REMOVAL.

DATE:

4.2.07

PREPARED BY:

Rich Powell

DISTRICT STUDIES & PLANS ENGINEER

EXAMINED BY:

Subodh K...

DISTRICT CONSTRUCTION ENGINEER

...

DISTRICT MATERIALS ENGINEER

...

DISTRICT OPERATIONS ENGINEER

REVISIONS	
NAME	DATE

ILLINOIS DEPARTMENT OF TRANSPORTATION

GENERAL NOTES

FAI ROUTE 80 (I-80)

SECTION (32-1,2)PATCHING

GRUNDY COUNTY

Date: February 23, 2007
c:/projects/cmain08/cm303/details.dgn

F.A.I. RTE.	SECTION	COUNTY	TOTAL SHEETS	SHEET NO.
80	(32-1,2)PATCHING	GRUNDY	10	3

SUMMARY OF QUANTITIES

CONSTRUCTION CODE TYPE: **I000**

CODE NO.	ITEM	UNIT	TOTAL QUANTITY	100% STATE	
				RURAL	URBAN
21001000	GEOTECHNICAL FABRIC FOR GROUND STABILIZATION	SQ YD	247	37	210
44002228	HOT-MIX ASPHALT REMOVAL OVER PATCHES 7"	SQ YD	32	32	
44200630	CLASS A PATCHES, TYPE II 15 INCH	SQ YD	87	37	50
44200632	CLASS A PATCHES, TYPE IV 15 INCH	SQ YD	160		160
44201055	CLASS B PATCHES, TYPE II, 17 INCH	SQ YD	32	32	
44213000	PATCHING REINFORCEMENT	SQ YD	247	37	210
44213100	PAVEMENT FABRIC	SQ YD	32	32	
44213200	SAW CUTS	FOOT	1230	468	762
67100100	MOBILIZATION	L SUM	1	0.5	0.5
70100420	TRAFFIC CONTROL AND PROTECTION, STANDARD 701411	EACH	8	4	4
70100800	TRAFFIC CONTROL AND PROTECTION, STANDARD 701401	L SUM	1	0.5	0.5
70103815	TRAFFIC CONTROL SURVEILLANCE	CAL DA	5	1	4
*78008210	POLYUREA PAVEMENT MARKING TYPE I - LINE 4"	FOOT	216	56	160
*78008230	POLYUREA PAVEMENT MARKING TYPE I - LINE 6"	FOOT	216	56	160
Z0001050	AGGREGATE SUBGRADE 12"	SQ YD	247	37	210
Z0017202	DOWEL BARS 1 1/2"	EACH	80	80	
Z0075300	TIE BARS	EACH	216	48	168

*SPECIALTY ITEM

REVISIONS	
NAME	DATE

ILLINOIS DEPARTMENT OF TRANSPORTATION
GENERAL NOTES
 FAI ROUTE 80 (I-80)
 SECTION (32-1,2)PATCHING
 GRUNDY COUNTY

F.A.I. RTE.	SECTION	COUNTY	TOTAL SHEETS	SHEET NO.
80	(50-2)PATCHING	LASALLE	10	4

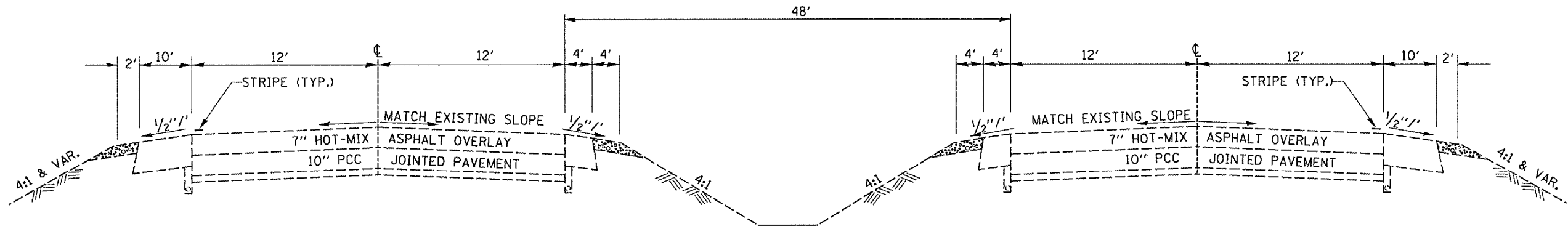

**MAINLINE
TYPICAL SECTION
M.P. 102.99 TO M.P. 105.41
WEST BOUND**

**MAINLINE
TYPICAL SECTION
M.P. 102.99 TO M.P. 105.41
EAST BOUND**

TYPICAL NO. 1

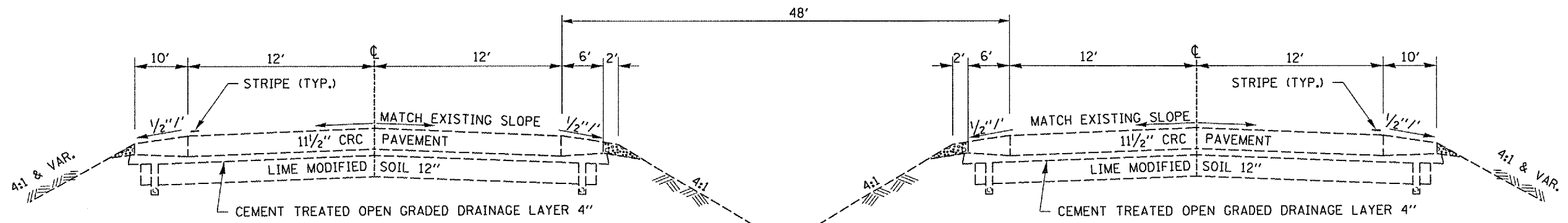

**MAINLINE
TYPICAL SECTION
M.P. 105.41 TO M.P. 112.12
WEST BOUND**

**MAINLINE
TYPICAL SECTION
M.P. 105.41 TO M.P. 112.12
EAST BOUND**

TYPICAL NO. 2

REVISIONS	
NAME	DATE

ILLINOIS DEPARTMENT OF TRANSPORTATION
TYPICAL SECTIONS
FAI ROUTE 80 (I-80)
SECTION (50-2)PATCHING
LASALLE COUNTY

Date: February 23, 2007
c:/projects/cmain08/cm303/details.dgn

F.A.I. RTE.	SECTION	COUNTY	TOTAL SHEETS	SHEET NO.
80	(32-1,2)PATCHING	GRUNDY	10	5

SCHEDULE - CLASS B PATCHING											
LOCATION		PASSING LANE					DRIVING LANE				
MILE		HOT-MIX ASPHALT REMOVAL OVER PATCHES 7"	PATCH TYPE II 17"	DOWEL BARS	SAW CUTS	PAVE'T FABRIC	HOT-MIX ASPHALT REMOVAL OVER PATCHES 17"	PATCH TYPE II 17"	DOWEL BARS	SAW CUTS	PAVE'T FABRIC
POST	LANE	SQ YD	SQ YD	EACH	FOOT	SQ YD	SQ YD	SQ YD	EACH	FOOT	SQ YD
RURAL SECTION											
103.80	EB						8	8	20	48	8
105.40	EB						8	8	20	48	8
EASTBOUND SUBTOTAL							16	16	40	96	16
103.20	WB						8	8	20	48	8
105.30	WB						8	8	20	48	8
WESTBOUND SUBTOTAL							16	16	40	96	16
RURAL SECTION TOTAL							32	32	80	192	32

SCHEDULE - CLASS A PATCHING											
LOCATION		PASSING LANE					DRIVING LANE				
MILE		CLASS A PATCH TYPE II 15"	PATCH TYPE IV 15"	PATCH REINF.	SAW CUTS	TIE BARS 3/4"	CLASS A PATCH TYPE II 15"	PATCH TYPE IV 15"	PATCH REINF.	SAW CUTS	TIE BARS 3/4"
POST	LANE	SQ YD	SQ YD	SQ YD	FOOT	EACH	SQ YD	SQ YD	SQ YD	FOOT	EACH
RURAL											
105.78	EB						13		13	78	12
105.90	EB						8		8	66	12
106.40	EB						8		8	66	12
106.80	EB	8		8	66	12					
RURAL TOTAL		8		8	66	12	29		29	210	36

SCHEDULE - CLASS A PATCHING											
LOCATION		PASSING LANE					DRIVING LANE				
MILE		CLASS A PATCH TYPE II 15"	PATCH TYPE IV 15"	PATCH REINF.	SAW CUTS	TIE BARS 3/4"	CLASS A PATCH TYPE II 15"	PATCH TYPE IV 15"	PATCH REINF.	SAW CUTS	TIE BARS 3/4"
POST	LANE	SQ YD	SQ YD	SQ YD	FOOT	EACH	SQ YD	SQ YD	SQ YD	FOOT	EACH
URBAN											
109.10	EB						8		8	66	12
109.19	EB						8		8	66	12
110.50	EB							160	160	408	108
110.55	EB						13		13	78	12
110.80	EB						13		13	78	12
EB SUBTOTAL							42	160	202	696	156
110.65	WB						8		8	66	12
WB SUBTOTAL							8		8	66	12
URBAN TOTAL							50	160	210	762	168

REVISIONS	
NAME	DATE

ILLINOIS DEPARTMENT OF TRANSPORTATION
SCHEDULES--PATCHING
 FAI ROUTE 80 (I-80)
 SECTION (32-1,2)PATCHING
 GRUNDY COUNTY

Date: February 23, 2007
 c:/projects/cmain08/cm303/details.dgn

F.A.I. RTE.	SECTION	COUNTY	TOTAL SHEETS	SHEET NO.
80	(32-1,2)PATCHING	GRUNDY	10	6

SCHEDULE				
LOCATION		STABILIZED SUB-BASE 4"		
MILE POST	LANE	PASSING LANE	DRIVE LANE	
		SQ YD	SQ YD	SQ YD
RURAL				
105.78	EB			13
105.90	EB			8
106.40	EB			8
106.80	EB	8		
SUBTOTAL		8		29
RURAL TOTAL			37	

SCHEDULE				
LOCATION		GEOTECHNICAL FABRIC FOR GROUND STABILIZATION		
MILE POST	LANE	PASSING LANE	DRIVE LANE	
		SQ YD	SQ YD	SQ YD
RURAL				
105.78	EB			13
105.90	EB			8
106.40	EB			8
106.80	EB	8		
EB SUBTOTAL		8		29
RURAL TOTALS			37	

SCHEDULE				
LOCATION		AGGREGATE SUBGRADE 12"		
MILE POST	LANE	PASSING LANE	DRIVE LANE	
		SQ YD	SQ YD	SQ YD
RURAL				
105.78	EB			13
105.90	EB			8
106.40	EB			8
106.80	EB	8		
EB SUBTOTAL		8		29
RURAL TOTALS			37	

SCHEDULE				
LOCATION		STABILIZED SUB-BASE 4"		
MILE POST	LANE	PASSING LANE	DRIVE LANE	
		SQ YD	SQ YD	SQ YD
URBAN				
109.10	EB			8
109.19	EB			8
110.50	EB			160
110.55	EB			13
110.80	EB			13
EB SUBTOTAL				202
110.65	WB			8
WB SUBTOTAL				8
URBAN TOTALS			210	

SCHEDULE				
LOCATION		GEOTECHNICAL FABRIC FOR GROUND STABILIZATION		
MILE POST	LANE	PASSING LANE	DRIVE LANE	
		SQ YD	SQ YD	SQ YD
URBAN				
109.10	EB			8
109.19	EB			8
110.50	EB			160
110.55	EB			13
110.80	EB			13
EB SUBTOTAL				202
110.65	WB			8
WB SUBTOTAL				8
URBAN TOTALS			210	

SCHEDULE				
LOCATION		AGGREGATE SUBGRADE 12"		
MILE POST	LANE	PASSING LANE	DRIVE LANE	
		SQ YD	SQ YD	SQ YD
URBAN				
109.10	EB			8
109.19	EB			8
110.50	EB			160
110.55	EB			13
110.80	EB			13
EB SUBTOTAL				202
110.65	WB			8
WB SUBTOTAL				8
URBAN TOTALS			210	

Date: February 23, 2007
c:\projects\cm303\details.dgn

REVISIONS	
NAME	DATE

ILLINOIS DEPARTMENT OF TRANSPORTATION
SCHEDULES
FAI ROUTE 80 (I-80)
SECTION (32-1,2)PATCHING
GRUNDY COUNTY

F.A.I. RTE.	SECTION	COUNTY	TOTAL SHEETS	SHEET NO.
80	(32-1,2)PATCHING	GRUNDY	10	7

SCHEDULE - PAVEMENT MARKING				
LOCATION		POLYUREA PAVEMENT MARKING TYPE 1, LINE 4"		POLYUREA PAVEMENT MARKING TYPE 1, LINE 6"
MILE POST	LANE	YELLOW FEET	WHITE FEET	WHITE FEET
RURAL				
103.80	EB		6	6
105.40	EB		6	6
105.78	EB		10	10
105.90	EB		6	6
106.40	EB		6	6
106.80	EB	6		6
EB SUBTOTAL		6	34	40
103.20	WB		8	8
105.30	WB		8	8
WB SUBTOTAL			16	16
URBAN TOTALS		56		56

SCHEDULE - PAVEMENT MARKING				
LOCATION		POLYUREA PAVEMENT MARKING TYPE 1, LINE 4"		POLYUREA PAVEMENT MARKING TYPE 1, LINE 6"
MILE POST	LANE	YELLOW FEET	WHITE FEET	WHITE FEET
URBAN				
109.10	EB		6	6
109.19	EB		6	6
110.50	EB		120	120
110.55	EB		10	10
110.80	EB		10	10
EB SUBTOTAL			152	152
110.65	WB		8	8
WB SUBTOTAL			8	8
URBAN TOTALS		160		160

Date: February 23, 2007
c:/projects/cmain08/cm303/details.dgn

REVISIONS	
NAME	DATE

ILLINOIS DEPARTMENT OF TRANSPORTATION
SCHEDULES
FAI ROUTE 80 (I-80)
SECTION (32-1,2)PATCHING
GRUNDY COUNTY

FAI RY.	SECTION	COUNTY	TOTAL SHEETS	SHEET NO.
80	(32-1)PATCHING	GRUNDY	10	8

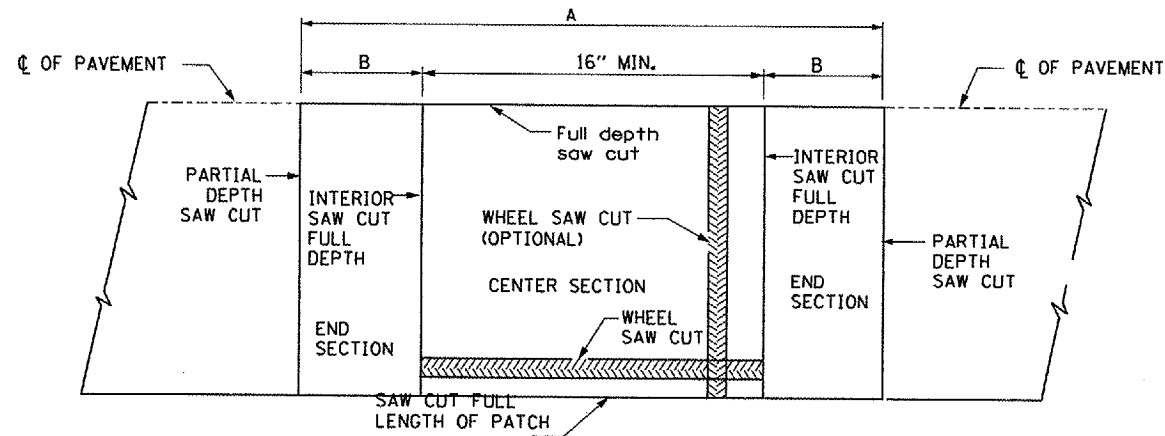

ALTERNATE SAWING DETAIL
(PCC SHOULDER)

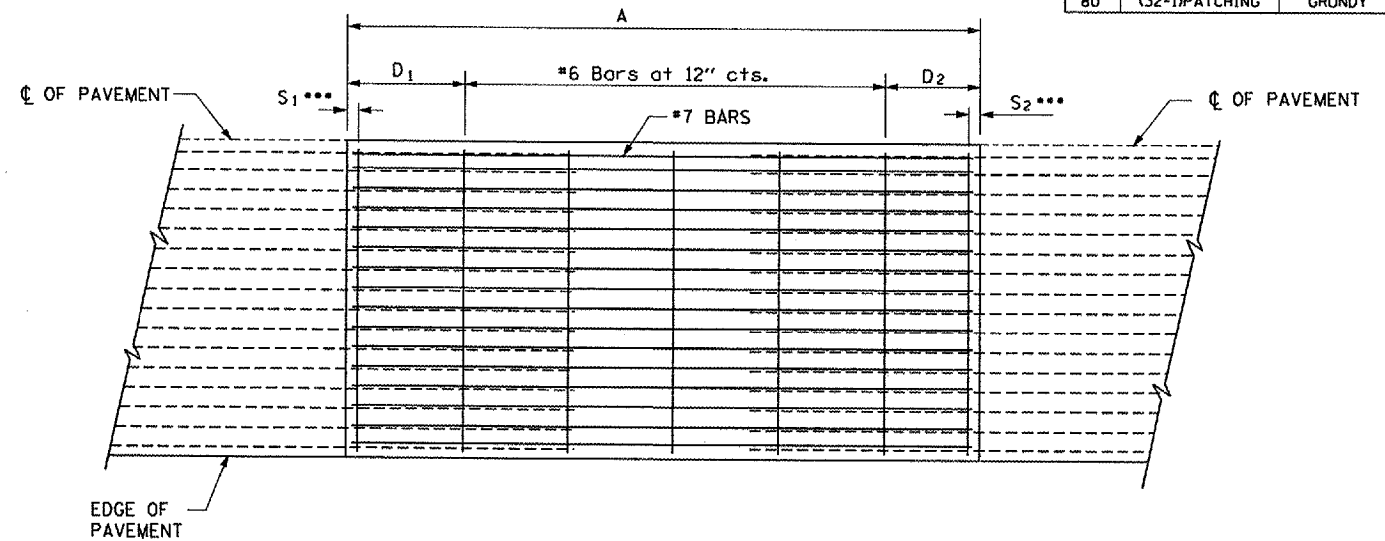

PROPOSED PAVEMENT DETAIL
(AGAINST CONCRETE SHOULDER)

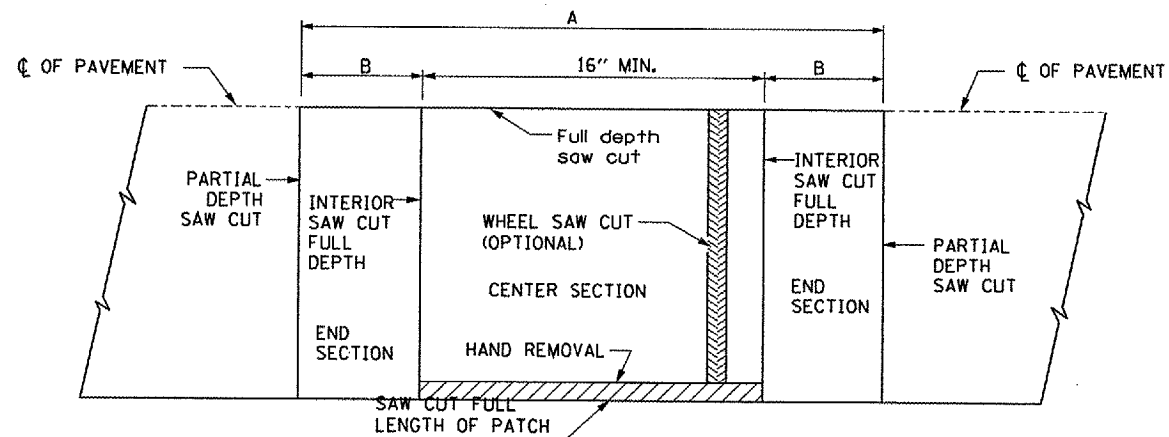

PAVEMENT SAWING DETAIL
(PCC SHOULDER)

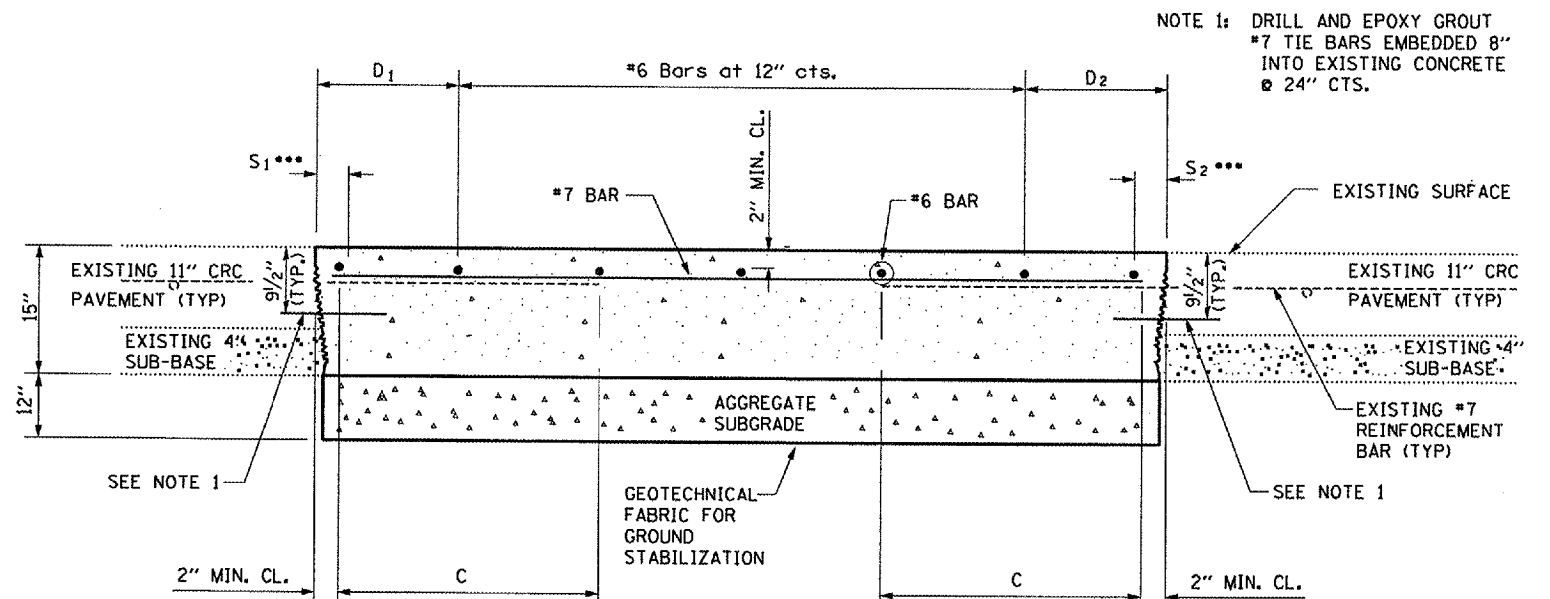

NOTE 1: DRILL AND EPOXY GROUT #7 TIE BARS EMBEDDED 8" INTO EXISTING CONCRETE @ 24" CTS.

PROPOSED CLASS A PATCHING DETAIL

EXISTING LONGITUDINAL REINFORCEMENT BARS	A (min.)	B (min.)	C (min.)
No. 7	6'-0"	24"	22"

- NOTES:
- EVERY 3rd INTERSECTION MUST BE TIED
 - LAP NEW REINFORCEMENT WITH EXISTING LONGITUDINAL REINFORCEMENT
 - VARIABLES: WHERE S₁ AND S₂ ARE 2 1/2" MIN. AND 12" MAX. D₁ = 2(S₁) AND D₂ = 2(S₂)

REVISIONS	
NAME	DATE

ILLINOIS DEPARTMENT OF TRANSPORTATION
CLASS A PATCHING DETAILS

FAI ROUTE 80 (I-80)
SECTION (32-1)PATCHING
GRUNDY COUNTY

Date: February 23, 2007
c:/projects/cmain08/cm303/detail.dgn

F.A.I. RTE.	SECTION	COUNTY	TOTAL SHEETS	SHEET NO.
80	(50-2)PATCHING	LASALLE	10	9

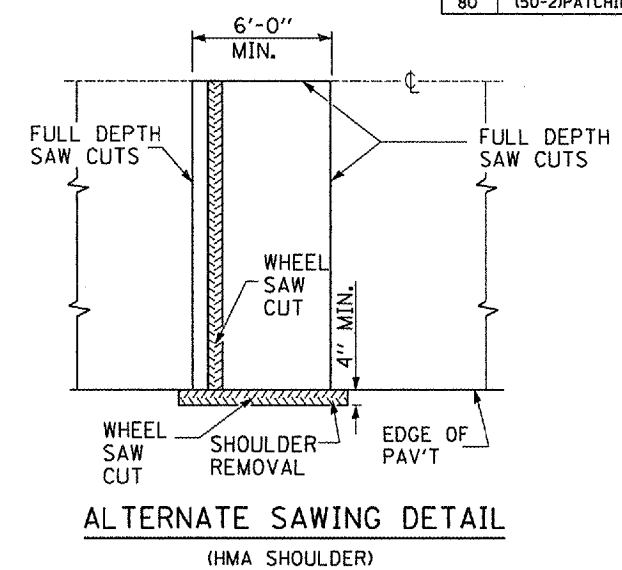
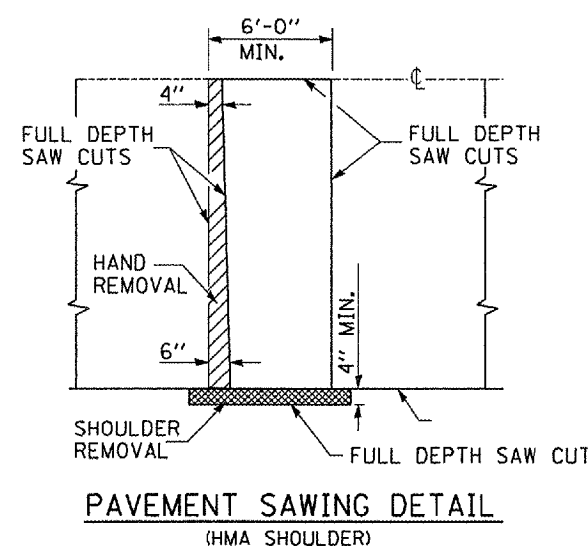
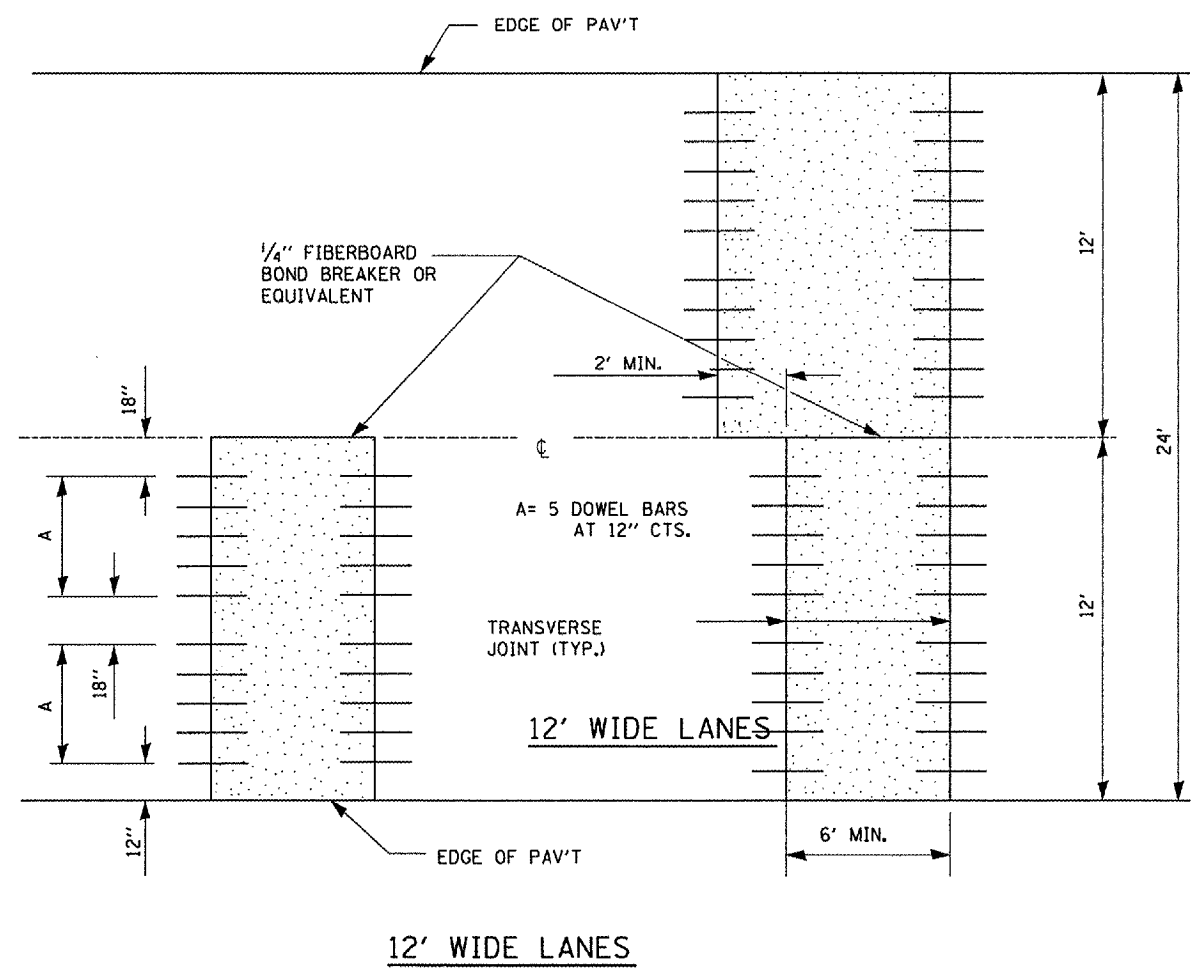

PAVEMENT THICKNESS	DOWEL BAR DIAMETER	HOLE DIAMETER
8" OR GREATER	1 1/2"	1 5/8"
7" THRU 7.99"	1 1/4"	1 3/8"
LESS THAN 7"	1"	1 1/8"

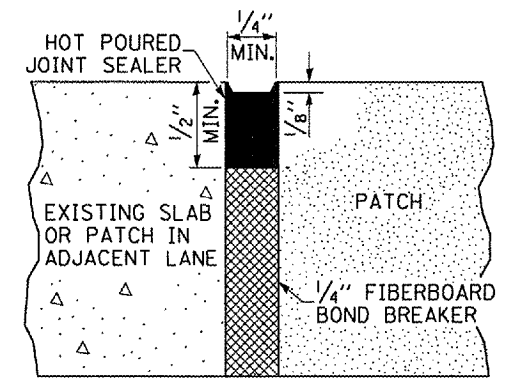

SEALING DETAIL CENTERLINE JOINT

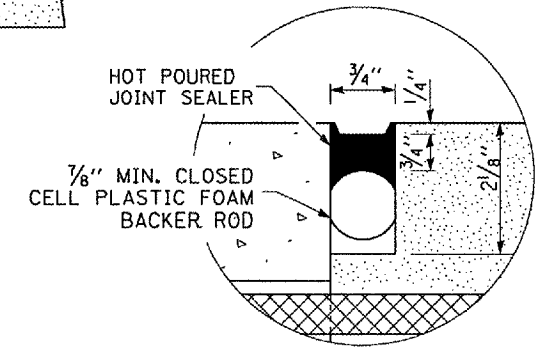

SEALING DETAIL TRANSVERSE JOINT

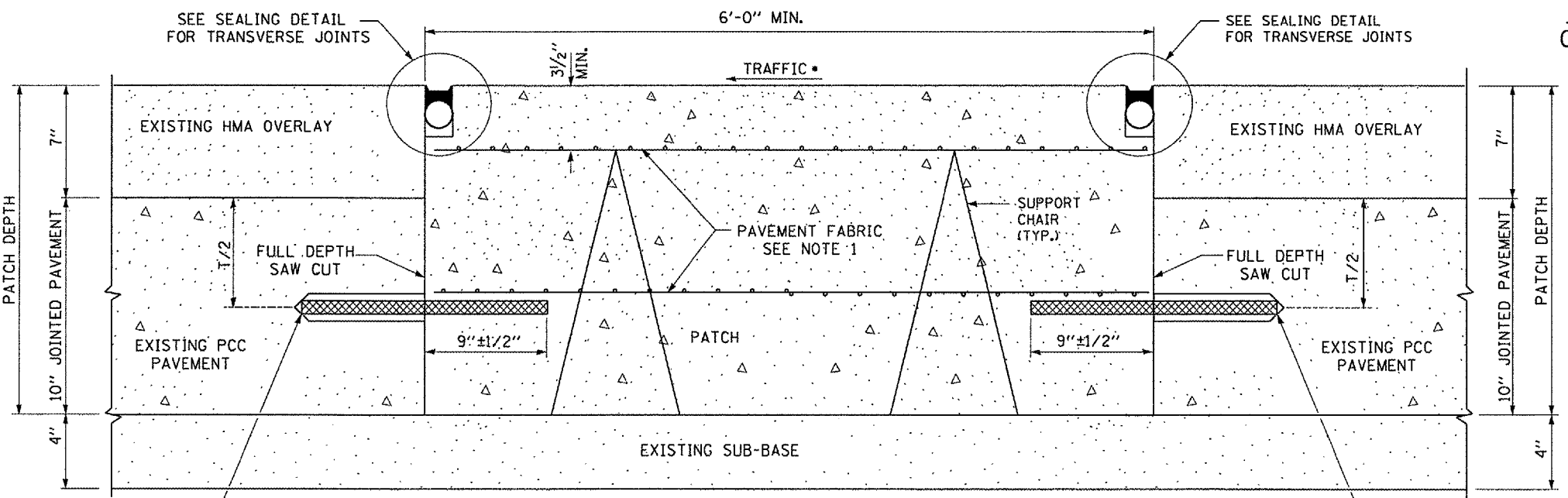

CLASS B PATCH (With Resurfacing)

NOTE 1: FOR TYPE II PATCHES, OMIT BOTTOM PAVEMENT FABRIC

18" LONG DOWEL BARS ANCHORED INTO EXISTING PAVEMENT AT 12" CTS.

18" LONG DOWEL BARS ANCHORED INTO EXISTING PAVEMENT AT 12" CTS.

GENERAL NOTES

- THE TRANSVERSE JOINTS FOR CLASS PATCHES SHALL ALIGN WITH JOINTS OR CRACKS IN THE ADJACENT LANE WHENEVER POSSIBLE.
- SEE STANDARD 420701 FOR DETAILS OF PAVEMENT FABRIC.

REVISIONS	
NAME	DATE

ILLINOIS DEPARTMENT OF TRANSPORTATION
CLASS B PATCHING DETAILS
 FAI ROUTE 80 (I-80)
 SECTION (50-2)PATCHING
 LASALLE COUNTY

Date: February 22, 2007
 c:/projects/cmain08/cm302/details.dgn

F.A.I. RTE.	SECTION	COUNTY	TOTAL SHEETS	SHEET NO.
80	(32-1)PATCHING	GRUNDY	10	10

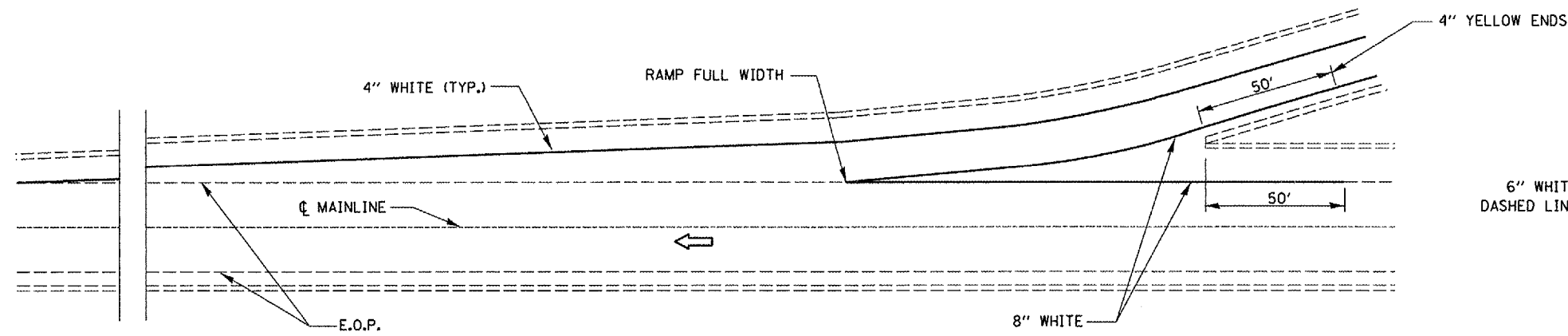

TYPICAL PAVEMENT MARKING FOR ENTRANCE RAMP TERMINALS

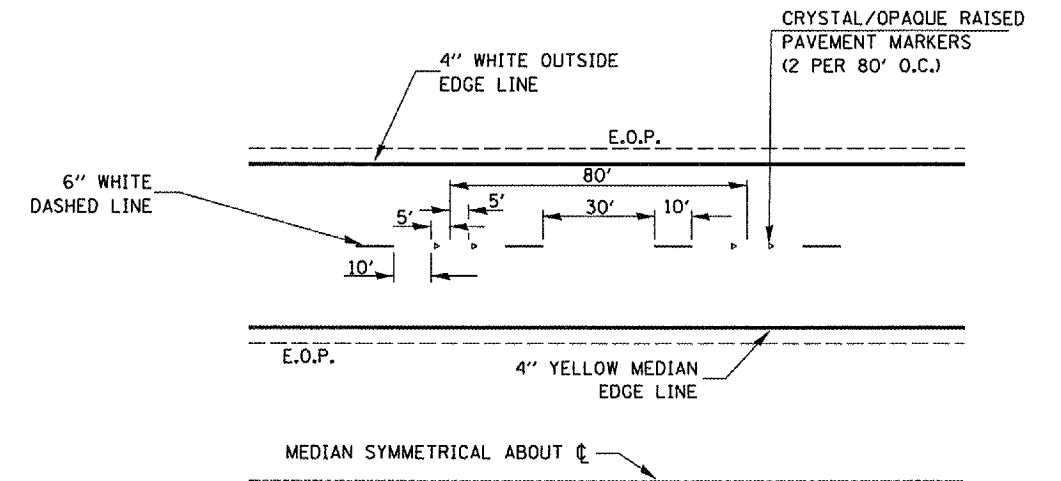

TYPICAL PAVEMENT MARKINGS

NOTE:
 WHEN PATCHING IS ADJACENT TO 8" PAVEMENT MARKING LINE THE 8" STRIP SHALL BE REPLACED WITH TWO 4" LINES.
 RAISED REFLECTIVE PAVEMENT MARKERS THAT FALL WITHIN PATCHED BOUNDARIES WILL NOT BE REPLACED.

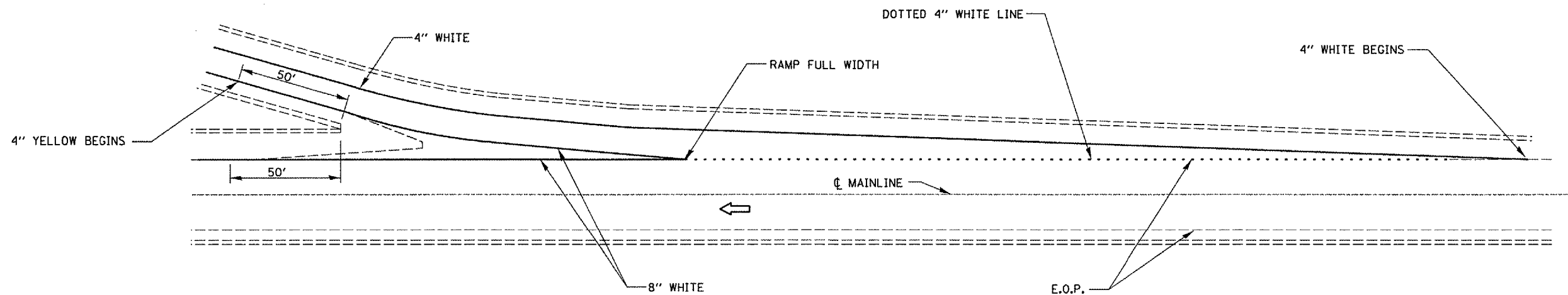

TYPICAL PAVEMENT MARKINGS FOR EXIT RAMP TERMINALS

Date: February 23, 2007
 c:/projects/main08/cm303/details.dgn

REVISIONS	
NAME	DATE

ILLINOIS DEPARTMENT OF TRANSPORTATION
PAVEMENT MARKING DETAILS
 FAI ROUTE 80 (I-80)
 SECTION (32-1)PATCHING
 GRUNDY COUNTY