

F.A.I. RTE.	SECTION	COUNTY	TOTAL SHEETS	SHEET NO.
55	53(6HB-1,6B)BP	LIVINGSTON	15	1
ILLINOIS				

INDEX OF SHEETS

1. COVER SHEET
2. GENERAL NOTES
3. SUMMARY OF QUANTITIES
4. TYPICAL SECTIONS
5. SCHEDULES
6. TRAFFIC CONTROL AND PROTECTION, STANDARD 701402 (SPECIAL)
7. TEMPORARY CONCRETE BARRIER DETAILS, BRIDGE LOCATION NO. 1
8. TEMPORARY CONCRETE BARRIER DETAILS, BRIDGE LOCATION NO. 2 AND 3
- 9 - 11. EXISTING STRUCTURE DETAILS, BRIDGE LOCATION NO. 1
- 12 - 15. EXISTING STRUCTURE DETAILS, BRIDGE LOCATION NO. 2 AND 3

STANDARDS

- | | |
|-----------|---|
| 000001-04 | STANDARD SYMBOLS, ABBREVIATIONS AND PATTERNS |
| 635011-01 | REFLECTOR MARKER AND MOUNTING DETAILS |
| 701011-01 | OFF-ROAD MOVING OPERATIONS 2L, 2W, DAY ONLY |
| 701101-01 | OFF-ROAD OPERATIONS MULTILANE, 4.5 m (15') TO 600 mm (24") FROM PAVEMENT EDGE |
| 701301-02 | LANE CLOSURE, 2L, 2W, SHORT TIME OPERATIONS |
| 701400-02 | APPROACH TO LANE CLOSURE, FREEWAY/EXPRESSWAY |
| 701402-05 | LANE CLOSURE, FREEWAY/EXPRESSWAY, WITH BARRIER |
| 702001-06 | TRAFFIC CONTROL DEVICES |
| 704001-03 | TEMPORARY CONCRETE BARRIER |

**STATE OF ILLINOIS
DEPARTMENT OF TRANSPORTATION**

**DIVISION OF HIGHWAYS
PROPOSED
HIGHWAY PLANS**

**FAI ROUTE 55 (I-55)
SECTION: 53(6HB-1,6B)BP**

**LIVINGSTON COUNTY
C-93-056-07
BRIDGE PAINTING**

D-93-026-07

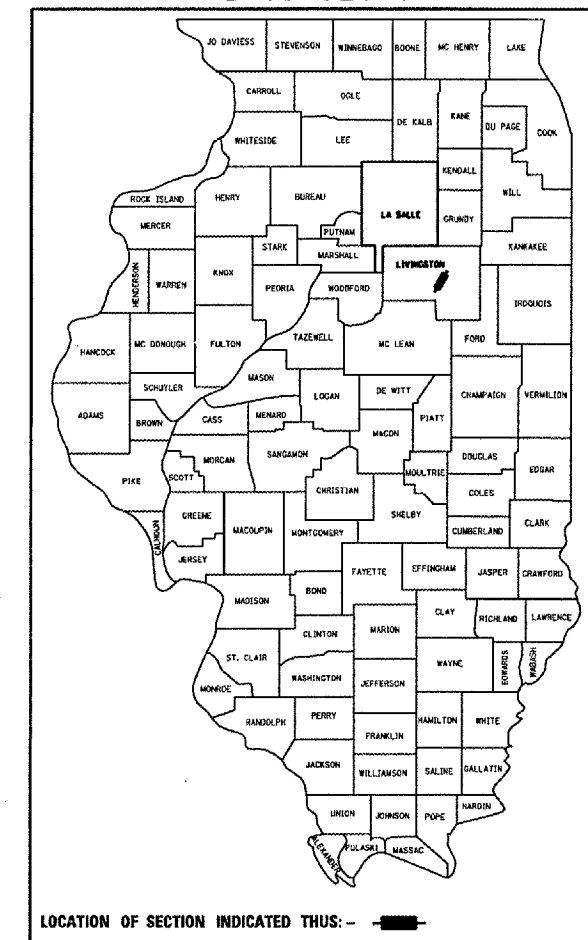

FUNCTIONAL CLASSIFICATION

RURAL - INTERSTATE
F.A.I. ROUTE 55 (I-55)
2005 ADT = 21500

P.V. = 72.3% M.U. = 22.3% S.U. = 5.4%

STATE OF ILLINOIS
DEPARTMENT OF TRANSPORTATION
DIVISION OF HIGHWAYS

SUBMITTED April 2, 2007
George Ragan
DEPUTY DIRECTOR OF HIGHWAYS, REGION ENGINEER

May 11, 2007
Eric E. Harn
INTERIM ENGINEER OF DESIGN AND ENVIRONMENT

May 11, 2007
Milton R. Soos, P.E.
DIRECTOR OF HIGHWAYS, CHIEF ENGINEER

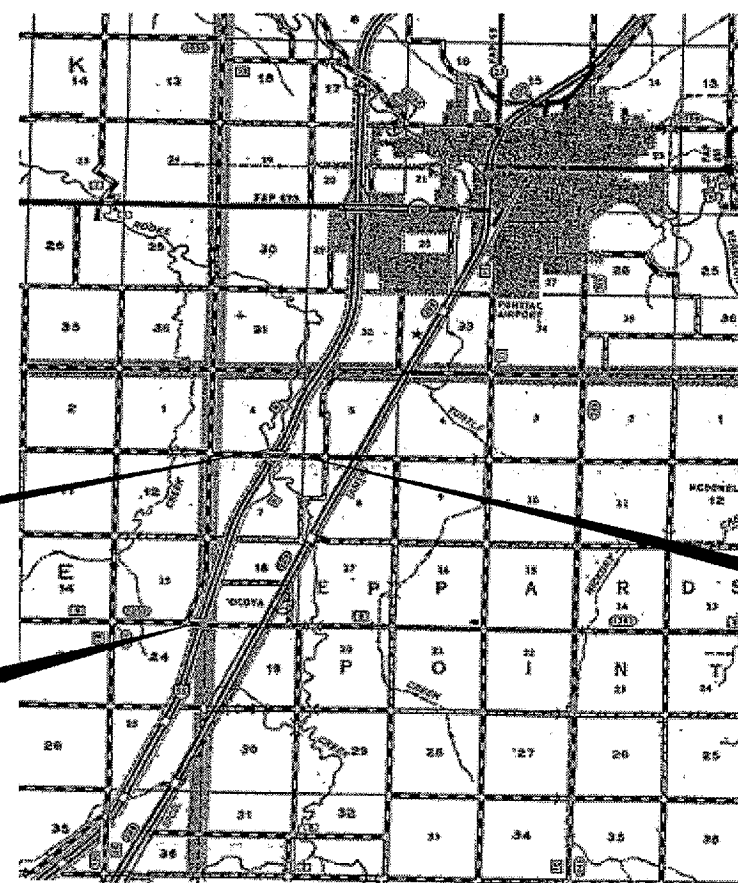

BRIDGE LOCATION NO. 2 SN 053-0124 (SB)
SECTION 53-6B
CARRYING FAI 55 (SB) OVER ROOKS CREEK
3.25 MILES SOUTH OF IL ROUTE 116 (PONTIAC)

BRIDGE LOCATION NO. 1 SN 053-0122
SECTION 53-6HB-1
CARRYING C.H. 8 OVER FAI ROUTE 55
5.37 MILES SOUTH OF IL ROUTE 116 (PONTIAC)

BRIDGE LOCATION NO. 3 SN 053-0125 (NB)
SECTION 53-6B
CARRYING FAI 55 (NB) OVER ROOKS CREEK
3.25 MILES SOUTH OF IL ROUTE 116 (PONTIAC)

MICROFILMED _____
REEL NUMBER _____
AWARDED _____
RESIDENT ENGINEER _____
AS BUILT CHANGES WERE MADE
ON THE FOLLOWING SHEETS _____

J.U.L.I.E.
JOINT UTILITY LOCATION INFORMATION FOR EXCAVATION
1-800-892-0123

DISTRICT NO. 3 815-434-6131

PROJECT ENGINEER: JOE KANNEL
UNIT CHIEF: RON WOODSHANK
TOWNSHIP: EPPARD POINT

CONTRACT NO. 66714

LOCATION MAP

NOT TO SCALE
POINT LOCATION