

F.A.I. RTE.	SECTION	COUNTY	TOTAL SHEETS	SHEET NO.
55	53(6HB-1,6B)BP	LIVINGSTON	15	9

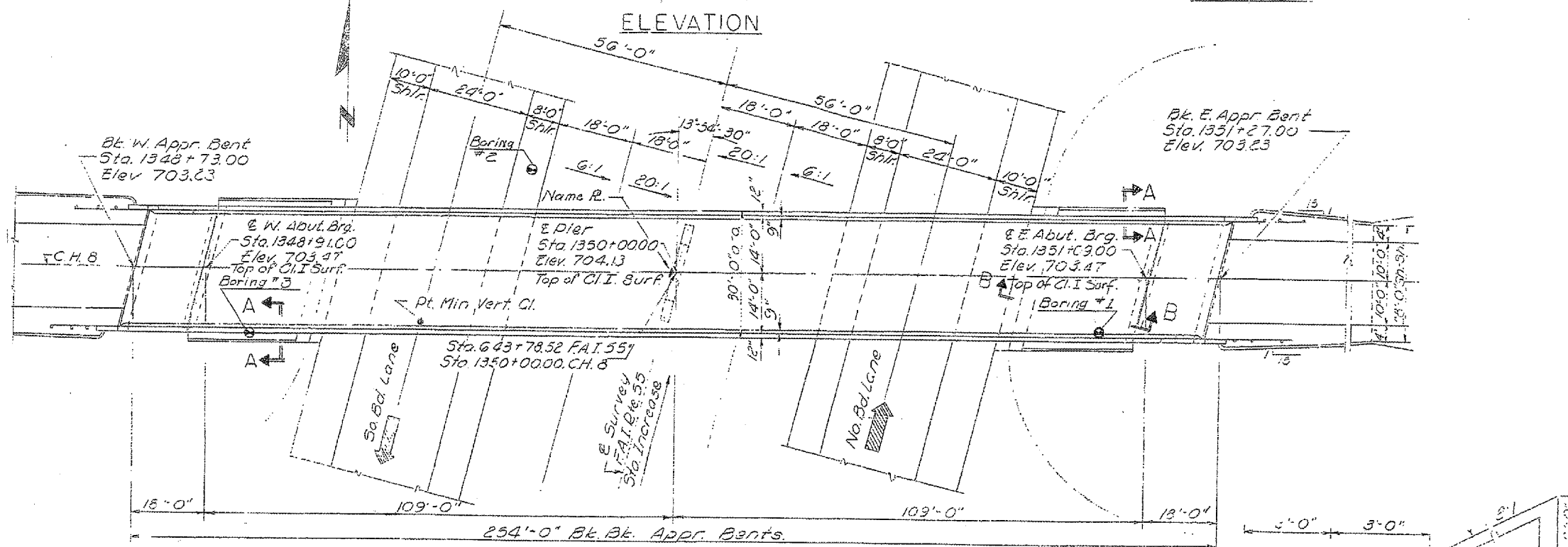
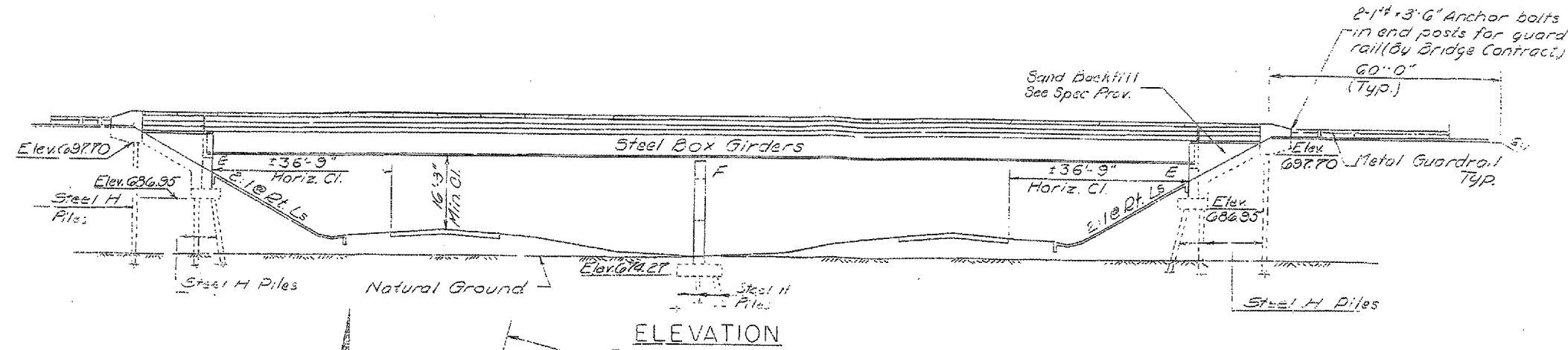

**DESIGN STRESSES**

- $f_c = 1200$  psi. Deck Slab
  - $f_c = 1400$  psi. Curb, Parapet, Sub. & Appr. Slab
  - $f_s = 20,000$  psi. Reinforcing Steel
  - $f_s = 20,000$  psi. Structural Steel
  - $V_c = 75$  psi. Footings
  - $n = 10$
- Allowable Fut. w. s.  $25^{\#}/15q. Ft.$

**PLAN**

STATION 643+78.52  
 BUILT 197 BY  
 STATE OF ILLINOIS  
 F.A.I. RT. 55 SEC. 53(6HB-1)  
 PROJ. I-55-5(41)  
 LOADING H3 15  
**NAME PLATE**  
 (See Std. C113 )

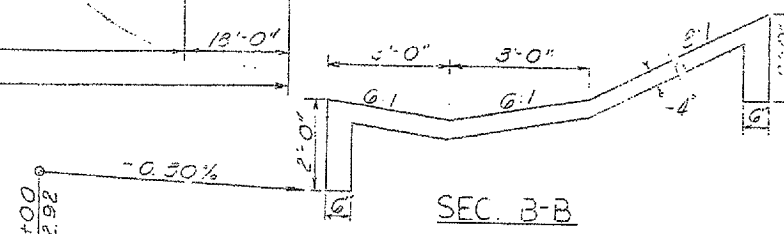

**"FOR INFORMATION ONLY"**

REVISIONS	
NAME	DATE

ILLINOIS DEPARTMENT OF TRANSPORTATION  
**EXISTING STRUCTURE DETAILS**  
**BRIDGE LOCATION NO. 1**  
 FAI ROUTE 55 (I-55) SECTION 53(6HB-1,6B)BP  
 LIVINGSTON COUNTY  
 SN 053-0122, SN 053-0124 (SB), SN 053-0125 (NB)

Date: 03/12/2007 project: bridgepoint-07-053-0124 & 5.dgn