

F.A.I. RTE.	SECTION	COUNTY	TOTAL SHEETS	SHEET NO.
80	(50-3HB)BP	LASALLE	8	1

STATE OF ILLINOIS
DEPARTMENT OF TRANSPORTATION
DIVISION OF HIGHWAYS
**PROPOSED
HIGHWAY PLANS**

FAI ROUTE 80 (I-80)
SECTION (50-3HB)BP

LASALLE COUNTY
C-93-057-07
BRIDGE PAINTING

INDEX OF SHEETS

1. COVER SHEET
2. GENERAL NOTES
3. SUMMARY OF QUANTITIES
4. TYPICAL SECTIONS
5. TRAFFIC CONTROL AND PROTECTION, STANDARD 701402 (SPECIAL)
6. TEMPORARY CONCRETE BARRIER DETAILS
- 7 - 8. EXISTING STRUCTURE DETAILS

STANDARDS

- | | |
|-----------|---|
| 000001-04 | STANDARD SYMBOLS, ABBREVIATIONS AND PATTERNS |
| 635011-01 | REFLECTOR MARKER AND MOUNTING DETAILS |
| 701011-01 | OFF-ROAD MOVING OPERATIONS 2L, 2W, DAY ONLY |
| 701101-01 | OFF-ROAD OPERATIONS MULTILANE, 4.5 m (15') TO 600 mm (24") FROM PAVEMENT EDGE |
| 701301-02 | LANE CLOSURE, 2L, 2W, SHORT TIME OPERATIONS |
| 701400-02 | APPROACH TO LANE CLOSURE, FREEWAY/EXPRESSWAY |
| 701402-05 | LANE CLOSURE, FREEWAY/EXPRESSWAY, WITH BARRIER |
| 702001-06 | TRAFFIC CONTROL DEVICES |
| 704001-03 | TEMPORARY CONCRETE BARRIER |

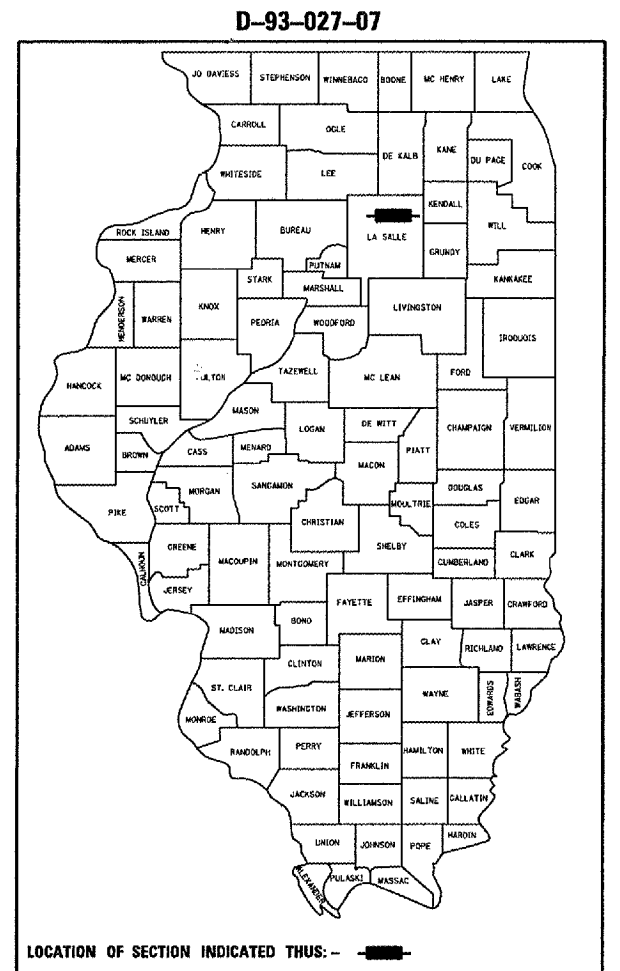

FUNCTIONAL CLASSIFICATION
RURAL - INTERSTATE
F.A.I. ROUTE 80 (I-80)
2005 ADT = 28100
P.V = 61.4% M.U. = 31.3% S.U. = 7.3%

PROJECT LOCATION

SN 050-0127
2.0 MI. EAST OF IL ROUTE 178

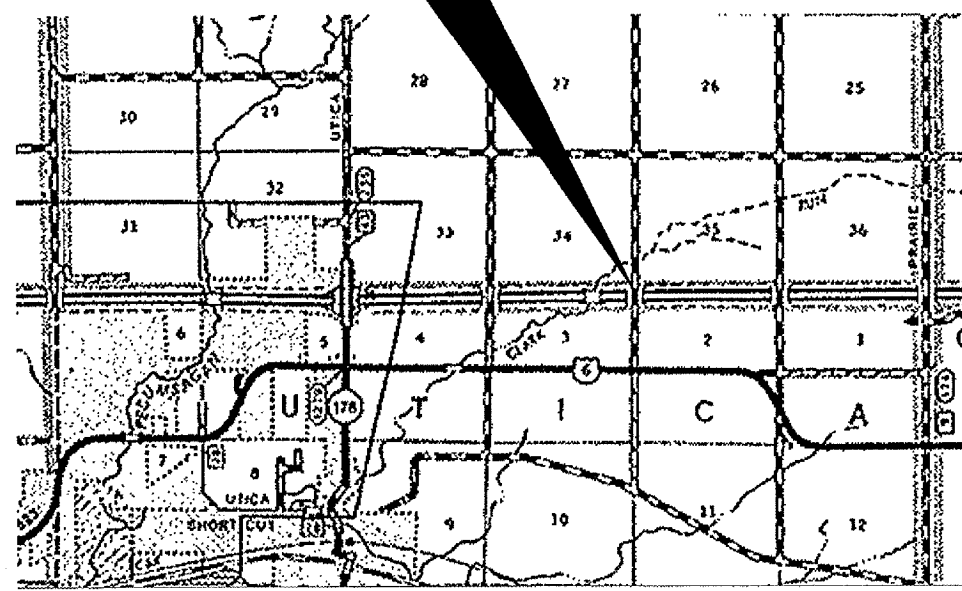

LOCATION MAP

NOT TO SCALE
POINT LOCATION

MICROFILMED _____
REEL NUMBER _____
AWARDED _____
RESIDENT ENGINEER _____
AS BUILT CHANGES WERE MADE
ON THE FOLLOWING SHEETS _____

J.U.L.I.E.
JOINT UTILITY LOCATION INFORMATION FOR EXCAVATION
1-800-892-0123

DISTRICT NO. 3 815-434-6131
PROJECT ENGINEER: JOE KANNEL
UNIT CHIEF: RON WOODSHANK
TOWNSHIP: UTICA

CONTRACT NO. 66715

STATE OF ILLINOIS
DEPARTMENT OF TRANSPORTATION
DIVISION OF HIGHWAYS

SUBMITTED April 7, 2007
George Ryan
DEPUTY DIRECTOR OF HIGHWAYS/REGION ENGINEER

May 11, 2007
Eric F. Hawk
ENGINEER OF DESIGN AND ENVIRONMENT

May 11, 2007
Milton R. Seas, P.E.
DIRECTOR OF HIGHWAYS, CHIEF ENGINEER

**PRINTED BY THE AUTHORITY
OF THE STATE OF ILLINOIS**

Date: 03/12/2007
project:z:/bridgepaint_07/050-0127.dgn