

F.A.U. RTE.	SECTION	COUNTY	TOTAL SHEETS	SHEET NO.
35RS-5,36RS-8	TAZEWELL	90	35	
STA. TO STA.				
FED. ROAD DIST. NO.		ILLINOIS FED. AID PROJECT		
*6717 (BUS 24) & 6713 (IL 8)				

The Contractor shall notify the Resident Engineer a minimum of seven calendar days prior to the detour being used. Contact Bill Harrmann at 309-693-5176 for the route signs. The detour is to be used for milling and resurfacing of Ramp B and placement of the Soluble Reactive Silicate (SRS) Concrete Treatment to the structure on Ramp B. This closure shall be no earlier than 8:00 AM on Friday through 6:00 AM on Monday. No other operation shall be completed with the use of the detour unless it corresponds during the same time frame as this work.

A Changeable Message Board (CMB) shall be placed on McClugage Road on Monday prior to the closure. The sign shall read:

- p. 1: "Fri 8 AM
WB BUS 24
Ramp"
- p. 2: "Closing for Weekend"
- p. 3: "Follow Marked Detour"

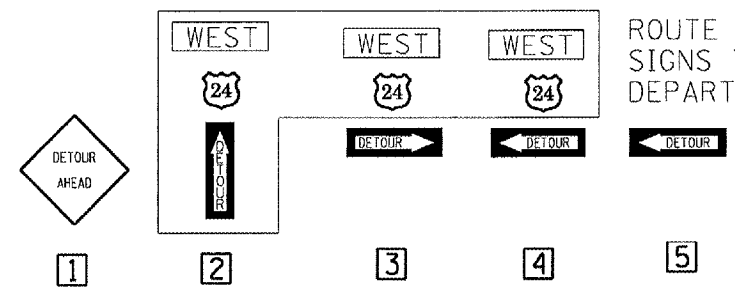

ROUTE MARKER AND VERTICAL DETOUR SIGNS TO BE PROVIDED BY THE DEPARTMENT.

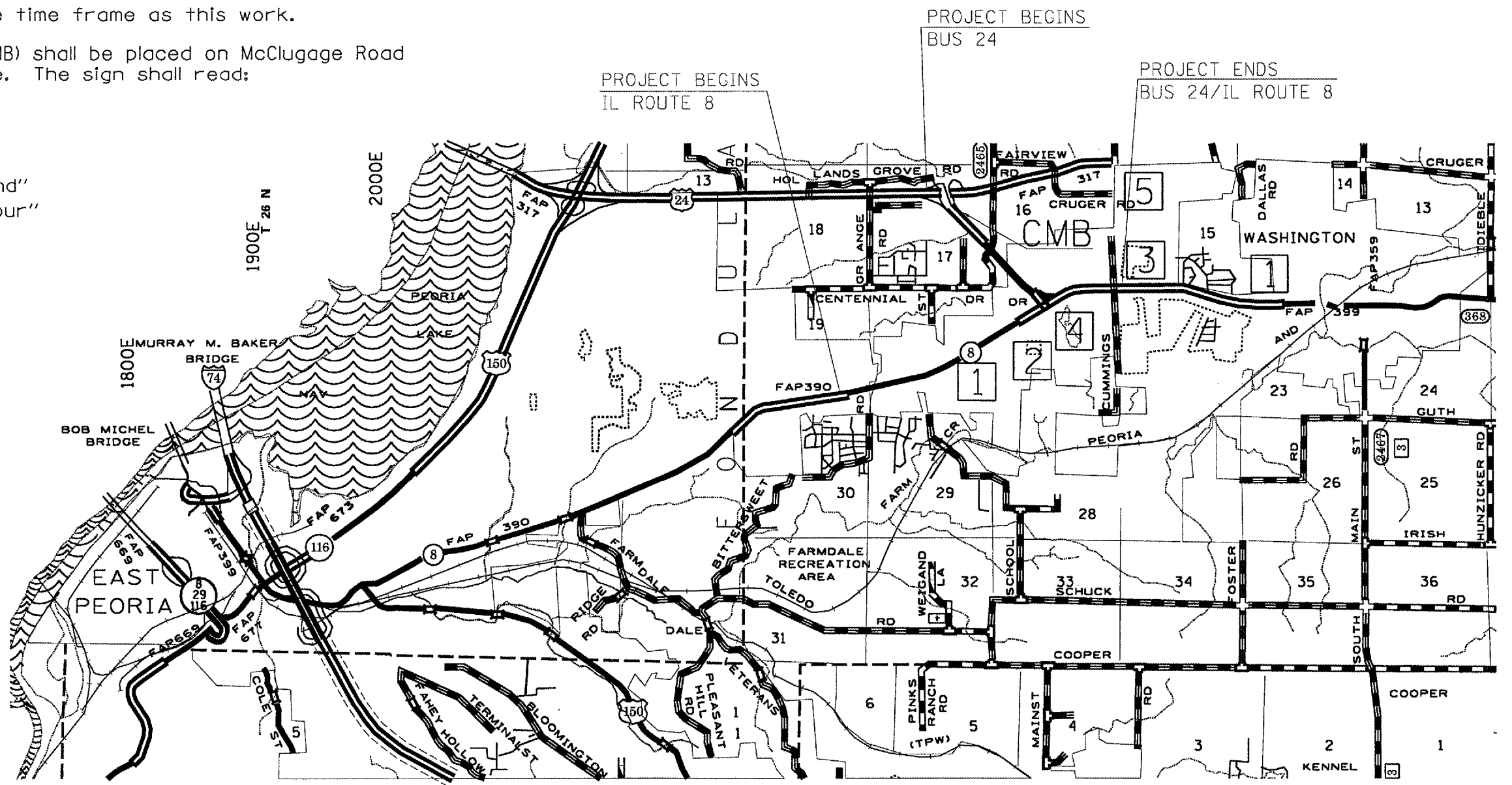

ILLINOIS DEPARTMENT OF TRANSPORTATION

DETOUR ROUTE

SCALE: VERT. NOT TO SCALE
 HORIZ. DATE
 DRAWN BY
 CHECKED BY

PLOT DATE = 4/1/2007
 FILE NAME = c:\vpro\mcta\bus24\constr\plan.dgn
 PLOT SCALE = 1/8"=1'-0"
 USER NAME = h11mra