

F.A.U. RTE.	SECTION	COUNTY	TOTAL SHEETS	SHEET NO.
35RS-5,36RS-8		TAZEWELL	90	52
STA. TO STA.		ILLINOIS FED. AID PROJECT		
		*6717 (BUS 24) & 6713 (IL 8)		

In the area of the 8' stabilized shoulder, only the standard 6' shoulder width will be milled and resurfaced.

STATION EQUATION  
 STA 23+67.71 (FAP 49) =  
 STA 10+84.26 (RAMP B)

STA. 18+15.75 (RAMP A) =  
 47' RT. STA. 27+63.22 (US 24)

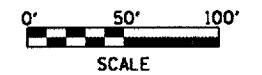
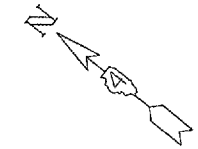
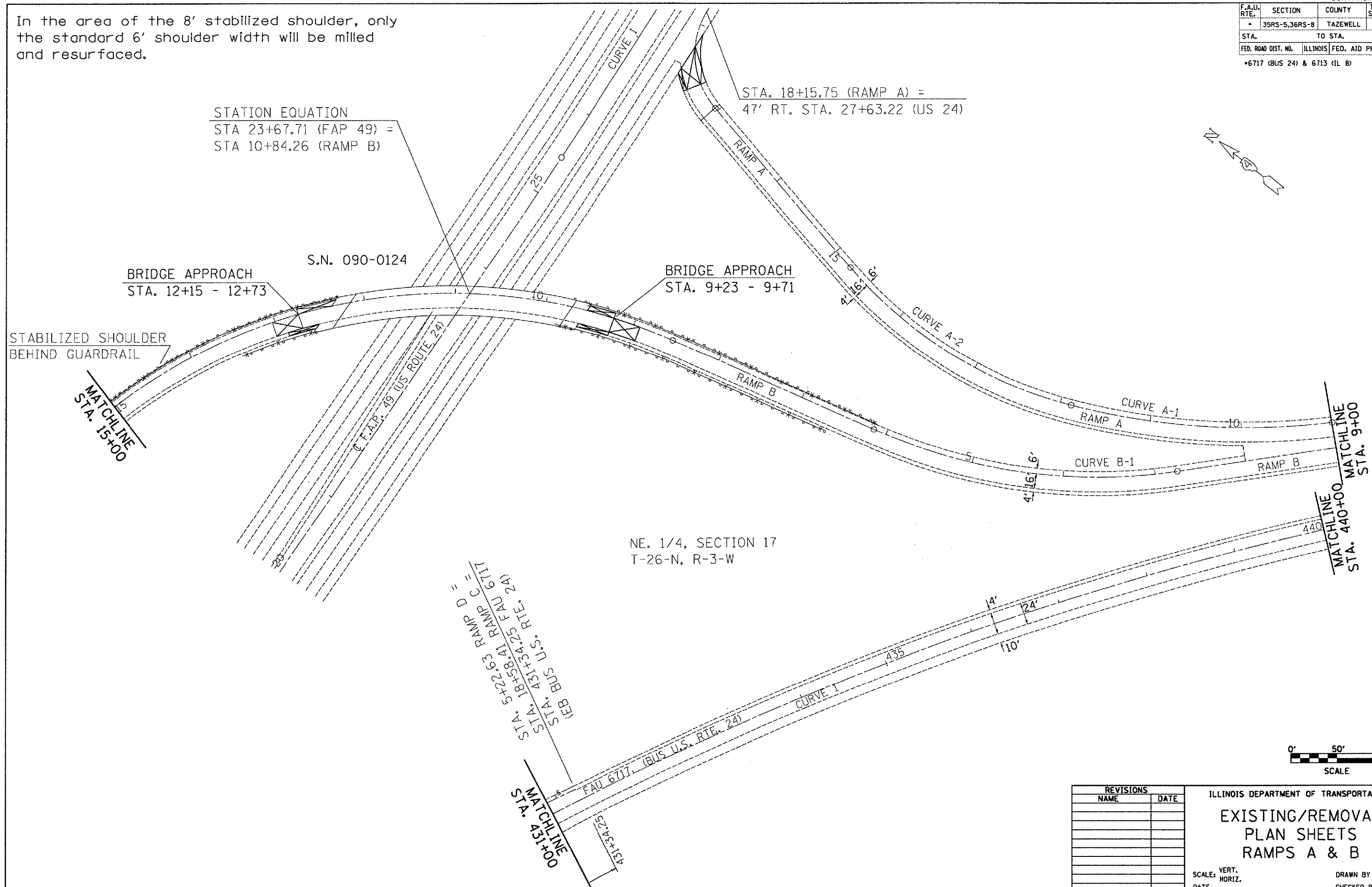

REVISIONS	
NAME	DATE

ILLINOIS DEPARTMENT OF TRANSPORTATION  
**EXISTING/REMOVAL  
 PLAN SHEETS  
 RAMPS A & B**

SCALE: VERT. \_\_\_\_\_  
 HORIZ. \_\_\_\_\_  
 DATE \_\_\_\_\_

DRAWN BY \_\_\_\_\_  
 CHECKED BY \_\_\_\_\_

PLOT DATE = 4/4/2007  
 PLOT NAME = \\s241\consult\plan\endg  
 PLOT SCALE = 1/8"=1'-0"  
 USER NAME = kjmorkh