

F.A.U. RTE.	SECTION	COUNTY	TOTAL SHEETS	SHEET NO.
35RS-5,36RS-8	TAZEWELL	ILLINOIS	90	54
STA.		TO STA.		
FED. ROAD DIST. NO.		ILLINOIS FED. AID PROJECT		
6717 (BUS 24) & 6713 (IL 8)				

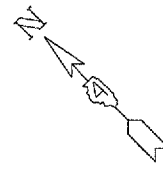

NE 1/4, SECTION 16
T-26-N, R-3-W

NE 1/4, SECTION 17
T-26-N, R-3-W

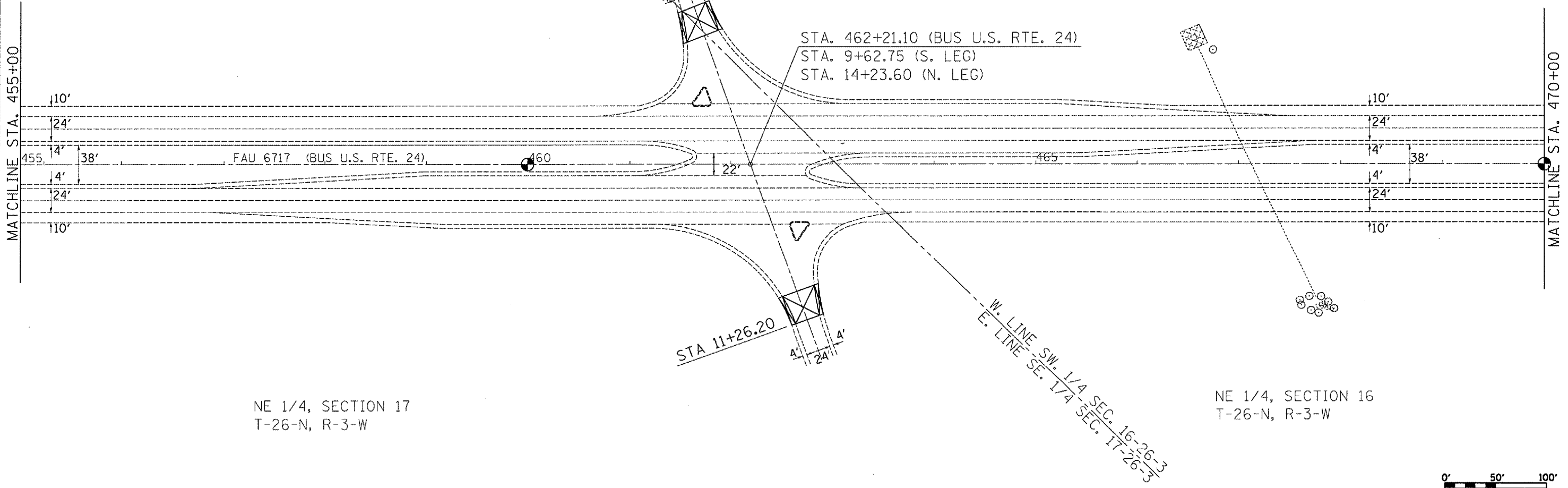

NE 1/4, SECTION 17
T-26-N, R-3-W

NE 1/4, SECTION 16
T-26-N, R-3-W

W. LINE SW. 1/4 SEC. 16-26-3
E. LINE SE. 1/4 SEC. 17-26-3

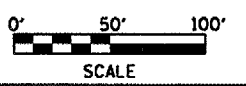

REVISIONS	
NAME	DATE

ILLINOIS DEPARTMENT OF TRANSPORTATION
EXISTING/REMOVAL
PLAN SHEET
BUS U.S. RTE. 24
STA. 455+00-470+00
SCALE: VERT. _____
HORIZ. _____
DRAWN BY _____
CHECKED BY _____

PLOT DATE = 4/4/2007
PLOT TIME = 10:55:24
PLOT SCALE = 1/8" = 100'
USER NAME = kulmanek