

F.A.I. RTE.	SECTION	COUNTY	TOTAL SHEETS	SHEET NO.
57	•	••	153	4

STA.	TO STA.
FED. ROAD DIST. NO.	ILLINOIS FED. AID PROJECT

- D5 SAFETY IMPROVEMENT 2007-2
- CHAMPAIGN, COLES, & DOUGLAS

LOCATION MAP #1

F.A.I. 57, FROM COLES /DOUGLAS COUNTY LINE TO DOUGLAS /CHAMPAIGN COUNTY LINE

DOUGLAS COUNTY /RURAL MULTILANE

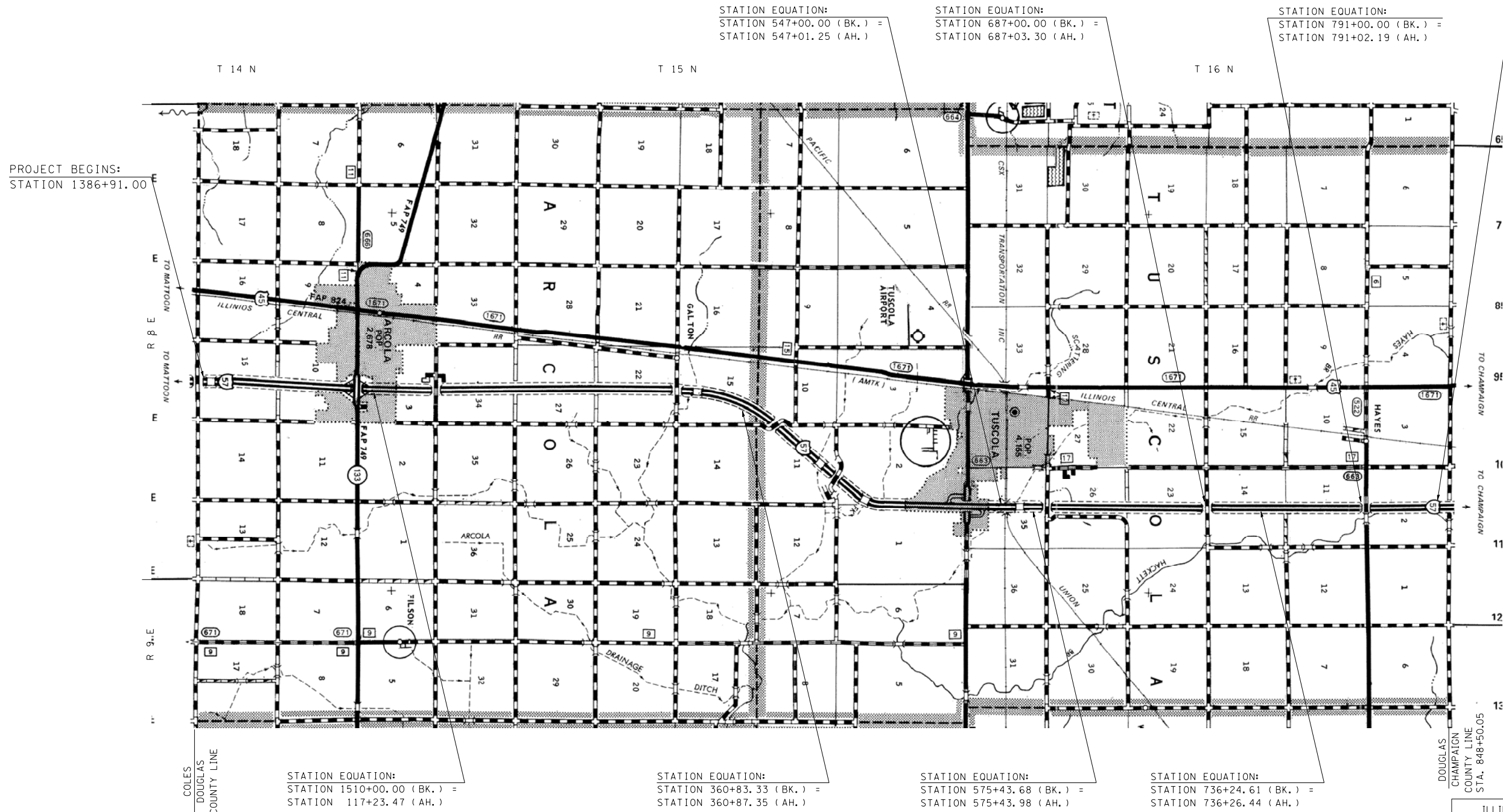

PROJECT BEGINS:
STATION 1386+91.00

STATION EQUATION:
STATION 547+00.00 (BK.) =
STATION 547+01.25 (AH.)

STATION EQUATION:
STATION 687+00.00 (BK.) =
STATION 687+03.30 (AH.)

STATION EQUATION:
STATION 791+00.00 (BK.) =
STATION 791+02.19 (AH.)

STATION EQUATION:
STATION 843+84.01 (BK.) =
STATION 843+83.95 (AH.)

STATION EQUATION:
STATION 1510+00.00 (BK.) =
STATION 117+23.47 (AH.)

STATION EQUATION:
STATION 360+83.33 (BK.) =
STATION 360+87.35 (AH.)

STATION EQUATION:
STATION 575+43.68 (BK.) =
STATION 575+43.98 (AH.)

STATION EQUATION:
STATION 736+24.61 (BK.) =
STATION 736+26.44 (AH.)

TOTAL LENGTH OF SECTION = 293,923.82 FT. = 55.667 MILES
NET LENGTH OF SECTION = 293,923.82 FT. = 55.667 MILES

PLOT DATE = 3/30/2007
 FILE NAME = c:\projects\d5\406 (v8)\70628\lsh\sheet1.dgn
 PLOT SCALE = 42.3529 / IN.
 USER NAME = pier-sonbr

ILLINOIS DEPARTMENT OF TRANSPORTATION
LOCATION MAPS
F.A.I. ROUTE 57 (I-57)
SECTION D5 SAFETY IMPROVEMENT 2007-2
CHAMPAIGN, COLES, & DOUGLAS COUNTIES

SCALE: NOT TO SCALE
DATE: 01/30/07

DRAWN BY: B.B.P.
CHECKED BY: M.L.B.