

F.A.P. RTE.	SECTION	COUNTY	TOTAL SHEETS	SHEET NO.
717	109(RS-3)	LOGAN	31	25
STA. 529+00		TO STA. 586+00		
FED. ROAD DIST. NO. 6		ILLINOIS FED. AID PROJECT		
CONTRACT NO. 72825				

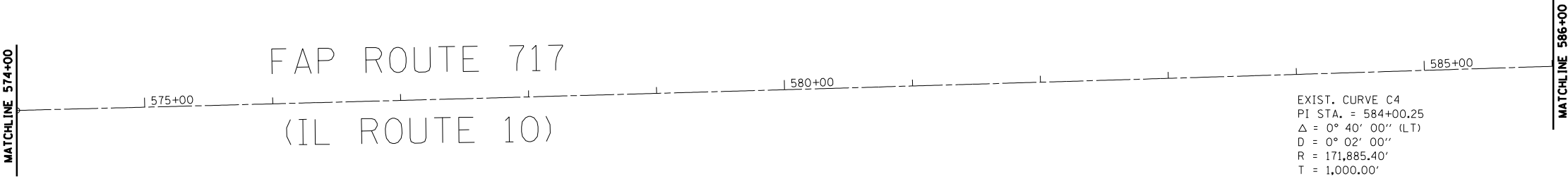
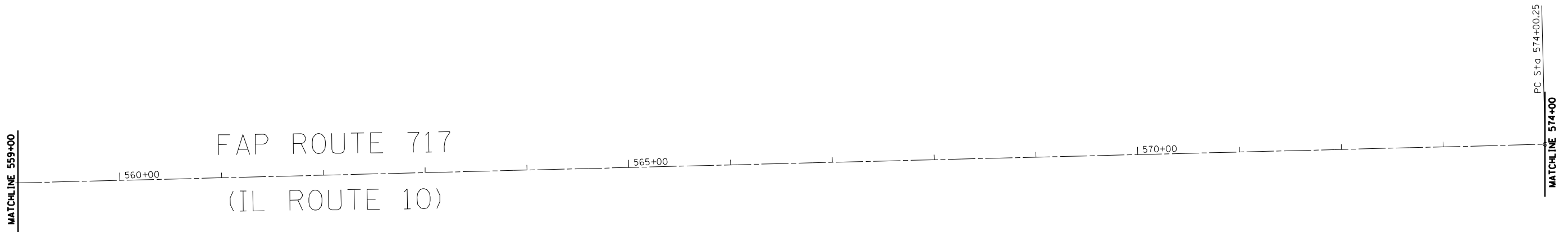
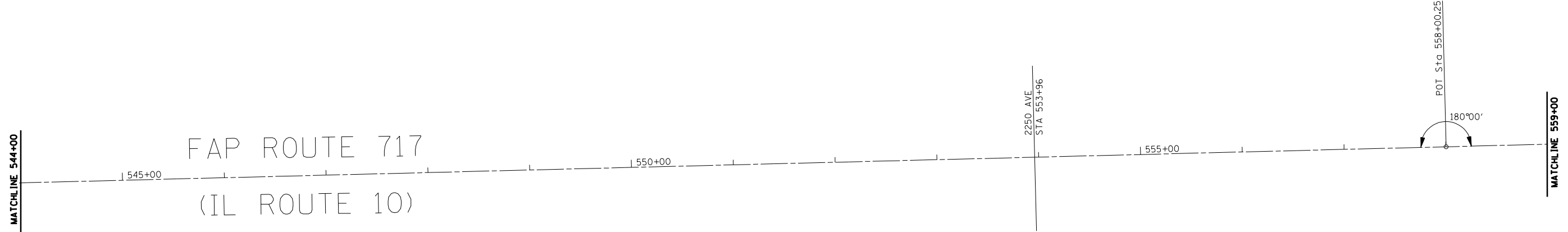
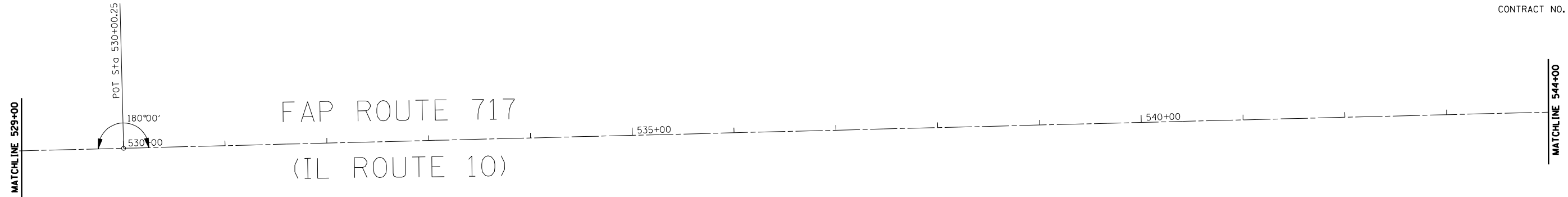

EXIST. CURVE C4
 PI STA. = 584+00.25
 $\Delta = 0^\circ 40' 00''$ (LT)
 $D = 0^\circ 02' 00''$
 $R = 171,885.40'$
 $T = 1,000.00'$
 $L = 1,999.98'$
 $E = 2.91'$
 $e = N.C.$
 P.C. STA. = 574+00.25
 P.T. STA. = 594+00.22

REVISIONS	
NAME	DATE
TMJ	03-07

ILLINOIS DEPARTMENT OF TRANSPORTATION

ALIGNMENT
 FAP ROUTE 717 (IL 10)
 SECTION 109 (RS-3)
 LOGAN COUNTY

SCALE: VERT. 1"=20'
 HORIZ. 1"=50'
 DATE: AUG 2004

DRAWN BY: LJR
 CHECKED BY: LDB



G:\PROJ\CIVIL\G13303.74\DMV\ALIGNMENT