

F.A.P. RTE.	SECTION	COUNTY	TOTAL SHEETS	SHEET NO.
317	(9,10,11) RS-3	SCHUYLER	23	14
STA. 490+00		TO STA. 550+00		
FED. ROAD DIST. NO.	ILLINOIS	FED. AID PROJECT		
CONTRACT 72838				

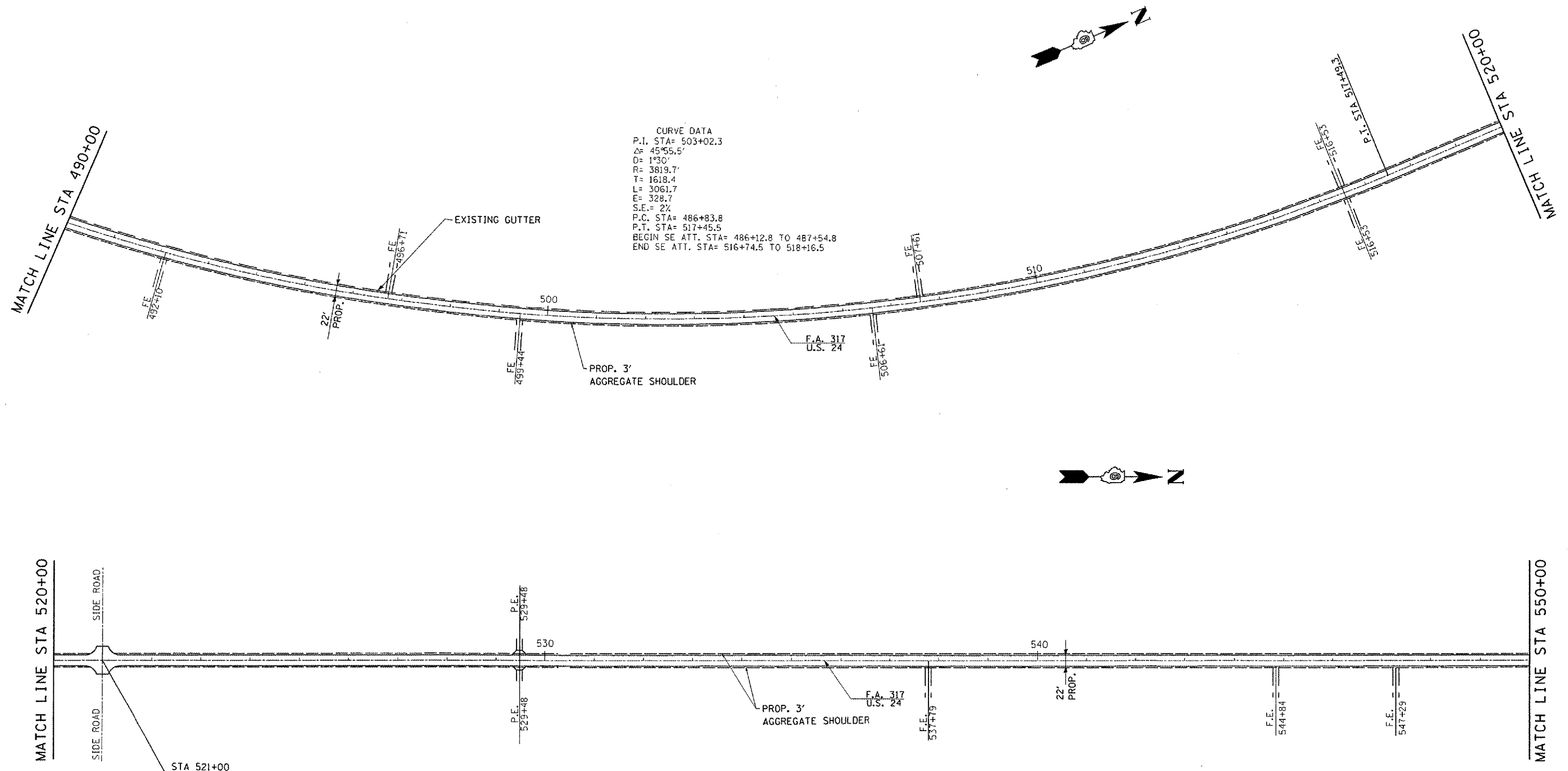

CURVE DATA
P.I. STA= 503+02.3
 $\Delta = 45^{\circ}55.5'$
 $D = 1^{\circ}30'$
 $R = 3819.7'$
 $T = 1618.4'$
 $L = 3061.7'$
 $E = 328.7'$
 $S.E. = 2\%$
P.C. STA= 486+83.8
P.T. STA= 517+45.5
BEGIN SE ATT. STA= 486+12.8 TO 487+54.8
END SE ATT. STA= 516+74.5 TO 518+16.5

NOTE:
END EDGELINE PAVEMENT MARKING THROUGH SIDE ROADS

REVISIONS	
NAME	DATE

ILLINOIS DEPARTMENT OF TRANSPORTATION
ALIGNMENT SCHEMATIC
F. A. P. ROUTE 317 (U. S. 24)
SECTION (9, 10, 11) RS-3
SCHUYLER COUNTY
SCALE: NOT TO SCALE
DATE: OCT, 2003
DRAWN BY: AGG
CHECKED BY: MJS