

F.A.P. RTE.	SECTION	COUNTY	TOTAL SHEETS	SHEET NO.
317	(9,10,11) RS-3	SCHUYLER	23	15
STA. 550+00		TO STA. 170+00		
FED. ROAD DIST. NO.	ILLINOIS	FED. AID PROJECT		
CONTRACT 72838				

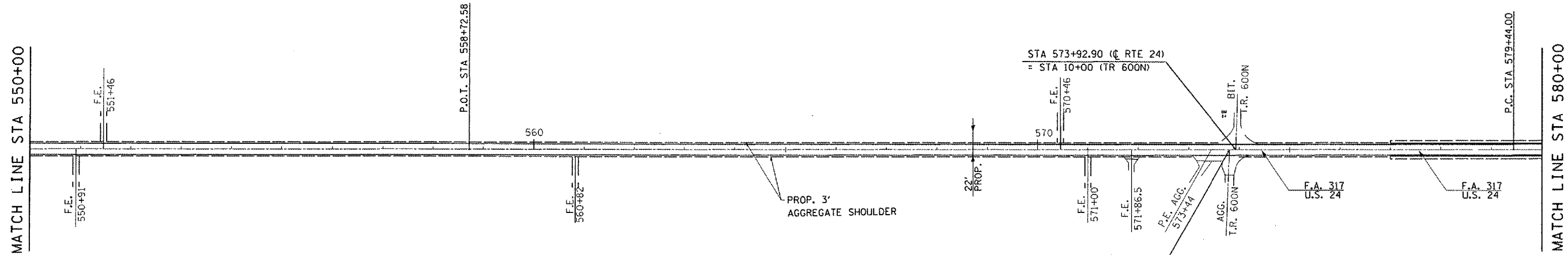

CURVE DATA
P.I. STA= 583+94
 Δ = 0°-25'-39.5"
D= 0°-02'-51"
R= 120583.5
T= 450.00
L= 900
E= 0.84
S.E.= NO S.E.
P.C. STA= 579+44.00
P.T. STA= 588+44.00 BK
P.T. STA= 150+38.00 AH

CURVE DATA
P.I. STA= 166+84.10
 Δ = 0°-16'-41.5"
D= 0°-02'-00"
R= 171887.40
T= 417.23
L= 834.58
E= 0.51
S.E.= N.C.
P.C. STA= 162+66.81
P.T. STA= 171+01.39

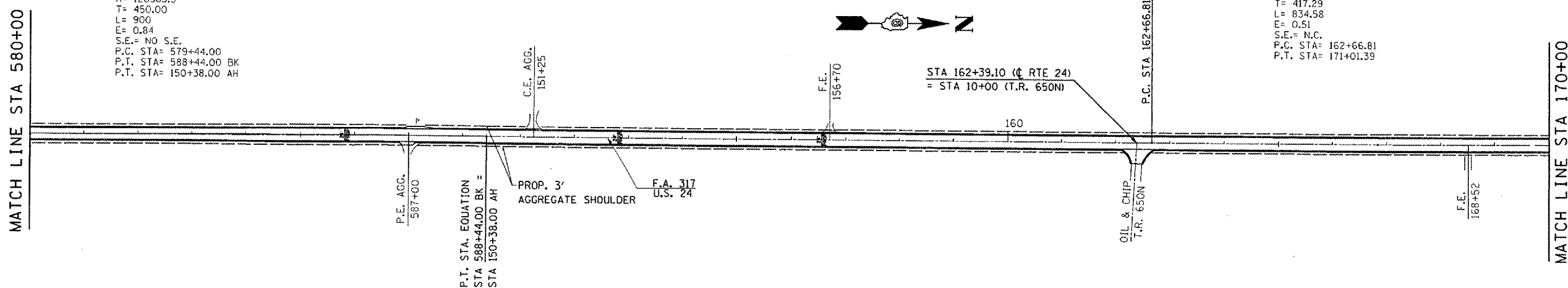

NOTE:
END EDGELINE PAVEMENT MARKING THROUGH SIDE ROADS

REVISIONS	
NAME	DATE

ILLINOIS DEPARTMENT OF TRANSPORTATION
ALIGNMENT SCHEMATIC
F. A. P. ROUTE 317 (U. S. 24)
SECTION (9, 10, 11) RS-3
SCHUYLER COUNTY
SCALE: NOT TO SCALE
DATE: OCT, 2003
DRAWN BY AGG
CHECKED BY MJS