

F.A.P. RTE.	SECTION	COUNTY	TOTAL SHEETS	SHEET NO.
317	(9,10,11) RS-3	SCHUYLER	23	17
STA. 220+00		TO STA. 270+00		
FED. ROAD DIST. NO.	ILLINOIS FED. AID PROJECT			
CONTRACT 72838				

CURVE DATA
P.I. STA= 226+87.24
 Δ = 15°-02'-45"
D= 1°-00'-11"
R= 5712.12
T= 754.34
L= 1500
E= 49.59
S.E.= 0.021 '/'
P.C. STA= 219+32.90
P.T. STA= 234+32.90
S.E. ATTN. = STA 218+16.23 TO 219+91.23
S.E. REM. = STA 233+74.57 TO 235+49.57

CURVE DATA
P.I. STA= 254+00.74
 Δ = 7°-58'-41.5"
D= 0°-59'-50"
R= 5745.24
T= 400.65
L= 800
E= 13.95
S.E.= 0.021 '/'
P.C. STA= 250+00.09
P.T. STA= 258+00.09
S.E. ATTN. = STA 248+83.42 TO 250+58.42
S.E. REM. = STA 257+41.76 TO 259+16.76

CURVE DATA
P.I. STA= 269+06.36
 Δ = 15°-07'-16.5"
D= 1°-29'-56"
R= 3822.81
T= 507.40
L= 1008.9
E= 33.53
S.E.= 0.03 '/'
P.C. STA= 263+98.96
P.T. STA= 274.07.86
S.E. ATTN. = STA 262+82.29 TO 264+57.29
S.E. REM. = STA 273+49.53 TO 275+24.53

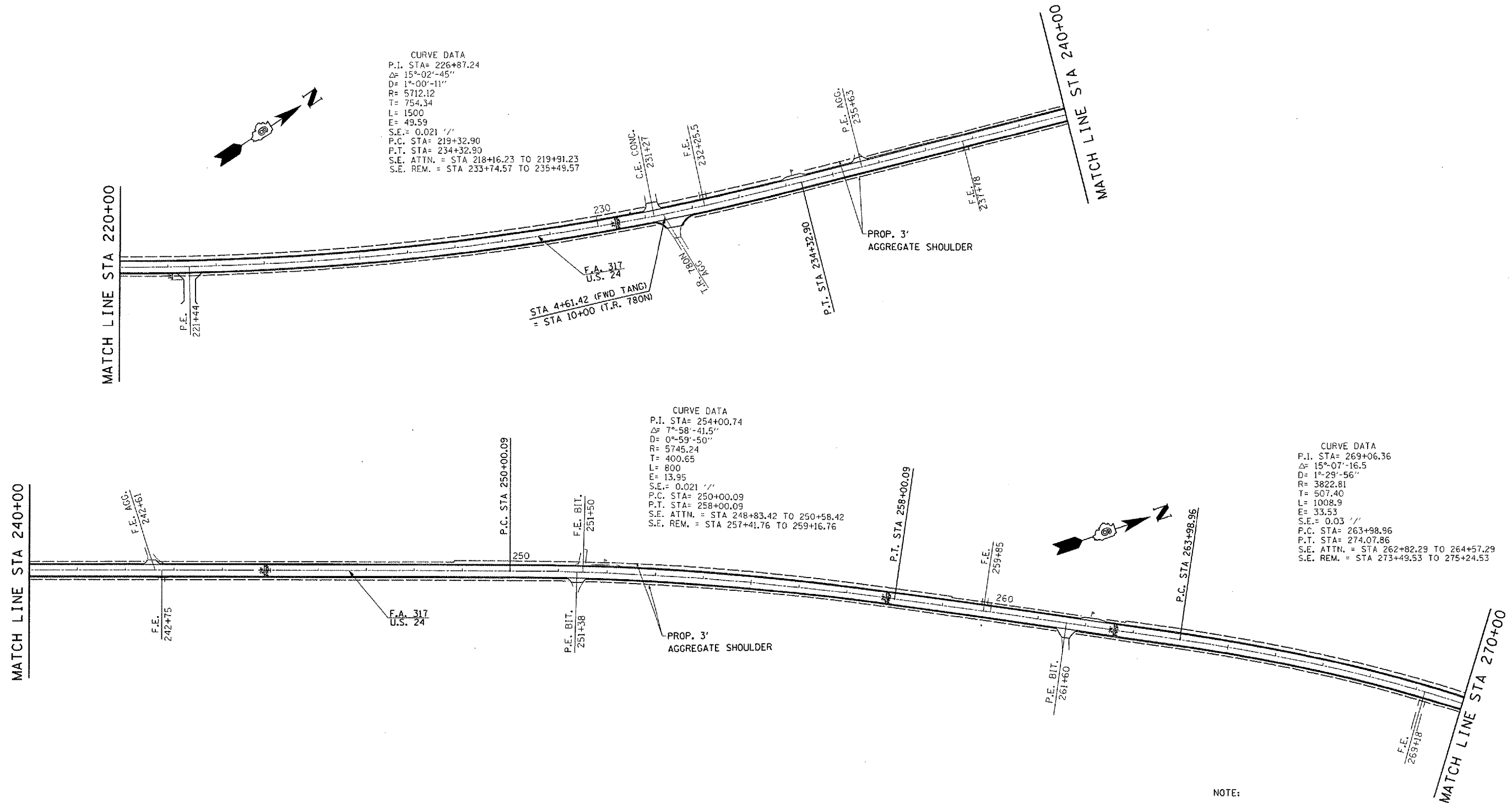

NOTE:
END EDGELINE PAVEMENT MARKING THROUGH SIDE ROADS

REVISIONS	
NAME	DATE

ILLINOIS DEPARTMENT OF TRANSPORTATION
ALIGNMENT SCHEMATIC
F. A. P. ROUTE 317 (U. S. 24)
SECTION (9, 10, 11) RS-3
SCHUYLER COUNTY
SCALE: NOT TO SCALE
DATE: OCT, 2003
DRAWN BY: AGG
CHECKED BY: MJS