

F.A.P. RTE.	SECTION	COUNTY	TOTAL SHEETS	SHEET NO.
317	(9,10,11) RS-3	SCHUYLER	23	19
STA. 330+00		TO STA. 380+00		
FED. ROAD DIST. NO.		ILLINOIS FED. AID PROJECT		
CONTRACT 72838				

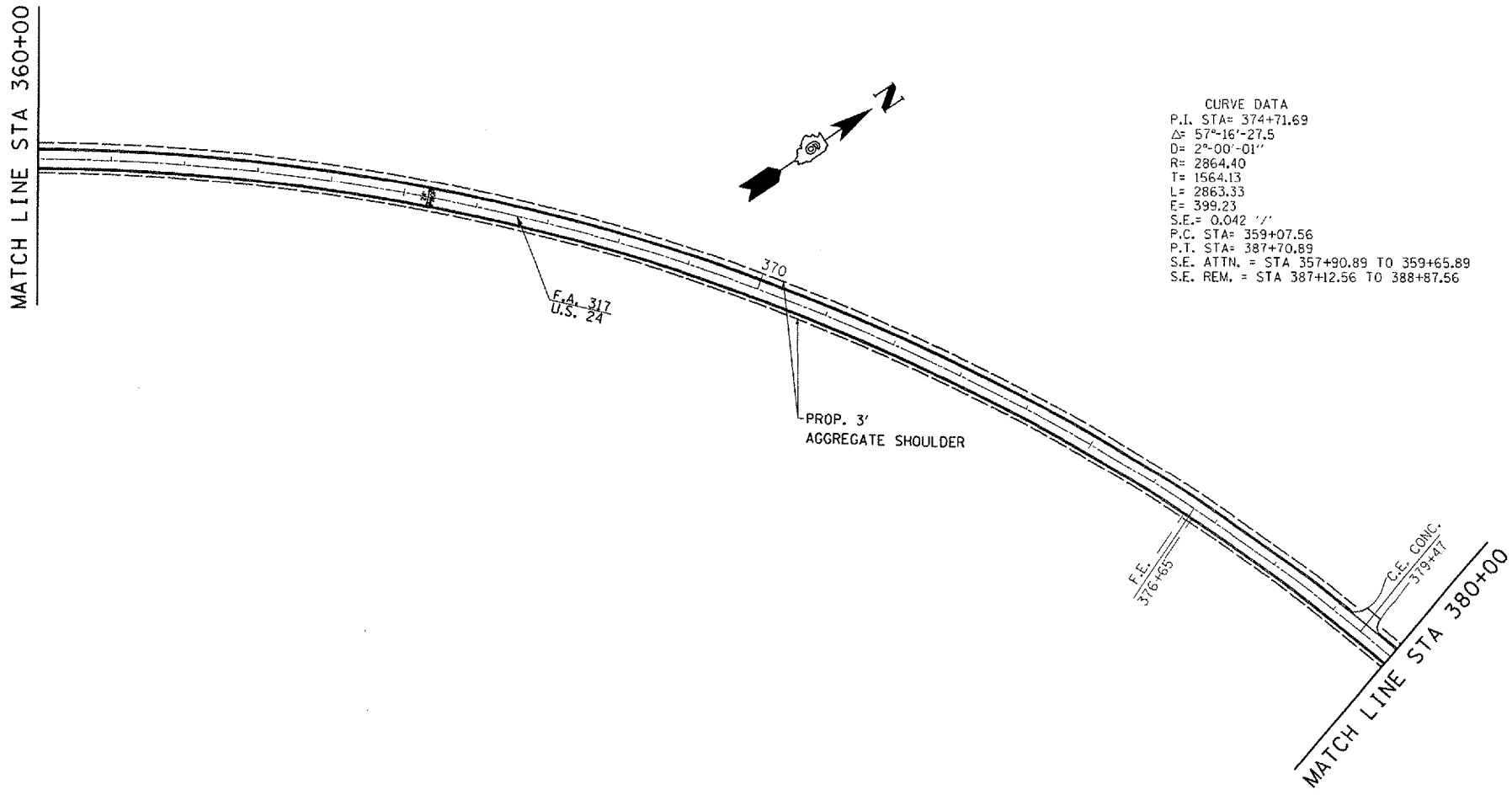
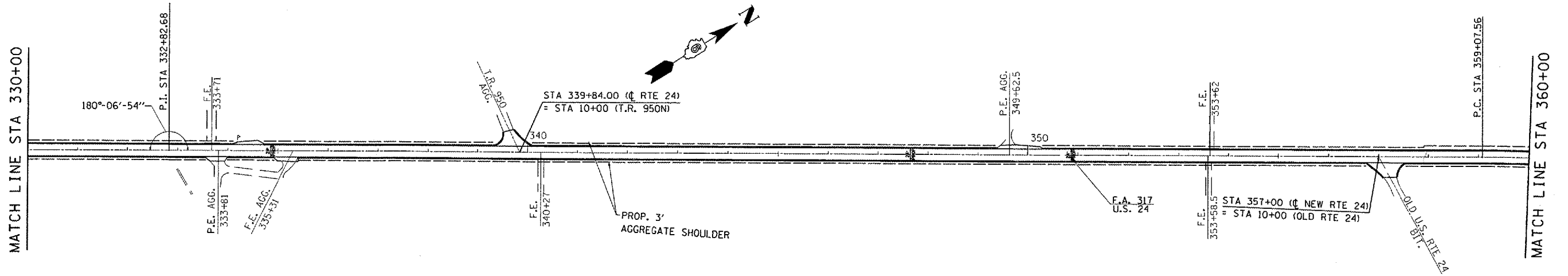

CURVE DATA
 P.I. STA= 374+71.69
 Δ = 57°-16'-27.5
 D= 2°-00'-01"
 R= 2864.40
 T= 1564.13
 L= 2863.33
 E= 399.23
 S.E.= 0.042 %
 P.C. STA= 359+07.56
 P.T. STA= 387+70.89
 S.E. ATTN. = STA 357+90.89 TO 359+65.89
 S.E. REM. = STA 387+12.56 TO 388+87.56

NOTE:
 END EDGELINE PAVEMENT MARKING THROUGH SIDE ROADS

REVISIONS	
NAME	DATE

ILLINOIS DEPARTMENT OF TRANSPORTATION
ALIGNMENT SCHEMATIC
 F. A. P. ROUTE 317 (U. S. 24)
 SECTION (9, 10, 11) RS-3
 SCHUYLER COUNTY
 SCALE: NOT TO SCALE
 DATE: OCT, 2003
 DRAWN BY: AGG
 CHECKED BY: MJS