

F.A.P. RTE.	SECTION	COUNTY	TOTAL SHEETS	SHEET NO.
317	(9,10,11)RS-3	SCHUYLER	23	20
STA. 380+00		TO STA. 389+00		
FED. ROAD DIST. NO.	ILLINOIS	FED. AID PROJECT		

CONTRACT 72838

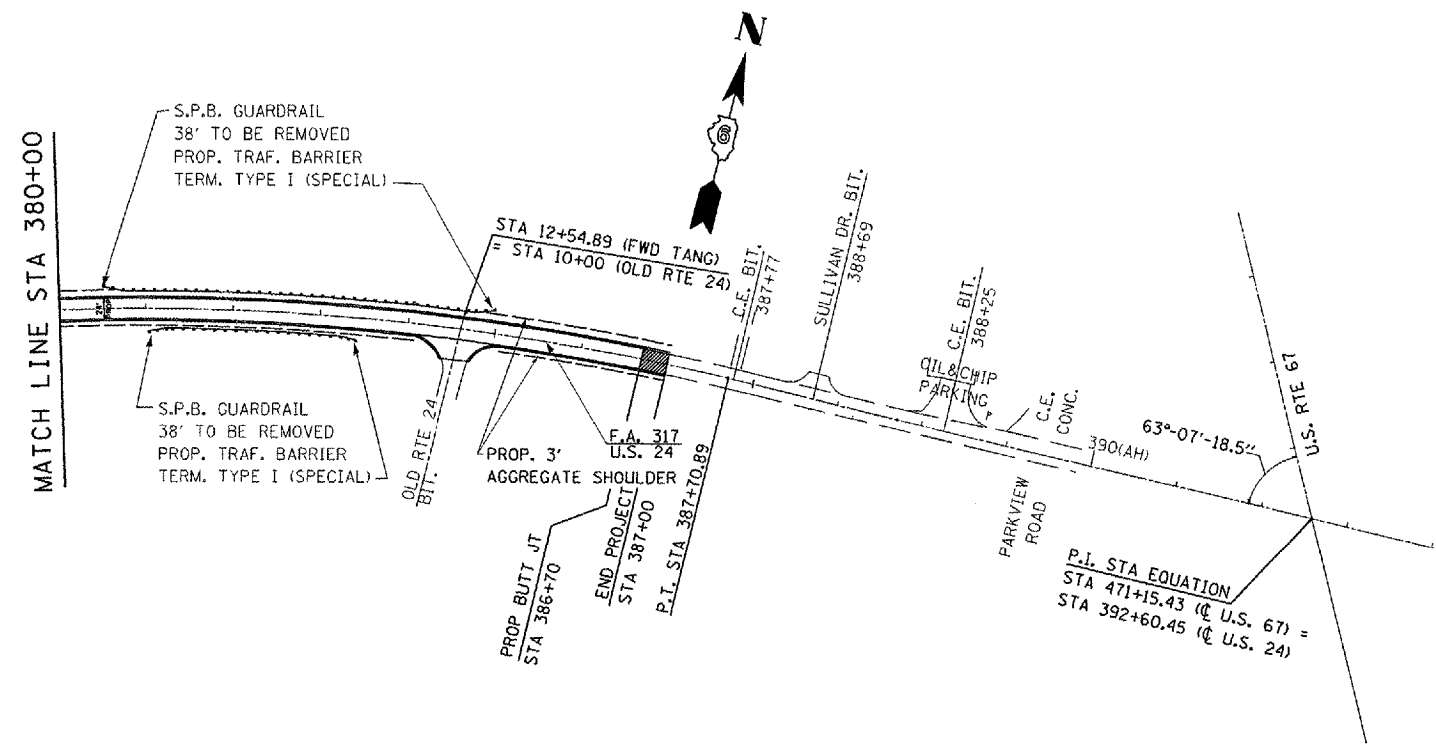

NOTE:
END EDGELINE PAVEMENT MARKING THROUGH SIDE ROADS

REVISIONS	
NAME	DATE

ILLINOIS DEPARTMENT OF TRANSPORTATION
ALIGNMENT SCHEMATIC
 F. A. P. ROUTE 317 (U. S. 24)
 SECTION (9, 10, 11) RS-3
 SCHUYLER COUNTY

SCALE: NOT TO SCALE
 DATE: OCT. 2003

DRAWN BY: AGC
 CHECKED BY: MJS