

F.A.P. RTE.	SECTION	COUNTY	TOTAL SHEETS	SHEET NO.
317	(9,10,11) RS-3	SCHUYLER	23	1

CONTRACT NO. 72838

STATE OF ILLINOIS
DEPARTMENT OF TRANSPORTATION
DIVISION OF HIGHWAYS

**PROPOSED
HIGHWAY PLANS**

FAP ROUTE 317 (US 24)
SECTION (9, 10, 11) RS-3
PROJECT: F-0317(071)
SCHUYLER COUNTY
C-96-560-07

FOR INDEX OF SHEETS, SEE SHEET NO. 2

FOR LIST OF STANDARDS, SEE SHEET NO. 2

D-96-555-03

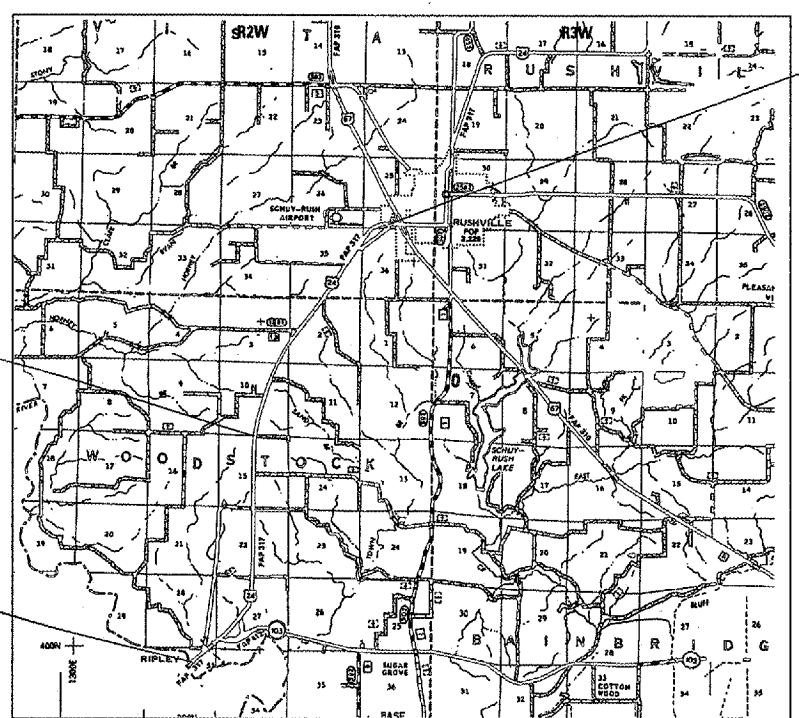
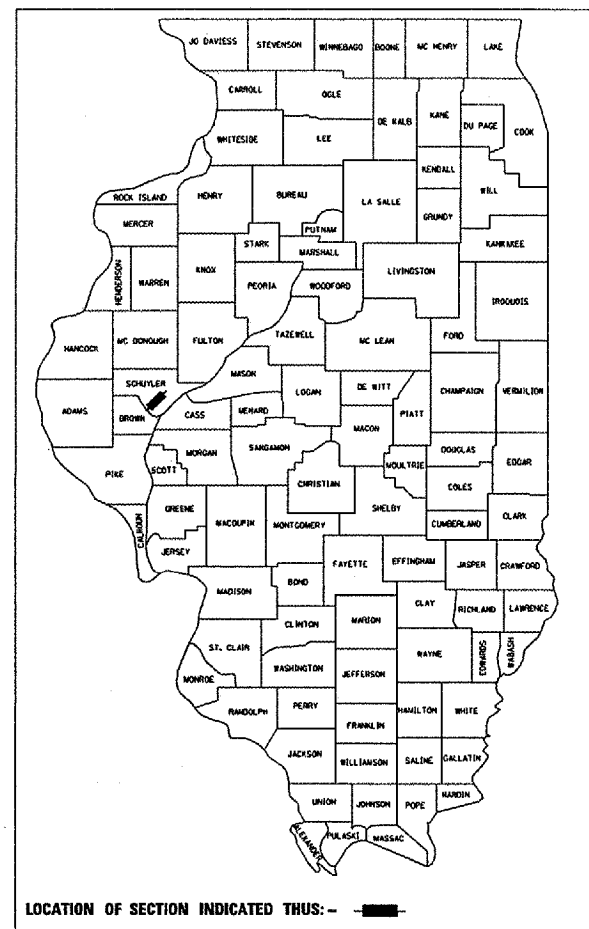

END PROJECT
STA. 387+00

STA. EQ.
STA 588+44.00 (BK) =
STA 150+38.00 (AH)

BEGIN PROJECT
STA. 469+00

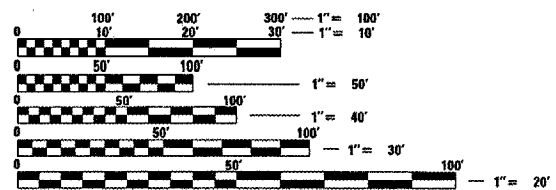

FULL SIZE PLANS HAVE BEEN PREPARED USING STANDARD ENGINEERING SCALES. REDUCED SIZED PLANS WILL NOT CONFORM TO STANDARD SCALES. IN MAKING MEASUREMENTS ON REDUCED PLANS, THE ABOVE SCALES MAY BE USED.

J.U.L.I.E.
JOINT UTILITY LOCATION INFORMATION FOR EXCAVATION
1-800-892-0123

LOCATION MAP

NET LENGTH OF SECTION = 35,806 FT = 6.743 MILES

AVG ADT = 2300 (2001)
% MU + SU = 18%

PROJECT ENGINEER JOHN NEGANGARD 217-782-6990
SQUAD LEADER VINCE MADONIA 217-785-9046

STATE OF ILLINOIS
DEPARTMENT OF TRANSPORTATION
DIVISION OF HIGHWAYS

SUBMITTED MARCH 23, 20 07
Christ H Reed
DISTRICT ENGINEER

May 11, 20 07
Eric E. Ham
ENGINEER OF DESIGN AND ENVIRONMENT

May 11, 20 07
Melton R. Sees, P.E.
DIRECTOR, DIVISION OF HIGHWAYS

**PRINTED BY THE AUTHORITY
OF THE STATE OF ILLINOIS**

CONTRACT NO. 72838

GENERAL NOTES

- ANY REFERENCE TO THE STANDARDS THROUGHOUT THE PLANS SHALL BE INTERPRETED TO BE THE LATEST STANDARDS OF THE DEPARTMENT AS INCLUDED IN THE PLANS.
- NO EXCAVATION ANTICIPATED ON THIS PROJECT WHICH WOULD AFFECT UTILITIES. SHOULD ANY EXCAVATION BE REQUIRED, J.U.L.I.E. SHALL BE NOTIFIED A MINIMUM OF 48 HOURS IN ADVANCE - (800) 892-0123.
- THE FOLLOWING APPLICATION RATES WERE USED FOR QUANTITY CALCULATIONS:

LEVELING BINDER	0.056 T / SY*IN
BIT. CONC. SURF. CSE.	0.056 T / SY*IN
PRIME COAT (BIT) - ON PAVEMENT	.00038 T / SY
PRIME COAT (BIT) - ON SHOULDERS & ENTRANCES	.001425 T / SY
PRIME COAT (AGG)	.002 T / SY
- ACTUAL SIZE AND LOCATIONS OF PATCHES WILL BE DETERMINED IN THE FIELD BY THE RESIDENT ENGINEER.
- IN ADDITION TO FIELD SURVEYS AND AERIAL SURVEYS, PLAN DIMENSIONS AND DETAILS RELATIVE TO THE EXISTING FACILITIES HAVE BEEN TAKEN FROM EXISTING PLANS AND ARE SUBJECT TO CONSTRUCTION VARIATIONS. IT SHALL BE THE CONTRACTOR'S RESPONSIBILITY TO VERIFY SUCH DIMENSIONS AND DETAILS IN THE FIELD. SUCH VARIATIONS SHALL NOT BE A CAUSE FOR ADDITIONAL COMPENSATION DUE TO A CHANGE IN THE SCOPE OF THE WORK. HOWEVER, THE CONTRACTOR WILL BE PAID FOR THE QUANTITY ACTUALLY FURNISHED AT THE BID PRICE FOR THE WORK.
- THE LOCATION OF ANY NO PASSING ZONES WILL BE NOTED PRIOR TO RESURFACING AND REPLACED IN THE SAME LOCATIONS AFTER RESURFACING. COST TO BE INCLUDED IN THE RELATED PAVEMENT MARKING PAY ITEMS.
- ALL REFERENCES IN THE PLANS TO "BITUMINOUS" SHALL BE INTERPRETED TO MEAN "HOT-MIX ASPHALT"

INDEX OF SHEETS

- 1 COVER SHEET
- 2 GENERAL NOTES
- 3-5 SUMMARY OF QUANTITIES
- 6 RESURFACING SCHEDULE
- 7-8 ENTRANCE SCHEDULES
- 9-12 TYPICAL CROSS SECTIONS
- 13-20 ALIGNMENT SCHEMATICS
- 21 BUTT JOINT DETAILS
- 22-23 SIDEROAD, ENTRANCE AND MAILBOX TURNOUT DETAILS

LIST OF STANDARDS

- 000001-04 701001-01
- 280001-03 701006-02
- 442201-02 701011-01
- 542401 701201-02
- 602301-01 701301-02
- 604006-02 701306-01
- 606001-03 701326-02
- 606301-03 701311-02
- 630301-04 702001-06
- 635006-02 720001
- 635011-01 720006-01
- 728001
- 780001-01
- 781001-02

DISTRICT SIX	
EXAMINED <u>March 8</u>	<u>20 07</u>
<i>[Signature]</i>	
OPERATIONS ENGINEER	
EXAMINED <u>Mar 7</u>	<u>2007</u>
<i>[Signature]</i>	
PROGRAM IMPLEMENTATION ENGINEER	
EXAMINED <u>Mar 7</u>	<u>20 07</u>
<i>[Signature]</i>	
PROGRAM DEVELOPMENT ENGINEER	

THE FOLLOWING MIXTURE REQUIREMENTS ARE APPLICABLE TO THIS PROJECT:

MIXTURE USES:	HMA LEVEL BINDER	HMA SURF. CSE.	INCIDENTAL HMA SURF.	HMA SHLDS.
LOCATION	US 24	US 24	SIDEROADS & ENTRANCES	
AC/PG:	PG 64-22	PG 64-22	PG 64-22	PG 58-22
DESIGN AIR VOIDS:	4.0% @ N DESIGN=70	4.0% @ N DESIGN=70	4.0% @ N DESIGN=50	2.0% @ N DESIGN=30
MIXTURE COMPOSITION: (GRADATION MIXTURE)	IL 9.5	IL 9.5 OR 12.5	IL 95 or IL 12.5	IL 19.0
FRICTION AGGREGATE:	N/A	MIX C	MIX C	N/A

REVISIONS	
NAME	DATE

ILLINOIS DEPARTMENT OF TRANSPORTATION

GENERAL NOTES

FAP ROUTE 317 (U.S. 24)
SECTION (9, 10, 11) RS-3
SCHUYLER COUNTY

SCALE: _____ DRAWN BY: _____
DATE: _____ CHECKED BY: _____

F.A.P. RTE.	SECTION	COUNTY	TOTAL SHEETS	SHEET NO.
317	(9,10,11) RS-3	SCHUYLER	23	3
STA. 438+51		TO STA. 388+80		
FED. ROAD DIST. NO. 6 ILLINOIS FED. AID PROJECT				
CONTRACT 72838				

SUMMARY OF QUANTITIES				80% FEDERAL 20% STATE	
CODE NO	ITEM	UNIT	TOTAL	ROADWAY	
				1000	
20200600	EXCAVATING AND GRADING EXISTING SHOULDER	UNIT	198	198	
20400800	FURNISHED EXCAVATION	CUYD	40	40	
35800100	PREPARATION OF BASE	SOYD	719	719	
40200800	AGGREGATE SURFACE COURSE, TYPE B	TON	15	15	
40600200	BITUMINOUS MATERIALS (PRIME COAT)	TON	37	37	
40600300	AGGREGATE (PRIME COAT)	TON	187	187	
40600635	LEVELING BINDER (MACHINE METHOD), N70	TON	3,884	3,884	
40600895	CONSTRUCTING TEST STRIP	EACH	1	1	
40600982	HOT-MIX ASPHALT SURFACE REMOVAL - BUTT JOINT	SOYD	1,088	1,088	
40600990	TEMPORARY RAMP	SOYD	31	31	
40603315	HOT-MIX ASPHALT SURFACE COURSE, MIX "C", N70	TON	9,099	9,099	
40800050	INCIDENTAL HOT-MIX ASPHALT SURFACING	TON	326	326	
42300400	PORTLAND CEMENT CONCRETE DRIVEWAY PAVEMENT, 8 INCH	SOYD	172	172	
44000198	HOT-MIX ASPHALT SURFACE REMOVAL, VARIABLE DEPTH	SOYD	92,444	92,444	
44000200	DRIVEWAY PAVEMENT REMOVAL	SOYD	172	172	
44200144	PAVEMENT PATCHING, TYPE II, 12 INCH	SOYD	320	320	

Rev.

REVISIONS	
NAME	DATE

ILLINOIS DEPARTMENT OF TRANSPORTATION
SUMMARY OF QUANTITIES
 U. S. ROUTE 24
 F. A. P. ROUTE 317
 SECTION (9, 10, 11) RS-3
 SCHUYLER COUNTY

SCALE: DRAWN BY:
 DATE: CHECKED BY:

SUMMARY OF QUANTITIES				80% FEDERAL 20% STATE
CODE NO	ITEM	UNIT	TOTAL	ROADWAY
				1000
44200148	PAVEMENT PATCHING, TYPE III, 12 INCH	SQYD	140	140
48101200	AGGREGATE SHOULDERS, TYPE B	TON	3,953	3,953
48203021	HOT-MIX ASPHALT SHOULDERS, 6"	SQYD	2,201	2,201
*63000000	STEEL PLATE BEAM GUARD RAIL, TYPE A	FOOT	500	500
*63100167	TRAFFIC BARRIER TERMINAL TYPE 1, SPECIAL (TANGENT)	EACH	4	4
63200310	GUARDRAIL REMOVAL	FOOT	700	700
67000400	ENGINEER'S FIELD OFFICE, TYPE A	CAL MO	6	6
67100100	MOBILIZATION	L SUM	1	1
70100450	TRAFFIC CONTROL AND PROTECTION, STANDARD 701201	L SUM	1	1
70100460	TRAFFIC CONTROL AND PROTECTION, STANDARD 701306	L SUM	1	1
70100500	TRAFFIC CONTROL AND PROTECTION, STANDARD 701326	L SUM	1	1
70103815	TRAFFIC CONTROL SURVEILLANCE	CAL DA	5	5
70300100	SHORT-TERM PAVEMENT MARKING	FOOT	10,682	10,682
70300230	TEMPORARY PAVEMENT MARKING - LINE 5"	FOOT	86,698	86,698
70301000	WORK ZONE PAVEMENT MARKING REMOVAL	SQFT	1,187	1,187
*78001120	PAINT PAVEMENT MARKING - LINE 5"	FOOT	86,698	86,698

* SPECIALTY ITEMS

REVISIONS	
NAME	DATE

F.A.P. RTE.	SECTION	COUNTY	TOTAL SHEETS	SHEET NO.
317	(9,10,11) RS-3	SCHUYLER	23	5
STA. 438+51		TO STA. 388+80		
FED. ROAD DIST. NO. 6		ILLINOIS FED. AID PROJECT		

CONTRACT 72838

SUMMARY OF QUANTITIES				80% FEDERAL 20% STATE	
				ROADWAY	
CODE NO	ITEM	UNIT	TOTAL	1000	
* 78100100	RAISED REFLECTIVE PAVEMENT MARKER	EACH	445	445	
* 78200420	GUARDRAIL MARKERS, TYPE B	EACH	9	9	
* 78201000	TERMINAL MARKER - DIRECT APPLIED	EACH	4	4	
78300200	RAISED REFLECTIVE PAVEMENT MARKER REMOVAL	EACH	445	445	

* *SPECIALTY ITEMS*

REVISIONS	
NAME	DATE

ILLINOIS DEPARTMENT OF TRANSPORTATION
SUMMARY OF QUANTITIES
 U. S. ROUTE 24
 F. A. P. ROUTE 317
 SECTION (9, 10, 11) RS-3
 SCHUYLER COUNTY
 SCALE: _____ DRAWN BY: _____
 DATE: _____ CHECKED BY: _____

F.A. RTE.	SECTION	COUNTY	TOTAL SHEETS	SHEET NO.
317	(9,10,11) RS	SCHUYLER	23	6
STA.		TO STA.		
FED. ROAD DIST. NO.		ILLINOIS	FED. AID PROJECT	

PAVING SCHEDULE														
STATION	STATION	LENGTH	MILLED WIDTH	SURFACE PAVED WIDTH	HMA SURF REM BUTT JOINT	HMA SURF REM VAR. DEPTH	EXCAVATE & GRADING EXISTING SHLDR (1 FT)	HMA SHOULDERS, 6"	AGGREGATE SHOULDERS	LEVELING BINDER	HMA SURFACE CSE	AGG PRIME COAT	HMA PRIME COAT	TEMPORARY RAMPS
		FT	FT	FT	SOYD	SOYD	UNITS	SOYD	TON	TON	TON	TON	TON	SOYD
469+00	469+30	30	22	24	73		1	7	3	2	7	0.16	0.03	15
469+30	488+10	1880	22	24		4596	38	418	214	193	439	9.19	1.75	
488+10	506+00	1790	22	24.5		4376	18	199	102	184	418	8.75	1.66	
506+00	577+00	7100	22	24		17356	142	1578	809	729	1756	34.71	6.60	
577+00	581+60	460	24	28		1227			52	52	120	2.45	0.47	
581+60	584+50	290	23	27		741			33	31	73	1.48	0.28	
584+50	588+44 (BK)	394	24	28		1051			45	44	103	2.10	0.40	
150+38 (AH)	387+00	23662	24	28	80	63099			2695	2650	6184	126.20	23.98	16
TOTALS		35,606			153	92,444	198	2,201	3,953	3,884	9,099	185	35	31

* LT GUTTER FILLED IN 1.5 FT WIDE (SEE TYPICAL DETAIL)

GUARDRAIL SCHEDULE								
LT/RT	STATION	STATION	GUARDRAIL REMOVAL	STEEL PLATE BEAM GUARDRAIL, TY A	TRAF BAR TERM, TY 1 SPECIAL (TANGENT)	TERMINAL MARKER DIRECT APPLY	FURNISHED EXCAVATION	GUARDRAIL MARKERS
			FT	FT	EA	EA	CUYD	EA
LT	380+50	385+00	450	350	2	2	10	6
RT	381+00	383+50	250	150	2	2	10	3
TOTALS			700	500	4	4	20	9

PATCHING SCHEDULE		
	PAVT PATCHING TY 2, 12"	PAVT PATCHING TY 3, 12"
	SOYD	SOYD
TOTALS	320	140

PAVEMENT MARKING SCHEDULE							
STATION	STATION	LENGTH	SHORT-TERM PAVT MKG	WORK ZONE PAVT MKG REM	RAISED REFL PAVT MKR	RAISED REFL PAVT MKR REM	
		FT	FT	SOFT	EACH	EACH	
469+00	588+44 (BK)	11944	3583.2	398	149	149	
150+38 (AH)	387+00 (BK)	23662	7098.6	789	296	296	
TOTALS			10,682	1,187	445	445	

PAVEMENT MARKING FOR NO PASSING ZONES							
STATION	STATION	LENGTH	PAINT PAVT MKG LINE - 5" SKIP YELLOW	PAINT PAVT MKG LINE - 5" SOLID SINGLE YELLOW	PAINT PAVT MKG LINE - 5" SOLID DOUBLE YELLOW	PAINT PAVT MKG LINE - 5" SOLID WHITE	TEMP PAVT MKG LINE - 5"
		FT	FT	FT	FT	FT	FT
EDGE LINE							
469+00	588+44 (BK)	11944				23888	23888
150+38 (AH)	387+00	23662				47324	47324
SKIP DASH							
438+51	496+94	5843	1461				1461
509+87	588+44 (BK)	7857	1964				1964
150+38 (AH)	387+00	23662	5916				5916
NO PASSING ZONES							
486+41	496+94	1053		1053			1053
496+94	509+87	1293			2586		2586
509+87	520+19	1032		1032			1032
526+30	535+54	924		924			924
537+92	543+42	550		550			550
TOTALS			9,341	3,559	2,586	71,212	86,698
			PAINT TOTAL		86,698		

REVISIONS		ILLINOIS DEPARTMENT OF TRANSPORTATION	
NAME	DATE	SCHEDULES SCALE: VERT. _____ HORIZ. _____ DATE _____	
DRAWN BY _____		CHECKED BY _____	

PLOT DATE = 3/22/2007
 FILE NAME = M:\projects\8855803\pavement\82-82-2884\schedule.dgn
 PLOT SCALE = 1/8" = 1' IN.
 USER NAME = laughton

F.A. RTE.	SECTION	COUNTY	TOTAL SHEETS	SHEET NO.
317	(9,10,11) RS-3	SCHUYLER	23	7
STA. 438+51		TO STA. 388+80		
FED. ROAD DIST. NO.	ILLINOIS	FED. AID PROJECT		
CONTRACT 72838				

ENTRANCE IMPROVEMENT SCHEDULE FOR RURAL / URBAN "PPP" PROJECTS															
LOCATION	TYPE OF ENTRANCE	EX MATERIAL TYPE	WIDTH	RT OFFSET	LT OFFSET	LENGTH (FROM EDGE OF PVT/ BIT SHLD TO LIMITS OF IMPROVEMENT)	PR BIT. CONC. THICKNESS	BIT. SURF. REM. - BUTT JOINT	DRIVE WAY PAVEMENT REMOVAL	PREP OF BASE	PCC DRIVE WAY PAVEMENT 8"	AGGREGATE SURFACE COURSE TY - B	BIT (P. C.)	AGG (P. C.)	INCIDENTAL BIT. SURF.
(LT / RT) (STA) (+)	(FE / PE / CE / MB) (RURAL / URBAN)	(EARTH / AGG. / BIT. / P. C. C.)	FOOT	FOOT	FOOT	FOOT	INCH	SO. YD.	SO. YD.	SO. YD.	TON	TON	TON	TON	TON
LT 477+37	FE	GRASS	40			3									
RT 477+37	FE	GRASS	40			3									
RT 492+10	FE	GRASS	25			3									
LT 496+71	FE	GRASS	20			3									
RT 499+44	FE	GRASS	25			3									
RT 506+61	FE	GRASS	25			3									
LT 507+61	FE	GRASS	25			3									
LT 516+53	FE	GRASS	25			3									
RT 516+53	FE	DIRT	20			3									
LT 529+48	PE	AGG	48			7	3.5			37.3		1.4		0.07	7.3
RT 529+48	PE	AGG	23			7	3.5			17.9		0.5		0.04	3.5
RT 537+79	FE	GRASS	25			3									
RT 544+84	FE	GRASS	30			3									
RT 547+29	FE	GRASS	25			3									
RT 550+91	FE	GRASS	25			3									
LT 551+46	FE	GRASS	20			3									
RT 560+82	FE	GRASS	25			3									
LT 570+46	FE	GRASS	25			3									
RT 571+00	FE	GRASS	25			3									
RT 571+86.5	FE	GRASS	25			3									
RT 573+44	PE	AGG	53			7	3.5			41.2		1.5		0.08	8.1
RT 587+00	PE	AGG	28			7	3.5			21.8		0.7		0.04	4.3
LT 587+17	MB	BIT.	42			7	3.5	32.7					0.05		6.4
LT 151+25	CE	AGG.	60.2			9	8			60.2		1.8		0.1	27.0
LT 156+70	FE	AGG.	33			3									
RT 168+52	FE	GRASS	25			3									
LT 181+73.5	PE/MB	AGG.	71	26		7	3.5			55.2				0.1	10.8
RT 184+34	FE	AGG.	35			3									
LT 189+00	FE	GRASS	42			3									
LT 205+00	FE	GRASS	32			3									
RT 205+25	PE	AGG.	39			7	3.5	30.3						0.04	5.9
LT 205+76	MB	BIT.	42			7	3.5	32.7		32.7				0.06	6.4
RT 214+85	FE	GRASS	43			3									
RT 221+44	PE	AGG.	33			7	3.5			25.7		0.9			
LT 231+27	CE	P. C. C.	126			9	1.5		126		126		0.18		10.6
LT 234+16	MB	BIT.	42			7	3.5	32.7		32.7				0.06	6.4
LT 235+63	PE	AGG.	33			7	3.5			25.7		0.9		0.05	5.0
RT 237+78	FE	GRASS	39			3									
LT 242+61	FE	AGG.	41			3									
RT 242+75	FE	GRASS	42			3									
RT 251+38	PE	BIT.	40			7	3.5	31.1						0.04	6.1
LT 251+50	FE	BIT.	18			7	1.5	14						0.02	1.2
LT 251+95	MB	BIT.	38			7	3.5	29.6						0.04	5.8
LT 259+85	FE	GRASS	40			3									
RT 261+60	PE	BIT.	38			7	1.5	29.6						0.04	2.5

REVISIONS	
NAME	DATE

ILLINOIS DEPARTMENT OF TRANSPORTATION
DISTRICT SIX
SCHEDULES FOR RURAL / URBAN
ENTRANCE & MAILBOX TURNOUT
W / O CONCRETE GUTTER
(PPP - PROJECTS)

SCALE: NOT TO SCALE
DATE: OCT, 2003

DRAWN BY AGG
CHECKED BY MJS

DGN-SPEC
DATE-TIME
*REF:01

ENTRANCE IMPROVEMENT SCHEDULE FOR RURAL / URBAN "PPP" PROJECTS

LOCATION	TYPE OF ENTRANCE	EX MATERIAL TYPE	WIDTH	RT OFFSET	LT OFFSET	LENGTH (FROM EDGE OF PVT/ BIT SHLD TO LIMITS OF IMPROVEMENT)	PR BIT. CONC. THICKNESS	BIT. SURF. REM. - BUTT JOINT	DRIVE WAY PAVEMENT REMOVAL	PREP OF BASE	PCC DRIVE WAY PAVEMENT 8"	AGGREGATE SURFACE COURSE TY - B	BIT (P. C.)	AGG (P. C.)	INCIDENTAL BIT. SURF.
(LT / RT) (STA) (+)	(FE / PE / CE / MB) (RURAL / URBAN)	(EARTH / AGG. / BIT. / P. C. C.)	FOOT	FOOT	FOOT	FOOT	INCH	SQ. YD.	SQ. YD.	SQ. YD.	TON	TON	TON	TON	TON
ENTRANCES															
LT 262+10	MB	BIT.	38			7	3.5	29.6					0.04		5.8
RT 269+18	FE	AGG.	35			3									
LT 270+41.5	FE	GRASS	42			3									
RT 272+14	PE	AGG.	36			7	3.5			28		1.0			5.5
LT 273+44	PE/MB	AGG.	65	25		7	3.5			50.6				0.1	9.9
RT 275+29	FE	GRASS	35			3									
RT 275+81	FE	GRASS	35			3									
LT 283+54	PE	AGG.	38			7	3.5			29.6		1.0		0.06	5.8
RT 284+23	FE	GRASS	35			3									
LT 289+46	FE	GRASS	40			3									
RT 303+48	FE	AGG.	35			3									
LT 307+89	FE	AGG.	40			3									
RT 319+00	FE	AGG.	40			3									
LT 324+00	FE	GRASS	25			3									
LT 333+71	FE	GRASS	35			3									
RT 333+81	PE	AGG.	49			7	3.5					1.4		0.08	7.5
LT 334+19	MB	BIT.	42			7	3.5	32.7					0.05		6.4
RT 335+31	FE	AGG.	45			3									
RT 340+27	FE	GRASS	40			3									
LT 349+62.5	PE	AGG.	33			7	3.5			25.7		0.9		0.05	5.0
RT 353+58.5	FE	GRASS	40			3									
LT 353+62	FE	GRASS	38			3									
RT 376+65	FE	GRASS	41			3									
LT 379+47	CE	PCC	46			9	1.5		46		46				3.9
SIDE ROADS															
LT 521+67	SR	BIT.	91			9	1.5	91					0.13		7.6
RT 521+67	SR	BIT.	41			9	1.5	41					0.06		3.4
RT 573+80.48	SR	AGG.	51			9	8			51		0.5		0.05	22.8
LT 573+92.90	SR	BIT.	81			9	1.5	81					0.12		6.8
LT 162+39.10	SR	O/C	56			9	1.5	56					0.08		4.7
RT 188+84.77	SR	AGG.	51			9	8			51		0.5		0.05	22.8
LT 216+18	SR	BIT.	86			9	1.5	86					0.12		7.2
RT 231+38	SR	AGG.	71			9	8			71		0.7		0.07	31.8
LT 275+20.17	SR	O/C	76			9	1.5	76					0.11		6.4
RT 308+44	SR	BIT.	71			9	1.5	71					0.10		6.0
LT 339+84	SR	AGG.	61			9	8			61		0.6		0.06	27.3
RT 357+00	SR	BIT.	61			9	1.5	61					0.09		5.1
RT 384+60	SR	BIT.	76			9	1.5	76					0.11		6.4
TOTAL =															
								935	172	719	172	15	2	2	326

REVISIONS	
NAME	DATE

ILLINOIS DEPARTMENT OF TRANSPORTATION
DISTRICT SIX
SCHEDULES FOR RURAL / URBAN
ENTRANCE & MAILBOX TURNOUT
W / O CONCRETE GUTTER
(PPP - PROJECTS)

SCALE: NOT TO SCALE DRAWN BY: AGG
DATE: OCT, 2003 CHECKED BY: MJS

DDN=SPEC
DATE=TIME
*REF=01

F.A.P. RTE.	SECTION	COUNTY	TOTAL SHEETS	SHEET NO.
317	(9,10,11) RS-3	SCHUYLER	23	9
STA.	TO STA.			
FED. ROAD DIST. NO.	ILLINOIS FED. AID PROJECT			

CONTRACT 72838

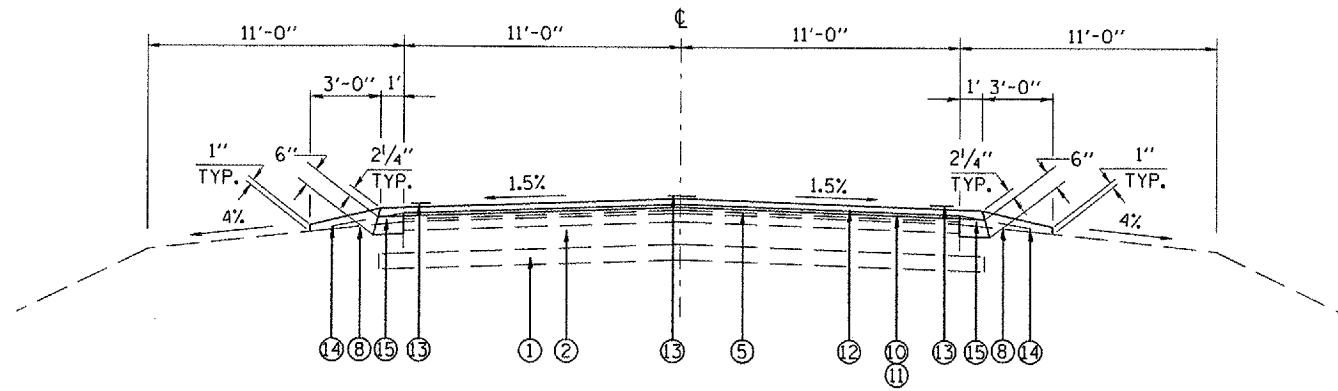

STA. 469+00 to 486+13.9
STA. 518+20.2 to 577+00

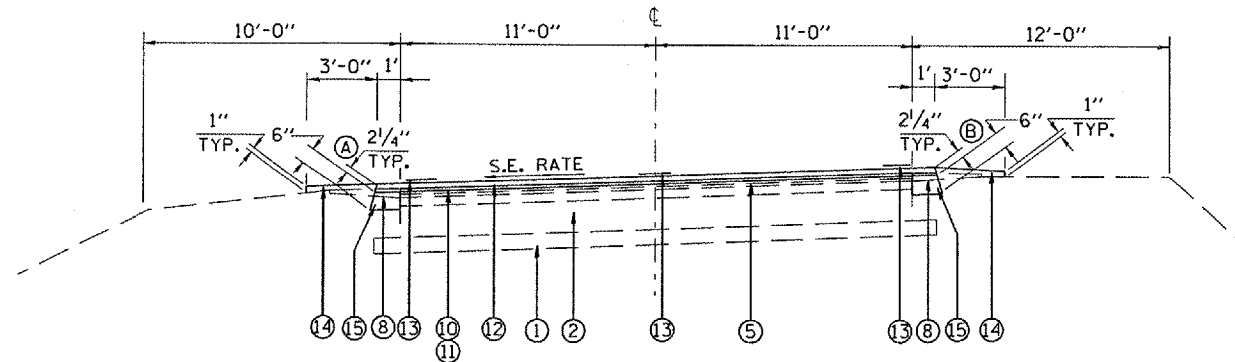

STA. 486+13.9 TO STA. 488+10 (S.E. 2 %)
STA. 506+00 TO 518+20.2 (S.E. 2 %)

- ① EXISTING AGGREGATE SUB-BASE 4"
- ② EXISTING P.C.C. BASE COURSE 8"
- ③ EXISTING P.C.C. PAVEMENT
- ④ EXISTING P.C.C. BASE COURSE WIDENING 9"
- ⑤ EXISTING HOT-MIX ASPHALT PAVEMENT 3" ±
- ⑥ EXISTING STRIP REFLECTIVE CRACK CONTROL SPECIAL
- ⑦ EXISTING BITUMINOUS SHOULDER 8"
- ⑧ EXISTING AGGREGATE SHOULDER TYPE A
- ⑨ EXISTING CONCRETE GUTTER
- ⑩ PROPOSED HOT-MIX ASPHALT SURFACE REMOVAL - VARIABLE DEPTH
- ⑪ PROPOSED HOT-MIX ASPHALT LEVELING BINDER, 3/4"
- ⑫ PROPOSED HOT-MIX ASPHALT SURFACE COURSE, 1 1/2"
- ⑬ PROPOSED PAVEMENT MARKING
- ⑭ PROPOSED AGGREGATE SHOULDER
- ⑮ PROPOSED HMA SHOULDER - 6"

NOTES FOR SHOULDER SLOPES:

- Ⓐ LOW SIDE OF SE: THE SHOULDER SLOPE SHALL BE THE SAME AS SE RATE BUT NOT LESS THAN 4.0%.
- Ⓑ HIGH SIDE OF SE: WHEN THE SE RATE OF THE PAVEMENT IS BETWEEN 0.0% AND 4.0% THE SHOULDER SHALL BE 4.0%. WHEN THE RATE OF THE PAVEMENT EXCEEDS 4.0% THE SHOULDER SHALL BE SLOPED SO THAT THE ALGEBRAIC DIFFERENCE BETWEEN PAVEMENT AND SHOULDER SLOPES WILL NOT BE GREATER THAN 8.0%.

REVISIONS		ILLINOIS DEPARTMENT OF TRANSPORTATION
NAME	DATE	
		TYPICAL SECTIONS F. A. P. ROUTE 317 (US 24) SECTION (9, 10, 11) RS-3 SCHUYLER COUNTY SCALE: NONE DATE: NOV, 2003
DRAWN BY AGG		CHECKED BY MJS

F.A.P. RTE.	SECTION	COUNTY	TOTAL SHEETS	SHEET NO.
317	(9,10,11) RS-3	SCHUYLER	23	10
STA.		TO STA.		
FED. ROAD DIST. NO.		ILLINOIS	FED. AID PROJECT	
CONTRACT 72838				

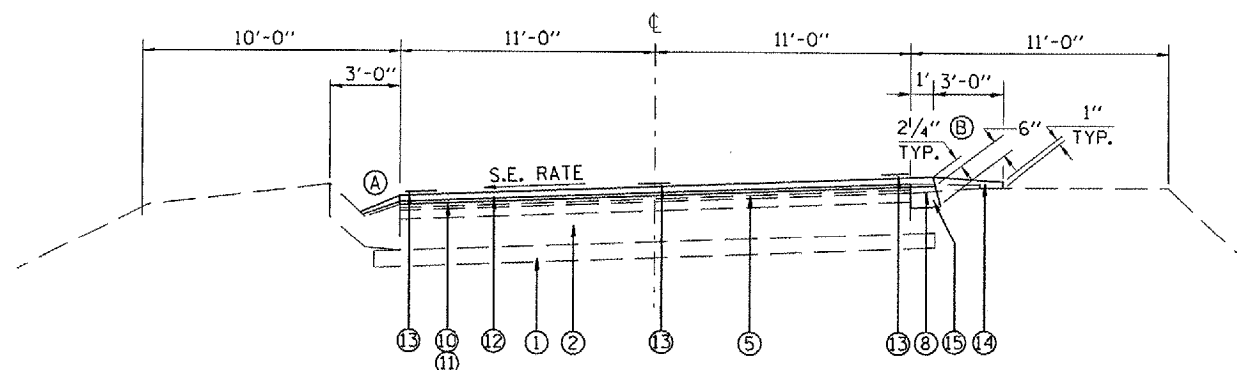

STA. 488+10 TO STA. 506+00

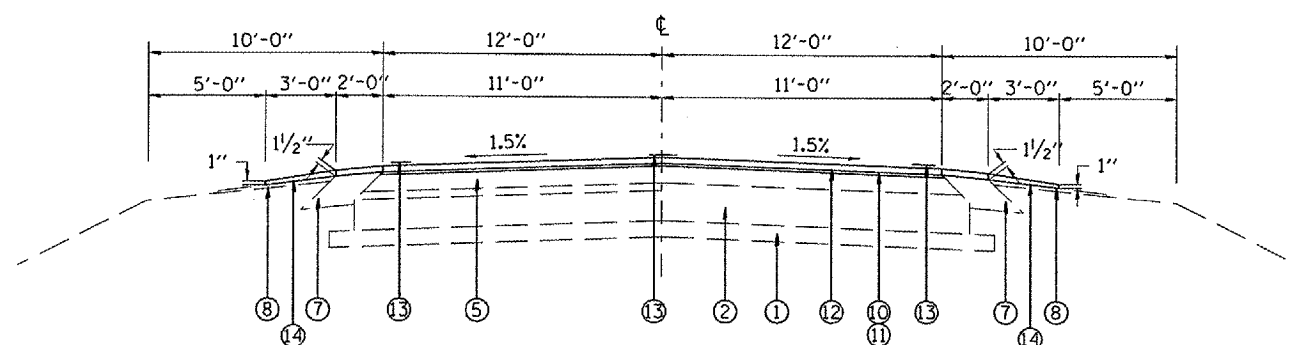
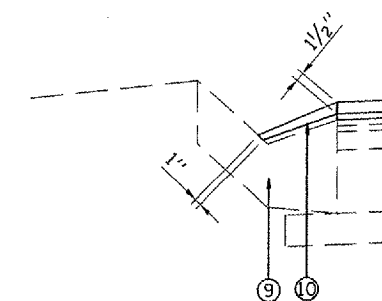

STA. 577+00 to 581+60
STA. 345+50 to 357+90.89

- ① EXISTING AGGREGATE SUB-BASE 4"
- ② EXISTING P.C.C. BASE COURSE 8"
- ③ EXISTING P.C.C PAVEMENT
- ④ EXISTING P.C.C. BASE COURSE WIDENING 9"
- ⑤ EXISTING HOT-MIX ASPHALT PAVEMENT 3" ±
- ⑥ EXISTING STRIP REFLECTIVE CRACK CONTROL SPECIAL
- ⑦ EXISTING BITUMINOUS SHOULDER 8"
- ⑧ EXISTING AGGREGATE SHOULDER TYPE A
- ⑨ EXISTING CONCRETE GUTTER
- ⑩ PROPOSED HOT-MIX ASPHALT SURFACE REMOVAL - VARIABLE DEPTH
- ⑪ PROPOSED HOT-MIX ASPHALT LEVELING BINDER, 3/4"
- ⑫ PROPOSED HOT-MIX ASPHALT SURFACE COURSE, 1/2"
- ⑬ PROPOSED PAVEMENT MARKING
- ⑭ PROPOSED AGGREGATE SHOULDER
- ⑮ PROPOSED HMA SHOULDER -6"

NOTES FOR SHOULDER SLOPES:

- (A) LOW SIDE OF SE: THE SHOULDER SLOPE SHALL BE THE SAME AS SE RATE BUT NOT LESS THAN 4.0%.
- (B) HIGH SIDE OF SE: WHEN THE SE RATE OF THE PAVEMENT IS BETWEEN 0.0% AND 4.0% THE SHOULDER SHALL BE 4.0%. WHEN THE RATE OF THE PAVEMENT EXCEEDS 4.0% THE SHOULDER SHALL BE SLOPED SO THAT THE ALGEBRAIC DIFFERENCE BETWEEN PAVEMENT AND SHOULDER SLOPES WILL NOT BE GREATER THAN 8.0%.

REVISIONS	
NAME	DATE

ILLINOIS DEPARTMENT OF TRANSPORTATION

TYPICAL SECTIONS
F. A. P. ROUTE 317 (US 24)
SECTION (9, 10, 11) RS-3
SCHUYLER COUNTY

SCALE: NONE
DATE: NOV, 2003

DRAWN BY AGG
CHECKED BY MJS

F.A.P. RTE.	SECTION	COUNTY	TOTAL SHEETS	SHEET NO.
317	(9,10,11) RS-3	SCHUYLER	23	11
STA.	TO STA.			
FED. ROAD DIST. NO.	ILLINOIS	FED. AID PROJECT		

CONTRACT 72838

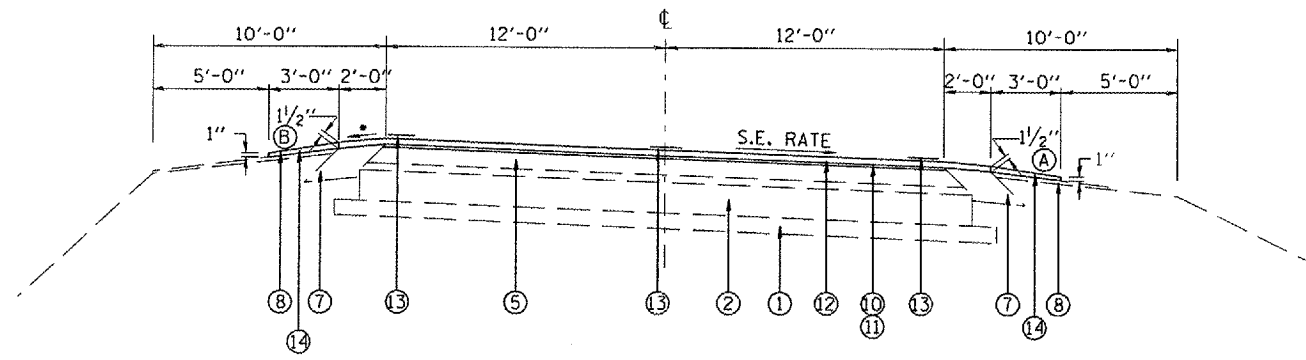

STA. 197+98.1 TO 229+78
STA. 357+90.89 TO 387+00

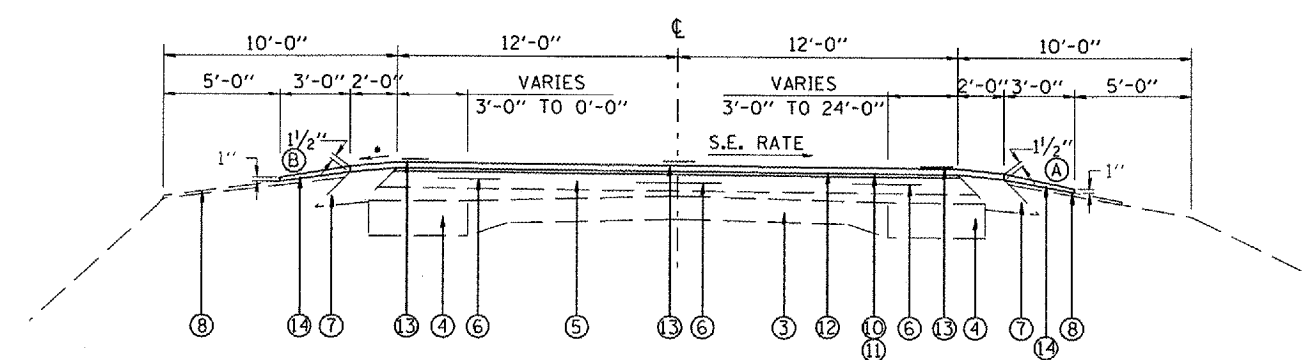

STA. 192+82.87 TO 197+98.1
STA. 229+78 TO 235+49.57
STA. 284+74.95 TO 292+07.11

- ① EXISTING AGGREGATE SUB-BASE 4"
- ② EXISTING P.C.C. BASE COURSE 8"
- ③ EXISTING P.C.C. PAVEMENT
- ④ EXISTING P.C.C. BASE COURSE WIDENING 9"
- ⑤ EXISTING HOT-MIX ASPHALT PAVEMENT 3" ±
- ⑥ EXISTING STRIP REFLECTIVE CRACK CONTROL SPECIAL
- ⑦ EXISTING BITUMINOUS SHOULDER 8"
- ⑧ EXISTING AGGREGATE SHOULDER TYPE A
- ⑨ EXISTING CONCRETE GUTTER
- ⑩ PROPOSED HOT-MIX ASPHALT SURFACE REMOVAL - VARIABLE DEPTH
- ⑪ PROPOSED HOT-MIX ASPHALT LEVELING BINDER, 3/4"
- ⑫ PROPOSED HOT-MIX ASPHALT SURFACE COURSE, 1 1/2"
- ⑬ PROPOSED PAVEMENT MARKING
- ⑭ PROPOSED AGGREGATE SHOULDER

NOTES FOR SHOULDER SLOPES:
 (A) LOW SIDE OF SE: THE SHOULDER SLOPE SHALL BE THE SAME AS SE RATE BUT NOT LESS THAN 4.0%.
 (B) HIGH SIDE OF SE: WHEN THE SE RATE OF THE PAVEMENT IS BETWEEN 0.0% AND 4.0% THE SHOULDER SHALL BE 4.0%. WHEN THE RATE OF THE PAVEMENT EXCEEDS 4.0% THE SHOULDER SHALL BE SLOPED SO THAT THE ALGEBRAIC DIFFERENCE BETWEEN PAVEMENT AND SHOULDER SLOPES WILL NOT BE GREATER THAN 8.0%.

REVISIONS		ILLINOIS DEPARTMENT OF TRANSPORTATION
NAME	DATE	
		TYPICAL SECTIONS F. A. P. ROUTE 317 (US 24) SECTION (9, 10, 11) RS-3 SCHUYLER COUNTY SCALE: NONE DATE: NOV, 2003
DRAWN BY AGG		CHECKED BY MJS

F.A.P. RTE.	SECTION	COUNTY	TOTAL SHEETS	SHEET NO.
317 (9,10,11)	RS-3	SCHUYLER	23	12
STA.	TO STA.			
FED. ROAD DIST. NO.	ILLINOIS FED. AID PROJECT			
CONTRACT 72838				

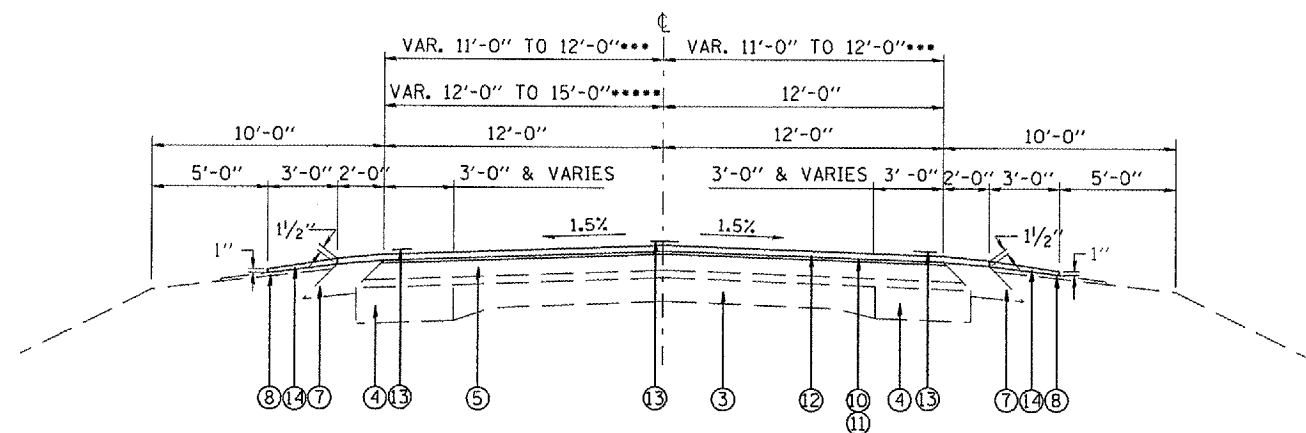

STA. 581+60 TO 584+50***
 STA. 584+50 TO 588+44.00 (BK)****
 STA. 150+38.00 AH TO 192+82.87
 STA. 235+49.57 TO 248+83.42
 STA. 259+16.76 TO 262+82.29
 STA. 275+24.53 TO 284+74.95
 STA. 292+07.11 TO 345+50

NOTES:

- *** PAVEMENT WIDTH OF MAINLINE TRANSITIONS FROM 22'-0" @ STA. 581+60 TO 24'-0" @ STA. 584+50
- **** STA. EQ 588+44.00 (BK) = 150+38.00 (AH)

- ① EXISTING AGGREGATE SUB-BASE 4"
- ② EXISTING P.C.C. BASE COURSE 8"
- ③ EXISTING P.C.C. PAVEMENT
- ④ EXISTING P.C.C. BASE COURSE WIDENING 9"
- ⑤ EXISTING HOT-MIX ASPHALT PAVEMENT 3" ±
- ⑥ EXISTING STRIP REFLECTIVE CRACK CONTROL SPECIAL
- ⑦ EXISTING BITUMINOUS SHOULDER 8"
- ⑧ EXISTING AGGREGATE SHOULDER TYPE A
- ⑨ EXISTING CONCRETE GUTTER
- ⑩ PROPOSED HOT-MIX ASPHALT SURFACE REMOVAL - VARIABLE DEPTH
- ⑪ PROPOSED HOT-MIX ASPHALT LEVELING BINDER, 3/4"
- ⑫ PROPOSED HOT-MIX ASPHALT SURFACE COURSE, 1 1/2"
- ⑬ PROPOSED PAVEMENT MARKING
- ⑭ PROPOSED AGGREGATE SHOULDER

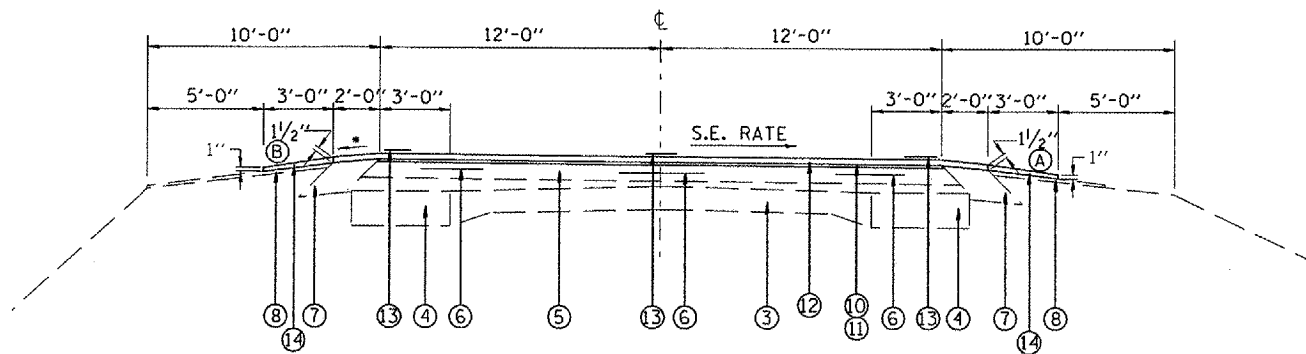

STA. 248+83.42 TO 259+16.76
 STA. 262+82.29 TO 275+24.53

NOTES FOR SHOULDER SLOPES:

- Ⓐ LOW SIDE OF SE: THE SHOULDER SLOPE SHALL BE THE SAME AS SE RATE BUT NOT LESS THAN 4.0%.
- Ⓑ HIGH SIDE OF SE: WHEN THE SE RATE OF THE PAVEMENT IS BETWEEN 0.0% AND 4.0% THE SHOULDER SHALL BE 4.0%. WHEN THE RATE OF THE PAVEMENT EXCEEDS 4.0% THE SHOULDER SHALL BE SLOPED SO THAT THE ALGEBRAIC DIFFERENCE BETWEEN PAVEMENT AND SHOULDER SLOPES WILL NOT BE GREATER THAN 8.0%.

REVISIONS		ILLINOIS DEPARTMENT OF TRANSPORTATION
NAME	DATE	
		TYPICAL SECTIONS F. A. P. ROUTE 317 (US 24) SECTION (9, 10, 11) RS-3 SCHUYLER COUNTY SCALE: NONE DATE: NOV, 2003
DRAWN BY AGG		CHECKED BY MJS

F.A.P. RTE.	SECTION	COUNTY	TOTAL SHEETS	SHEET NO.
317	(9,10,11) RS-3	SCHUYLER	23	13
STA. 438+51		TO STA. 490+00		
FED. ROAD DIST. NO.	ILLINOIS	FED. AID PROJECT		

CONTRACT 72838

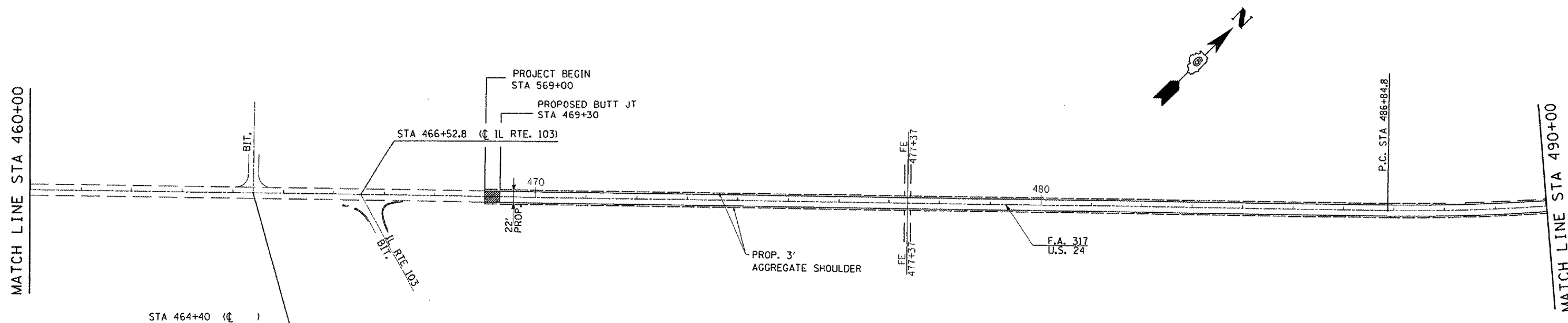
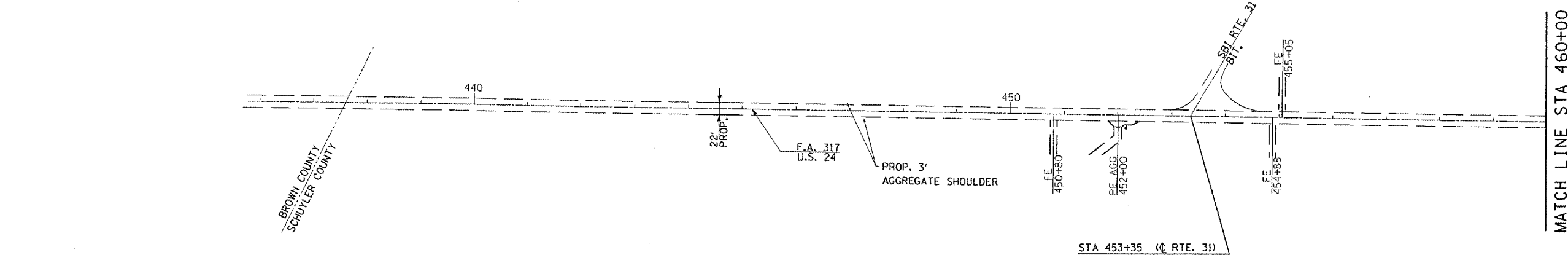

NOTE:
END EDGELINE PAVEMENT MARKING THROUGH SIDE ROADS

REVISIONS	
NAME	DATE

ILLINOIS DEPARTMENT OF TRANSPORTATION
ALIGNMENT SCHEMATIC
F. A. P. ROUTE 317 (U. S. 24)
SECTION (9, 10, 11) RS-3
SCHUYLER COUNTY
SCALE: NOT TO SCALE
DATE: OCT, 2003
DRAWN BY: AGG
CHECKED BY: MJS

F.A.P. RTE.	SECTION	COUNTY	TOTAL SHEETS	SHEET NO.
317	(9,10,11) RS-3	SCHUYLER	23	14
STA. 490+00		TO STA. 550+00		
FED. ROAD DIST. NO.	ILLINOIS	FED. AID PROJECT		

CONTRACT 72838

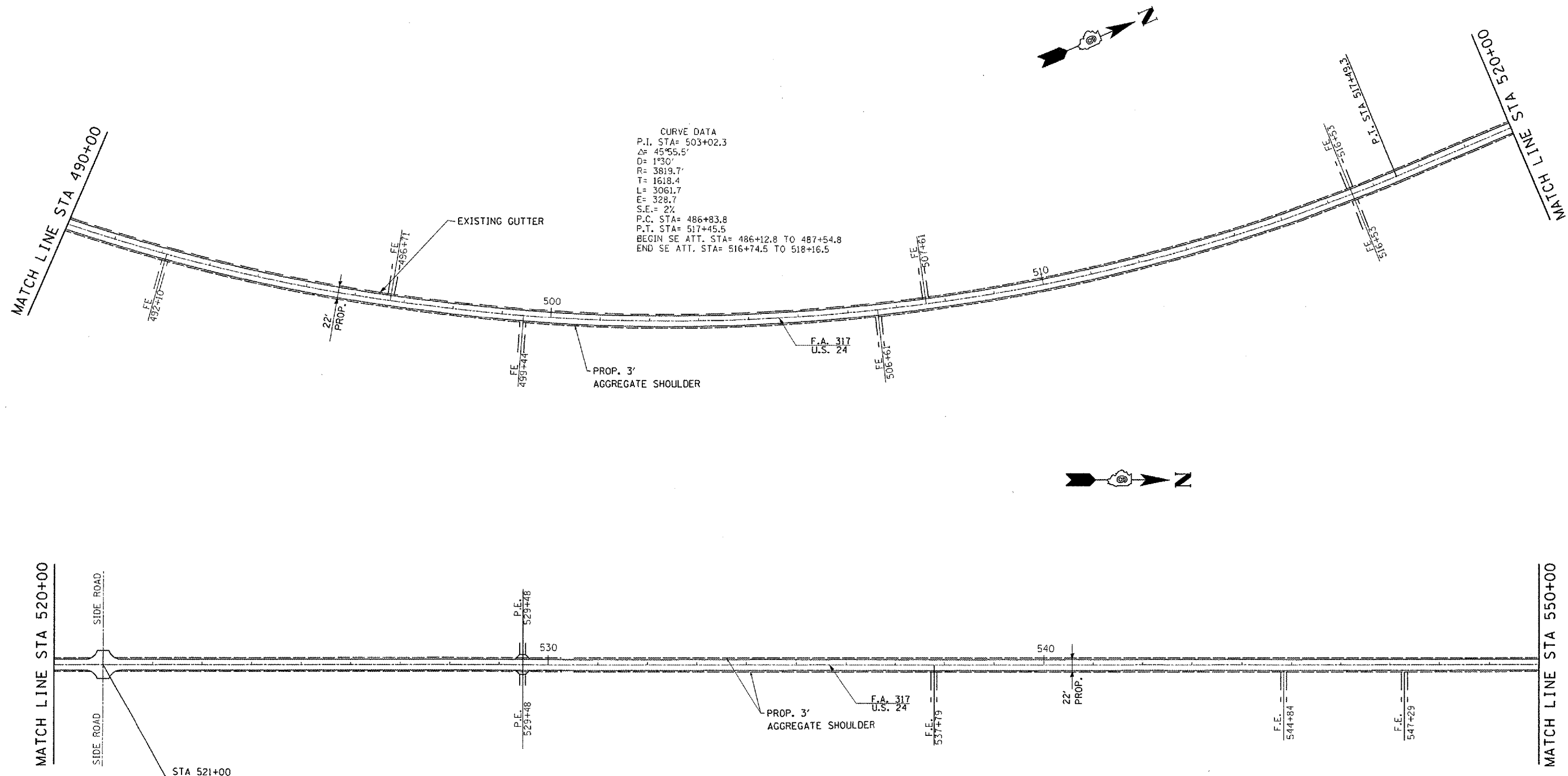

NOTE:
END EDGELINE PAVEMENT MARKING THROUGH SIDE ROADS

REVISIONS	
NAME	DATE

ILLINOIS DEPARTMENT OF TRANSPORTATION
ALIGNMENT SCHEMATIC
F. A. P. ROUTE 317 (U. S. 24)
SECTION (9, 10, 11) RS-3
SCHUYLER COUNTY
SCALE: NOT TO SCALE
DATE: OCT, 2003
DRAWN BY: AGG
CHECKED BY: MJS

F.A.P. RTE.	SECTION	COUNTY	TOTAL SHEETS	SHEET NO.
317	(9,10,11) RS-3	SCHUYLER	23	15
STA. 550+00		TO STA. 170+00		
FED. ROAD DIST. NO.		ILLINOIS	FED. AID PROJECT	
CONTRACT 72838				

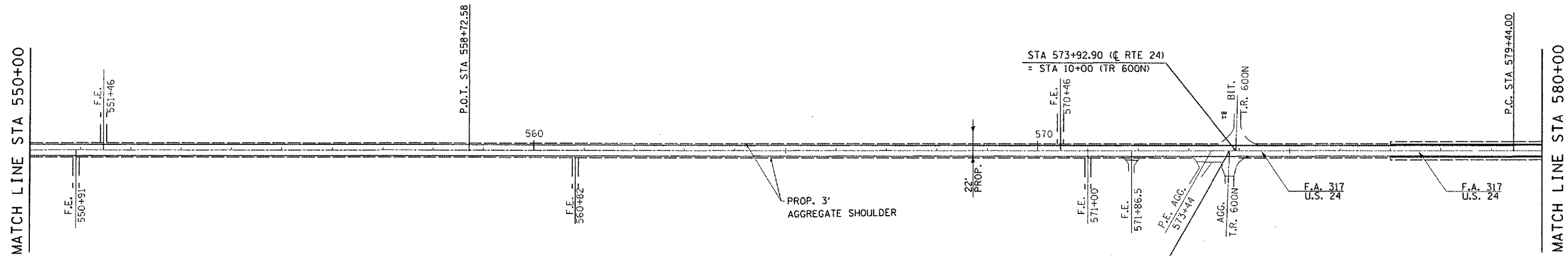

CURVE DATA
P.I. STA= 583+94
 Δ = 0°-25'-39.5"
D= 0°-02'-51"
R= 120583.5
T= 450.00
L= 900
E= 0.84
S.E.= NO S.E.
P.C. STA= 579+44.00
P.T. STA= 588+44.00 BK
P.T. STA= 150+38.00 AH

CURVE DATA
P.I. STA= 166+84.10
 Δ = 0°-16'-41.5"
D= 0°-02'-0.00"
R= 171887.40
T= 417.23
L= 834.58
E= 0.51
S.E.= N.C.
P.C. STA= 162+66.81
P.T. STA= 171+01.39

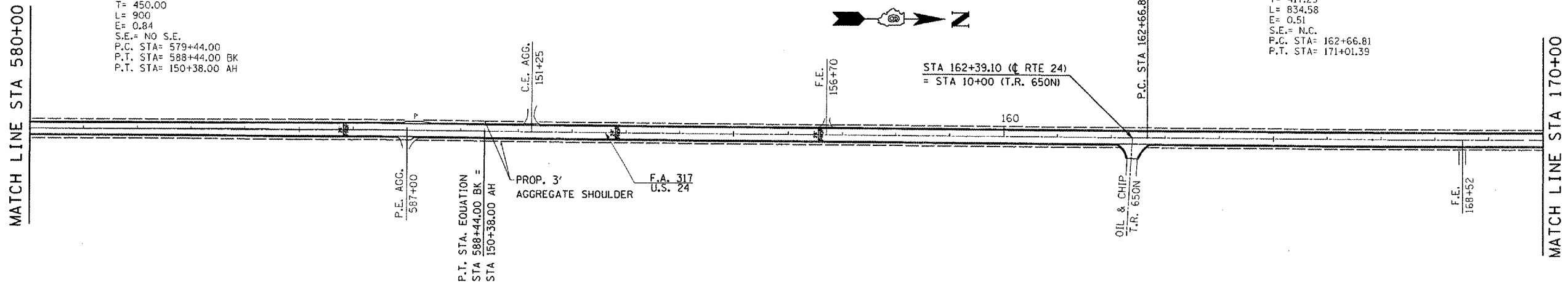

NOTE:
END EDGELINE PAVEMENT MARKING THROUGH SIDE ROADS

REVISIONS	
NAME	DATE

ILLINOIS DEPARTMENT OF TRANSPORTATION
ALIGNMENT SCHEMATIC
F. A. P. ROUTE 317 (U. S. 24)
SECTION (9, 10, 11) RS-3
SCHUYLER COUNTY
SCALE: NOT TO SCALE
DATE: OCT, 2003
DRAWN BY AGG
CHECKED BY MJS

F.A.P. RTE.	SECTION	COUNTY	TOTAL SHEETS	SHEET NO.
317	(9,10,11) RS-3	SCHUYLER	23	16
STA. 170+00		TO STA. 220+00		
FED. ROAD DIST. NO.		ILLINOIS FED. AID PROJECT		
CONTRACT 72838				

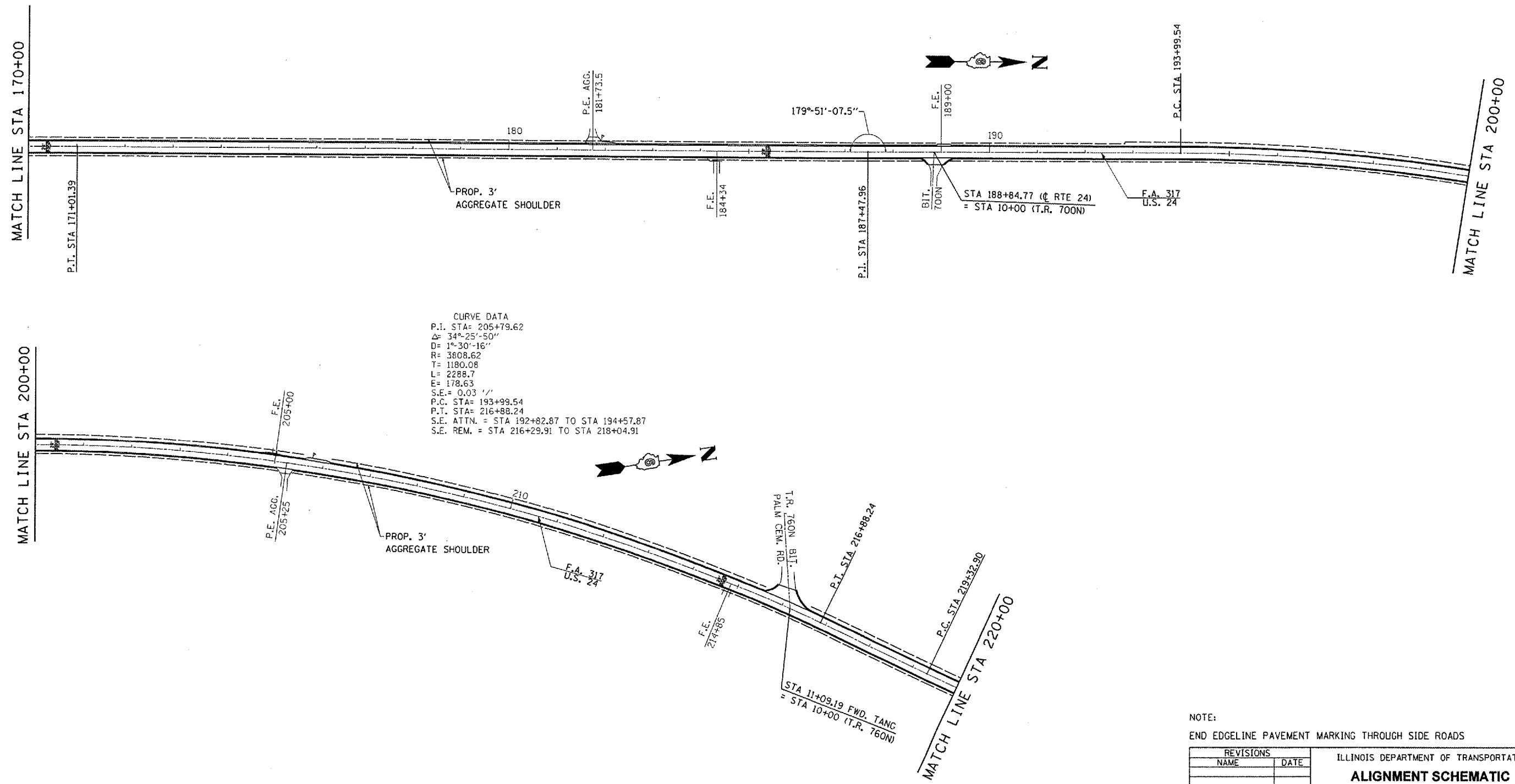

CURVE DATA
 P.I. STA= 205+79.62
 $\Delta = 34^{\circ}25'50''$
 $D = 1^{\circ}30'16''$
 $R = 3808.62$
 $T = 1180.08$
 $L = 2288.7$
 $E = 178.63$
 $S.E. = 0.03 \text{ \%/}$
 P.C. STA= 193+99.54
 P.T. STA= 216+88.24
 S.E. ATTN. = STA 192+82.87 TO STA 194+57.87
 S.E. REM. = STA 216+29.91 TO STA 218+04.91

NOTE:
 END EDGELINE PAVEMENT MARKING THROUGH SIDE ROADS

REVISIONS	
NAME	DATE

ILLINOIS DEPARTMENT OF TRANSPORTATION
ALIGNMENT SCHEMATIC
 F. A. P. ROUTE 317 (U. S. 24)
 SECTION (9, 10, 11) RS-3
 SCHUYLER COUNTY

SCALE: NOT TO SCALE
 DATE: OCT, 2003

DRAWN BY: AGG
 CHECKED BY: MJS

F.A.P. RTE.	SECTION	COUNTY	TOTAL SHEETS	SHEET NO.
317	(9,10,11) RS-3	SCHUYLER	23	17
STA. 220+00		TO STA. 270+00		
FED. ROAD DIST. NO.	ILLINOIS FED. AID PROJECT			
CONTRACT 72838				

CURVE DATA
P.I. STA= 226+87.24
 Δ = 15°-02'-45"
D= 1°-00'-11"
R= 5712.12
T= 754.34
L= 1500
E= 49.59
S.E.= 0.021 '/'
P.C. STA= 219+32.90
P.T. STA= 234+32.90
S.E. ATTN. = STA 218+16.23 TO 219+91.23
S.E. REM. = STA 233+74.57 TO 235+49.57

CURVE DATA
P.I. STA= 254+00.74
 Δ = 7°-58'-41.5"
D= 0°-59'-50"
R= 5745.24
T= 400.65
L= 800
E= 13.95
S.E.= 0.021 '/'
P.C. STA= 250+00.09
P.T. STA= 258+00.09
S.E. ATTN. = STA 248+83.42 TO 250+58.42
S.E. REM. = STA 257+41.76 TO 259+16.76

CURVE DATA
P.I. STA= 269+06.36
 Δ = 15°-07'-16.5"
D= 1°-29'-56"
R= 3822.81
T= 507.40
L= 1008.9
E= 33.53
S.E.= 0.03 '/'
P.C. STA= 263+98.96
P.T. STA= 274.07.86
S.E. ATTN. = STA 262+82.29 TO 264+57.29
S.E. REM. = STA 273+49.53 TO 275+24.53

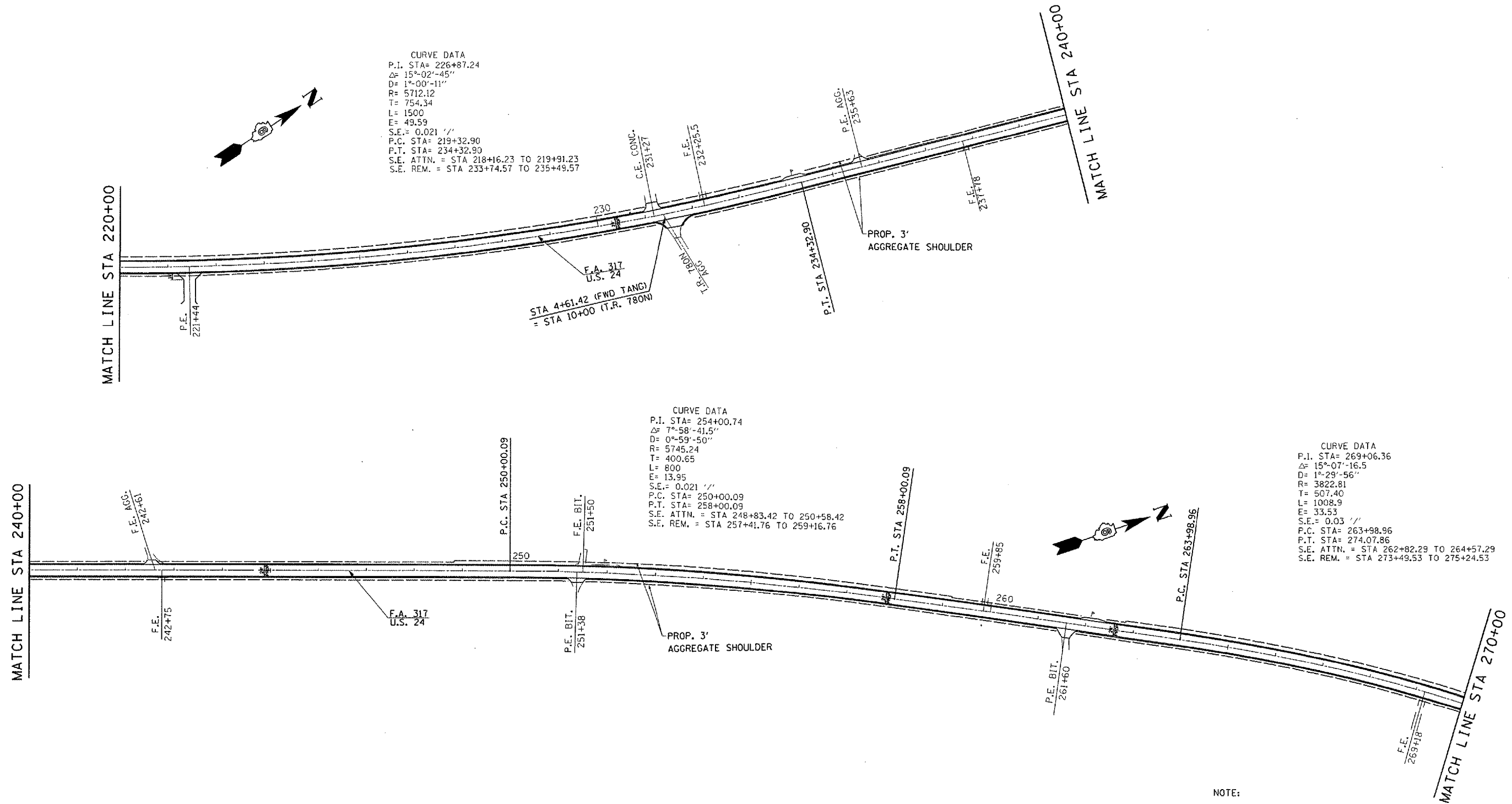

NOTE:
END EDGELINE PAVEMENT MARKING THROUGH SIDE ROADS

REVISIONS	
NAME	DATE

ILLINOIS DEPARTMENT OF TRANSPORTATION
ALIGNMENT SCHEMATIC
F. A. P. ROUTE 317 (U. S. 24)
SECTION (9, 10, 11) RS-3
SCHUYLER COUNTY
SCALE: NOT TO SCALE
DATE: OCT, 2003
DRAWN BY: AGG
CHECKED BY: MJS

F.A.P. RTE.	SECTION	COUNTY	TOTAL SHEETS	SHEET NO.
317	(9,10,11) RS-3	SCHUYLER	23	18
STA. 270+00		TO STA. 330+00		
FED. ROAD DIST. NO.		ILLINOIS FED. AID PROJECT		
CONTRACT 72838				

CURVE DATA
P.I. STA= 288+41.34
 Δ = 7°-00'-26"
D= 1°-24'-17"
R= 4078.69
T= 249.72
L= 498.82
E= 7.64
S.E.= 0.03 //
P.C. STA= 285+91.62
P.T. STA= 290+90.44
S.E. ATTN. = STA 284+74.95 TO 286+49.95
S.E. REM. = STA 290+32.11 TO 292+07.11

CURVE DATA
P.I. STA= 317+51.80
 Δ = 3°-28'-32"
D= 0°-30'-05"
R= 11429.30
T= 346.76
L= 693.3
E= 5.26
S.E.= N.C.
P.C. STA= 314+05.04
P.T. STA= 320+98.34

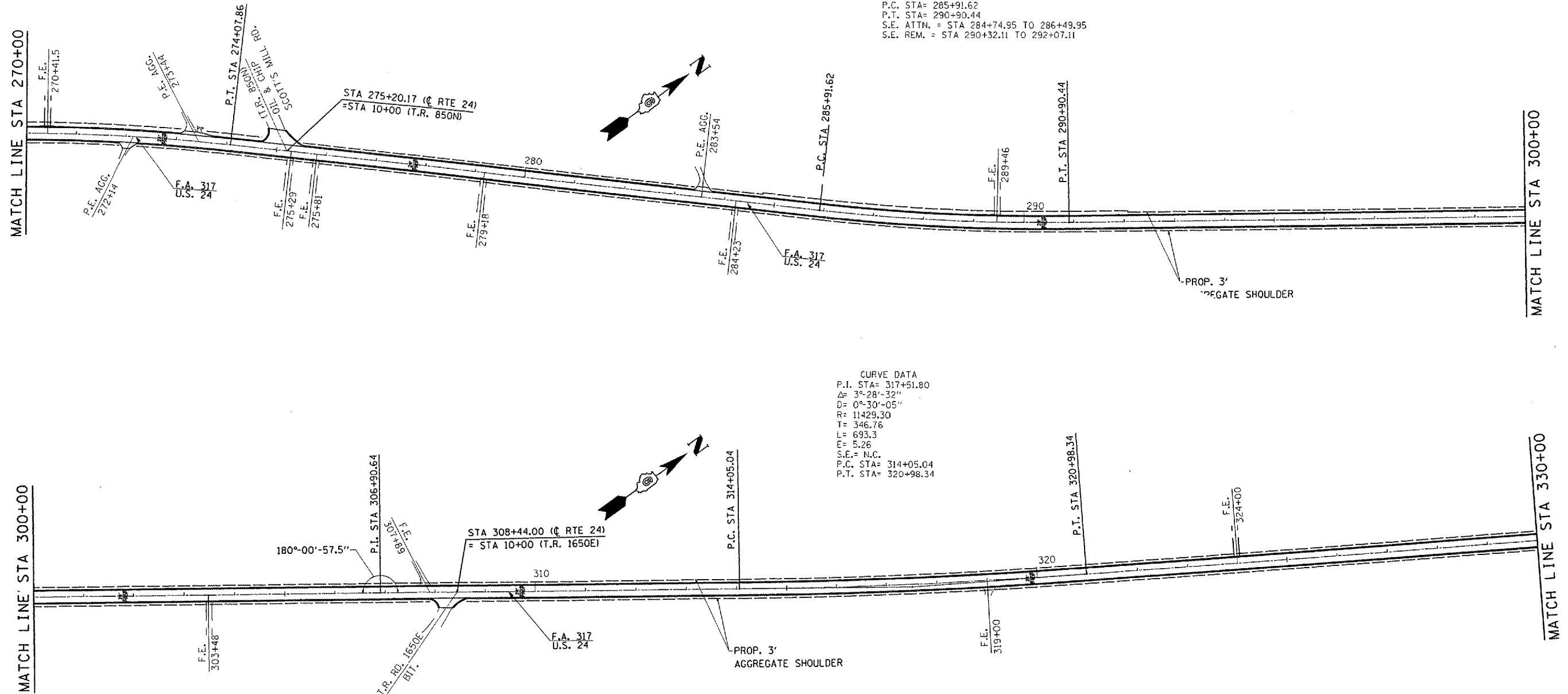

NOTE:
END EDGELINE PAVEMENT MARKING THROUGH SIDE ROADS

REVISIONS	
NAME	DATE

ILLINOIS DEPARTMENT OF TRANSPORTATION
ALIGNMENT SCHEMATIC
F. A. P. ROUTE 317 (U. S. 24)
SECTION (9, 10, 11) RS-3
SCHUYLER COUNTY
SCALE: NOT TO SCALE
DATE: OCT, 2003
DRAWN BY: AGG
CHECKED BY: MJS

F.A.P. RTE.	SECTION	COUNTY	TOTAL SHEETS	SHEET NO.
317	(9,10,11) RS-3	SCHUYLER	23	19
STA. 330+00		TO STA. 380+00		
FED. ROAD DIST. NO.		ILLINOIS FED. AID PROJECT		
CONTRACT 72838				

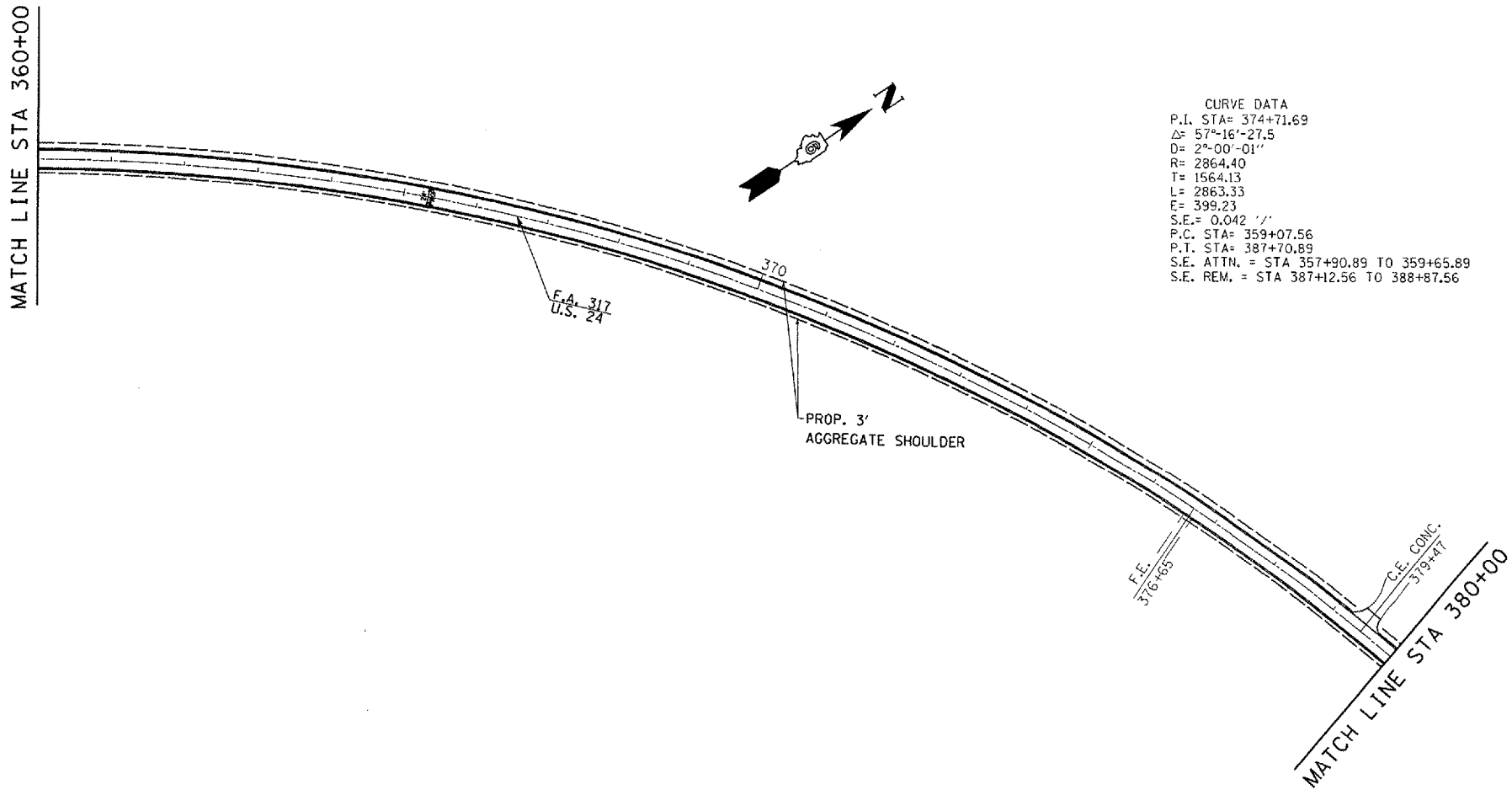
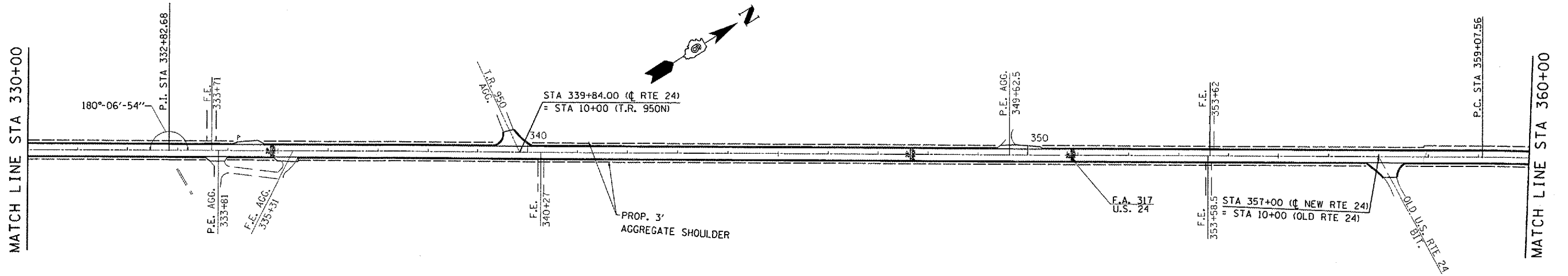

CURVE DATA
P.I. STA= 374+71.69
Δ= 57°-16'-27.5
D= 2°-00'-01"
R= 2864.40
T= 1564.13
L= 2863.33
E= 399.23
S.E.= 0.042 %
P.C. STA= 359+07.56
P.T. STA= 387+70.89
S.E. ATTN. = STA 357+90.89 TO 359+65.89
S.E. REM. = STA 387+12.56 TO 388+87.56

NOTE:
END EDGELINE PAVEMENT MARKING THROUGH SIDE ROADS

REVISIONS	
NAME	DATE

ILLINOIS DEPARTMENT OF TRANSPORTATION
ALIGNMENT SCHEMATIC
F.A.P. ROUTE 317 (U.S. 24)
SECTION (9, 10, 11) RS-3
SCHUYLER COUNTY
SCALE: NOT TO SCALE
DATE: OCT, 2003
DRAWN BY: AGG
CHECKED BY: MJS

F.A.P. RTE.	SECTION	COUNTY	TOTAL SHEETS	SHEET NO.
317	(9,10,11)RS-3	SCHUYLER	23	20
STA. 380+00		TO STA. 389+00		
FED. ROAD DIST. NO.	ILLINOIS	FED. AID PROJECT		

CONTRACT 72838

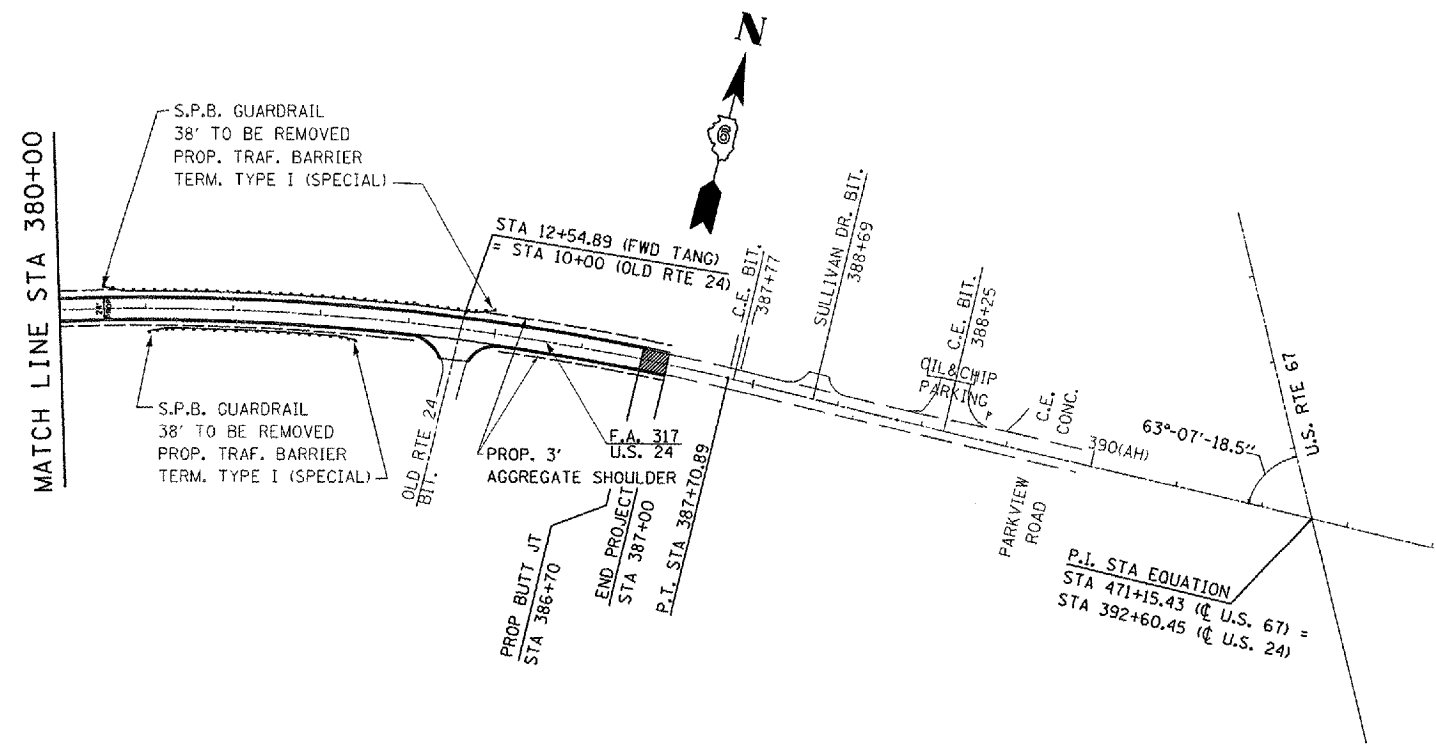

NOTE:
END EDGELINE PAVEMENT MARKING THROUGH SIDE ROADS

REVISIONS	
NAME	DATE

ILLINOIS DEPARTMENT OF TRANSPORTATION
ALIGNMENT SCHEMATIC
F. A. P. ROUTE 317 (U. S. 24)
SECTION (9, 10, 11) RS-3
SCHUYLER COUNTY

SCALE: NOT TO SCALE
DATE: OCT. 2003

DRAWN BY: AGC
CHECKED BY: MJS

F.A.P. RTE.	SECTION	COUNTY	TOTAL SHEETS	SHEET NO.
317	11RS-3	SCHUYLER	23	21
STA.		TO STA.		
FED. ROAD DIST. NO.		ILLINOIS FED. AID PROJECT		

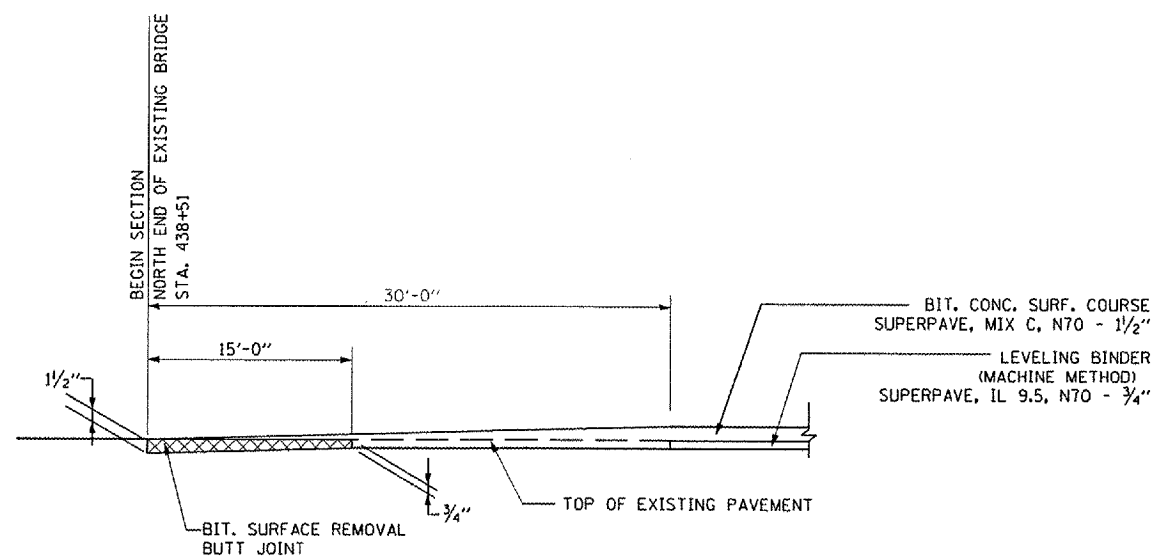

TYPICAL TAPER DETAIL
(AT BRIDGE)

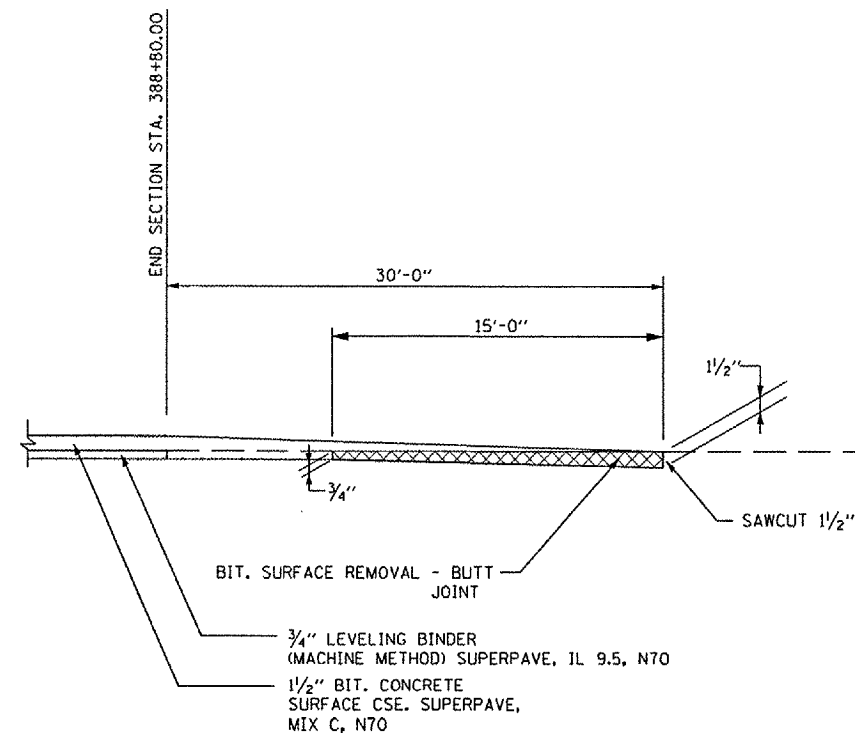

TYPICAL TAPER DETAIL
(AT LIMITS OF PROJECT AND PROJECT OMISSIONS)

THE UPCHURCH GROUP
HILLSIDE, IL. (708) 449-2321
MATTOON, IL. (217) 235-8177

D654601-TYPICALS.DGN

REVISIONS	
NAME	DATE

ILLINOIS DEPARTMENT OF TRANSPORTATION
BUTT JOINT AND TAPER DETAILS
FA. ROUTE 317 (U. S. 24)
SECTION 11RS-3
SCHUYLER COUNTY

SCALE: NOT TO SCALE
DATE OCT, 2003
DRAWN BY AGG
CHECKED BY MJS

F.A.P. RTE.	SECTION	COUNTY	TOTAL SHEETS	SHEET NO.
317	(9,10,11) RS-3	SCHUYLER	23	22
STA. 438+51		TO STA. 388+80 (AH)		
FED. ROAD DIST. NO. 6		ILLINOIS FED. AID PROJECT		

CONTRACT 72838

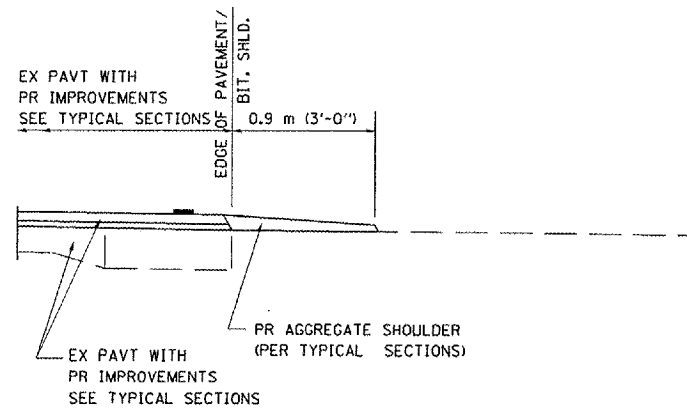

SECTION A-A FOR EX EARTH/AGGREGATE FE

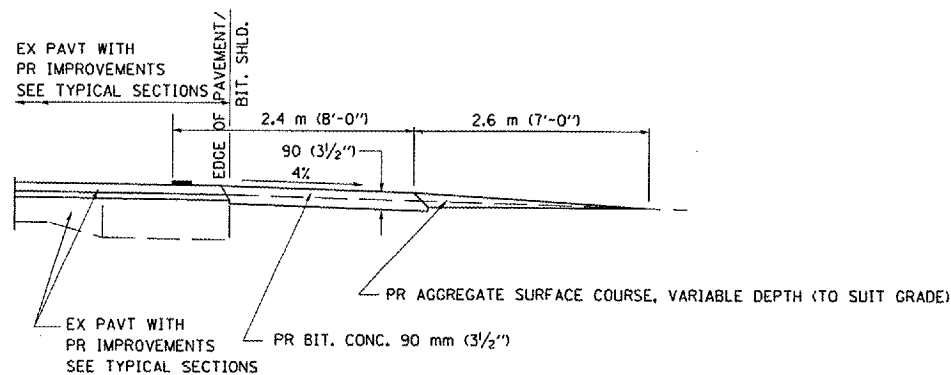

SECTION A-A FOR EX EARTH/AGGREGATE PE

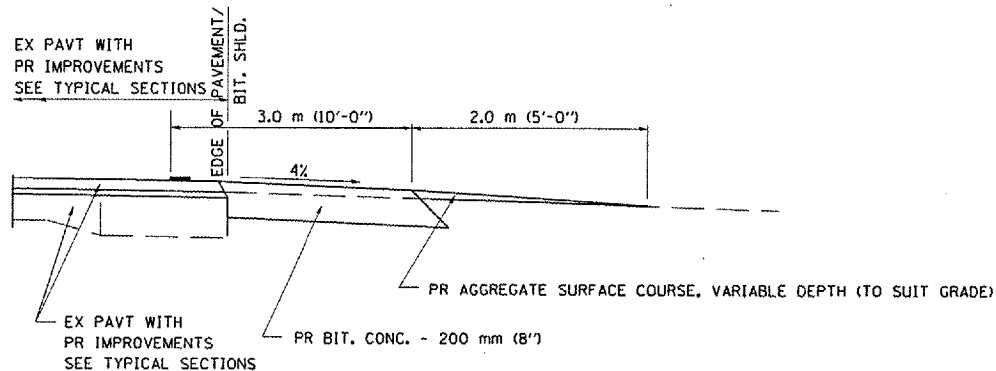

SECTION A-A FOR EX EARTH/AGGREGATE CE & SIDE ROAD

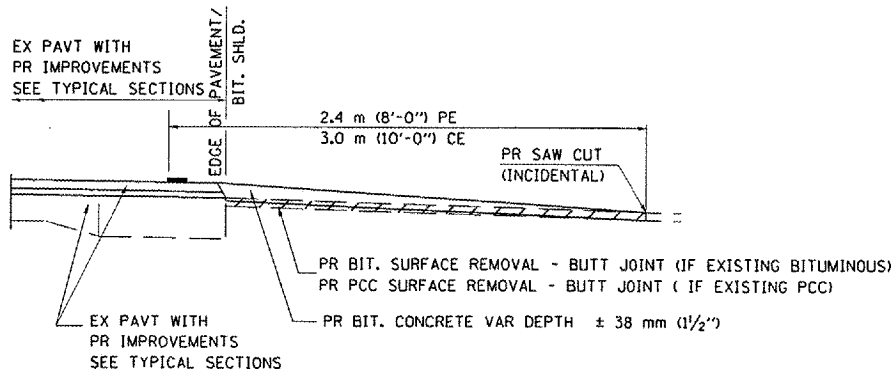

SECTION A-A FOR EX BITUMINOUS/PC CONCRETE PE, CE & SIDE ROAD

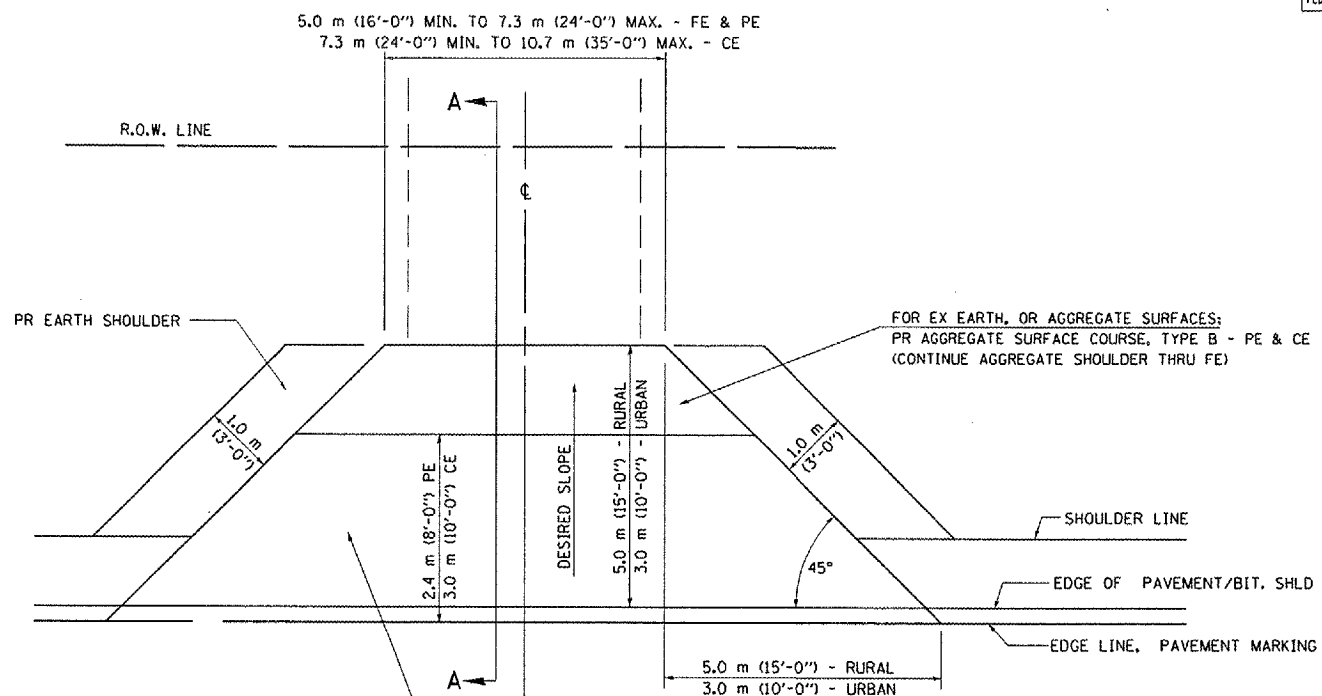

FOR EX EARTH OR AGGREGATE SURFACES:
 PR BIT SURFACE REMOVAL (IF APPLICABLE)
 PR AGGREGATE SHOULDER THRU - FE
 PR BITUMINOUS CONCRETE 90 mm (3 1/2") - PE
 PR BITUMINOUS CONCRETE 200mm (8") - CE

FOR EX BITUMINOUS CONCRETE SURFACES:
 PR BITUMINOUS SURFACE REMOVAL-BUTT JOINT

FOR EX PCC SURFACES:
 PR PCC SURFACE REMOVAL-BUTT JOINT

GENERAL NOTES:

THE RESIDENT ENGINEER WILL DETERMINE THE EXACT TYPE OF IMPROVEMENT TO BE COMPLETED FOR ALL ENTRANCES, SIDEROADS AND MAILBOX TURNOUTS ON THIS PROJECT.

THE PLAN DETAILS AND SCHEDULES SHOULD BE USED AS A GUIDE FOR THE ENGINEER TO IMPLEMENT THE FINAL DESIGN. THE ENGINEER MAY DECIDE TO SALVAGE PORTIONS OF THE EXISTING ENTRANCE PAVEMENT STRUCTURE; THEREFORE, REDUCING PAY ITEM QUANTITIES. NO ADDITIONAL PAYMENT WILL BE ALLOWED FOR THIS REDUCTION IN QUANTITIES.

ANY WORK THE ENGINEER REQUIRES WHICH IS NOT COVERED BY A PAY ITEM CONTAINED IN THE PLANS WILL BE PAID FOR IN ACCORDANCE WITH ARTICLE 109.04 OF THE STANDARD SPECIFICATIONS.

BITUMINOUS CONCRETE REQUIRED TO CONSTRUCT THE ENTRANCES SHALL BE IN ACCORDANCE WITH THE APPLICABLE PORTIONS OF SECTION 406 AND 408 OF THE STANDARD SPECIFICATIONS AND AS DIRECTED BY THE ENGINEER.

WHEN THE BITUMINOUS CONCRETE PROPOSED FOR THE IMPROVEMENT IS THICKER THAN 75 mm (3 INCHES) AND REQUIRE PLACEMENT IN MORE THAN ONE LIFT. THE BOTTOM LIFT(S) SHALL MEET THE REQUIREMENTS OF BITUMINOUS BASE COURSE IN SECTION 406 OF THE STANDARD SPECIFICATIONS AND THE TOP LIFT OF 50 mm (2 INCHES) SHALL MEET THE REQUIREMENTS OF BITUMINOUS CONCRETE SURFACE COURSE, SUPERPAVE.

THIS WORK WILL BE PAID FOR IN ACCORDANCE WITH SECTIONS 351, 358, 408, 423 AND 440 OF THE STANDARD SPECIFICATIONS.

ALL DIMENSIONS ARE IN MILLIMETERS (INCHES) UNLESS OTHERWISE SHOWN.

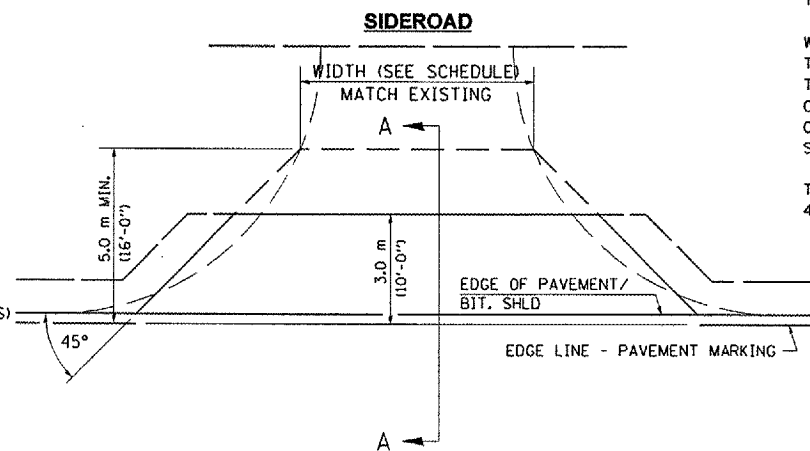

NOTE: IF BIT. SHLDS ARE PROPOSED THEY SHOULD NOT EXTEND THROUGH SIDEROADS

REVISIONS	
NAME	DATE
JCN	2/19/03

SHEET 1 OF 3
 ILLINOIS DEPARTMENT OF TRANSPORTATION
DISTRICT SIX
DETAILS FOR RURAL / URBAN
ENTRANCE, MAILBOX TURNOUT
& SIDEROADS
W / O CONCRETE GUTTER
(PPP - PROJECTS)

SCALE: VERT. DRAWN BY CADD
 HORIZ. CHECKED BY JCN
 DATE: FEBRUARY 23, 1999

ENT PPP

DGN-SPEC
 DATE-TIME \$TIME\$ *USER*

DETAILS OF MAILBOX TURNOUTS

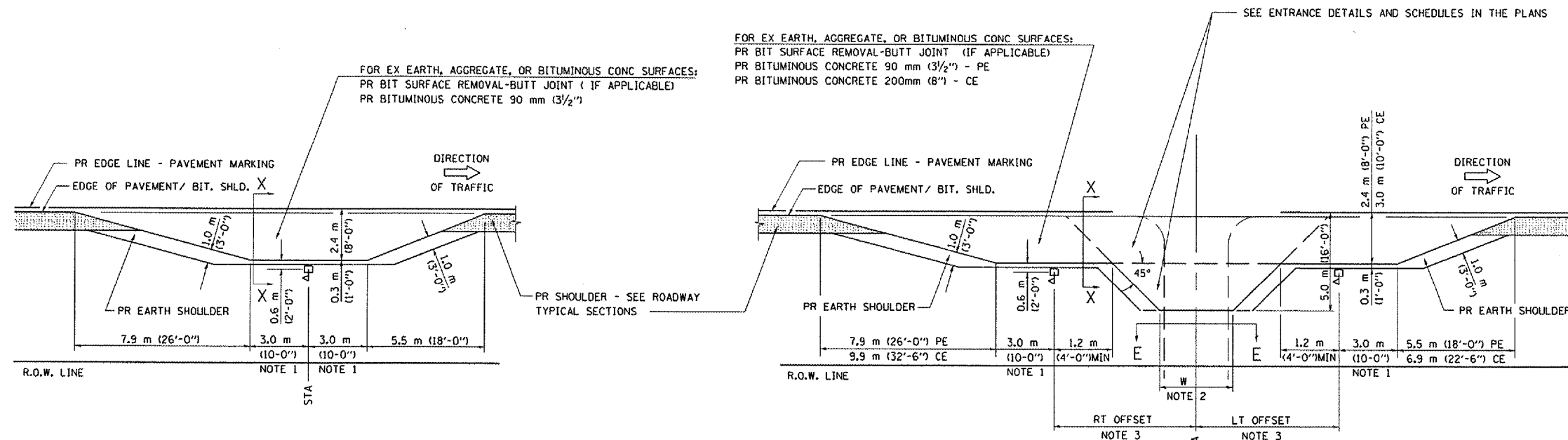

PLAN - MAILBOX TURNOUTS

PLAN - COMBINED MAILBOX TURNOUT WITH TRAILING OR LEADING ENTRANCE

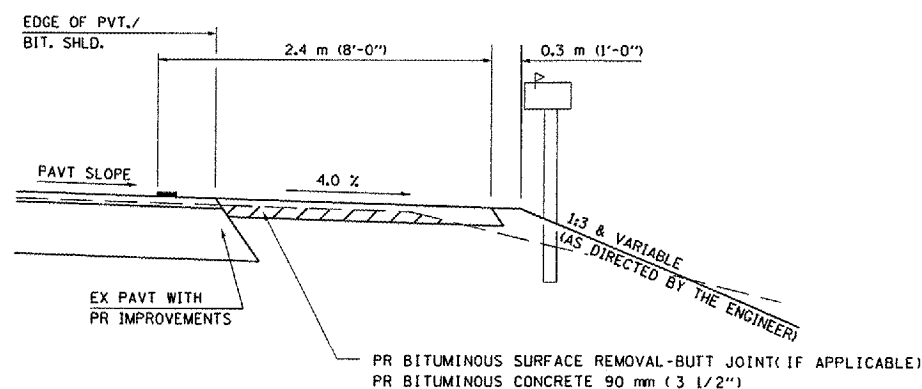

**SECTION X-X THRU MAILBOX TURNOUT
 ALSO APPLIES TO MAILBOX TURNOUTS COMBINED WITH
 EX EARTH, AGGREGATE, OR BITUMINOUS PE & FE**

(DETAIL APPLIES WHEN M.B. TURNOUT DOES NOT EXIST.
 IF EXISTING, TREAT SAME AS ENTRANCE.)

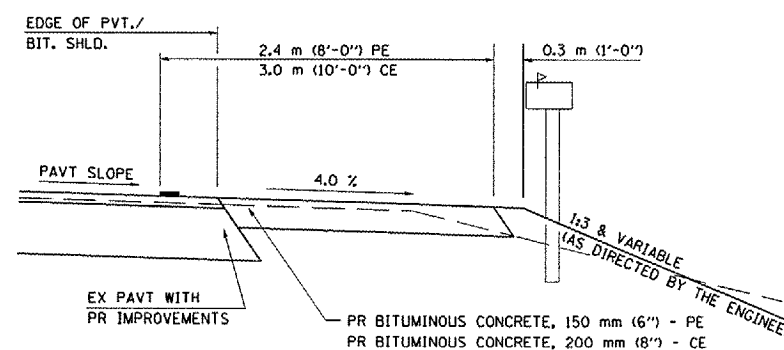

**SECTION X-X THRU MAILBOX TURNOUT
 COMBINED WITH EX BITUMINOUS CONC & PC CONC PE & CE**

(DETAIL APPLIES WHEN M.B. TURNOUT DOES NOT EXIST.
 IF EXISTING, TREAT SAME AS ENTRANCE.)

- NOTE 1 IF MORE THAN ONE MAILBOX IS PRESENT, DIMENSION FROM CENTER OF END MAILBOX.
- NOTE 2 FOR ENTRANCE LAYOUT DIMENSIONS AND SECTIONS A-A & E-E REFER TO THE SCHEDULES IN THE PLANS.
- NOTE 3 BOTH LT OR RT OFFSETS FOR MAILBOX SHOWN USE OFFSET DIMENSION PER SCHEDULE AND REFER TO LAYOUT SHOWN ON THE PLAN.

ALL DIMENSIONS ARE IN MILLIMETERS (INCHES)
 UNLESS OTHERWISE SHOWN.

SHEET 2 OF 3

REVISIONS	
NAME	DATE
JCN	2/19/03

ILLINOIS DEPARTMENT OF TRANSPORTATION
DISTRICT SIX
DETAILS FOR RURAL / URBAN
ENTRANCE, MAILBOX TURNOUT
& SIDEROADS
W / O CONCRETE GUTTER
(PPP - PROJECTS)

SCALE: VERT. _____ DRAWN BY CADD
 HORIZ. _____ CHECKED BY JCN
 DATE: FEBRUARY 23, 1999

ENT PPP

•DGN-SPEC•
 •DATE-TIME• \$TIME\$ •USER•