

F.A.P. RTE.	SECTION	COUNTY	TOTAL SHEETS	SHEET NO.
310	87 RS-3	SCHUYLER	26	11
STA. 100+00		TO STA. 110+00		
FED. ROAD DIST. NO.	ILLINOIS	FED. AID PROJECT		
CONTRACT 72839				

CURVE 102
P.I. STA= 44+84.80
 $\Delta = 27^{\circ}36'43.28''$ (LT)
D= $0^{\circ}29'59.15''$
R= 11,464.54'
T= 2,817.24'
L= 5,525.00'
E=
S.E.= N.C.
P.C. STA= 16+67.56
P.T. STA= 71+92.56

STATION EQUATION:
Sta. 112+91.90 BK (SOUTH)
= Sta 12+93.18 AH (NORTH)

PC Sta. 16+67.56

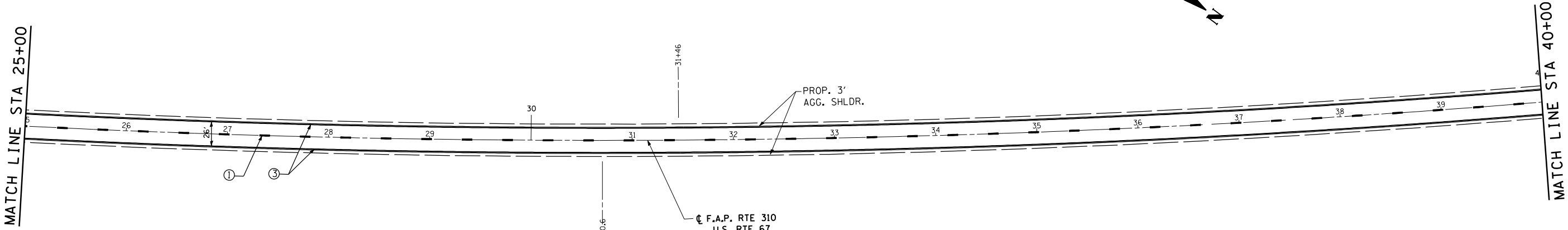
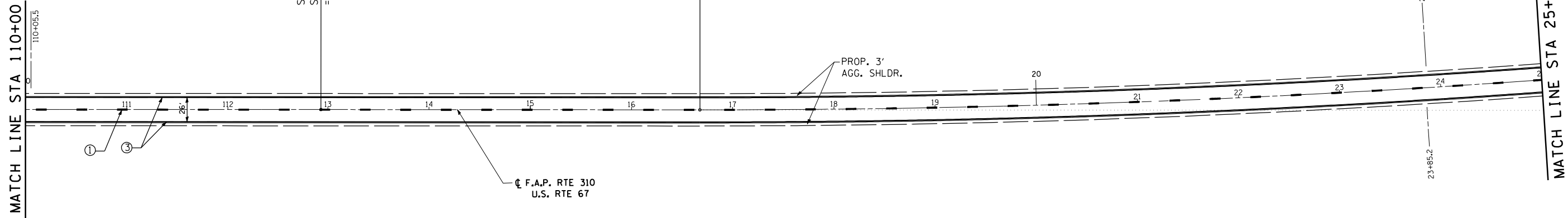

- ① PROPOSED PAINT PAVEMENT MARKING CENTERLINE 5" - SKIP DASH YELLOW
- ② PROPOSED PAINT PAVEMENT MARKING CENTERLINE 5" - SOLID YELLOW
- ③ PROPOSED PAINT PAVEMENT MARKING EDGELINE 5" - SOLID WHITE (12" EITHER SIDE OF CENTERLINE)

REVISIONS	
NAME	DATE

ILLINOIS DEPARTMENT OF TRANSPORTATION
ALIGNMENT SCHEMATIC
F. A. P. ROUTE 310 (US 67)
SECTION 87 RS-3
SCHUYLER COUNTY
SCALE: NOT TO SCALE
DATE: NOV, 2003
DRAWN BY: AGG
CHECKED BY: MJS