

F.A.P. RTE.	SECTION	COUNTY	TOTAL SHEETS	SHEET NO.
310	87(RS-3)	SCHUYLER	26	1

STATE OF ILLINOIS  
DEPARTMENT OF TRANSPORTATION  
DIVISION OF HIGHWAYS

# PROPOSED HIGHWAY PLANS

FAP ROUTE 310 (US 67)  
SECTION 87 (RS- 3)  
PROJECT  
SCHUYLER COUNTY  
RESURFACING  
C-96-558-07

FOR INDEX OF SHEETS, SEE SHEET NO. 2

FOR LIST OF STANDARDS, SEE SHEET NO. 2

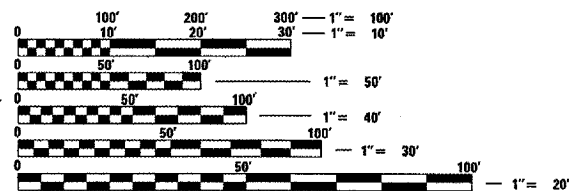
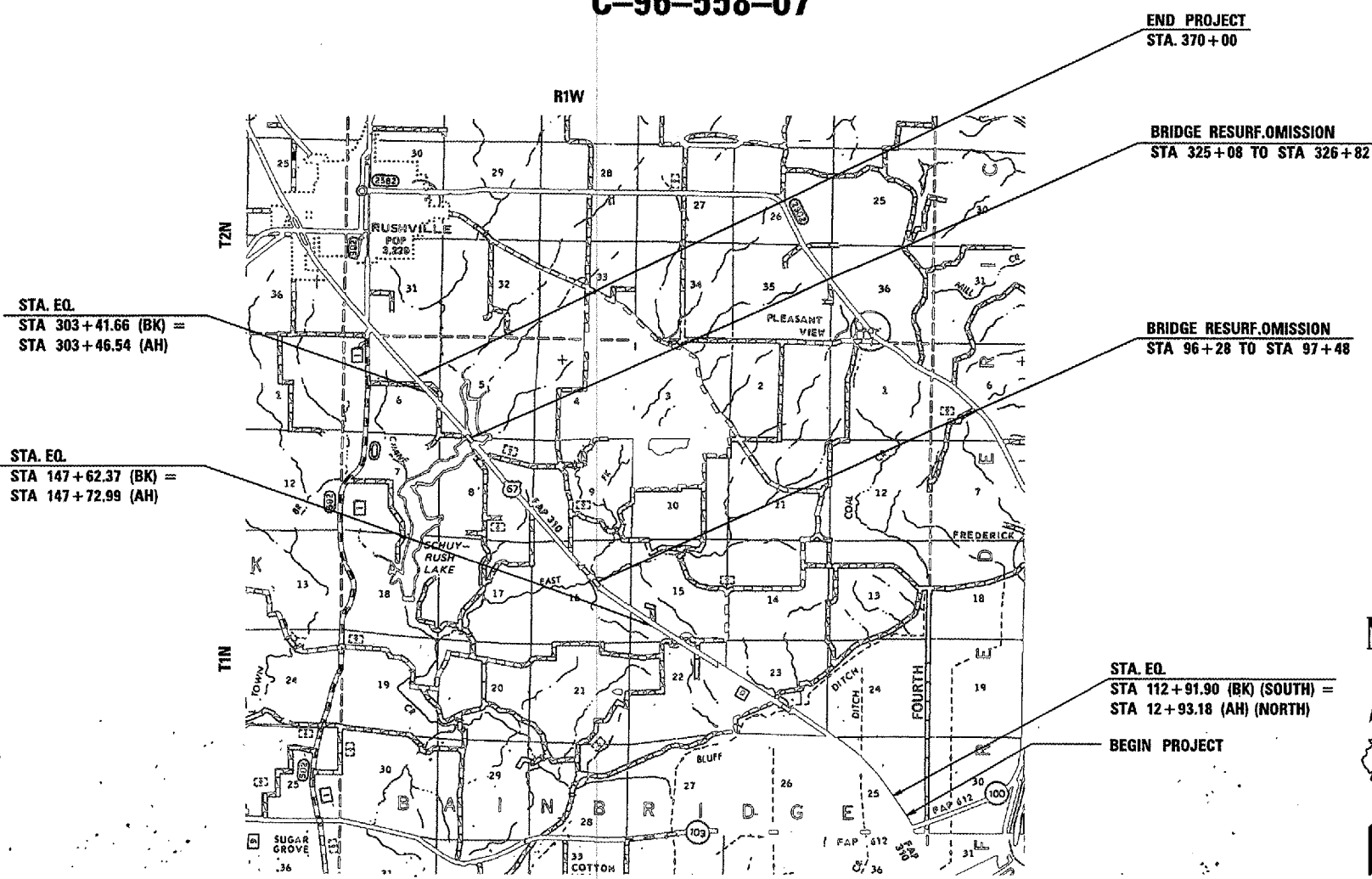
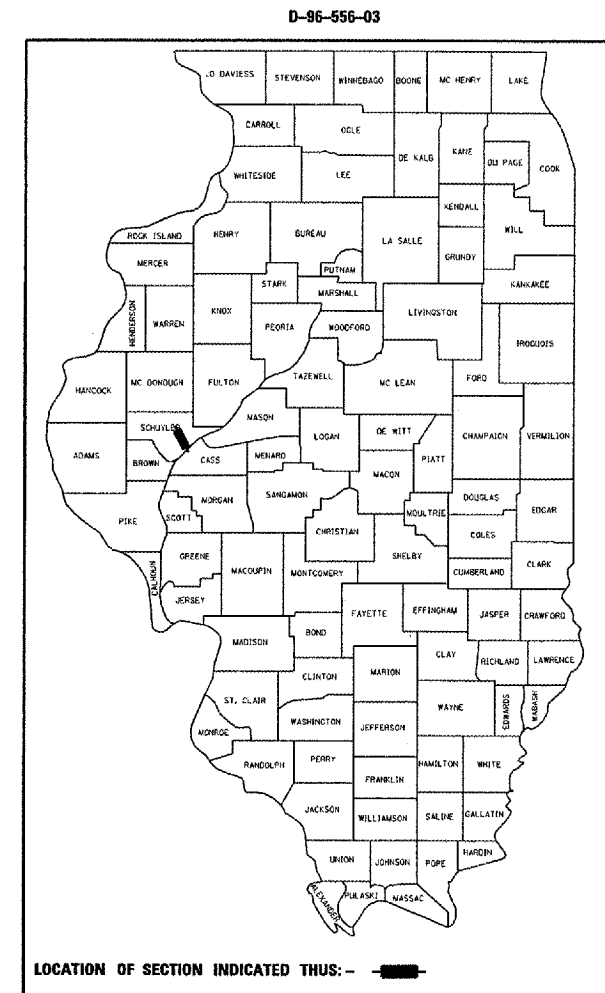

FULL SIZE PLANS HAVE BEEN PREPARED USING STANDARD ENGINEERING SCALES. REDUCED SIZED PLANS WILL NOT CONFORM TO STANDARD SCALES. IN MAKING MEASUREMENTS ON REDUCED PLANS, THE ABOVE SCALES MAY BE USED.

J.U.L.I.E.  
JOINT UTILITY LOCATION INFORMATION FOR EXCAVATION  
1-800-892-0123

CONTRACT NO. 72839

TOTAL LENGTH OF SECTION = 36,214.22 FT = 6.859 MILES  
NET LENGTH OF SECTION = 35,920.22 FT = 6.803 MILES

STATE OF ILLINOIS  
DEPARTMENT OF TRANSPORTATION  
DIVISION OF HIGHWAYS

SUBMITTED Mar 8 2007  
*[Signature]* DISTRICT ENGINEER  
May 11 2007  
*[Signature]* ENGINEER OF DESIGN AND ENVIRONMENT  
May 11 2007  
*[Signature]* DIRECTOR, DIVISION OF HIGHWAYS

PRINTED BY THE AUTHORITY  
OF THE STATE OF ILLINOIS

PROJECT ENGINEER JOHN MEGANGARD 217-782-6990  
SQUAD LEADER VINCE MADONIA 217-785-9046



ILLINOIS DEPARTMENT OF TRANSPORTATION  
SUMMARY OF QUANTITIES

CODE NO.	ITEM	UNIT	TOTAL	CONSTRUCTION TYPE CODE - 1000	
				80% Federal	20% State
20400805	FURNISHED EXCAVATION, SPECIAL	CU YD	170	170	
35800100	PREPARATION OF BASE	SQ YD	130	130	
40200800	AGGREGATE SURFACE COURSE, TYPE B	TON	43	43	
40600200	BITUMINOUS MATERIALS (PRIME COAT)	TON	43.8	43.8	
40600300	AGGREGATE (PRIME COAT)	TON	225	225	
40600895	CONSTRUCTING TEST STRIP	EACH	1	1	
40600982	HOT-MIX ASPHALT SURFACE REMOVAL - BUTT JOINT	SQ YD	1279	1279	
40600990	TEMPORARY RAMP	SQ YD	87	87	
<b>44000198</b>	<b>HOT-MIX ASPHALT</b> SURFACE REMOVAL (VARIABLE DEPTH)	SQ YD	110,957	110,957	
44200168	PAVEMENT PATCHING, TYPE II, 14 INCH	SQ YD	270	270	
44200172	PAVEMENT PATCHING, TYPE III, 14 INCH	SQ YD	90	90	
44200174	PAVEMENT PATCHING, TYPE IV, 14 INCH	SQ YD	180	180	
48101200	AGGREGATE SHOULDERS, TYPE B	TON	4023	4023	

REVISIONS		ILLINOIS DEPARTMENT OF TRANSPORTATION <b>SUMMARY OF QUANTITIES</b> F. A. P. ROUTE 310 (US 67) SECTION 87 RS-3 SCHUYLER COUNTY SCALE: NONE DATE: DEC. 2003	DRAWN BY: AGG CHECKED BY: MJS
NAME	DATE		

Rev.

F.A.P. RTE.	SECTION	COUNTY	TOTAL SHEETS	SHEET NO.
310	87 RS-3	SCHUYLER	26	4
STA. 69+70		TO STA. 370+00		
FED. ROAD DIST. NO. 6 ILLINOIS FED. AID PROJECT				
CONTRACT 72839				

ILLINOIS DEPARTMENT OF TRANSPORTATION  
SUMMARY OF QUANTITIES

CODE NO.	ITEM	UNIT	TOTAL	CONSTRUCTION TYPE CODE - 1000	
				80% Federal	20% State
* 63100167	TRAFFIC BARRIER TERMINAL TYPE 1, SPECIAL (TANGENT)	EACH	8	8	
* 63200305	STEEL PLATE BEAM GUARDRAIL REMOVAL	<i>FOOT</i>	304	304	
67000400	ENGINEER'S FIELD OFFICE, TYPE A	CAL MO	6	6	
67100100	MOBILIZATION	L SUM	1	1	
70100450	TRAFFIC CONTROL AND PROTECTION, STANDARD 701201	L SUM	1	1	
70100460	TRAFFIC CONTROL AND PROTECTION, STANDARD 701306	L SUM	1	1	
70300100	SHORT-TERM PAVEMENT MARKING	FOOT	12,300	12,300	
70300230	TEMPORARY PAVEMENT MARKING - LINE 5"	FOOT	100,611	100,611	
70301000	WORK ZONE PAVEMENT MARKING REMOVAL	SQ FT	1708	1708	
* 78001120	PAINT PAVEMENT MARKING - LINE 5"	FOOT	100,611	100,611	
* 78100100	RAISED REFLECTIVE PAVEMENT MARKER	EACH	512	512	
* 78200420	GUARDRAIL MARKERS, TYPE B	EACH	26	26	
* 78201000	TERMINAL MARKER - DIRECT APPLIED	EACH	8	8	
78300200	RAISED REFLECTIVE PAVEMENT MARKER REMOVAL	EACH	512	512	
40603080	HOT-MIX ASPHALT BINDER COURSE IL 19.0, N50	TON	13,882	13,882	
40603310	HOT-MIX ASPHALT CONCRETE SURFACE COURSE, MIX "C", N50	TON	9409	9409	
40800050	INCIDENTAL HOT-MIX ASPHALT SURFACING	TON	132	132	

\*SPECIALTY ITEMS

REVISIONS	
NAME	DATE

ILLINOIS DEPARTMENT OF TRANSPORTATION  
**SUMMARY OF QUANTITIES**  
F. A. P. ROUTE 310 (US 67)  
SECTION 87 RS-3  
SCHUYLER COUNTY  
SCALE: NONE  
DATE: DEC. 2003  
DRAWN BY: AGG  
CHECKED BY: MJS

F.A.P. RTE.	SECTION	COUNTY	TOTAL SHEETS	SHEET NO.
310	87 RS-3	SCHUYLER	26	5
STA. 69+70		TO STA.370+00		
FED. ROAD DIST. NO.	ILLINOIS	FED. AID PROJECT		

RESURFACING SCHEDULE										
LOCATION	LENGTH	WIDTH	HMA SURFACE REMOVAL - BUTT JOINT	HMA SURFACE REMOVAL - (VAR. DEPTH)	TEMP RAMPS	BIT. MATERIALS PRIME COAT	AGG PRIME COAT	HMA BINDER COURSE	HMA CONC SURFACE COURSE	AGG SHOULDERS TYPE B
(LT / RT) (STA) ( + )	FOOT	FOOT	SQ YD	SQ YD	SQ YD	TON	TON	TON	TON	TON
107+69.0 TO 108+29.0	60.00	26	43.33	130.00	14.44	0.066	0.35		22.75	6.72
108+29.0 TO 112+91.90 (BK)	462.90	26		1337.27		0.508	2.67	168.50	112.33	51.84
12+93.18 (AH) TO 95+54.0	8230.82	26		23777.92		9.036	47.56	2996.02	1997.35	921.85
95+54.0 TO 96+28.0	74.00	26	213.78		14.44	0.081	0.43		31.43	8.29
97+48.0 TO 98+22.0	74.00	26	213.78		14.44	0.081	0.43		31.43	8.29
98+22.0 TO 107+47.5	925.50	26		2673.67		1.016	5.35	336.88	224.59	103.66
107+47.5 TO 108+61.0	113.50	26 TO 38		403.56		0.153	0.81	50.85	33.90	12.71
108+61.0 TO 109+30.0	69.00	38		291.33		0.111	0.58	36.71	24.47	7.73
109+30.0 TO 110+25.0	95.00	38.5		406.39		0.154	0.81	51.21	34.14	10.64
110+25.0 TO 147+62.37 (BK)	3737.37	39		16195.27		6.154	32.39	2040.60	1360.40	418.59
147+72.99 (AH) TO 152+15.0	442.01	39		1915.38		0.728	3.83	241.34	160.89	49.51
152+15.0 TO 159+10.7	695.70	38		2937.40		1.116	5.87	370.11	246.74	77.92
159+10.7 TO 160+96.0	185.30	38 TO 26		658.84		0.250	1.32	83.01	55.34	20.75
160+96.0 TO 206+55.0	4559.00	26		13170.44		5.005	26.34	1659.48	1106.32	510.61
206+55.0 TO 225+00.0	1845.00	26.5		5432.50		2.064	10.87	684.50	456.33	206.64
225+00.00 TO 229+25.0	425.00	26		1227.78		0.467	2.46	154.70	103.13	47.60
229+25.0 TO 236+00.0	675.00	26.5		1987.50		0.755	3.98	250.43	166.95	75.60
236+00.0 TO 303+41.66 (BK)	6741.66	26		19475.91		7.401	38.95	2453.96	1635.98	755.07
303+46.54 (AH) TO 324+48.0	2101.46	26		6070.88		2.307	12.14	764.93	509.95	235.36
324+48.0 TO 325+08.0	60.00	26	43.33	130.00	14.44	0.066	0.35		22.75	6.72
326+82.0 TO 327+42.0	60.00	26	43.33	130.00	14.44	0.066	0.35		22.75	6.72
327+42.0 TO 369+70.0	4228.00	26		12214.22		4.641	24.43	1538.99	1025.99	473.54
369+70.0 TO 370+30.0	60.00	26	43.33	130.00	14.44	0.066	0.35		22.75	6.72
<b>TOTAL =</b>			600.89	110696.26	86.67	42.29	222.59	13882.21	9408.66	4023.06

SHORT TERM PAVEMENT MARKING SCHEDULE			
LOCATION	LENGTH	SHORT TERM PAVT MK	WORK ZONE PAVT MK REMOVAL
(LT / RT) (STA) ( + )	FOOT	FOOT	SQ FT
107+69.0 TO 112+91.90 (BK)	522.9	156.87	21.79
12+93.18 (AH) TO 96+28.0	8334.82	2500.45	347.28
96+28.0 TO 97+48.0 (BRIDGE)	120	0.00	0.00
97+48.0 TO 108+61.0	1113	333.90	46.38
108+61.0 TO 147+62.37 (BK)	3901.37	2340.82	325.11
147+72.99 (AH) TO 159+10.7	1137.71	682.63	94.81
159+10.7 TO 303+41.66 (BK)	14430.96	4329.29	601.29
303+46.54 (AH) TO 325+08.0	2161.46	648.44	90.06
325+08.0 TO 326+82.0 (BRIDGE)	174	0.00	0.00
326+82.0 TO 370+30.0	4348	1304.40	181.17
<b>TOTAL =</b>		12296.79	1707.89

RAISED PAVEMENT MARKER SCHEDULE			
LOCATION	LENGTH	RAISED PAVT MKS	RAISED PAVT MK REMOVAL
(LT / RT) (STA) ( + )	FOOT	EACH	EACH
107+69.0 TO 112+91.90 (BK)	522.9	7	7
12+93.18 (AH) TO 96+28.0	8334.82	104	104
96+28.0 TO 97+48.0 (BRIDGE)	120	0	0
97+48.0 TO 108+61.0	1113	14	14
108+61.0 TO 147+62.37 (BK)	3901.37	49	49
RT - CLIMBING LANE (CRYSTAL)	3901.37	49	49
147+72.99 (AH) TO 159+10.7	1137.71	14	14
RT - CLIMBING LANE (CRYSTAL)	1137.71	14	14
159+10.7 TO 303+41.66 (BK)	14430.96	180	180
303+46.54 (AH) TO 325+08.0	2161.46	27	27
325+08.0 TO 326+82.0 (BRIDGE)	174	0	0
326+82.0 TO 370+30.0	4348	54	54
<b>TOTAL =</b>		512	512

NOTE: 63 ONE-WAY CRYSTAL, AND 449 TWO-WAY AMBER

PLOT DATE = \$DATE\$  
 FILE NAME = \$FILEL\$  
 PLOT SCALE = \$SCALE\$  
 USER NAME = \$USER\$

REVISIONS	
NAME	DATE

ILLINOIS DEPARTMENT OF TRANSPORTATION  
**DISTRICT SIX**  
**SCHEDULES FOR RURAL / URBAN**  
**ENTRANCE & MAILBOX TURNOUT**  
**W / O CONCRETE GUTTER**  
**(PPP - PROJECTS)**  
 SCALE: VERT. \_\_\_\_\_  
 HORIZ. \_\_\_\_\_  
 DATE \_\_\_\_\_ DRAWN BY \_\_\_\_\_  
 CHECKED BY \_\_\_\_\_

F.A.P. RTE.	SECTION	COUNTY	TOTAL SHEETS	SHEET NO.
310	87 RS-3	SCHUYLER	26	6
STA. 69+70		TO STA.370+00		
FED. ROAD DIST. NO.		ILLINOIS	FED. AID PROJECT	

PAVEMENT MARKING SCHEDULE

LOCATION	LENGTH	LINE 5" SKIP-DASH YELLOW	LINE 5" SKIP-DASH WHITE	LINE 5" SOLID WHITE	LINE 5" SOLID YELLOW
(LT / RT) (STA) ( + )	FOOT	FOOT	FOOT	FOOT	FOOT
<b>SOLID WHITE - EDGE LINES</b>					
107+69.0 TO 112+91.90 (BK)	522.90			1045.80	
12+93.18 (AH) TO 96+28.0	8334.82			16669.64	
96+28.0 TO 97+48.0 (BRIDGE)	120.00			240.00	
97+48.0 TO 147+62.37 (BK)	5014.37			10028.74	
147+72.99 (AH) TO 303+41.66 (BK)	15568.67			31137.34	
303+46.54 (AH) TO 325+08.0	2161.46			4322.92	
325+08.0 TO 326+82.0 (BRIDGE)	174.00			348.00	
326+82.0 TO 370+30.0	4348.00			8696.00	
<b>WHITE SKIP DASH</b>					
RT 108+61.0 TO RT 147+62.37 (BK)	3901.37		975.34		
RT 147+72.99 (AH) TO RT 159+10.7	1137.71		284.43		
<b>YELLOW SKIP DASH</b>					
107+69.0 TO 112+91.90 (BK)	522.90	130.73			
12+93.18 (AH) TO 96+28.0	8334.82	2083.71			
96+28.0 TO 97+48.0 (BRIDGE)	120.00	30.00			
97+48.0 TO 147+62.37 (BK)	5014.37	1253.59			
147+72.99 (AH) TO 154+09.0	636.01	159.00			
155+53.0 TO 301+93.0	14640.00	3660.00			
305+96.0 TO 325+08.0	1912.00	478.00			
325+08.0 TO 326+82.0 (BRIDGE)	174.00	43.50			
326+82.0 TO 370+30.0	4348.00	1087.00			
<b>SOLID YELLOW - NO PASSING ZONES</b>					
RT 105+27.0 TO RT 147+62.37 (BK)	4235.37				4235.37
RT 147+72.99 (AH) TO RT 155+53.0	780.01				780.01
LT 154+09.0 TO LT 169+93.0	1584.00				1584.00
RT 189+65.0 TO RT 202+95.0	1330.00				1330.00
LT 206+89.0 TO LT 217+45.0	1056.00				1056.00
RT 231+89.0 TO RT 242+55.0	1066.00				1066.00
LT 245+85.0 TO LT 259+74.0	1389.00				1389.00
RT 287+33.0 TO RT 305+96.0	1863.00				1863.00
LT 301+93.0 TO LT 320+46.0	1853.00				1853.00
RT 334+90.0 TO RT 345+56.0	1066.00				1066.00
LT 346+86.0 TO LT 364+01.0	1715.00				1715.00
TOTAL =		8925.53	1259.77	72488.44	17937.38
GRAND TOTAL =			100611		

GUARDRAIL SCHEDULE

LOCATION	SPBGR REMOVAL	TBT T-1 SPL TANGENT	TERMINAL MARKERS DIRECT APPLIED	GUARDRAIL MARKERS T-B	FURNISHED EXCAVATION (SPECIAL)
(LT / RT) (STA) ( + )	FOOT	EACH	EACH	EACH	CU YD
LT 95+86.0	38	1	1	1	10
RT 95+86.0	38	1	1	1	10
LT 97+97.0	38	1	1	1	100*
RT 98+32.0	38	1	1	1	10
RT 318+47.0	38	1	1	7	10
LT 318+97.0	38	1	1	7	10
RT 329+69.0	38	1	1	3	10
LT 330+42.0	38	1	1	5	10
TOTAL =	304	8	8	26 **	170

NOTE: \* ADDITIONAL ESTIMATED QUANTITY TO RELOCATE FE.  
 \*\* QUANTITY ESTIMATED FOR MARKERS TO BE PLACED ON EXISTING GUARDRAIL LEFT IN PLACE, NONE TO BE PLACED ON NEW TBT T-1 SPL (TANG).

PLOT DATE = \$DATE\$  
 FILE NAME = \$FILEL\$  
 PLOT SCALE = \$SCALE\$  
 USER NAME = \$USER\$

REVISIONS	
NAME	DATE

ILLINOIS DEPARTMENT OF TRANSPORTATION  
**DISTRICT SIX**  
**SCHEDULES FOR RURAL / URBAN**  
**ENTRANCE & MAILBOX TURNOUT**  
**W / O CONCRETE GUTTER**  
**(PPP - PROJECTS)**  
 SCALE: VERT. \_\_\_\_\_  
 HORIZ. \_\_\_\_\_  
 DATE \_\_\_\_\_ DRAWN BY \_\_\_\_\_  
 CHECKED BY \_\_\_\_\_

F.A.P. RTE.	SECTION	COUNTY	TOTAL SHEETS	SHEET NO.
310	87 RS-3	SCHUYLER	26	7
STA.		TO STA.		
FED. ROAD DIST. NO.	ILLINOIS	FED. AID PROJECT		
CONTRACT 72839				

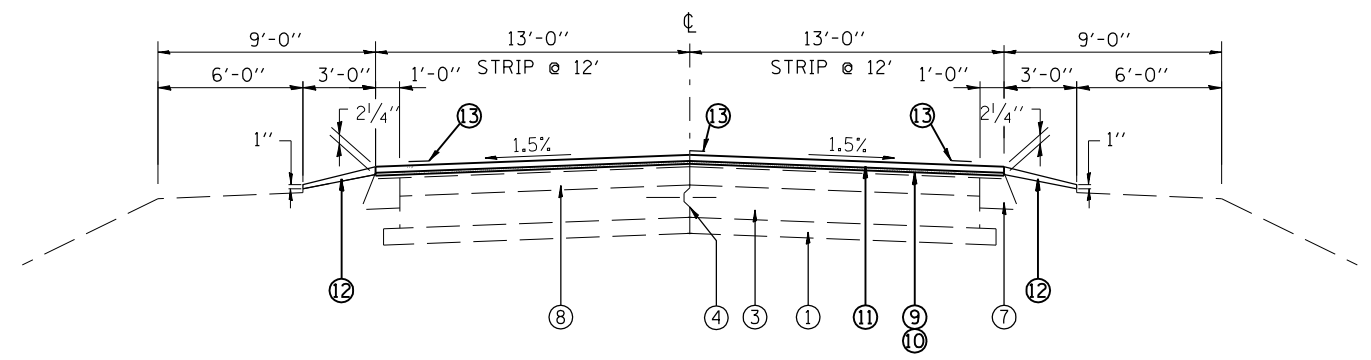

107+69 TO 112+91.90 (BK) =  
 12+93.18 (AH) TO 96+28  
 STA 96+28 TO STA 97+48 -  
 BRIDGE RESURF. OMISSION  
 97+48 TO 107+47.5  
 160+96 TO 206+55  
 225+00 TO 229+25  
 236+00 TO 303+41.66 (BK) =  
 303+46.54 (AH) TO 310+50  
 312+50 TO 325+08  
 STA 325+08 TO STA 326+82 -  
 BRIDGE RESURF. OMISSION  
 326+82 TO 344+00  
 346+50 TO 370+30

STATION EQUATIONS:  
 STA. 112+91.9 (BK) = STA. 12+93.18 (AH)  
 STA. 303+41.66 (BK) = STA. 303+46.54 (AH)

**LEGEND**

- ① EXISTING SUB-BASE GRANULAR MATERIAL 4"
- ② EXISTING SUB-BASE GRANULAR MATERIAL 14"
- ③ EXISTING P.C.C. BASE COURSE 8"
- ④ EXISTING LONGITUDINAL METAL JOINT WITH 1/2"Ø DEFORMED BAR
- ⑤ EXISTING #4 TIE BAR
- ⑥ EXISTING CONCRETE GUTTER
- ⑦ EXISTING BITUMINOUS SHOULDER
- ⑧ EXISTING BITUMINOUS SURFACE 6"±
- ⑨ PROPOSED HMA SURFACE REMOVAL -3/4"
- ⑩ PROPOSED HMA BINDER, 2 1/4"
- ⑪ PROPOSED HMA CONCRETE SURFACE COURSE, 1 1/2"
- ⑫ PROPOSED AGGREGATE SHOULDER, TYPE B
- ⑬ PROPOSED PAVEMENT MARKING, LINE 5"

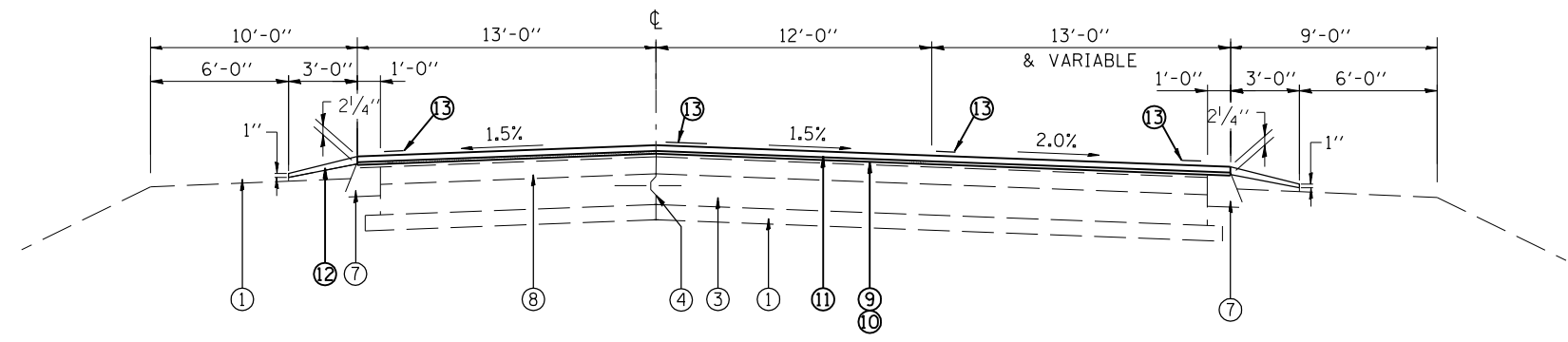

107+47.5 TO 109+30  
 152+15 TO 160+96

REVISIONS	
NAME	DATE

ILLINOIS DEPARTMENT OF TRANSPORTATION  
**TYPICAL SECTIONS**  
 F. A. P. ROUTE 310 (US 67)  
 SECTION 87 RS-3  
 SCHUYLER COUNTY  
 SCALE: NONE  
 DATE: NOV, 2003  
 DRAWN BY AGG  
 CHECKED BY MJS

F.A.P. RTE.	SECTION	COUNTY	TOTAL SHEETS	SHEET NO.
310	87 RS-3	SCHUYLER	26	8
STA.		TO STA.		
FED. ROAD DIST. NO.	ILLINOIS	FED. AID PROJECT		
CONTRACT 72839				

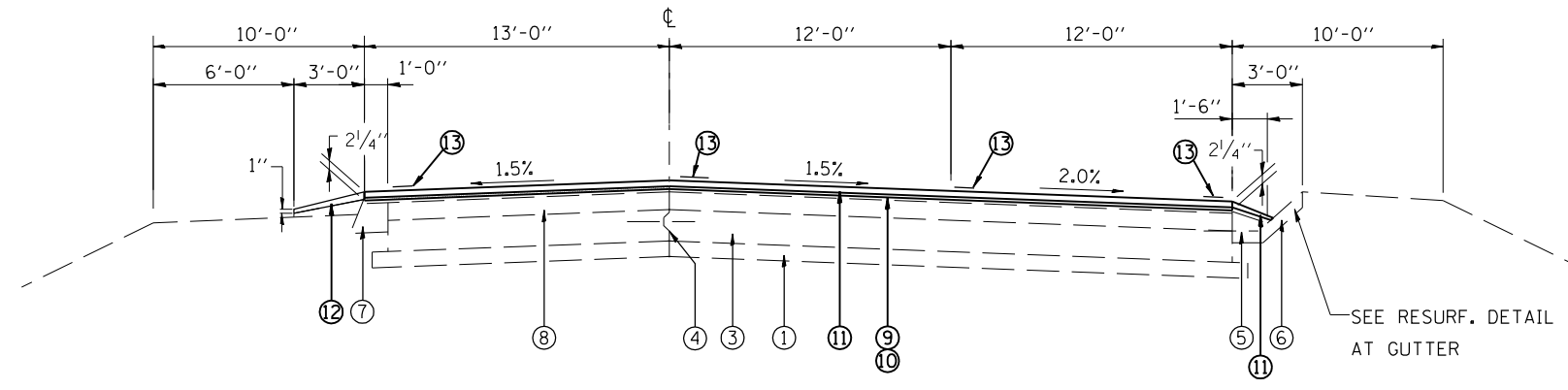

109+30 TO 110+25

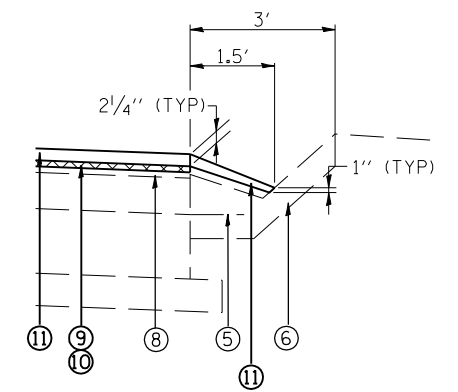

**LEGEND**

- ① EXISTING SUB-BASE GRANULAR MATERIAL 4"
- ② EXISTING SUB-BASE GRANULAR MATERIAL 14"
- ③ EXISTING P.C.C. BASE COURSE 8"
- ④ EXISTING LONGITUDINAL METAL JOINT WITH 1/2"Ø DEFORMED BAR
- ⑤ EXISTING #4 TIE BAR
- ⑥ EXISTING CONCRETE GUTTER
- ⑦ EXISTING BITUMINOUS SHOULDER
- ⑧ EXISTING BITUMINOUS SURFACE 6"±
- ⑨ PROPOSED HMA SURFACE REMOVAL -3/4"
- ⑩ PROPOSED HMA BINDER, 2 1/4"
- ⑪ PROPOSED HMA CONCRETE SURFACE COURSE, 1 1/2"
- ⑫ PROPOSED AGGREGATE SHOULDER, TYPE B
- ⑬ PROPOSED PAVEMENT MARKING, LINE 5"

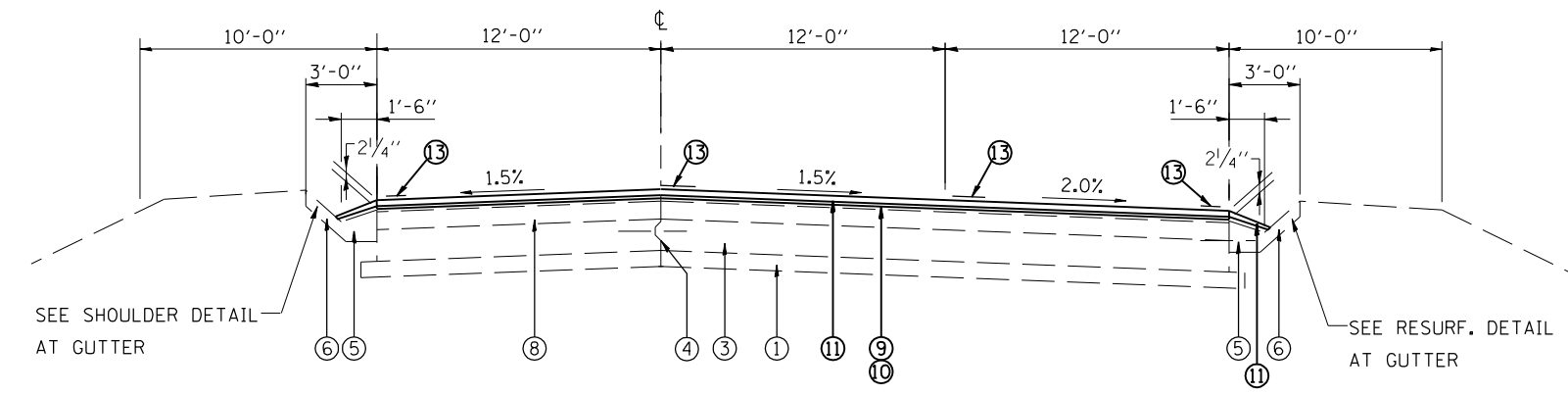

110+25 TO 147+62.37  
147+72.99 TO 152+15

STATION EQUATION:  
STA. 147+62.37 = STA. 147+72.99

EXISTING GUTTER SECTION RT 109+30(N) TO 152+15  
EXISTING GUTTER SECTION LT 110+25(N) TO 152+15

REVISIONS	
NAME	DATE

ILLINOIS DEPARTMENT OF TRANSPORTATION  
**TYPICAL SECTIONS**  
F. A. P. ROUTE 310 (US 67)  
SECTION 87 RS-3  
SCHUYLER COUNTY  
SCALE: NONE  
DATE: NOV, 2003  
DRAWN BY AGG  
CHECKED BY MJS



F.A.P. RTE.	SECTION	COUNTY	TOTAL SHEETS	SHEET NO.
310	87 RS-3	SCHUYLER	26	9
STA.		TO STA.		
FED. ROAD DIST. NO.	ILLINOIS	FED. AID PROJECT		
CONTRACT 72839				

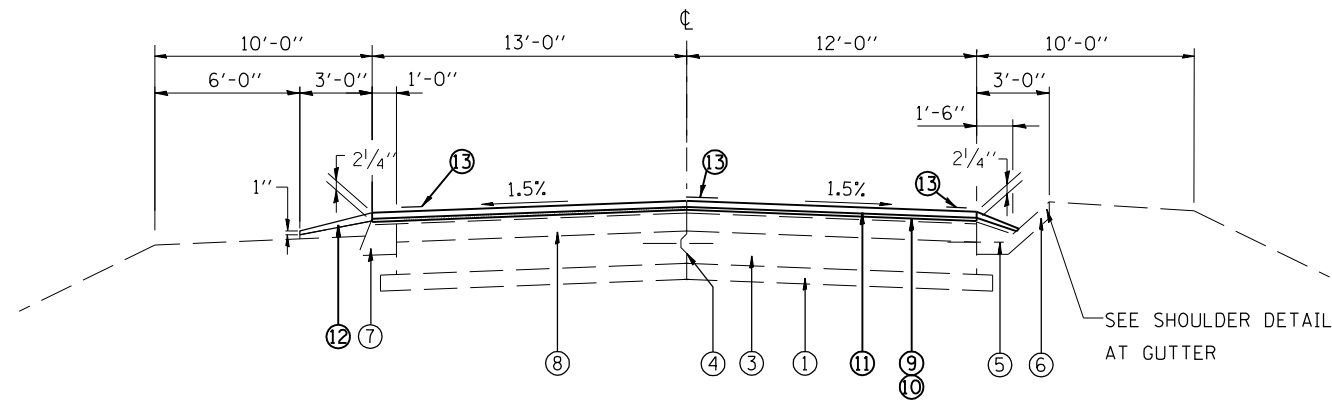

206+55 TO 225+00  
229+25 TO 236+00

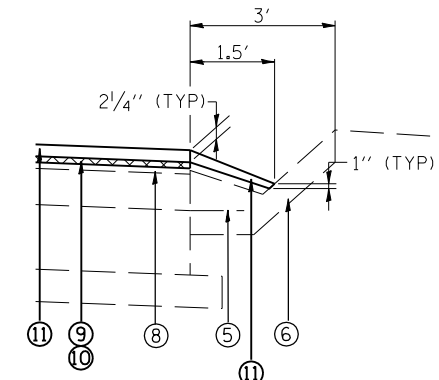

**LEGEND**

- ① EXISTING SUB-BASE GRANULAR MATERIAL 4"
- ② EXISTING SUB-BASE GRANULAR MATERIAL 14"
- ③ EXISTING P.C.C. BASE COURSE 8"
- ④ EXISTING LONGITUDINAL METAL JOINT WITH 1/2"Ø DEFORMED BAR
- ⑤ EXISTING #4 TIE BAR
- ⑥ EXISTING CONCRETE GUTTER
- ⑦ EXISTING BITUMINOUS SHOULDER
- ⑧ EXISTING BITUMINOUS SURFACE 6"±
- ⑨ PROPOSED HMA SURFACE REMOVAL -3/4"
- ⑩ PROPOSED HMA BINDER, 2 1/4"
- ⑪ PROPOSED HMA CONCRETE SURFACE COURSE, 1 1/2"
- ⑫ PROPOSED AGGREGATE SHOULDER, TYPE B
- ⑬ PROPOSED PAVEMENT MARKING, LINE 5"

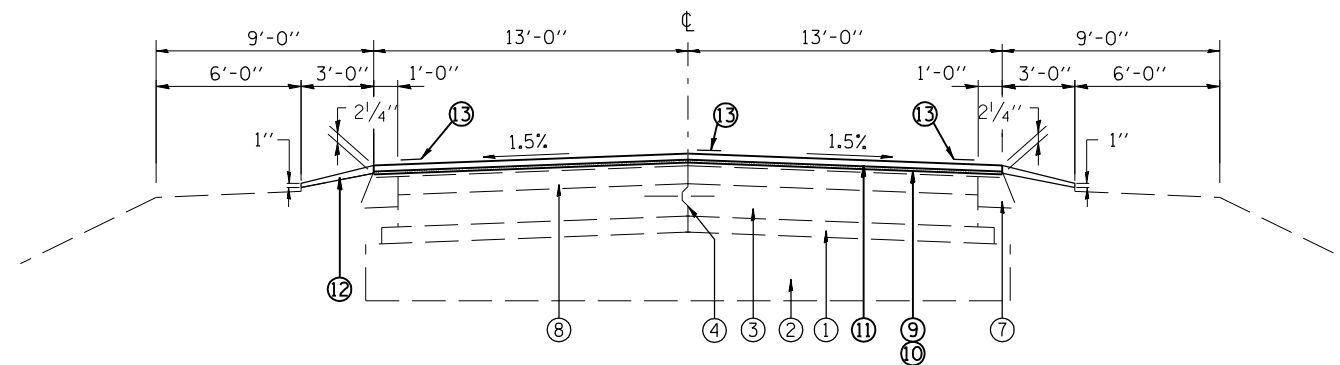

310+50 TO 312+50  
344+00 TO 346+50

REVISIONS	
NAME	DATE

ILLINOIS DEPARTMENT OF TRANSPORTATION  
**TYPICAL SECTIONS**  
F. A. P. ROUTE 310 (US 67)  
SECTION 87 RS-3  
SCHUYLER COUNTY

SCALE: NONE  
DATE: NOV, 2003  
DRAWN BY AGG  
CHECKED BY MJS

F.A.P. RTE.	SECTION	COUNTY	TOTAL SHEETS	SHEET NO.
310	87 RS-3	SCHUYLER	26	10
STA. 100+00		TO STA. 110+00		
FED. ROAD DIST. NO.	ILLINOIS	FED. AID PROJECT		
CONTRACT 72839				

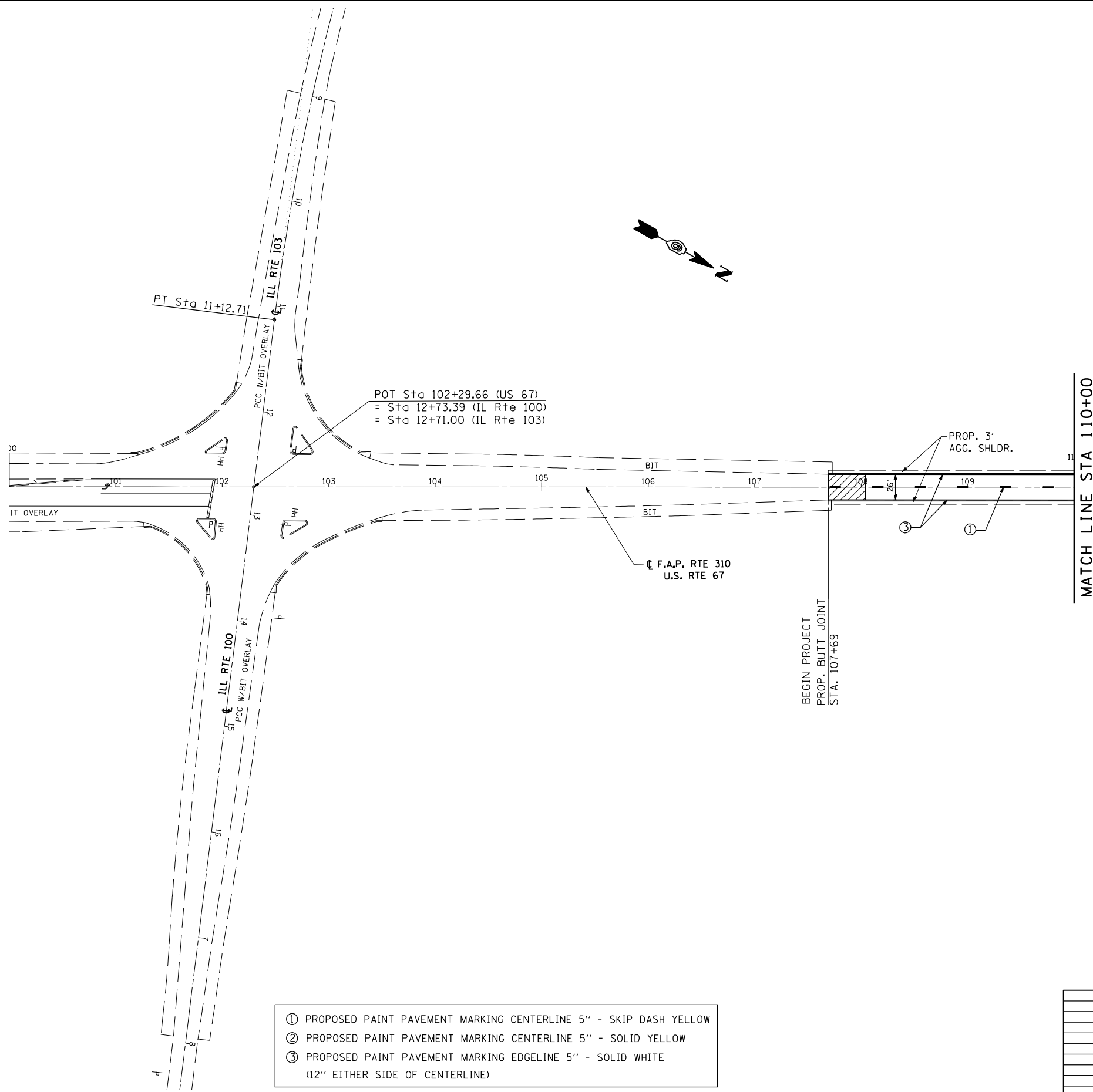

- ① PROPOSED PAINT PAVEMENT MARKING CENTERLINE 5" - SKIP DASH YELLOW
- ② PROPOSED PAINT PAVEMENT MARKING CENTERLINE 5" - SOLID YELLOW
- ③ PROPOSED PAINT PAVEMENT MARKING EDGELINE 5" - SOLID WHITE (12" EITHER SIDE OF CENTERLINE)

REVISIONS	
NAME	DATE

ILLINOIS DEPARTMENT OF TRANSPORTATION

**ALIGNMENT SCHEMATIC**

F. A. P. ROUTE 310 (US 67)  
SECTION 87 RS-3  
SCHUYLER COUNTY

SCALE: NOT TO SCALE  
DATE: NOV, 2003

DRAWN BY: AGG  
CHECKED BY: MJS

F.A.P. RTE.	SECTION	COUNTY	TOTAL SHEETS	SHEET NO.
310	87 RS-3	SCHUYLER	26	11
STA. 100+00		TO STA. 110+00		
FED. ROAD DIST. NO.	ILLINOIS	FED. AID PROJECT		
CONTRACT 72839				

CURVE 102  
P.I. STA= 44+84.80  
 $\Delta$ = 27°-36'-43.28" (LT)  
D= 0°-29'-59.15"  
R= 11,464.54'  
T= 2,817.24'  
L= 5,525.00'  
E=  
S.E.= N.C.  
P.C. STA= 16+67.56  
P.T. STA= 71+92.56

STATION EQUATION:  
Sta. 112+91.90 BK (SOUTH)  
= Sta 12+93.18 AH (NORTH)

PC Sta. 16+67.56

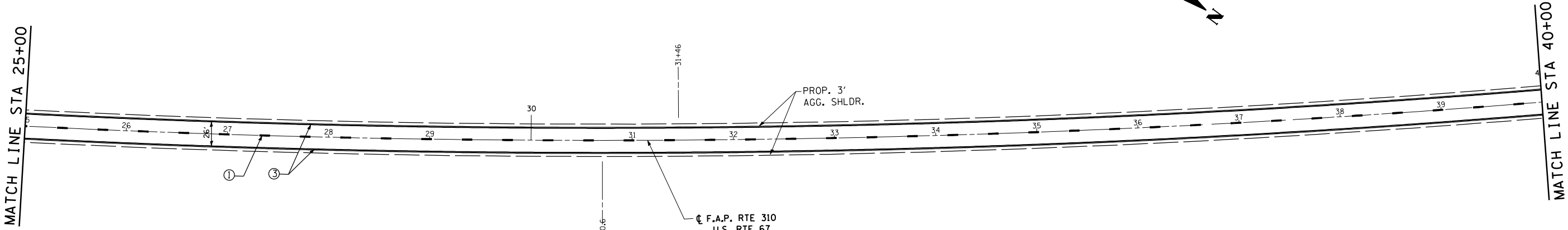
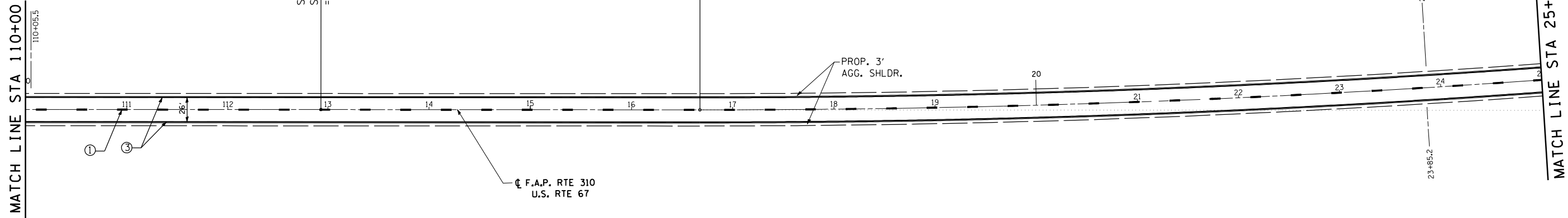

- ① PROPOSED PAINT PAVEMENT MARKING CENTERLINE 5" - SKIP DASH YELLOW
- ② PROPOSED PAINT PAVEMENT MARKING CENTERLINE 5" - SOLID YELLOW
- ③ PROPOSED PAINT PAVEMENT MARKING EDGELINE 5" - SOLID WHITE (12" EITHER SIDE OF CENTERLINE)

REVISIONS	
NAME	DATE

ILLINOIS DEPARTMENT OF TRANSPORTATION  
**ALIGNMENT SCHEMATIC**  
F. A. P. ROUTE 310 (US 67)  
SECTION 87 RS-3  
SCHUYLER COUNTY  
SCALE: NOT TO SCALE  
DATE: NOV, 2003  
DRAWN BY: AGG  
CHECKED BY: MJS

F.A.P. RTE.	SECTION	COUNTY	TOTAL SHEETS	SHEET NO.
310	87 RS-3	SCHUYLER	26	12
STA. 100+00		TO STA. 110+00		
FED. ROAD DIST. NO.	ILLINOIS	FED. AID PROJECT		
CONTRACT 72839				

CURVE 102  
P.I. STA= 44+84.80  
 $\Delta = 27^{\circ}-36'-43.28''$  (LT)  
D= 0 $^{\circ}$ -29'-59.15"  
R= 11,464.54'  
T= 2,817.24'  
L= 5,525.00'  
E=  
S.E.= N.C.  
P.C. STA= 16+67.56  
P.T. STA= 71+92.56

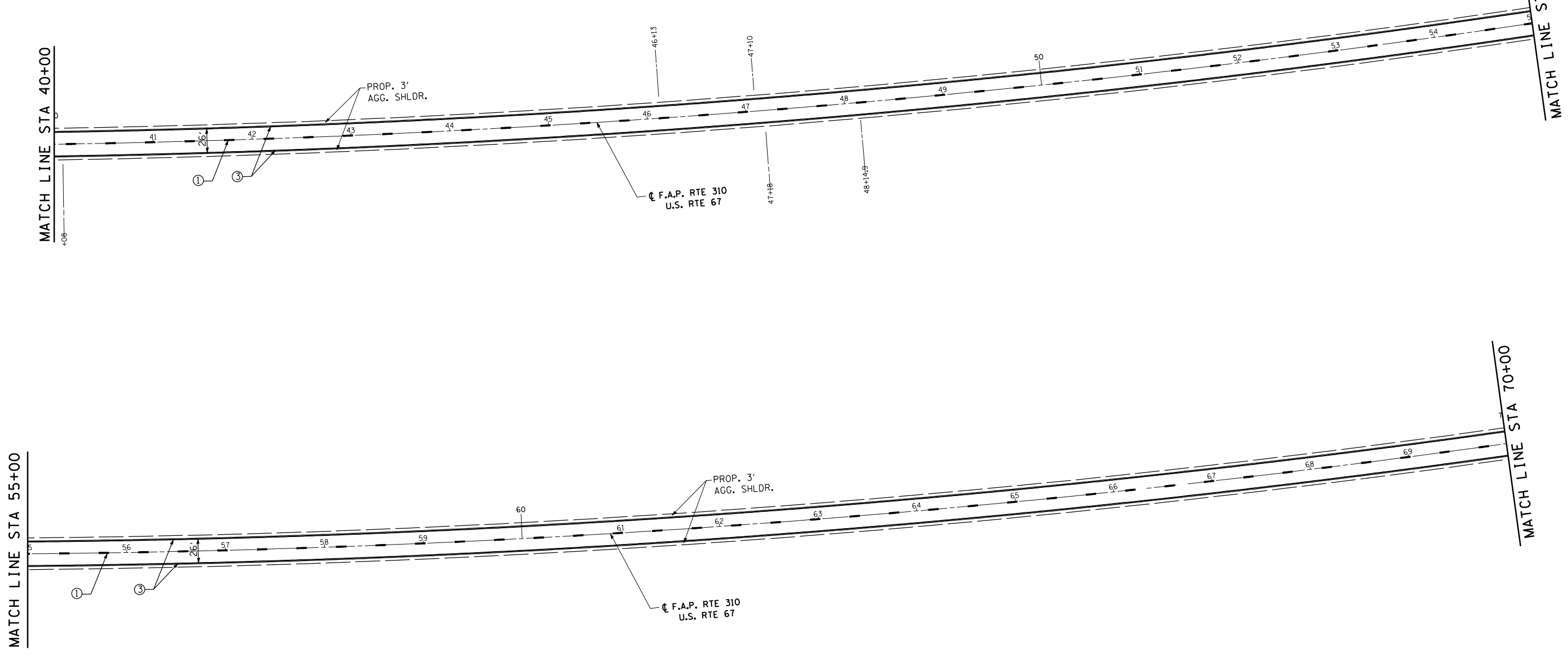
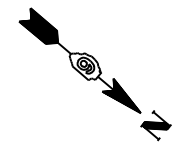

- ① PROPOSED PAINT PAVEMENT MARKING CENTERLINE 5" - SKIP DASH YELLOW
- ② PROPOSED PAINT PAVEMENT MARKING CENTERLINE 5" - SOLID YELLOW
- ③ PROPOSED PAINT PAVEMENT MARKING EDGELINE 5" - SOLID WHITE (12" EITHER SIDE OF CENTERLINE)

REVISIONS	
NAME	DATE

ILLINOIS DEPARTMENT OF TRANSPORTATION  
**ALIGNMENT SCHEMATIC**  
F. A. P. ROUTE 310 (US 67)  
SECTION 87 RS-3  
SCHUYLER COUNTY  
SCALE: NOT TO SCALE  
DATE: NOV, 2003  
DRAWN BY: AGG  
CHECKED BY: MJS

F.A.P. RTE.	SECTION	COUNTY	TOTAL SHEETS	SHEET NO.
310	87 RS-3	SCHUYLER	26	13
STA. 100+00		TO STA. 110+00		
FED. ROAD DIST. NO.	ILLINOIS	FED. AID PROJECT		
CONTRACT 72839				

CURVE 102  
P.I. STA= 44+84.80  
 $\Delta$ = 27°-36'-43.28" (LT)  
D= 0°-29'-59.15"  
R= 11,464.54'  
T= 2,817.24'  
L= 5,525.00'  
E=  
S.E.= N.C.  
P.C. STA= 16+67.56  
P.T. STA= 71+92.56

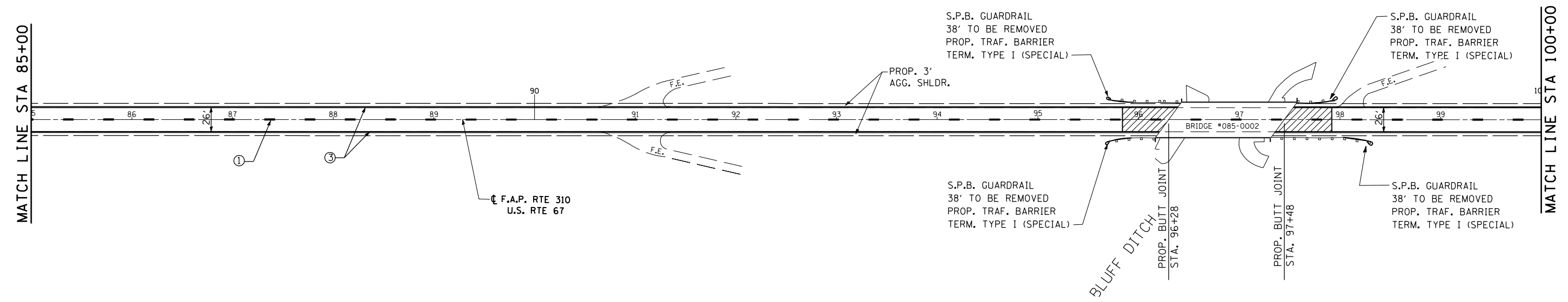
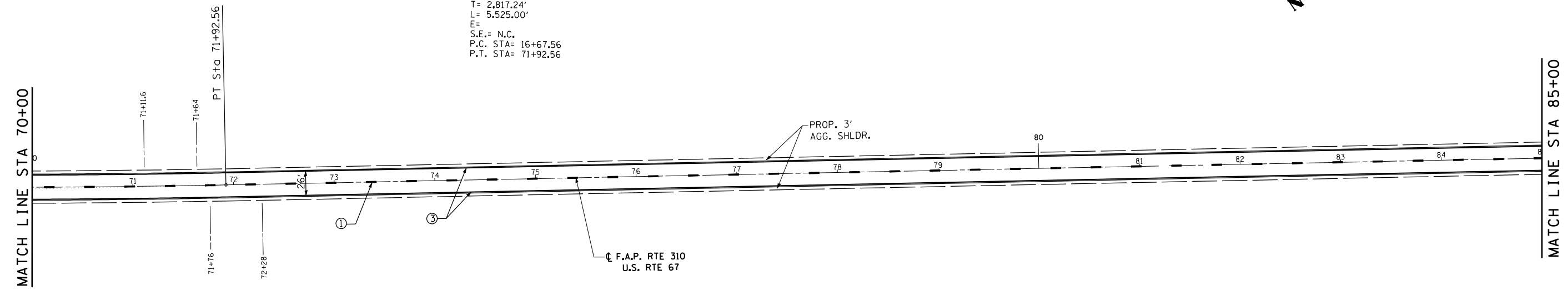

- ① PROPOSED PAINT PAVEMENT MARKING CENTERLINE 5" - SKIP DASH YELLOW
- ② PROPOSED PAINT PAVEMENT MARKING CENTERLINE 5" - SOLID YELLOW
- ③ PROPOSED PAINT PAVEMENT MARKING EDGELINE 5" - SOLID WHITE (12" EITHER SIDE OF CENTERLINE)

REVISIONS	
NAME	DATE

ILLINOIS DEPARTMENT OF TRANSPORTATION  
**ALIGNMENT SCHEMATIC**  
F. A. P. ROUTE 310 (US 67)  
SECTION 87 RS-3  
SCHUYLER COUNTY  
SCALE: NOT TO SCALE  
DATE: NOV, 2003  
DRAWN BY: AGG  
CHECKED BY: MJS

F.A.P. RTE.	SECTION	COUNTY	TOTAL SHEETS	SHEET NO.
310	87 RS-3	SCHUYLER	26	14
STA. 100+00		TO STA. 110+00		
FED. ROAD DIST. NO.	ILLINOIS	FED. AID PROJECT		
CONTRACT 72839				

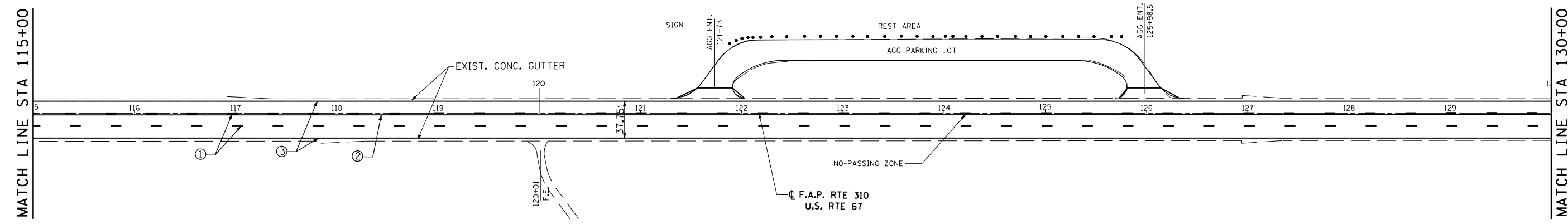
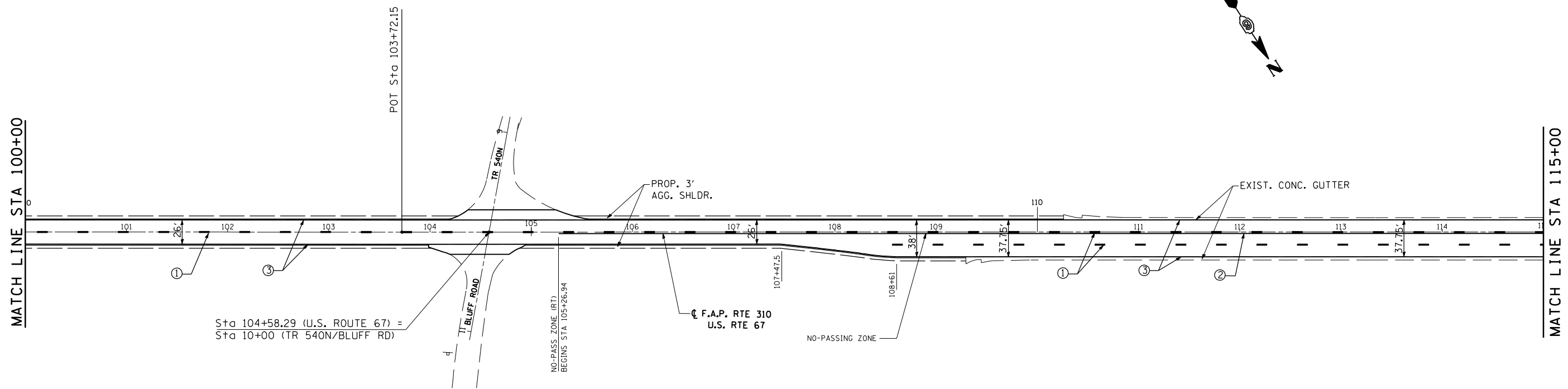

- ① PROPOSED PAINT PAVEMENT MARKING CENTERLINE 5" - SKIP DASH YELLOW
- ② PROPOSED PAINT PAVEMENT MARKING CENTERLINE 5" - SOLID YELLOW
- ③ PROPOSED PAINT PAVEMENT MARKING EDGELINE 5" - SOLID WHITE (12" EITHER SIDE OF CENTERLINE)

REVISIONS	
NAME	DATE

ILLINOIS DEPARTMENT OF TRANSPORTATION  
**ALIGNMENT SCHEMATIC**  
 F. A. P. ROUTE 310 (US 67)  
 SECTION 87 RS-3  
 SCHUYLER COUNTY

SCALE: NOT TO SCALE  
 DATE: NOV, 2003

DRAWN BY AGG  
 CHECKED BY MJS

F.A.P. RTE.	SECTION	COUNTY	TOTAL SHEETS	SHEET NO.
310	87 RS-3	SCHUYLER	26	15
STA. 100+00		TO STA. 110+00		
FED. ROAD DIST. NO.	ILLINOIS	FED. AID PROJECT		
CONTRACT 72839				

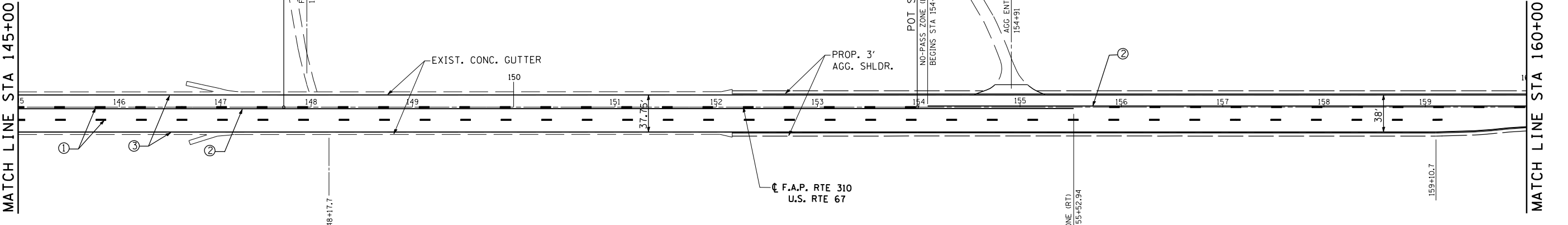
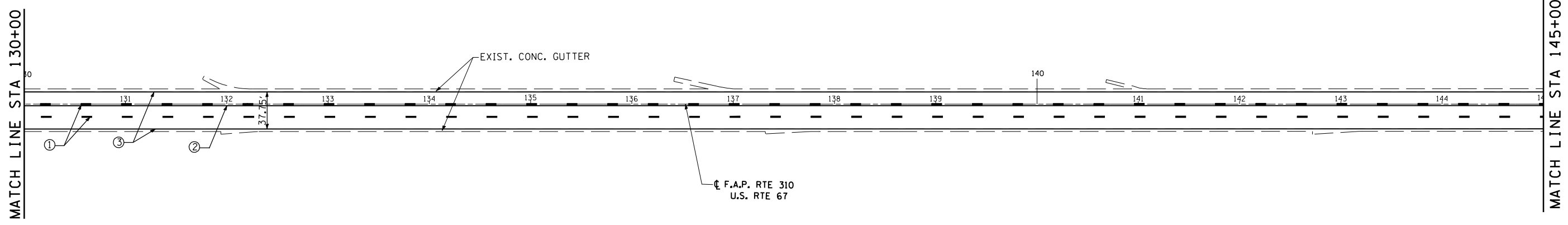

- ① PROPOSED PAINT PAVEMENT MARKING CENTERLINE 5" - SKIP DASH YELLOW
- ② PROPOSED PAINT PAVEMENT MARKING CENTERLINE 5" - SOLID YELLOW
- ③ PROPOSED PAINT PAVEMENT MARKING EDGELINE 5" - SOLID WHITE (12" EITHER SIDE OF CENTERLINE)

REVISIONS	
NAME	DATE

ILLINOIS DEPARTMENT OF TRANSPORTATION  
**ALIGNMENT SCHEMATIC**  
 F. A. P. ROUTE 310 (US 67)  
 SECTION 87 RS-3  
 SCHUYLER COUNTY

SCALE: NOT TO SCALE  
 DATE: NOV, 2003

DRAWN BY: AGG  
 CHECKED BY: MJS

F.A.P. RTE.	SECTION	COUNTY	TOTAL SHEETS	SHEET NO.
310	87 RS-3	SCHUYLER	26	16
STA. 100+00		TO STA.110+00		
FED. ROAD DIST. NO.	ILLINOIS	FED. AID PROJECT		

CONTRACT 72839

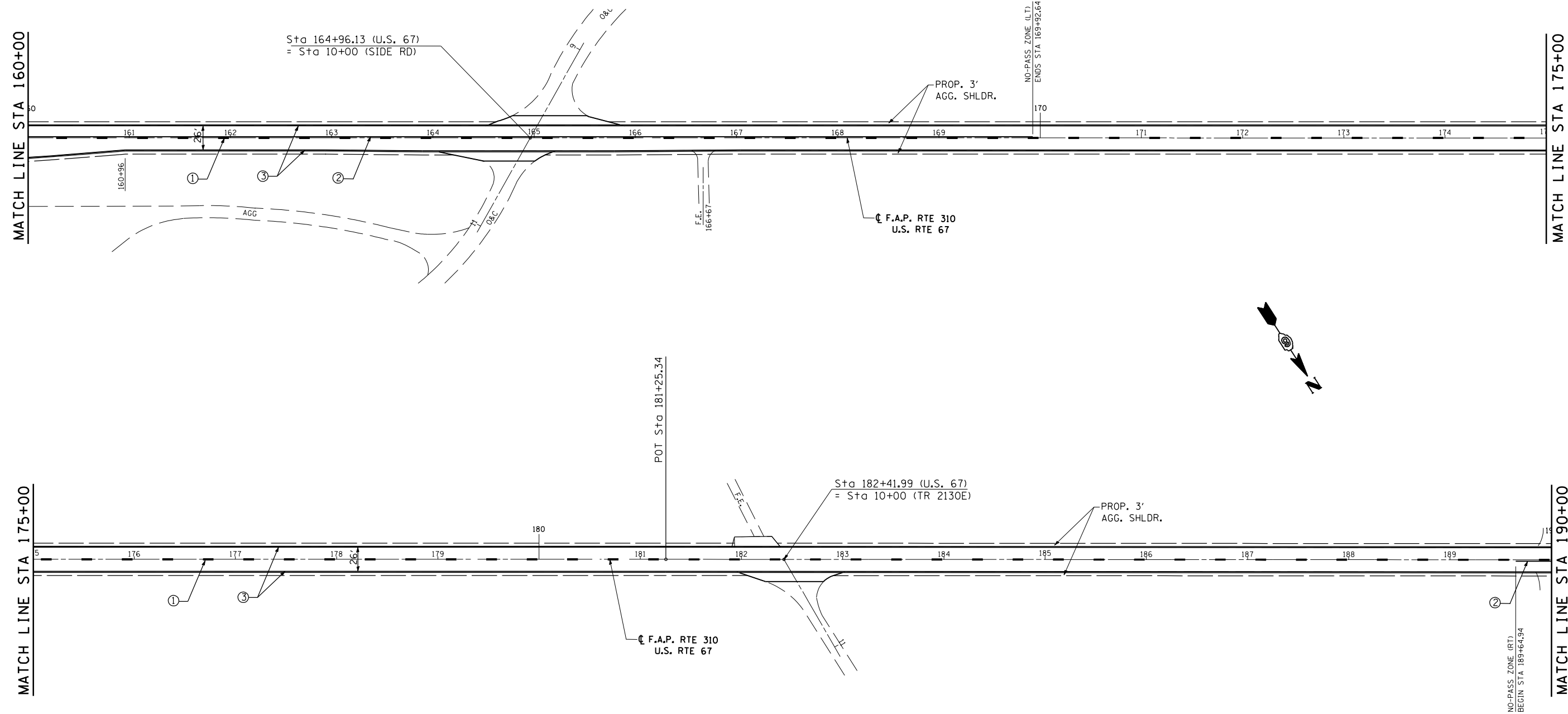

- ① PROPOSED PAINT PAVEMENT MARKING CENTERLINE 5" - SKIP DASH YELLOW
- ② PROPOSED PAINT PAVEMENT MARKING CENTERLINE 5" - SOLID YELLOW
- ③ PROPOSED PAINT PAVEMENT MARKING EDGELINE 5" - SOLID WHITE (12" EITHER SIDE OF CENTERLINE)

REVISIONS	
NAME	DATE

ILLINOIS DEPARTMENT OF TRANSPORTATION  
**ALIGNMENT SCHEMATIC**  
 F. A. P. ROUTE 310 (US 67)  
 SECTION 87 RS-3  
 SCHUYLER COUNTY

SCALE: NOT TO SCALE  
 DATE: NOV, 2003

DRAWN BY: AGG  
 CHECKED BY: MJS



F.A.P. RTE.	SECTION	COUNTY	TOTAL SHEETS	SHEET NO.
310	87 RS-3	SCHUYLER	26	17
STA. 100+00		TO STA. 110+00		
FED. ROAD DIST. NO.	ILLINOIS	FED. AID PROJECT		

CONTRACT 72839

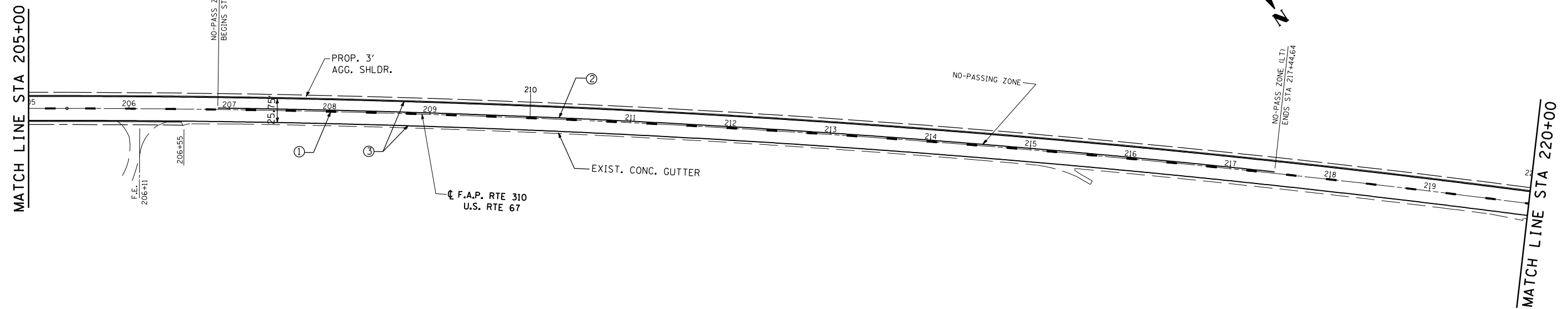
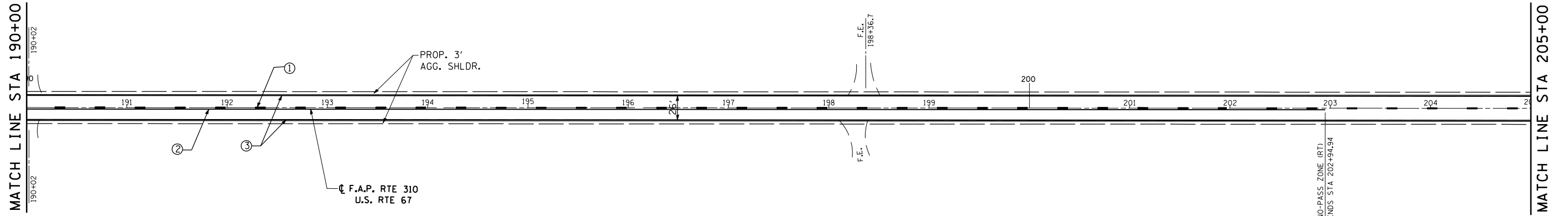

- ① PROPOSED PAINT PAVEMENT MARKING CENTERLINE 5" - SKIP DASH YELLOW
- ② PROPOSED PAINT PAVEMENT MARKING CENTERLINE 5" - SOLID YELLOW
- ③ PROPOSED PAINT PAVEMENT MARKING EDGELINE 5" - SOLID WHITE (12" EITHER SIDE OF CENTERLINE)

REVISIONS	
NAME	DATE

ILLINOIS DEPARTMENT OF TRANSPORTATION  
**ALIGNMENT SCHEMATIC**  
 F. A. P. ROUTE 310 (US 67)  
 SECTION 87 RS-3  
 SCHUYLER COUNTY

SCALE: NOT TO SCALE  
 DATE: NOV, 2003

DRAWN BY: AGG  
 CHECKED BY: MJS

F.A.P. RTE.	SECTION	COUNTY	TOTAL SHEETS	SHEET NO.
310	87 RS-3	SCHUYLER	26	18
STA. 100+00		TO STA.110+00		
FED. ROAD DIST. NO.	ILLINOIS	FED. AID PROJECT		
CONTRACT 72839				

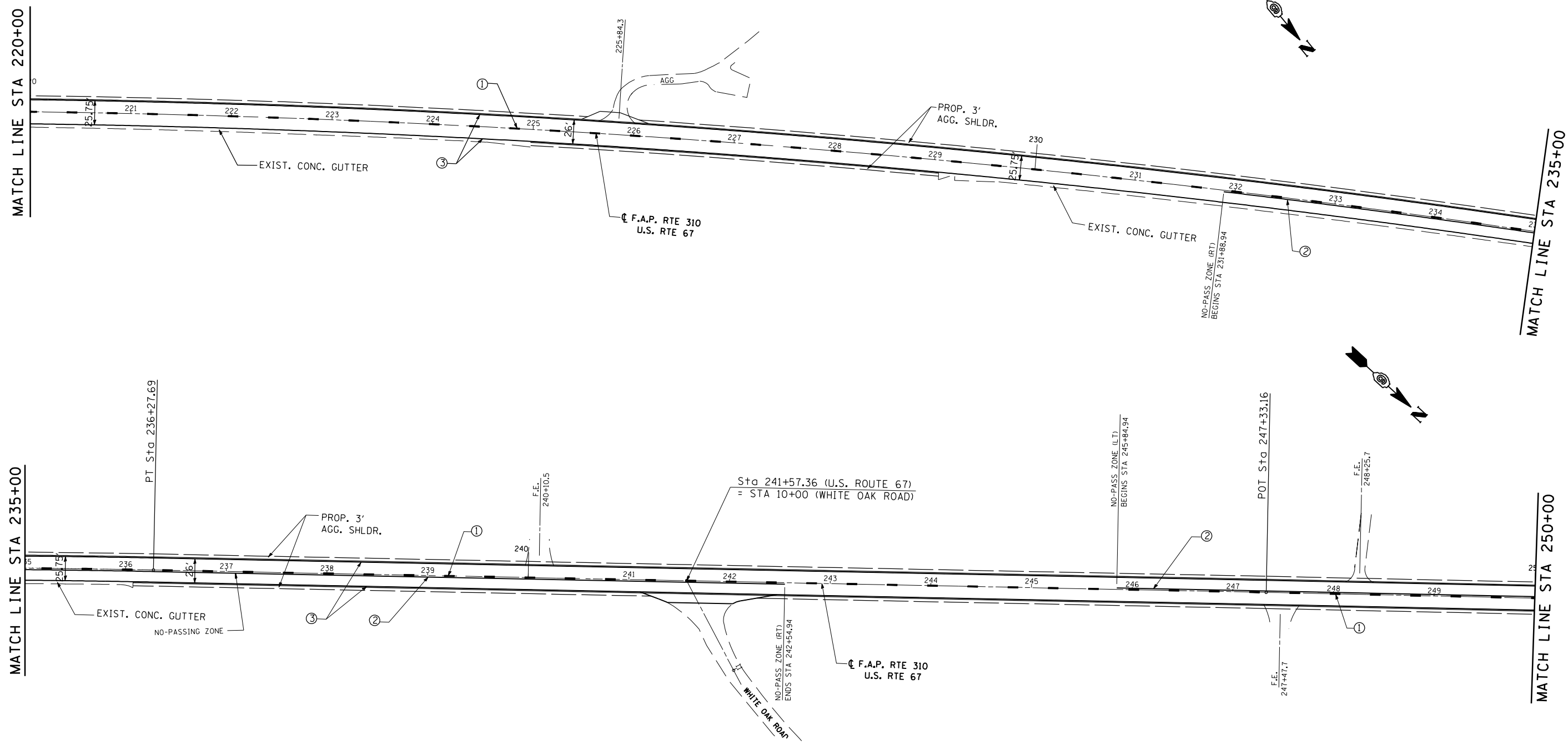

- ① PROPOSED PAINT PAVEMENT MARKING CENTERLINE 5" - SKIP DASH YELLOW
- ② PROPOSED PAINT PAVEMENT MARKING CENTERLINE 5" - SOLID YELLOW
- ③ PROPOSED PAINT PAVEMENT MARKING EDGELINE 5" - SOLID WHITE (12" EITHER SIDE OF CENTERLINE)

REVISIONS	
NAME	DATE

ILLINOIS DEPARTMENT OF TRANSPORTATION  
**ALIGNMENT SCHEMATIC**  
 F. A. P. ROUTE 310 (US 67)  
 SECTION 87 RS-3  
 SCHUYLER COUNTY

SCALE: NOT TO SCALE  
 DATE: NOV, 2003

DRAWN BY: AGG  
 CHECKED BY: MJS

F.A.P. RTE.	SECTION	COUNTY	TOTAL SHEETS	SHEET NO.
310	87 RS-3	SCHUYLER	26	19
STA. 100+00		TO STA.110+00		
FED. ROAD DIST. NO.	ILLINOIS	FED. AID PROJECT		
CONTRACT 72839				

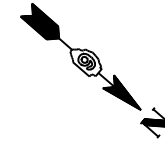

MATCH LINE STA 250+00

MATCH LINE STA 265+00

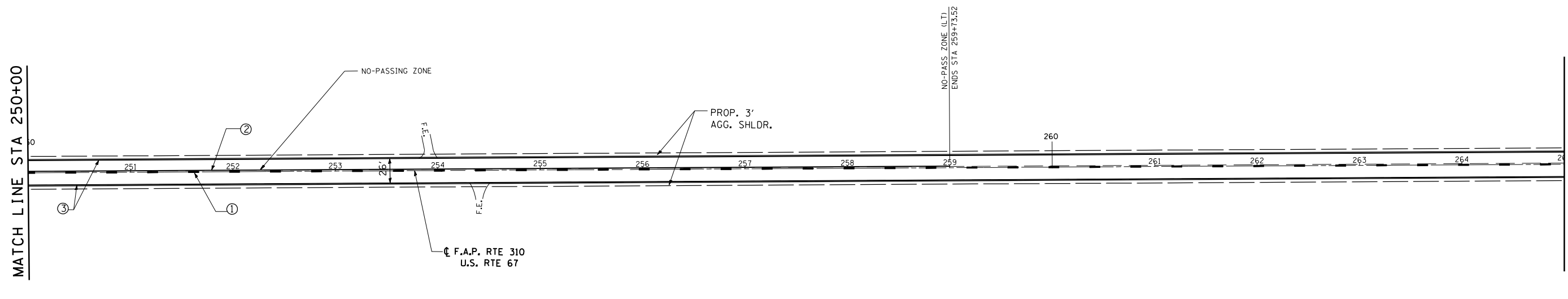

MATCH LINE STA 265+00

MATCH LINE STA 280+00

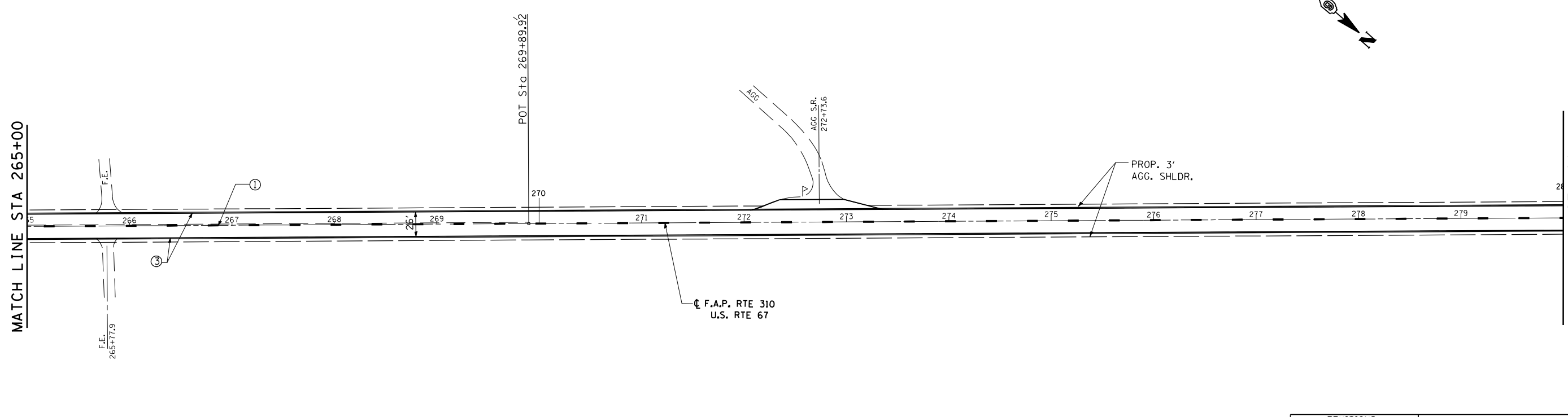

REVISIONS	
NAME	DATE

- ① PROPOSED PAINT PAVEMENT MARKING CENTERLINE 5" - SKIP DASH YELLOW
- ② PROPOSED PAINT PAVEMENT MARKING CENTERLINE 5" - SOLID YELLOW
- ③ PROPOSED PAINT PAVEMENT MARKING EDGELINE 5" - SOLID WHITE (12" EITHER SIDE OF CENTERLINE)

ILLINOIS DEPARTMENT OF TRANSPORTATION  
**ALIGNMENT SCHEMATIC**  
 F. A. P. ROUTE 310 (US 67)  
 SECTION 87 RS-3  
 SCHUYLER COUNTY

SCALE: NOT TO SCALE  
 DATE: NOV, 2003

DRAWN BY: AGG  
 CHECKED BY: MJS

F.A.P. RTE.	SECTION	COUNTY	TOTAL SHEETS	SHEET NO.
310	87 RS-3	SCHUYLER	26	20
STA. 100+00		TO STA. 110+00		
FED. ROAD DIST. NO.	ILLINOIS	FED. AID PROJECT		
CONTRACT 72839				

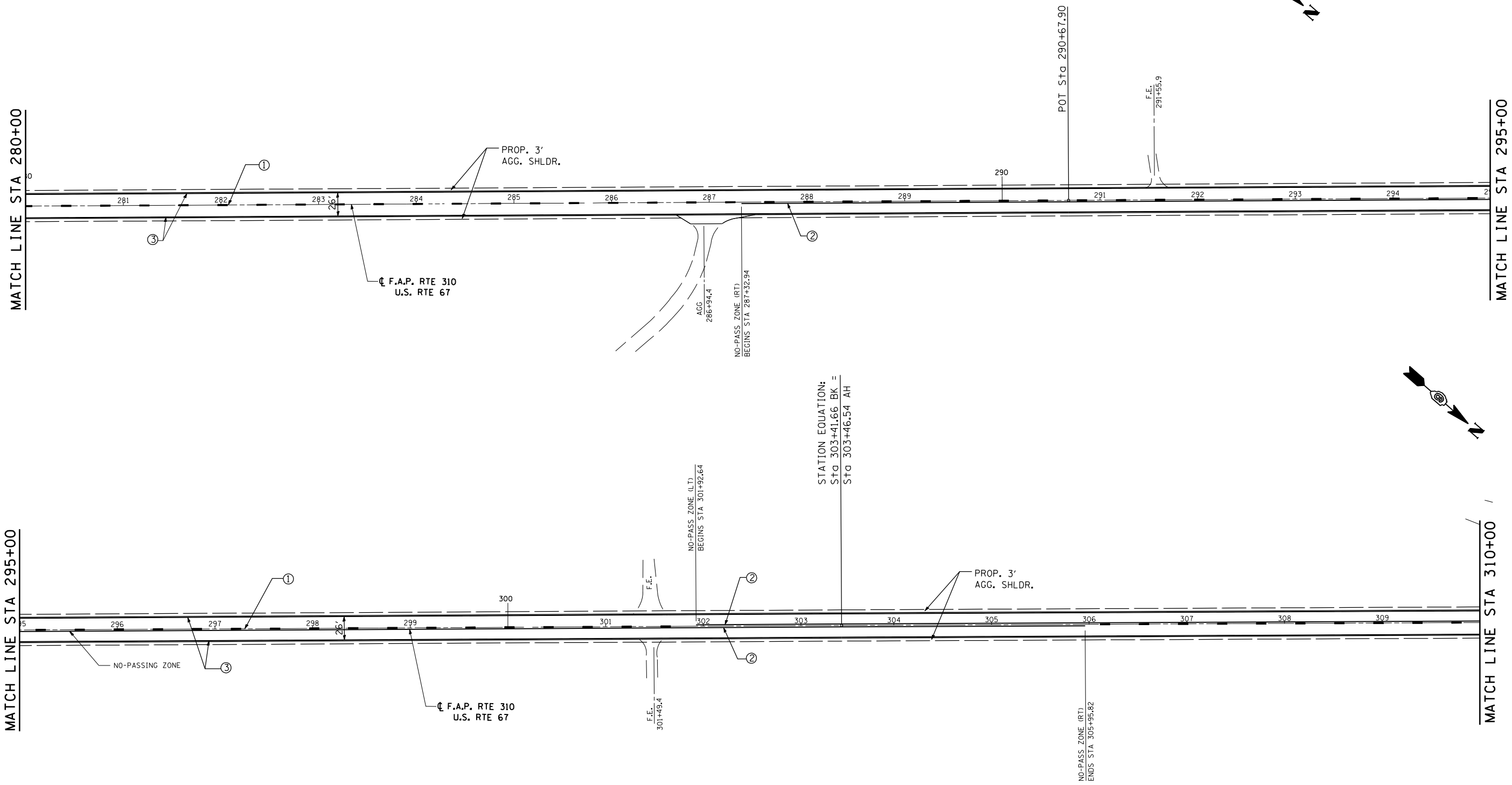

MATCH LINE STA 280+00

MATCH LINE STA 295+00

MATCH LINE STA 295+00

MATCH LINE STA 310+00

- ① PROPOSED PAINT PAVEMENT MARKING CENTERLINE 5" - SKIP DASH YELLOW
- ② PROPOSED PAINT PAVEMENT MARKING CENTERLINE 5" - SOLID YELLOW
- ③ PROPOSED PAINT PAVEMENT MARKING EDGELINE 5" - SOLID WHITE (12" EITHER SIDE OF CENTERLINE)

REVISIONS	
NAME	DATE

ILLINOIS DEPARTMENT OF TRANSPORTATION  
**ALIGNMENT SCHEMATIC**  
 F. A. P. ROUTE 310 (US 67)  
 SECTION 87 RS-3  
 SCHUYLER COUNTY

SCALE: NOT TO SCALE  
 DATE: NOV, 2003

DRAWN BY AGG  
 CHECKED BY MJS

F.A.P. RTE.	SECTION	COUNTY	TOTAL SHEETS	SHEET NO.
310	87 RS-3	SCHUYLER	26	21
STA. 100+00		TO STA. 110+00		
FED. ROAD DIST. NO.	ILLINOIS	FED. AID PROJECT		
CONTRACT 72839				

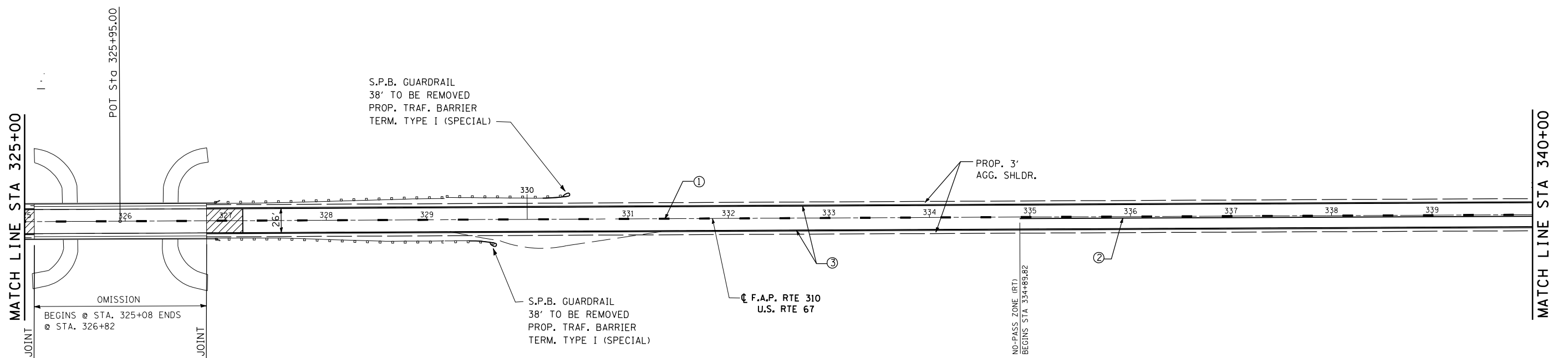
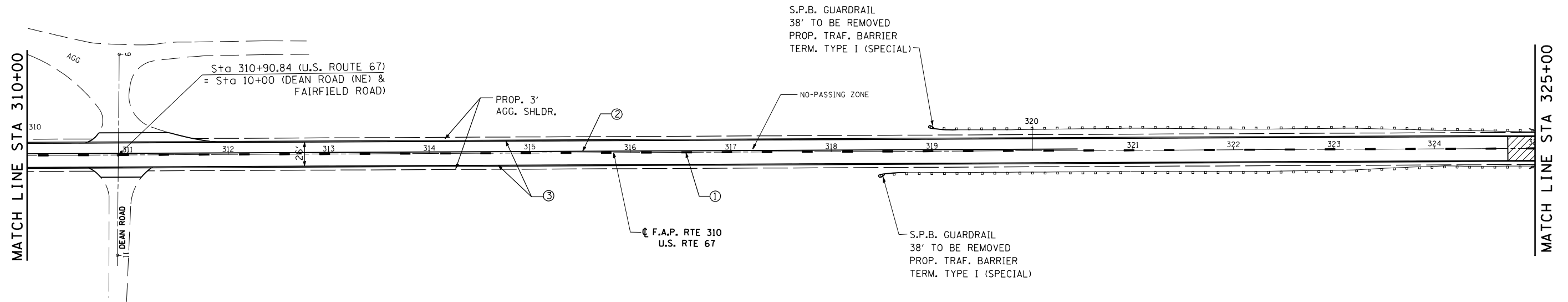

- ① PROPOSED PAINT PAVEMENT MARKING CENTERLINE 5" - SKIP DASH YELLOW
- ② PROPOSED PAINT PAVEMENT MARKING CENTERLINE 5" - SOLID YELLOW
- ③ PROPOSED PAINT PAVEMENT MARKING EDGELINE 5" - SOLID WHITE (12" EITHER SIDE OF CENTERLINE)

REVISIONS	
NAME	DATE

ILLINOIS DEPARTMENT OF TRANSPORTATION  
**ALIGNMENT SCHEMATIC**  
 F. A. P. ROUTE 310 (US 67)  
 SECTION 87 RS-3  
 SCHUYLER COUNTY

SCALE: NOT TO SCALE  
 DATE: NOV, 2003

DRAWN BY: AGG  
 CHECKED BY: MJS

F.A.P. RTE.	SECTION	COUNTY	TOTAL SHEETS	SHEET NO.
310	87 RS-3	SCHUYLER	26	22
STA. 100+00		TO STA. 110+00		
FED. ROAD DIST. NO.	ILLINOIS	FED. AID PROJECT		
CONTRACT 72839				

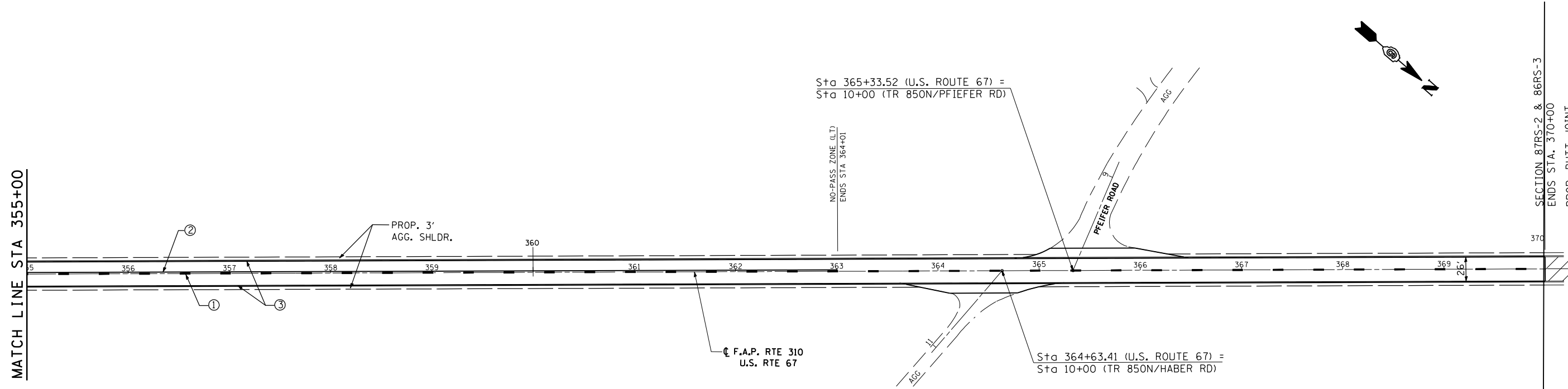
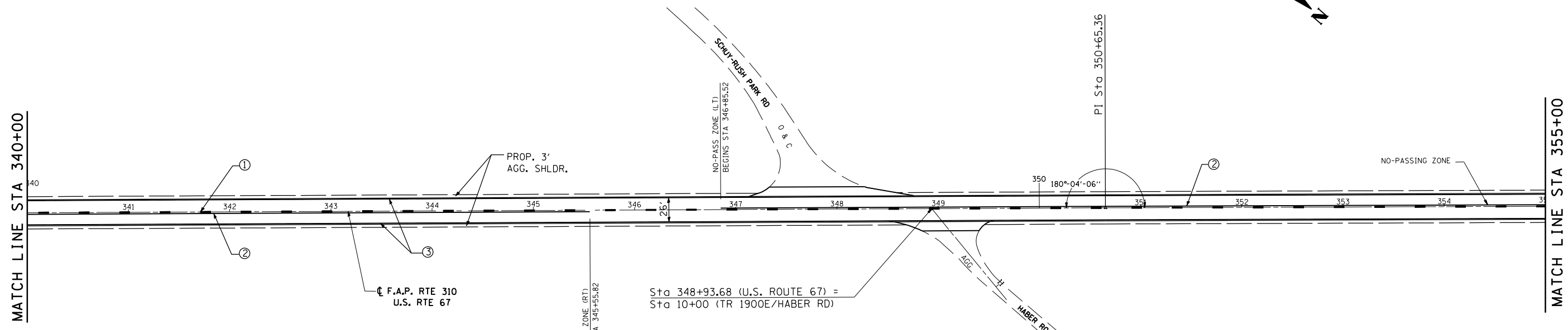

- ① PROPOSED PAINT PAVEMENT MARKING CENTERLINE 5" - SKIP DASH YELLOW
- ② PROPOSED PAINT PAVEMENT MARKING CENTERLINE 5" - SOLID YELLOW
- ③ PROPOSED PAINT PAVEMENT MARKING EDGELINE 5" - SOLID WHITE (12" EITHER SIDE OF CENTERLINE)

REVISIONS	
NAME	DATE

ILLINOIS DEPARTMENT OF TRANSPORTATION  
**ALIGNMENT SCHEMATIC**  
 F. A. P. ROUTE 310 (US 67)  
 SECTION 87 RS-3  
 SCHUYLER COUNTY

SCALE: NOT TO SCALE  
 DATE: NOV, 2003

DRAWN BY: AGG  
 CHECKED BY: MJS

F.A.P. RTE.	SECTION	COUNTY	TOTAL SHEETS	SHEET NO.
310	87 RS-3	SCHUYLER	26	23
STA. 69+70		TO STA. 370+00		
FED. ROAD DIST. NO.	ILLINOIS	FED. AID PROJECT		
CONTRACT 72839				

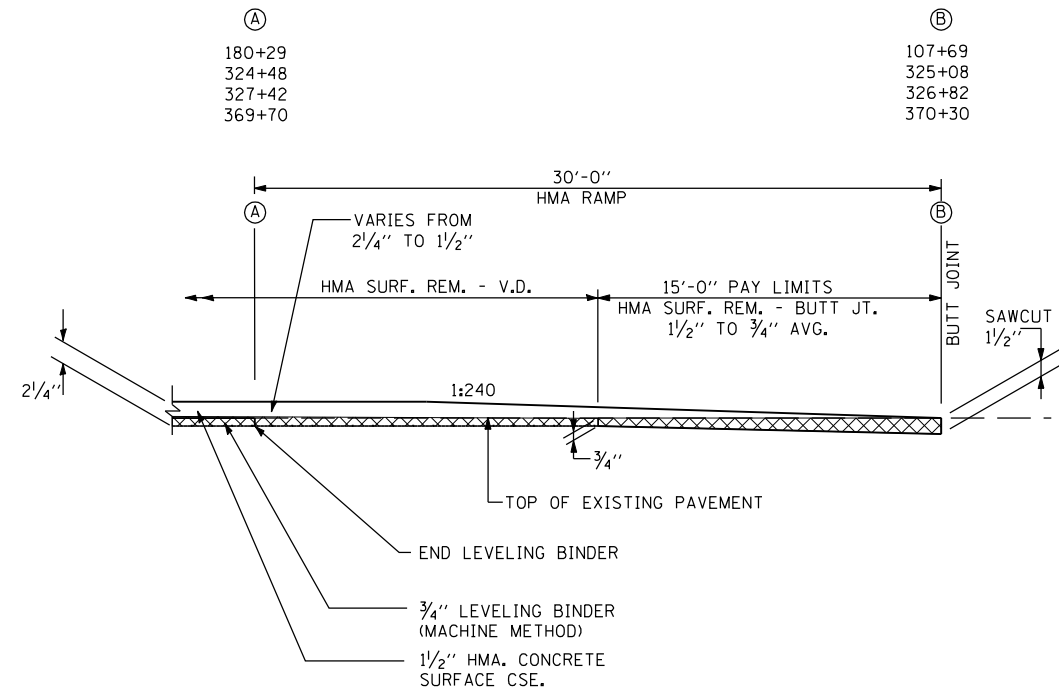

**TYPICAL TAPER DETAIL**  
(AT LIMITS OF PROJECT AND PROJECT OMISSIONS)

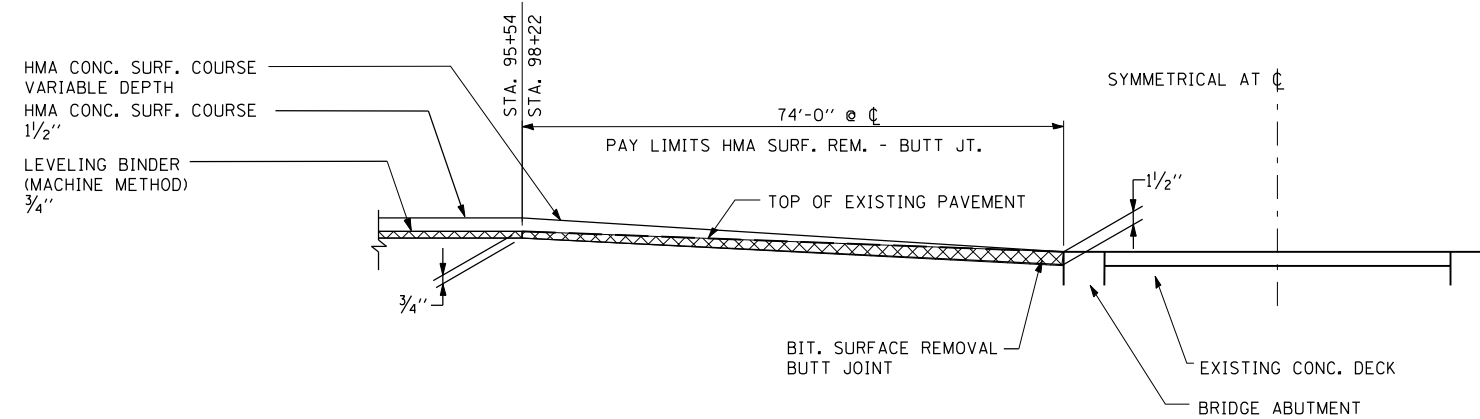

**TYPICAL TAPER DETAIL**  
(AT BRIDGE #085-0002)

REVISIONS	
NAME	DATE

ILLINOIS DEPARTMENT OF TRANSPORTATION  
**BUTT JOINT AND TAPER DETAILS**  
 F. A. P. ROUTE 310 (US 67)  
 SECTION 87 RS- & 86 RS-3  
 SCHUYLER COUNTY

SCALE: NOT TO SCALE  
 DATE: NOV, 2003  
 DRAWN BY: AGG  
 CHECKED BY: MJS

F.A.P. RTE.	SECTION	COUNTY	TOTAL SHEETS	SHEET NO.
310	87 RS-3	SCHUYLER	26	24
STA. 69+70		TO STA.370+00		
FED. ROAD DIST. NO. 6		ILLINOIS	FED. AID PROJECT	
CONTRACT 72839				

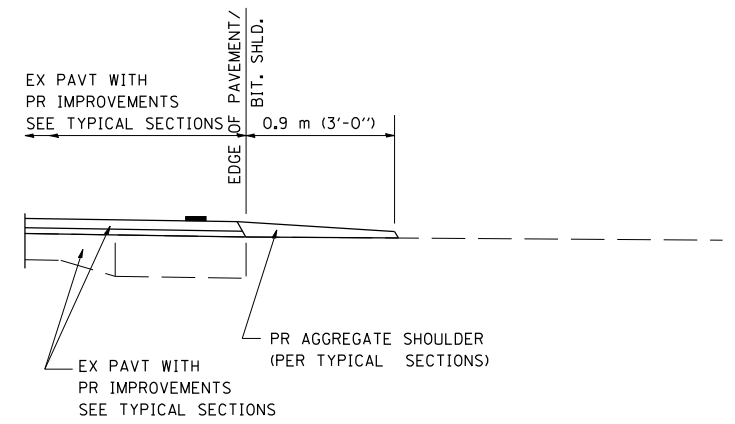

**SECTION A-A FOR EX EARTH/AGGREGATE FE**

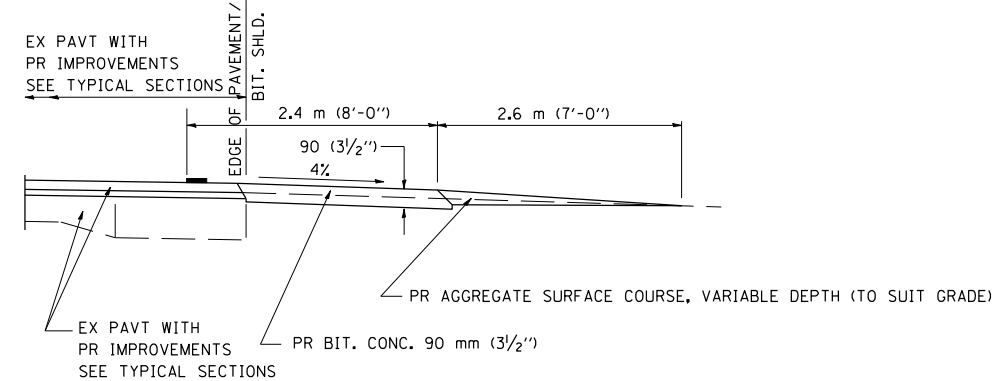

**SECTION A-A FOR EX EARTH/AGGREGATE PE**

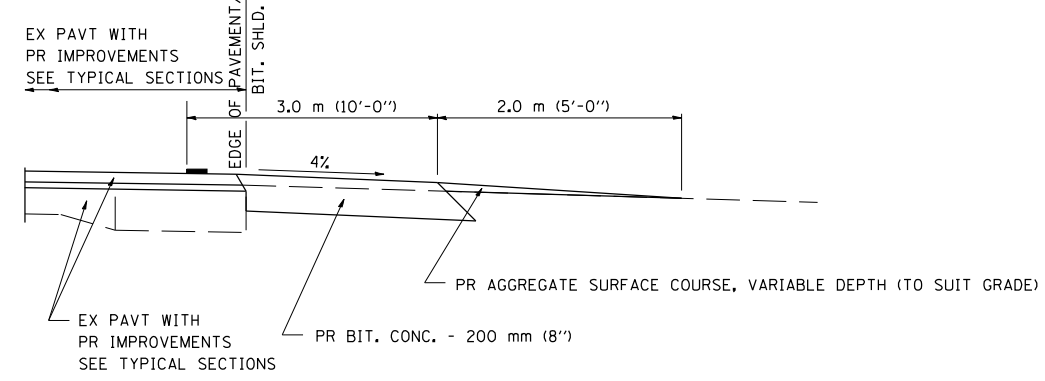

**SECTION A-A FOR EX EARTH/AGGREGATE CE & SIDE ROAD**

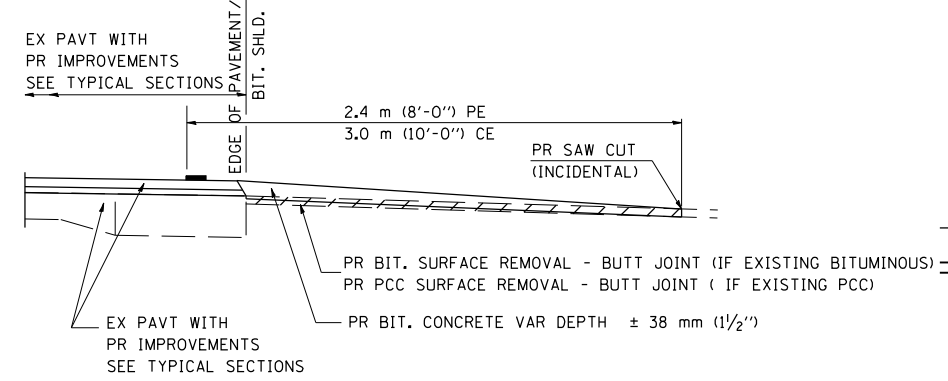

**SECTION A-A FOR EX BITUMINOUS/ PC CONCRETE PE, CE & SIDE ROAD**

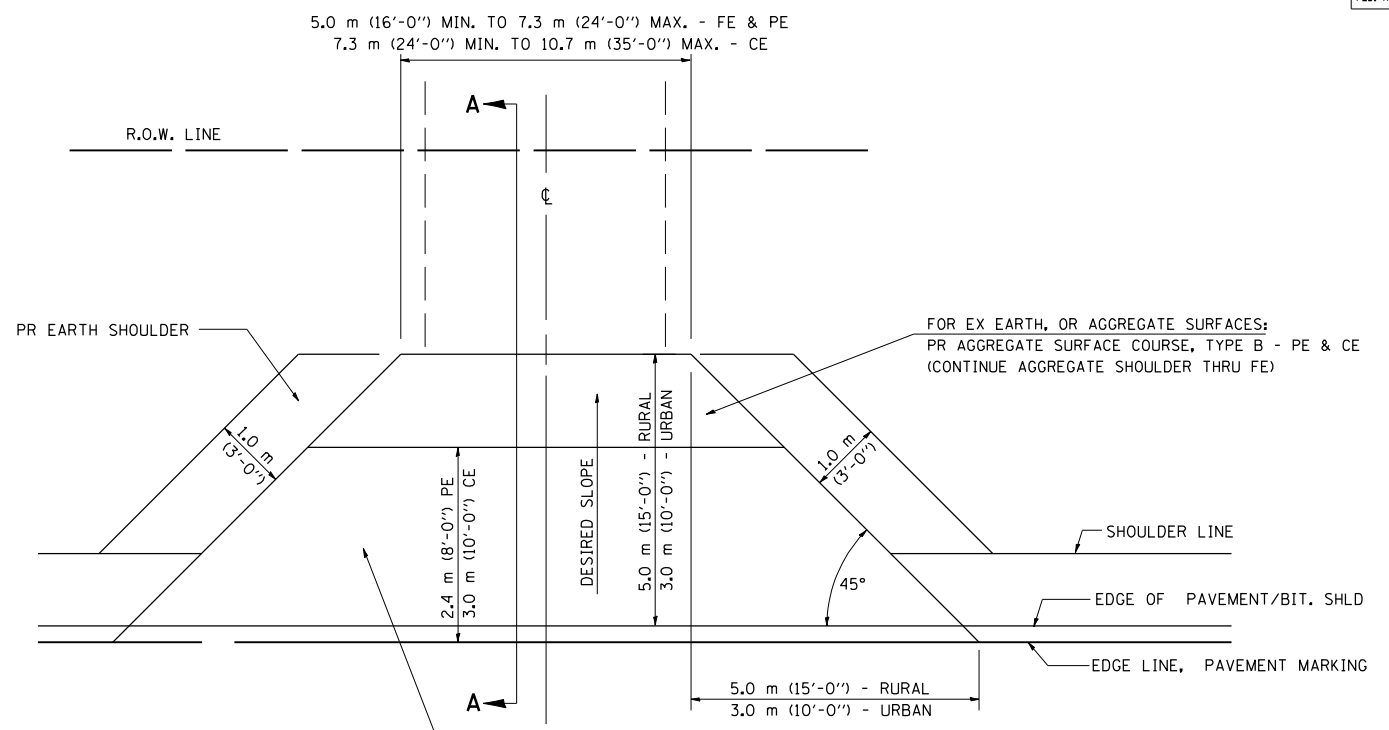

FOR EX EARTH OR AGGREGATE SURFACES:  
 PR BIT SURFACE REMOVAL (IF APPLICABLE)  
 PR AGGREGATE SHOULDER THRU - FE  
 PR BITUMINOUS CONCRETE 90 mm (3 1/2") - PE  
 PR BITUMINOUS CONCRETE 200mm (8") - CE

FOR EX BITUMINOUS CONCRETE SURFACES:  
 PR BITUMINOUS SURFACE REMOVAL-BUTT JOINT

FOR EX PCC SURFACES:  
 PR PCC SURFACE REMOVAL-BUTT JOINT

**GENERAL NOTES:**

THE RESIDENT ENGINEER WILL DETERMINE THE EXACT TYPE OF IMPROVEMENT TO BE COMPLETED FOR ALL ENTRANCES, SIDEROADS AND MAILBOX TURNOUTS ON THIS PROJECT.

THE PLAN DETAILS AND SCHEDULES SHOULD BE USED AS A GUIDE FOR THE ENGINEER TO IMPLEMENT THE FINAL DESIGN. THE ENGINEER MAY DECIDE TO SALVAGE PORTIONS OF THE EXISTING ENTRANCE PAVEMENT STRUCTURE; THEREFORE, REDUCING PAY ITEM QUANTITIES. NO ADDITIONAL PAYMENT WILL BE ALLOWED FOR THIS REDUCTION IN QUANTITIES.

ANY WORK THE ENGINEER REQUIRES WHICH IS NOT COVERED BY A PAY ITEM CONTAINED IN THE PLANS WILL BE PAID FOR IN ACCORDANCE WITH ARTICLE 109.04 OF THE STANDARD SPECIFICATIONS.

BITUMINOUS CONCRETE REQUIRED TO CONSTRUCT THE ENTRANCES SHALL BE IN ACCORDANCE WITH THE APPLICABLE PORTIONS OF SECTION 406 AND 408 OF THE STANDARD SPECIFICATIONS AND AS DIRECTED BY THE ENGINEER.

WHEN THE BITUMINOUS CONCRETE PROPOSED FOR THE IMPROVEMENT IS THICKER THAN 75 mm (3 INCHES) AND REQUIRE PLACEMENT IN MORE THAN ONE LIFT, THE BOTTOM LIFT(S) SHALL MEET THE REQUIREMENTS OF BITUMINOUS BASE COURSE IN SECTION 406 OF THE STANDARD SPECIFICATIONS AND THE TOP LIFT OF 50 mm (2 INCHES) SHALL MEET THE REQUIREMENTS OF BITUMINOUS CONCRETE SURFACE COURSE, SUPERPAVE.

THIS WORK WILL BE PAID FOR IN ACCORDANCE WITH SECTIONS 351, 358, 408, 423 AND 440 OF THE STANDARD SPECIFICATIONS.

ALL DIMENSIONS ARE IN MILLIMETERS ( INCHES ) UNLESS OTHERWISE SHOWN.

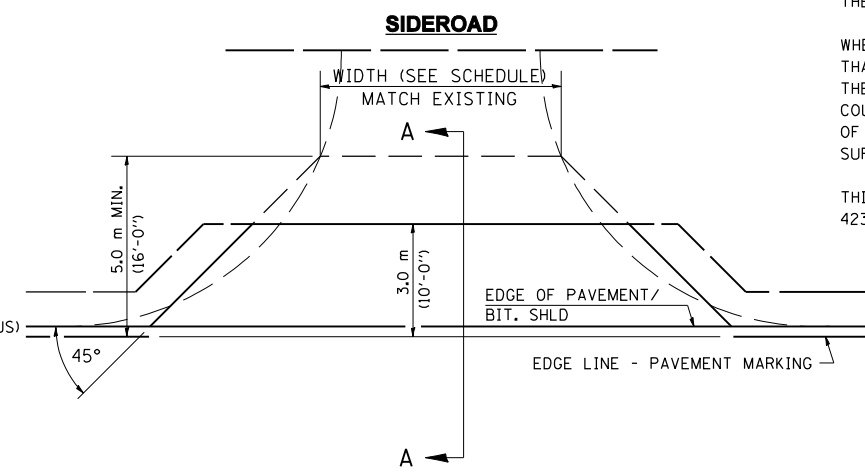

NOTE : IF BIT. SHLDS ARE PROPOSED THEY SHOULD NOT EXTEND THROUGH SIDEROADS

REVISIONS	
NAME	DATE
JCN	2/19/03

**SHEET 1 OF 3**

ILLINOIS DEPARTMENT OF TRANSPORTATION  
**DISTRICT SIX**  
**DETAILS FOR RURAL / URBAN**  
**ENTRANCE, MAILBOX TURNOUT**  
**& SIDEROADS**  
**W / O CONCRETE GUTTER**  
**(PPP - PROJECTS)**

SCALE: VERT.      DRAWN BY CADD  
 HORIZ.              CHECKED BY JCN  
 DATE: FEBRUARY 23, 1999

ENT PPP



## DETAILS OF MAILBOX TURNOUTS

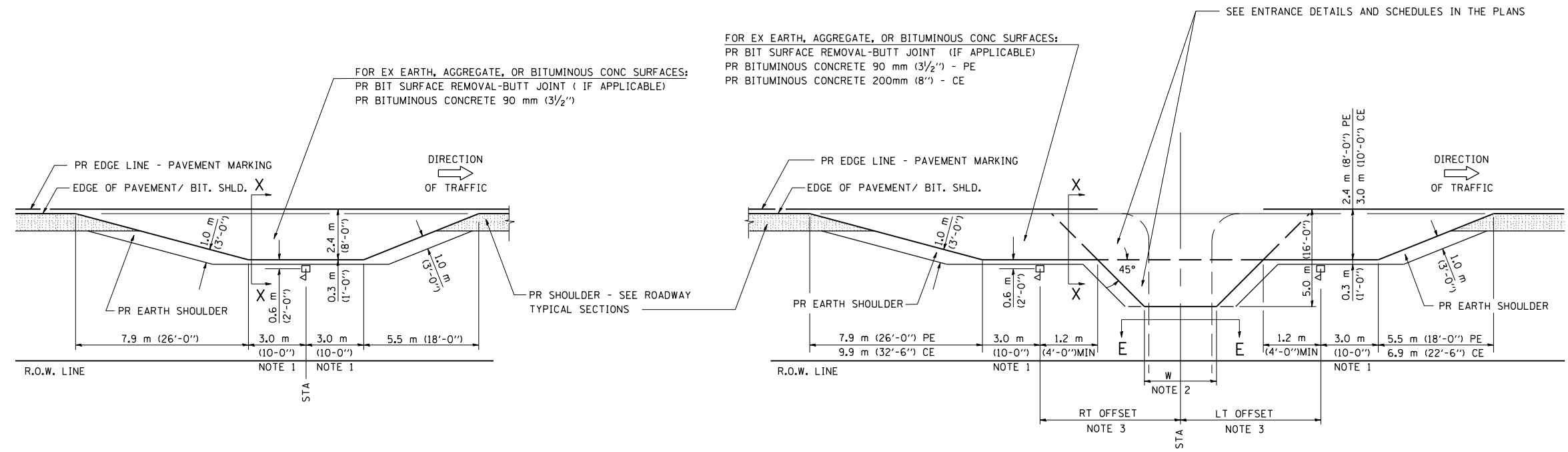

**PLAN - MAILBOX TURNOUTS**

**PLAN - COMBINED MAILBOX TURNOUT WITH TRAILING OR LEADING ENTRANCE**

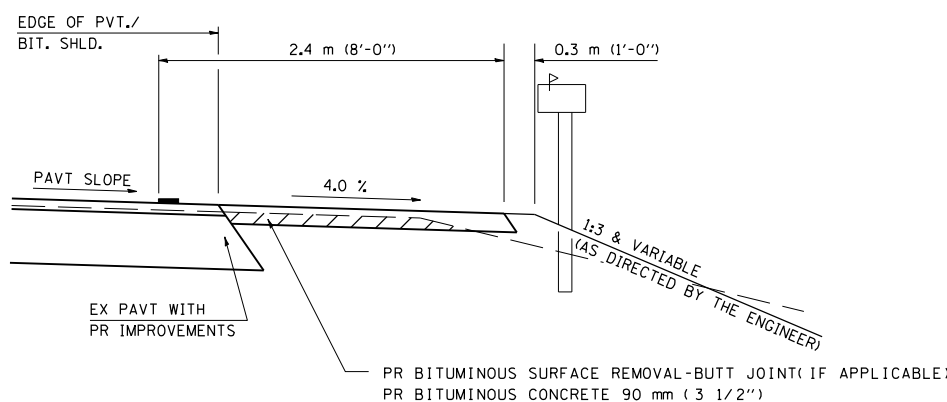

**SECTION X-X THRU MAILBOX TURNOUT  
 ALSO APPLIES TO MAILBOX TURNOUTS COMBINED WITH  
 EX EARTH, AGGREGATE, OR BITUMINOUS PE & FE**

( DETAIL APPLIES WHEN M.B. TURNOUT DOES NOT EXIST.  
 IF EXISTING, TREAT SAME AS ENTRANCE. )

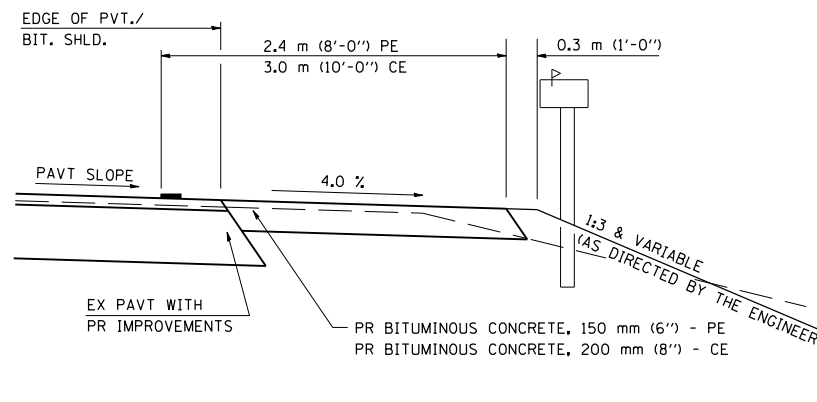

**SECTION X-X THRU MAILBOX TURNOUT  
 COMBINED WITH EX BITUMINOUS CONC & PC CONC PE & CE**

( DETAIL APPLIES WHEN M.B. TURNOUT DOES NOT EXIST.  
 IF EXISTING, TREAT SAME AS ENTRANCE. )

- NOTE 1 IF MORE THAN ONE MAILBOX IS PRESENT, DIMENSION FROM CENTER OF END MAILBOX.
- NOTE 2 FOR ENTRANCE LAYOUT DIMENSIONS AND SECTIONS A-A & E-E REFER TO THE SCHEDULES IN THE PLANS.
- NOTE 3 BOTH LT OR RT OFFSETS FOR MAILBOX SHOWN USE OFFSET DIMENSION PER SCHEDULE AND REFER TO LAYOUT SHOWN ON THE PLAN.

ALL DIMENSIONS ARE IN MILLIMETERS ( INCHES )  
 UNLESS OTHERWISE SHOWN.

SHEET 2 OF 3

REVISIONS	
NAME	DATE
JCN	2/19/03

ILLINOIS DEPARTMENT OF TRANSPORTATION  
**DISTRICT SIX**  
**DETAILS FOR RURAL / URBAN**  
**ENTRANCE, MAILBOX TURNOUT**  
**& SIDEROADS**  
**W / O CONCRETE GUTTER**  
**(PPP - PROJECTS)**

SCALE: VERT.      DRAWN BY CADD  
 HORIZ.              CHECKED BY JCN  
 DATE: FEBRUARY 23, 1999

ENT PPP

CONTRACT 72839

ENTRANCE IMPROVEMENT SCHEDULE FOR RURAL / URBAN "PPP" PROJECTS

LOCATION (LT / RT) (STA) ( + )	TYPE OF ENTRANCE (FE / PE / CE / MB) (RURAL / URBAN)	EX MATERIAL TYPE (EARTH / AGG. / BIT. / P.C.C.)	WIDTH AT EDGE OF PAVEMENT FOOT	RT OFFSET FOOT	LT OFFSET FOOT	LENGTH (FROM EDGE OF PVT/ BIT SHLD TO LIMITS OF IMPROVEMENT) FOOT	PR BIT. CONC. THICKNESS INCH	BIT. SURF. REM. - BUTT JOINT SQ. YD.	P.C.C. SURF. REM. - BUTT JOINT SQ. YD.	PREP OF BASE SQ. YD.	AGG. BASE REPAIR TON	AGGREGATE SURFACE COURSE TY - B TON	BIT (P.C.) TON	AGG (P.C.) TON	INCIDENTAL BIT. SURF. TON	
LT 91+00(N)	FE					3										
RT 91+00(N)	FE					3										
LT 98+13 (RELOC.)	FE	AGG	46			3										
LT 154+91	PE		46			7	3.5			30		2.0	0.04	0.06	5.9	
RT 166+67	FE					3										
LT 182+28	FE	BIT/AGG	46			7	3.0 TO 1.5			30		2.0	0.04	0.06	4.0	
LT 190+02	FE					3										
RT 190+02	FE					3										
RT 198+10	FE					3										
LT 198+36.7	FE	AGG				3										
RT 206+11	FE					3										
LT 225+84.3	PE/MB		59			7	3.5			40		2.0	0.06	0.08	7.9	
LT 240+10.5	FE					3										
RT 247+47.7	FE					3										
LT 248+25.7	FE					3										
LT 253+95	FE					3										
RT 254+40	FE					3										
RT 265+77.9	FE	AGG				3										
LT 265+80	FE					3										
RT 286+94.4	PE		46			7	3.5			30		2.0	0.04	0.06	5.9	
LT 291+55.9	FE					3										
LT 301+49.4	FE					3										
RT 301+49.4	FE					3										
<b>SIDE ROADS</b>																
LT 104+58.29	SR	OIL/CHIP	89			9	3.0 TO 1.5	88					0.13	0.18	11.1	
RT 104+58.29	SR	OIL/CHIP	66			9	3.0 TO 1.5	62					0.09	0.13	7.8	
LT 164+96.13	SR	OIL/CHIP	77			9	3.0 TO 1.5	74					0.11	0.15	9.3	
RT 164+96.13	SR	OIL/CHIP	59			9	3.0 TO 1.5	54					0.08	0.11	6.8	
RT 182+41.99	SR	AGG	61			9	3.0 TO 1.5	57					0.08	0.12	7.2	
LT 241+57.36	SR	AGG	70			9	3.0 TO 1.5	67					0.10	0.14	8.4	
LT 272+73.60	SR/MB	AGG	48			9	3.0 TO 1.5	42					0.06	0.08	5.3	
LT 310+90.84	SR	AGG	69			9	3.0 TO 1.5	66					0.10	0.13	8.4	
RT 310+90.84	SR	AGG	53			9	3.0 TO 1.5	48					0.07	0.10	6.0	
LT 347+92	SR	OIL/CHIP	96			9	3.0 TO 1.5	96					0.14	0.20	12.2	
RT 348+93.68	SR	AGG	64			9	3.0 TO 1.5	60					0.09	0.12	7.7	
RT 364+63.41	SR	AGG	63			9	3.0 TO 1.5	59					0.09	0.12	7.5	
LT 365+33.52	SR	AGG	80			9	3.0 TO 1.5	78					0.11	0.16	9.9	
TOTAL =								851		130		43.0	1.43	2.0	131.3	

ENT PPP

REVISIONS	
NAME	DATE

ILLINOIS DEPARTMENT OF TRANSPORTATION  
DISTRICT SIX  
SCHEDULES FOR RURAL / URBAN  
ENTRANCE, MAILBOX TURNOUT  
& SIDEROADS  
W / O CONCRETE GUTTER  
(PPP - PROJECTS)

SCALE: VERT. NONE  
HORIZ.  
DATE

DRAWN BY  
CHECKED BY