

F.A.U. RTE.	SECTION	COUNTY	TOTAL SHEETS	SHEET NO.
7706		LOGAN	111	34
STA.		TO STA.		
FED. ROAD DIST. NO.	ILLINOIS	FED. AID PROJECT		

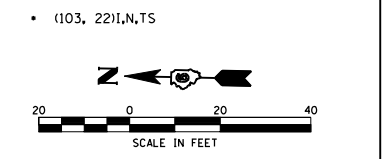

STA. 1758+07.50 END  
 SEC. (103, 22)I,N,TS IMPROVEMENT  
 OLD U.S. 66 / LINCOLN PARKWAY

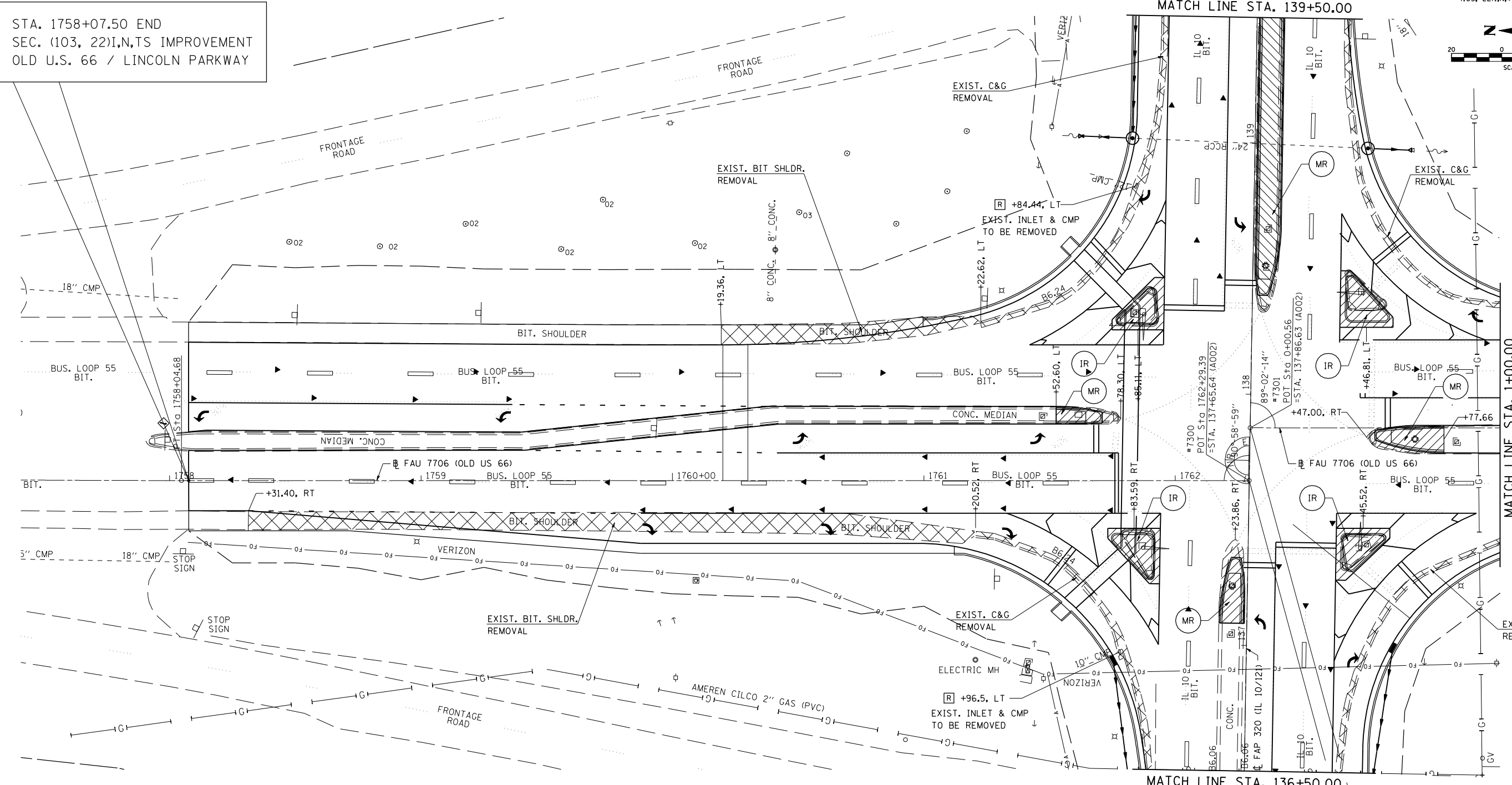

MATCH LINE STA. 139+50.00

MATCH LINE STA. 1+00.00

MATCH LINE STA. 136+50.00

STA. 137+86.63 (IL 10/121/WOODLAWN AVENUE) =  
 STA. 0+00.56 (OLD US 66/LINCOLN PARKWAY)  
 STA. 137+65.64 (IL 10/121/WOODLAWN AV. =  
 STA. 1762+29.39 (OLD U.S. 66/LINCOLN PKWY)

**LEGEND**

- (IR) ISLAND REMOVAL
- (MR) MEDIAN REMOVAL

REVISIONS	
NAME	DATE

ILLINOIS DEPARTMENT OF TRANSPORTATION  
**REMOVAL ITEMS**  
 F.A.U. 7706 (LINCOLN PKWY)  
 SECTION (103, 22) I,N,TS  
 LOGAN COUNTY  
 SCALE: VERT. / HORIZ.  
 DATE: 03-16-05  
 DRAWN BY: TMJ  
 CHECKED BY: VTY

PLOT DATE = 3/20/2007  
 FILE NAME = c:\projects\653384\shplan\m\166.dgn  
 PLOT SCALE = 42,352% / IN.  
 USER NAME = laughlin-1