

F.A.P. RTE.	SECTION	COUNTY	TOTAL SHEETS	SHEET NO.
320	(103, 22) I, N, TS	LOGAN	111	75
STA.		TO STA.		
FED. ROAD DIST. NO.		ILLINOIS FED. AID PROJECT		

STA. 133+71.35 BEGIN
SEC. (103, 22) I,N,TS IMPROVEMENT
IL 10/121/WOODLAWN RD.

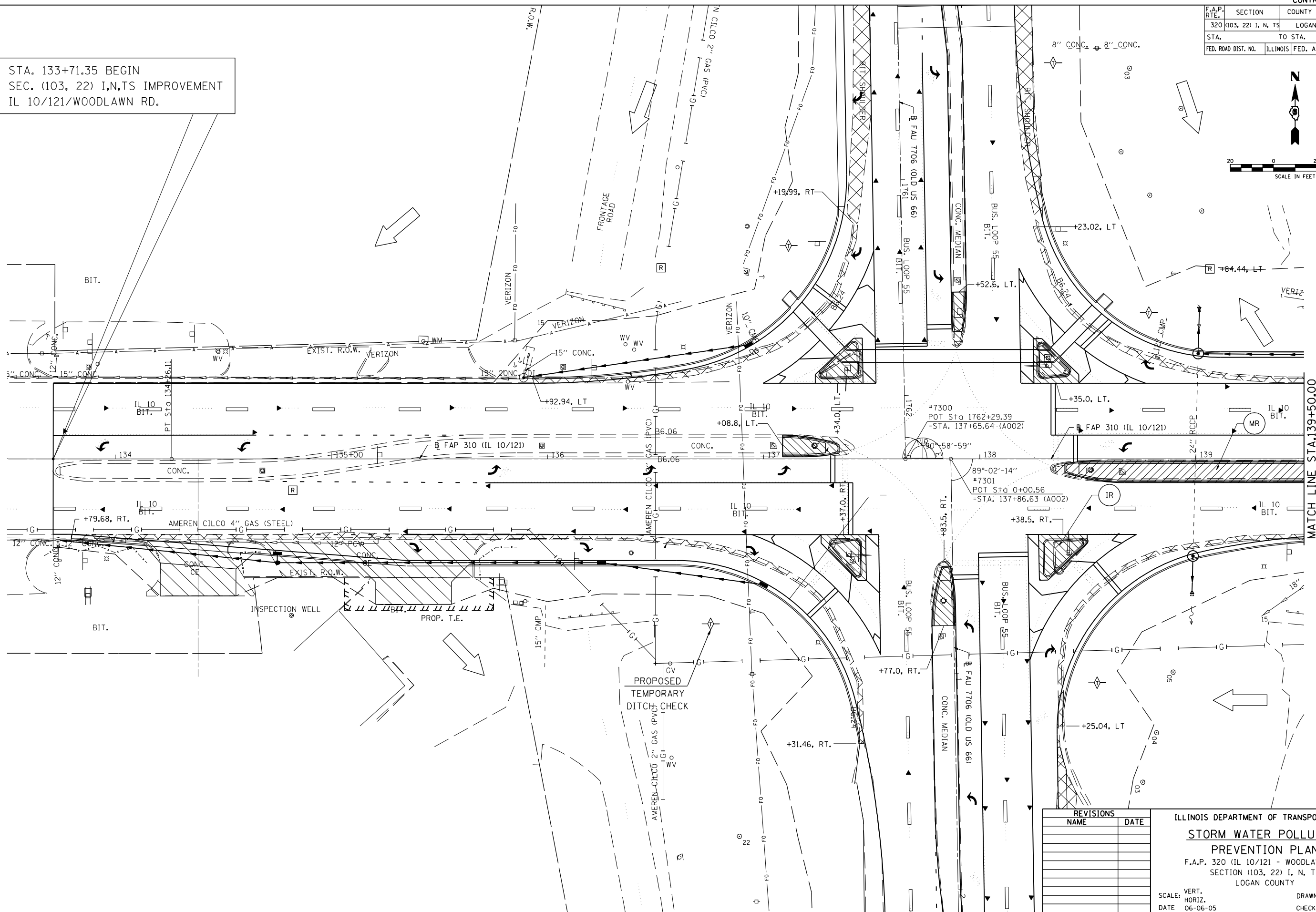
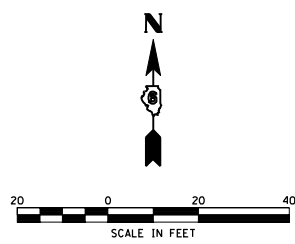

MATCH LINE STA.139+50.00

REVISIONS	
NAME	DATE

ILLINOIS DEPARTMENT OF TRANSPORTATION
STORM WATER POLLUTION PREVENTION PLAN
F.A.P. 320 (IL 10/121 - WOODLAWN RD.)
SECTION (103, 22) I, N, TS
LOGAN COUNTY

SCALE: VERT. 1"=10'
HORIZ. 1"=40'
DATE: 06-06-05

DRAWN BY: TMJ
CHECKED BY: VTY

PLOT DATE = 3/26/2007
 FILE NAME = c:\projects\665338A\shp\ppr110.dgn
 PLOT SCALE = 42.3525' / IN.
 REFERENCE = #REF#