

FOR INDEX OF SHEETS AND HIGHWAY
STANDARDS, SEE SHEET 2.

STATE OF ILLINOIS
DEPARTMENT OF TRANSPORTATION
DIVISION OF HIGHWAYS
**PLANS FOR PROPOSED
CONTRACT MAINTENANCE**
FAP ROUTE 304 (IL 96)
SECTION 4RS-4
PIKE COUNTY
C96-005-08 / D96-016-07

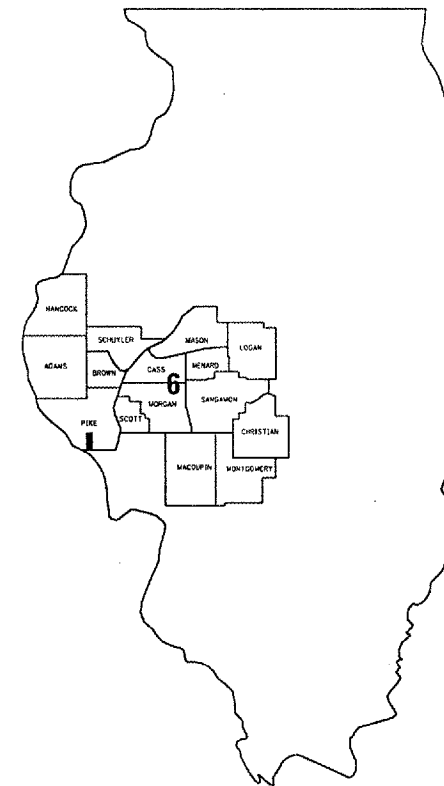

LOCATION OF SECTION INDICATED THUS: ■

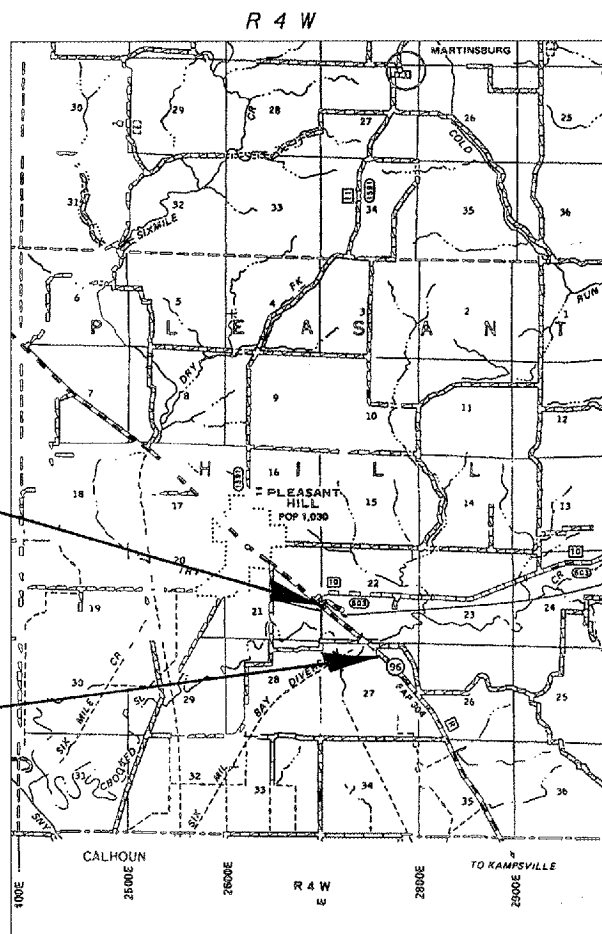

BEGIN PROJECT
STA. 1306+99

END PROJECT
STA. 1348+29

BRIDGE OMISSION
STA. 1310+27 TO 1313+77
STA. 1334+96 TO 1340+29

J. U. L. I. E.
JOINT UTILITY LOCATION INFORMATION FOR EXCAVATION
1-800-892-0123

PLANS & CONTRACT TECHNICIAN: TIMOTHY SHARP
PHONE: (217) 782-7743

GROSS LTH OF SEC 4,130.00 FT = 0.782 MILE

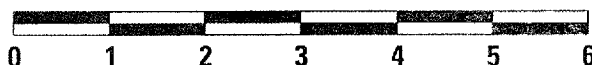

SCALE: 1" = 2 MILES

STATE OF ILLINOIS
DEPARTMENT OF TRANSPORTATION
DIVISION OF HIGHWAYS

SUBMITTED MARCH 29, 20 07

Justin U. Reed
DEPUTY DIRECTOR OF HIGHWAYS, REGION FOUR ENGINEER

May 11, 20 07
Eric E. Harn
ENGINEER OF DESIGN AND ENVIRONMENT

May 11, 20 07
Milton R. Sees, P.E.
DIRECTOR, DIVISION OF HIGHWAYS

CONTRACT NO. 72B16

INDEX

- 1 COVER
- 2 INDEX/STANDARDS/SIGNATURES
- 3 QUANTITIES
- 4-5 TYPICAL SECTIONS
- 6 SCHEDULES
- 7-8 BUTT JOINT DETAILS

STANDARDS

- 701001-01
- 701006-02
- 701011-01
- 701201-02
- 701306-01
- 701311-02
- 702001-06
- 780001-01

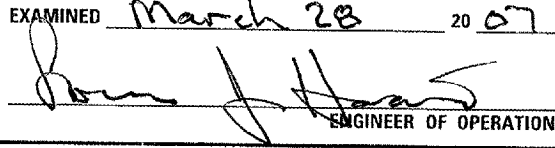
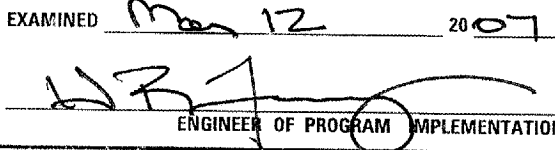
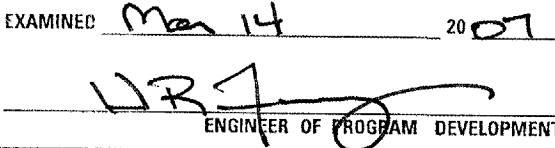
| | |
|---|--|
| STATE OF ILLINOIS DEPARTMENT OF TRANSPORTATION DIVISION OF HIGHWAYS DISTRICT 6 | |
| EXAMINED | March 28 20 07  ENGINEER OF OPERATIONS |
| EXAMINED | Mar 12 20 07  ENGINEER OF PROGRAM IMPLEMENTATION |
| EXAMINED | Mar 14 20 07  ENGINEER OF PROGRAM DEVELOPMENT |

NOTES:

NO PASSING ZONES TO BE FIELD VERIFIED BY THE BUREAU OF OPERATIONS.
THE RESIDENT ENGINEER SHALL NOTIFY THE BUREAU OF OPERATIONS 14 DAYS
PRIOR TO PERMANENT PAVEMENT MARKING.

Rev.

INDEX/STANDARDS/SIGNATURES
FAP 304 (IL 96)
SECTION 4RS-4
PIKE COUNTY

S U M M A R Y O F Q U A N T I T I E S

| CODE NO. | ITEM | UNIT | 100% STATE |
|------------|---|-------|------------|
| | | | 1000 |
| | | | TOTAL QTY |
| 40600200 | BITUMINOUS MATERIALS (PRIME COAT) | TON | 3.2 |
| 40600300 | AGGREGATE (PRIME COAT) | TON | 16.9 |
| 40600990 | TEMPORARY RAMP | SQ YD | 80 |
| 40603310 | HOT-MIX ASPHALT SURFACE COURSE, MIX C, N50 | TON | 711 |
| 44000155 | HOT-MIX ASPHALT SURFACE REMOVAL, 1 1/2" | SQ YD | 8.462 |
| 67100100 | MOBILIZATION | L SUM | 1 |
| 70100450 | TRAFFIC CONTROL AND PROTECTION, STANDARD 701201 | L SUM | 1 |
| 70100460 | TRAFFIC CONTROL AND PROTECTION, STANDARD 701306 | L SUM | 1 |
| 70300100 | SHORT-TERM PAVEMENT MARKING | FOOT | 650 |
| 70300230 | TEMPORARY PAVEMENT MARKING - LINE 5" | FOOT | 10,590 |
| 70301000 | WORK ZONE PAVEMENT MARKING REMOVAL | SQ FT | 109 |
| * 78001120 | PAINT PAVEMENT MARKING - LINE 5" | FOOT | 10,590 |
| * 78100100 | RAISED REFLECTIVE PAVEMENT MARKER | EACH | 41 |
| 78300200 | RAISED REFLECTIVE PAVEMENT MARKER REMOVAL | EACH | 41 |

*SPECIALTY ITEMS

QUANTITIES
FAP 304 (IL 96)
SECTION 4RS-4
PIKE COUNTY

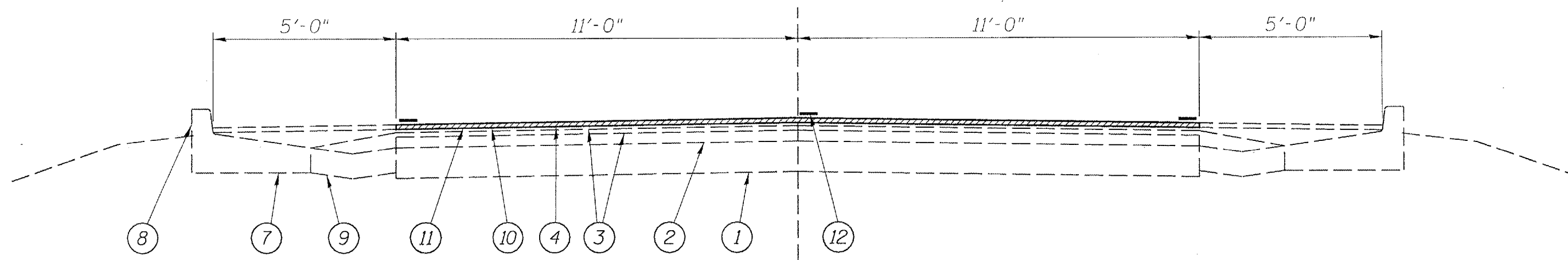

STA. 1307+44 TO 1310+27
STA. 1313+77 TO 1316+42

BRIDGE OMISSION
STA. 1310+27 TO 1313+77

LEGEND

- 1 - EXIST. CRUSHED STONE BASE ±10"
- 2 - EXIST. H.M.A. SURFACE VARIABLE DEPTH
- 3 - EXIST. H.M.A. LEVELING BINDER VARIABLE DEPTH
- 4 - EXIST. H.M.A. SURFACE 1 1/2"
- 5 - EXIST. BASE COURSE WIDENING
- 6 - EXIST. AGGREGATE SHOULDERS
- 7 - EXIST. P.C.C. BASE COURSE WIDENING
- 8 - EXIST. CONCRETE CURB, TYPE B SPECIAL
- 9 - EXIST. CONCRETE GUTTER, TYPE C
- 10 - PROP. H.M.A. SURFACE REMOVAL 1 1/2"
- 11 - PROP. H.M.A. SURFACE COURSE, MIX C, N50 1 1/2"
- 12 - PROP. PAINT PAVMENT MARKING - LINE 5"

Rev.

TYPICAL SECTIONS
FAP 304 (IL 96)
SECTION 4RS-4
PIKE COUNTY

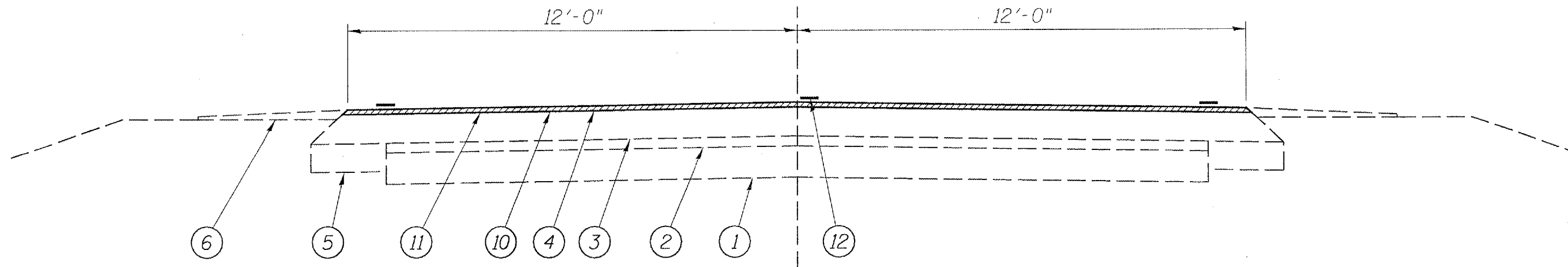

STA. 1306+99 TO 1307+44
STA. 1316+42 TO 1323+72
STA. 1327+12 TO 1334+96
STA. 1340+29 TO 1348+29

BRIDGE OMMISION
STA. 1334+96 TO 1340+29

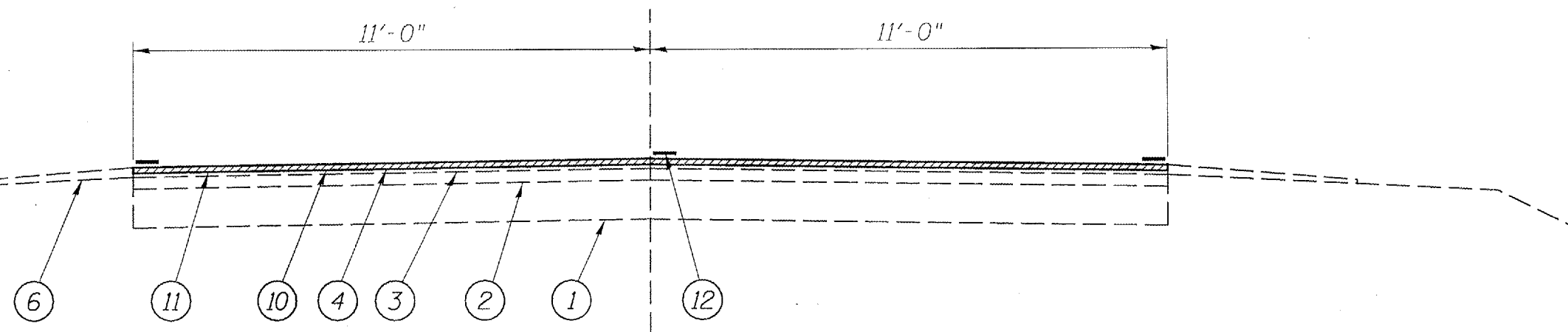

STA. 1323+72 TO 1327+12

LEGEND

- 1 - EXIST. CRUSHED STONE BASE ±10"
- 2 - EXIST. H.M.A. SURFACE VARIABLE DEPTH
- 3 - EXIST. H.M.A. LEVELING BINDER VARIABLE DEPTH
- 4 - EXIST. H.M.A. SURFACE 1 1/2"
- 5 - EXIST. BASE COURSE WIDENING
- 6 - EXIST. AGGREGATE SHOULDERS
- 7 - EXIST. P.C.C. BASE COURSE WIDENING
- 8 - EXIST. COCRETE CURB, TYPE B SPECIAL
- 9 - EXIST. CONCRETE GUTTER, TYPE C
- 10 - PROP. H.M.A. SURFACE REMOVAL 1 1/2"
- 11 - PROP. H.M.A. SURFACE COURSE, MIX C, N50 1 1/2"
- 12 - PROP. PAINT PAVMENT MARKING - LINE 5"

TYPICAL SECTIONS
FAP 304 (IL 96)
SECTION 4RS-4
PIKE COUNTY

Rev.

| PAVEMENT MARKING SCHEDULE | | | |
|----------------------------|-----------|-------------------------|----------|
| STATION | TYPE | PAINT PVT MK LINE 5" | |
| | | WHITE | YELLOW |
| LT & RT 1306+99 TO 1310+27 | EDGE LINE | 656 | |
| LT 1306+99 TO 1310+14 | SKIP DASH | | 80 FT |
| RT 1306+99 TO 1310+27 | NO PASS | | 328 FT |
| LT 1310+14 TO 1310+27 | NO PASS | | 13 FT |
| LT & RT 1313+77 TO 1334+96 | EDGE LINE | 4,238 FT | |
| LT 1313+77 TO 1326+29 | NO PASS | | 1,252 FT |
| RT 1313+77 TO 1313+90 | NO PASS | | 13 FT |
| RT 1313+90 TO 1326+29 | SKIP DASH | | 310 FT |
| LT 1326+29 TO 1334+73 | SKIP DASH | | 210 FT |
| RT 1326+29 TO 1334+96 | NO PASS | | 867 FT |
| LT 1334+73 TO 1334+96 | NO PASS | | 23 FT |
| LT & RT 1340+29 TO 1348+29 | EDGE LINE | 1,600 FT | |
| LT 1340+29 TO 1348+29 | NO PASS | | 800 FT |
| RT 1340+29 TO 1348+29 | SKIP DASH | | 200 FT |
| TOTALS | | 6,494 FT | 4,096 FT |

NOTES:

STATIONS ARE APPROXIMATE.

| MIXTURE REQUIREMENTS | |
|---|------------------------|
| THE FOLLOWING MIXTURE REQUIREMENTS ARE APPLICABLE FOR THIS PROJECT | |
| MIXTURE USE(S): | H.M.A S.C., MIX C, N50 |
| AC/PG | PG 64-22 |
| DESIGN AIR VOIDS: | 4.0% @ N DESIGN = 50 |
| MIXTURE COMP: | IL 9.5 OR 12.5 |
| FRICTION AGG: | MIX "C" |

SCHEDULES
FAP 304 (IL 96)
SECTION 4RS-4
PIKE COUNTY

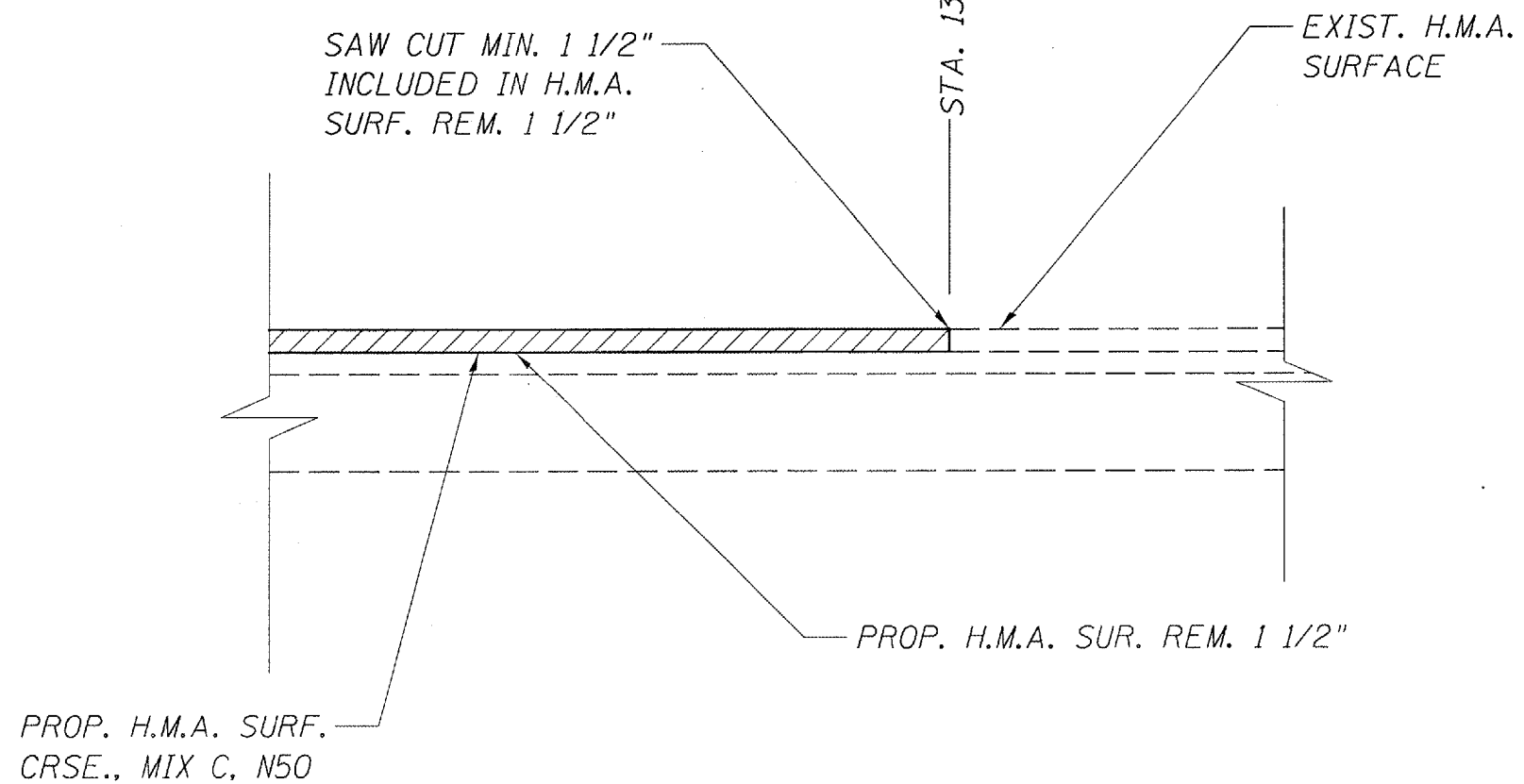
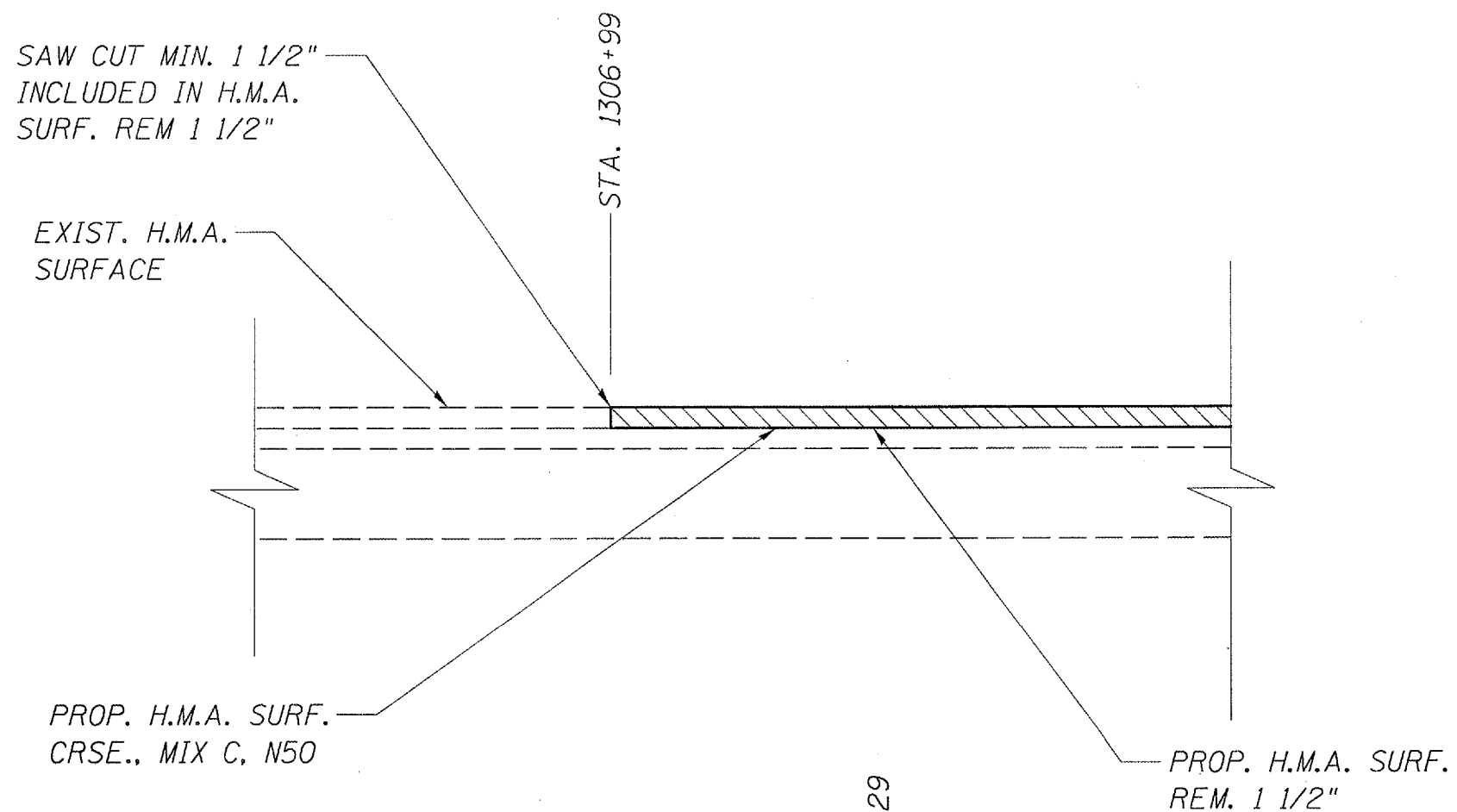

BUTT JOINT
FAP 304 (IL 96)
SECTION 4RS-4
PIKE COUNTY

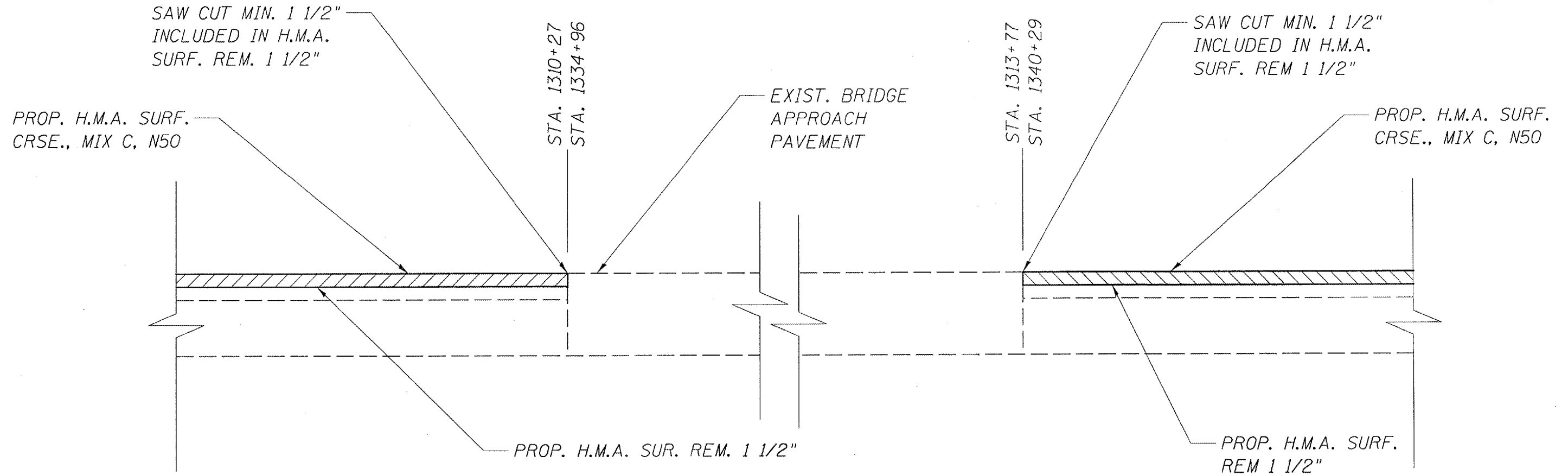

BUTT JOINT
FAP 304 (IL 96)
SECTION 4RS-4
PIKE COUNTY